

TOP HOLE (UTM NAD 83)  
N) 4438940.3  
E) 537472.2

BOTTOM HOLE (UTM NAD 83)  
N) 4435389.3  
E) 539144.4

5,700' SOUTH  
OF LATITUDE  
40°05'00"

11,570' WEST  
OF LONGITUDE  
80°30'00"

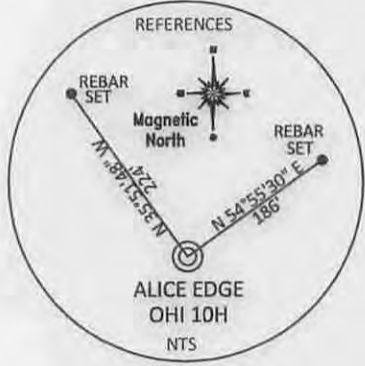
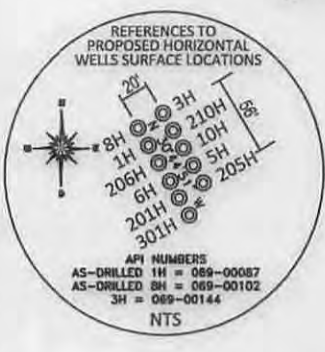
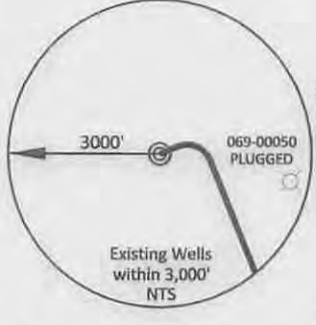

NOTE:  
NO WATER WELLS WERE FOUND WITHIN 250' OF THE CENTER OF WELL PAD.  
NO DWELLINGS WERE FOUND WITHIN 625' OF THE CENTER OF THE WELL PAD.

LESSOR	PARCEL	ACREAGE	LEASE NUMBER
A JOSEPH I. & S.R. REED	VG2-2	0.51 ACRES	47-000240-000
B JOHN J. MOSA	VG2-1	1.01 ACRES	47-000332-000
C HANCY LOUISE FREEMAN	VG5-1	0.23 ACRES	47-000158-000
D FLORENCE CROFT	VG2-57	2.018 ACRES	01-313856-000
E JOSEPH KLUSKEY	VG5-24	1.54 ACRES	47-000315-000
F WILLIAM C. III. & D.B. LADERER	L11-34.1	3.68 ACRES	47-0000562-000
G WILLIAM C. III. & D.B. LADERER	L11-35.1	1.33 ACRES	47-003335-000
H WILLIAM C. III. & D.B. LADERER	L11-35	4.99 ACRES	47-003335-000
I ROSAMARI E. GRIFFITH	L11-59	1.93 ACRES	47-000383-000
J PAUL ROBERT LESHUK	L11-38.1	1.32 ACRES	47-002718-000
K CHARLES H. & SHELLY L. GUTHOERL	L14-27.10	4.60 ACRES	47-000785-000
L CHRIS BEISWENGER	L14-27.35	5.18 ACRES	47-000241-000
M JULIE MANNING	L14-27.40	2.00 ACRES	47-000988-000
N KATHLEEN K. CROCKARD	L14-27.30	0.763 ACRES	47-001364-000
O JUNE M. & RICHARD HESTER	L14-27.14	1.474 ACRES	47-001452-000
P FREDERICK E. & DELLA E. MISENHOLDER	L14-27.12	0.432 ACRES	47-000785-000
Q ANDREW & CONNIE BURRIS	L14-27.13	2.55 ACRES	UNLEASED
R JAMES F. & ANN C. ROSE	T4-12	1.00 ACRES	01-385577-000
S RICHARD HESTER	L14-27.28	.505 ACRES	47-000988-000
T WEST VIRGINIA D.O.H.	RT. 40	N/A	01-357838-000

FREDRICK W. DAGUE  
111.572 TOTAL ACRES  
LEASE NUMBER  
01-385595-001  
TAX MAP AND PARCEL  
T9-46

JOHN A. & JAMES E. KOZIK  
128.09 TOTAL ACRES  
LEASE NUMBER  
01-292592-000  
TAX MAP AND PARCEL  
T9-49

REFERENCE NOTES  
Boundaries as shown taken  
from deeds, tax maps and  
field locations. A full boundary  
survey is not expressed nor implied.  
All bearings are based on true north.  
Ownership taken from public records  
OHIO County, West Virginia  
JUNE 2013  
State Plane Coordinates &  
NAD 83 Lat/Long by differential  
submeter mapping grade GPS  
Drafted by EAM

FILE #: CHE 036

DRAWING #: 1657

SCALE: PLAT: 1" = 2000'  
TICK MARK: 1" = 2000'

MINIMUM DEGREE  
OF ACCURACY: 1/200

PROVEN SOURCE: SUBMETER MAPPING  
GRADE GPS

I, THE UNDERSIGNED, HEREBY CERTIFY THAT THIS  
PLAT IS CORRECT TO THE BEST OF MY KNOWLEDGE AND  
BELIEF AND SHOWS ALL THE INFORMATION REQUIRED BY  
LAW AND THE REGULATIONS ISSUED AND PRESCRIBED BY  
THE DEPARTMENT OF ENVIRONMENTAL PROTECTION.

Signed:

L.L.S. #2124 : Ernest J. Benchek III

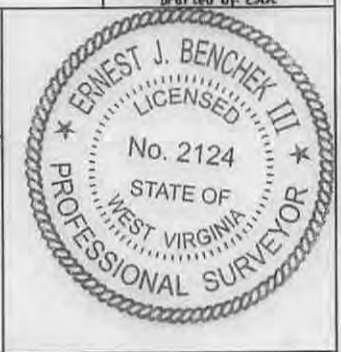

(+) DENOTES LOCATION OF WELL ON  
UNITED STATES TOPOGRAPHIC MAPS  
WVDEP  
OFFICE OF OIL & GAS  
601 57TH STREET  
CHARLESTON, WV 25304

Well Type:  Oil  Waste Diposal  Production  Deep  
 Gas  Liquid Injection  Storage  Shallow

WATERSHED: UPPER OHIO SOUTH ELEVATION: 1,198'

COUNTY/DISTRICT: OHIO / LIBERTY QUADRANGLE: VALLEY GROVE, WV

SURFACE OWNER: ALICE MAE EDGE ACREAGE: 103 +/-

OIL & GAS ROYALTY OWNER: ALICE MAE EDGE ACREAGE: 498.478 +/-

LEASE NUMBERS: \_\_\_\_\_

DRILL  CONVERT  DRILL DEEPER  REDRILL  FRACTURE OR STIMULATE   
PLUG OFF FORMATION  PERFORATE NEW FORMATION  PLUG & ABANDON   
CLEAN OUT & REPLUG  OTHER CHANGE  (SPECIFY): \_\_\_\_\_

TARGET FORMATION: MARCELLUS ESTIMATED DEPTH: TVD: 6,400' TMD: 19,675'

WELL OPERATOR: CHESAPEAKE APPALACHIA, LLC. DESIGNATED AGENT: ERIC B. GILLESPIE

ADDRESS: PO BOX 18496 ADDRESS: PO BOX 6070

CITY: OKLAHOMA CITY STATE: OK ZIP CODE: 73154-0496 CITY: CHARLESTON STATE: WV 7/19/2014

WELL: ALICE EDGE OHI 10H  
QUAD: VALLEY GROVE, WV & BETHANY, WV

47 06 9 00 1 86

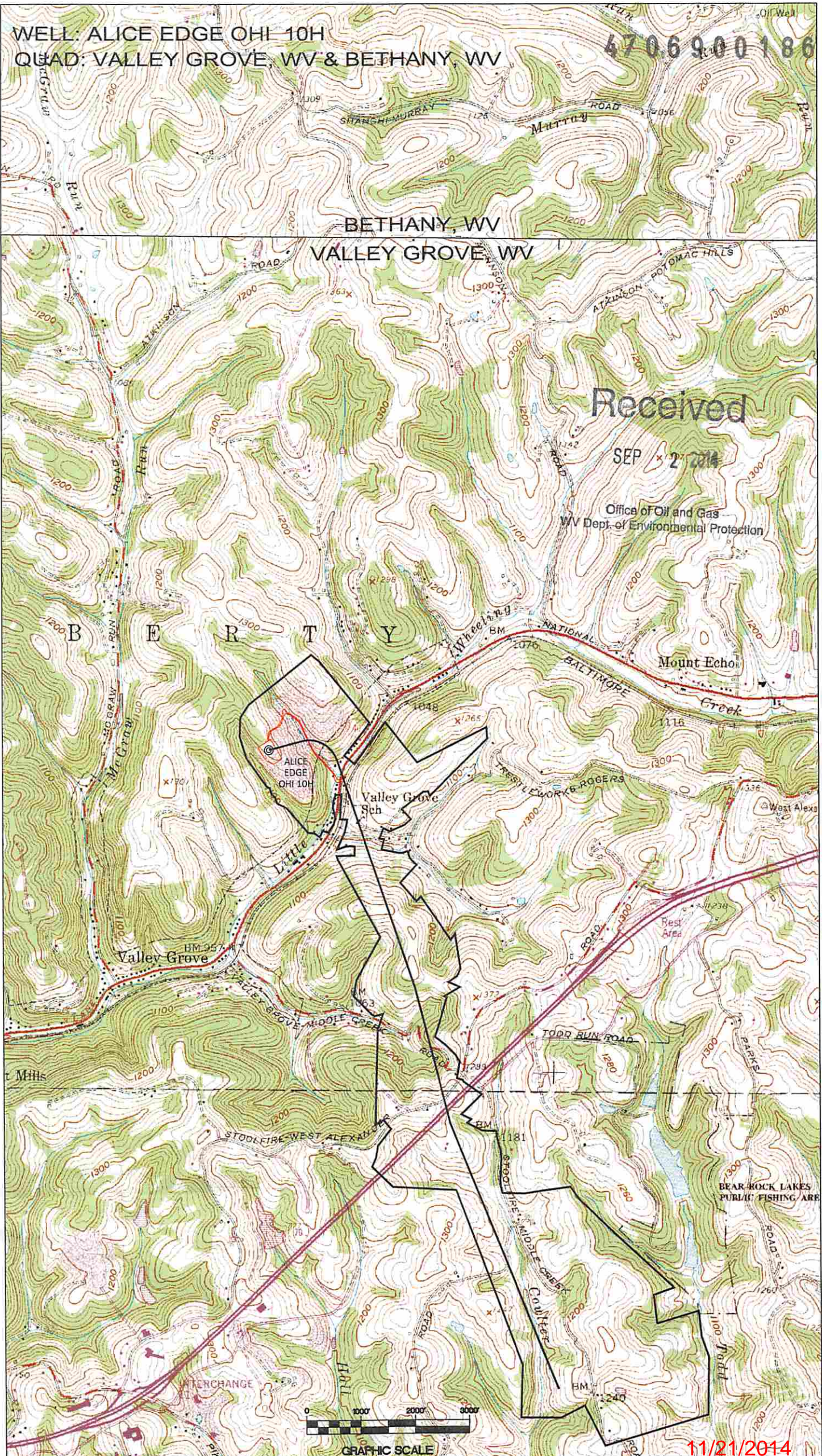

Received

SEP 2 2014

Office of Oil and Gas  
WV Dept. of Environmental Protection



GRAPHIC SCALE

11/21/2014