

TOP HOLE (UTM 83)
 N) 4440482.2
 E) 534509.5

BOTTOM HOLE (UTM 83)
 N) 4438544.4
 E) 535326.4

GLENN DIDRIKSEN
 47.93 TOTAL ACRES
 LEASE NUMBER
 1-268336-000
 TAX MAP AND PARCEL
 L7-42

#1	N 59°23'31" E 1,489'
#2	N 76°46'43" E 1,346'
#3	N 83°25'58" E 1,346'



J. MILTON AND CAROLYN GUTMAN
 24 TOTAL ACRES
 LEASE NUMBER
 1-385459-000
 TAX MAP AND PARCEL
 L10-39.1

LINDA JEAN STONE
 75 TOTAL ACRES
 LEASE NUMBER
 1-313594-001
 TAX MAP AND PARCEL
 L10-39

MATTHEW AND JUDITH PADDEN
 96 TOTAL ACRES
 LEASE NUMBER
 1-313595-001
 TAX MAP AND PARCEL
 L10-38

JERRY LEE HARRIS
 115.6 TOTAL ACRES
 LEASE NUMBER
 1-324182-000
 TAX MAP AND PARCEL
 L10-37

HANK D. & NIKI L. EWING-DAVIS
 10,804 TOTAL ACRES
 LEASE NUMBER
 1-385458-001
 TAX MAP AND PARCEL
 L10-37.1

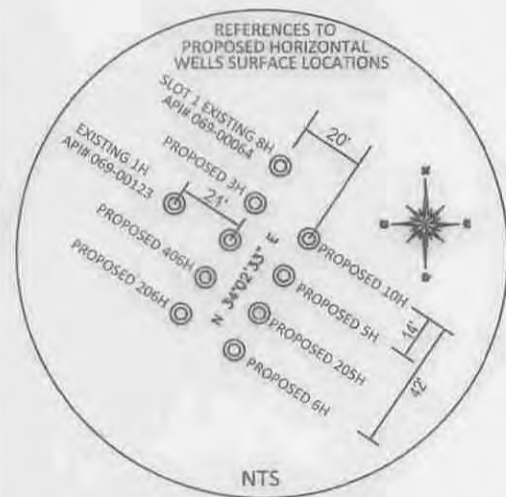
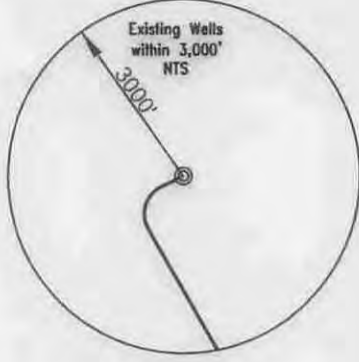

NO DWELLINGS WERE FOUND WITHIN 625' OF THE CENTER OF WELL PAD
 NO WATER WELLS WERE FOUND WITHIN 250' OF THE CENTER OF WELL PAD

REFERENCE NOTES
 Boundaries as shown taken from deeds, tax maps and field locations. A full boundary survey is not expressed nor implied. All bearings are based on true north. Ownership taken from public records Dea County, West Virginia SEPTEMBER 2014 State Plane Coordinates & NAD 83 Lat/Long by differential submeter mapping grade GPS Drawn by E.A.V.

FILE #: CHE115
 DRAWING #: 2400
 SCALE: PLAT = (1"=1200')
 TICK MARK = (1"=2000')
 MINIMUM DEGREE OF ACCURACY: 1/200
 PROVEN SOURCE OF ELEVATION: SUBMETER MAPPING GRADE GPS

I, THE UNDERSIGNED, HEREBY CERTIFY THAT THIS PLAT IS CORRECT TO THE BEST OF MY KNOWLEDGE AND BELIEF AND SHOWS ALL THE INFORMATION REQUIRED BY LAW AND THE REGULATIONS ISSUED AND PRESCRIBED BY THE DEPARTMENT OF ENVIRONMENTAL PROTECTION.

Signed: *[Signature]*
 L.L.S. #2124 : Ernest J. Benchek III



(+) DENOTES LOCATION OF WELL ON UNITED STATES TOPOGRAPHIC MAPS WYDEP
 OFFICE OF OIL & GAS
 601 57TH STREET
 CHARLESTON, WV 25304

Well Type: Oil Waste Diposal Production Deep
 Gas Liquid Injection Storage Shallow

WATERSHED: LITTLE WHEELING CREEK
 COUNTY/DISTRICT: OHIO / LIBERTY
 SURFACE OWNER: GLENN DIDRIKSEN
 OIL & GAS ROYALTY OWNER: D&B FAST FOOD, INC.
 LEASE NUMBERS:

DATE: MARCH 26, 2015
 OPERATOR'S WELL #: GLENN DIDRIKSEN OHI 6H
 API WELL #: 47 69 0018846A
 STATE COUNTY PERMIT

ELEVATION: 1,382'
 QUADRANGLE: VALLEY GROVE, WV
 ACREAGE: 47.93 +/-
 ACREAGE: 369.33 +/-

DRILL CONVERT DRILL DEEPER REDRILL FRACTURE OR STIMULATE
 PLUG OFF FORMATION PERFORATE NEW FORMATION PLUG & ABANDON
 CLEAN OUT & REPLUG OTHER CHANGE (SPECIFY):

TARGET FORMATION: MARCELLUS
 ESTIMATED DEPTH: TVD: 6,380' TMD: 14,166'
 WELL OPERATOR: SWN Production Co., LLC.
 ADDRESS: PO BOX 1300
 CITY: Jane Lew STATE: WV ZIP CODE: 26378

DESIGNATED AGENT: Dee Southall
 ADDRESS: PO BOX 1300
 CITY: Jane Lew STATE: WV ZIP CODE: 26378

05/08/2015

WELL: GLENN DIDRIKSEN OHI 6H
QUAD: VALLEY GROVE, WV.

