



320 O'Bryan Lane • Van Buren, AR 72956  
Office: 479.474.7916 • Fax: 479.474.2450  
Surveying • handa-inc.com

| LINE | BEARING       | DISTANCE    | DESCRIPTION      | MONUMENT                                    |
|------|---------------|-------------|------------------|---|
| L1   | S 19°16'52" E | 294.54'     | SHL TO LANDMARK  | FOUND POST                                  |
| L2   | N 50°41'21" E | 1094.73'    | SHL TO LANDMARK  | FOUND REBAR                                 |
| L3   | N 23°04'24" W | 49.53'      | SHL TO REF. PNT. | GLENN DIDRIKSEN OHI 1H WELLHEAD (069-00123) |
| L4   | N 07°17'08" E | 46.57'      | SHL TO REF. PNT. | GLENN DIDRIKSEN OHI 8H WELLHEAD (069-00064) |
| LINE | CHORD BEARING | CHORD DIST. | CURVE LENGTH     | DESCRIPTION                                 |
| L5   | S 33°30'59" W | 1147.24'    |                  | SHL TO LP                                   |
| L6   | S 31°27'42" E | 6233.98'    |                  | LP TO BHL                                   |

Latitude: 40°07'30"

Longitude: 80°35'00"

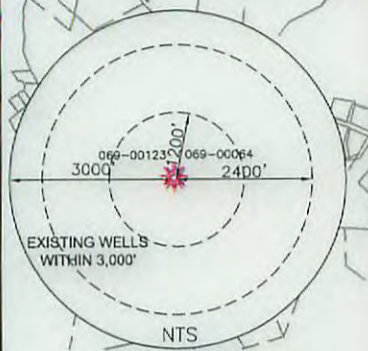
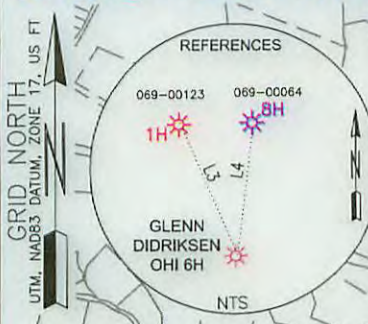

| TRACT | SURFACE OWNER (S) ROYALTY OWNER (R)            | TAX PARCEL | ACRES  | LEASE NUMBER |
|-------|--|------------|--------|--------------|
| 1     | GLENN DIDRIKSEN (S)<br>D&D FAST FOOD, INC. (R) | 3-L7-42    | 47.93  |              |
| 2     | ROBERT WALTER & DONNA JEAN LASCH (S/R)         | 3-L10-39   | 75.00  | 1-268336-000 |
| 3     | J. MILTON GUTMAN & CAROLYN L. GUTMAN (S/R)     | 3-L10-39.1 | 24.00  | 1-313594-001 |
| 4     | J. MATHEW PADDEN & JUDITH M. PADDEN (S/R)      | 3-L10-38   | 96.00  | 1-313595-001 |
| 5     | LARRY R. HARRIS (S)                            | 3-L10-37.1 | 10.804 |              |
|       | LAURA HICKMAN (R)                              | 3-L10-37.1 | 10.804 | 1-385458-001 |
|       | DON P. HARRIS (R)                              | 3-L10-37.1 | 10.804 | 1-385456-001 |
|       | LARRY HARRIS II (R)                            | 3-L10-37.1 | 10.804 | 1-385457-001 |
|       | JERRY LEE HARRIS (S/R)                         | 3-L10-37   | 115.6  | 1-324182-000 |

|                   |               |          |
|-------------------|---------------|----------|
| SHL TO "S" #1     | N 58°25'38" E | 1489.08' |
| SHL TO "S" #2     | N 75°48'51" E | 1346.02' |
| SHL TO WATER WELL | N 82°28'07" E | 1346.01' |

- NOTES ON SURVEY**
- COORDINATE SYSTEM IS UTM, NAD 83 DATUM, ZONE 17, U.S. FOOT AND WELL COORDINATES ESTABLISHED USING SURVEY GRADE GPS.
  - SURFACE AND ROYALTY OWNER INFORMATION AND THEIR BOUNDARIES SHOWN HEREON WERE PLOTTED FROM DEEDS AND/OR TAX PARCEL MAPS PROVIDED BY CLIENT AND/OR FIELD LOCATIONS.
  - THIS PLAT DOES NOT REPRESENT A BOUNDARY SURVEY OF THE PARCELS SHOWN HEREON.
  - NO OCCUPIED DWELLINGS AND AGRICULTURE BUILDINGS GREATER THAN 2500 SQ FT. WITHIN 625 FEET OF PROPOSED CENTER OF PAD.
  - NO WATER WELLS OR DEVELOPED SPRINGS WITHIN 250 FEET OF PROPOSED WELL.
  - NO PERENNIAL STREAMS, LAKES, PONDS, OR RESERVOIRS WITHIN 100 FEET OF THE LIMITS OF DISTURBANCE.
  - NO NATURALLY PRODUCING TROUT STREAM WITHIN 300 FEET OF LIMITS OF DISTURBANCE.
  - NO GROUND INTAKE OR PUBLIC WATER SUPPLY WITHIN 1000 FEET OF WELL PAD, LIMITS OF DISTURBANCE, E & S CONTROLS OR PUBLIC WATER SUPPLY.

|                                     |
|-------------------------------------|
| <b>SURFACE HOLE LOCATION (SHL):</b> |
| UTM (NAD83, ZONE 17, METERS):       |
| NORTHING: 4,440,482.184             |
| EASTING: 534,509.575                |
| <b>LANDING POINT (LP)</b>           |
| UTM (NAD83, ZONE 17, METERS):       |
| NORTHING: 4,440,190.645             |
| EASTING: 534,316.490                |
| <b>BOTTOM HOLE LOCATION (BHL):</b>  |
| UTM (NAD83, ZONE 17, METERS):       |
| NORTHING: 4,438,569.864             |
| EASTING: 535,308.220                |

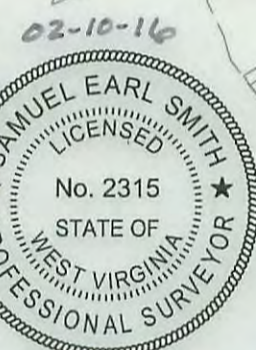
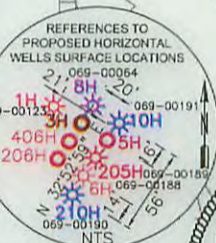

I, THE UNDERSIGNED, HEREBY CERTIFY THAT THIS PLAT IS CORRECT TO THE BEST OF MY KNOWLEDGE AND BELIEF AND SHOWS ALL THE INFORMATION REQUIRED BY LAW AND REGULATIONS ISSUED AND PRESCRIBED BY THE DEPARTMENT OF ENVIRONMENTAL PROTECTION.

P.S. 2315

COMPANY: **SWN** Production Company, LLC

|  |   |   |   |
|--|---|---|---|
|  | (+) DENOTES LOCATION OF WELL ON UNITED STATES TOPOGRAPHIC MAPS          | MINIMUM DEGREE OF ACCURACY: 1/200                             | GLENN DIDRIKSEN OHI   |
|  | WVDEP<br>OFFICE OF OIL & GAS<br>601 57TH STREET<br>CHARLESTON, WV 25034 | PROVEN SURVEY SOURCE OF GRADE GPS ELEVATION: (NAVD 88, US FT) | OPERATOR'S WELL #: 6H<br><br>API WELL #: 47 69 00188<br>STATE COUNTY PERMIT |

WELL TYPE: OIL  WASTE DISPOSAL  PRODUCTION  DEEP  GAS  LIQUID INJECTION  STORAGE  SHALLOW

WATERSHED: LITTLE WHEELING CREEK ELEVATION: 1382.2'

DISTRICT: LIBERTY COUNTY: OHIO QUADRANGLE: VALLEY GROVE, WV

SURFACE OWNER: GLENN DIDRIKSEN ACREAGE: ±47.93

OIL & GAS ROYALTY OWNER: D&D FAST FOOD, INC. ACREAGE: ±47.93

DRILL  DRILL DEEPER  REDRILL  FRACTURE OR STIMULATE  PLUG OFF OLD FORMATION  PERFORATE NEW FORMATION

CONVERT  PLUG & ABANDON  CLEAN OUT & REPLUG  OTHER CHANGE  (SPECIFY) AS-DRILLED

TARGET FORMATION: MARCELLUS DEPTH: 6,424' IVD 13,159' IMD

|  |  |
|--|--|
| WELL OPERATOR: SWN PRODUCTION COMPANY, LLC | DESIGNATED AGENT: DEE SOUTHALL           |
| ADDRESS: P.O. BOX 1300                     | ADDRESS: P.O. BOX 1300                   |
| CITY: JANE LEW STATE: WV ZIP CODE: 26378   | CITY: JANE LEW STATE: WV ZIP CODE: 26378 |

| LEGEND:   | REVISIONS:  | DATE:  |
|---|---|--|
| PROPOSED SURFACE HOLE / BOTTOM HOLE<br>EXISTING / PRODUCING WELLHEAD<br>ABANDONED WELL<br>PLUGGED & ABANDONED WELL<br>CUT CONDUCTOR | --- LEASE BOUNDARY<br>--- AS-DRILLED PATH<br>--- PERMITTED DIRECTIONAL PATH<br>--- DIRECTIONAL PATH<br>--- ABANDONED PATH | 07-21-2015<br>05/28/2015<br>11-16-2015<br>02-09-2016 |