

THRASHER

THE THRASHER GROUP, INC.
600 WHITE OAKS BLVD.
BRIDGEPORT, WV 26330
PHONE 304-624-4108

NOTES ON SURVEY

- COORDINATES SYSTEM IS UTM, NAD 83 DATUM, ZONE 17, U.S. FOOT AND WELL COORDINATES ESTABLISHED USING SURVEY GRADE GPS.
- SURFACE AND ROYALTY OWNER INFORMATION AND THEIR BOUNDARIES SHOWN HEREON WERE PLOTTED FROM DEEDS AND/OR TAX PARCEL MAPS PROVIDED BY CLIENT AND FIELD LOCATIONS.
- THIS PLAT DOES NOT REPRESENT A BOUNDARY SURVEY OF THE PARCELS SHOWN HEREON.
- NO DWELLINGS AND BUILDINGS WITHIN 625 FEET OF PROPOSED CENTER OF PAD.
- NO WATER WELLS OR DEVELOPED SPRINGS WITHIN 250 FEET OF PROPOSED WELL.
- NO PERENNIAL STREAMS, LAKES, PONDS, RESERVOIRS OR WETLANDS WITHIN 100 FEET OF THE LIMITS OF DISTURBANCE.
- NO NATURALLY PRODUCING TROUT STREAM WITHIN 300 FEET OF LIMITS OF DISTURBANCE.

LINE	DESCRIPTION	DISTANCE	DESCRIPTION	MONUMENT
L1	N 10°35'55" E	24.50'	SHL TO 069-00072	EXISTING WELL HEAD
L2	N 65°47'31" E	27.98'	SHL TO 069-00105	EXISTING WELL HEAD
L3	N 87°55'23" W	1717.98'	SHL TO LANDMARK	IRF FOUND
L4	S 75°13'39" W	1602.60'	SHL TO LANDMARK	IRF FOUND
L5	S 83°08'14" E	985.57'	SHL TO LP	LANDING POINT
L6	S 23°31'28" E	10301.05'	LP TO BHL	BOTTOM HOLE

TRACT	SURFACE OWNER	TAX PARCEL	ACRES
1	SHAWN W. COUCH TRUST	3-L4011000000000	121.56
2	PAUL & RHONDA TYRNA	3-L4011400000000	1.24
3	PENELOPE T. MILLER	3-L4011700000000	139.51
4	JAMES W. & HELEN L. LOEW	3-L4011800020000	15.00
5	KEVIN L. & RHONDA L. KIMMINS	3-L4011800030000	29.00
6	HERBERT P. & CAROL A. MINCH	3-L4012000000000	190.721
7	RONALD D. & MARY LEE FEKETE	3-L7000500000000	40.18
8	JOSEPH F. BIPPUS SR (ET AL)	3-L8000100050000	96.315
9	CHARLES E. DAGUE	3-L8001400000000	2.399
10	TUNNEL RIDGE, LLC	3-L8001500000000	19.829
11	THOMAS J. SCHMITT	3-L8001600000000	15.350
12	THOMAS J. SCHMITT	3-L8001600100000	2.700

ADJOINING OWNER INFORMATION
(SEE ADJOINING OWNERS SHEET)

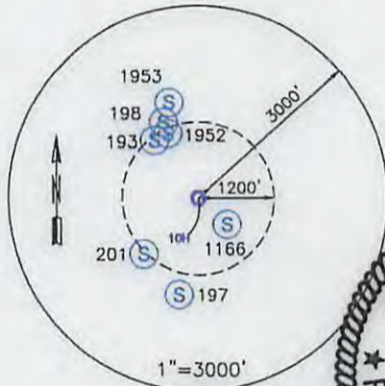
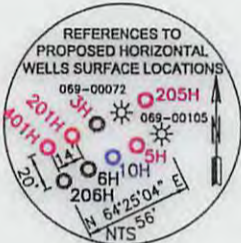

SURFACE HOLE LOCATION (SHL):
UTM (NAD83, ZONE 17, METERS):
NORTHING: 4,444,244.894
EASTING: 535,039.583
LANDING POINT LOCATION (LPL):
UTM (NAD83, ZONE 17, METERS):
NORTHING: 4,444,196.053
EASTING: 535,393.338
BOTTOM HOLE LOCATION (BHL):
UTM (NAD83, ZONE 17, METERS):
NORTHING: 4,441,317.234
EASTING: 536,646.546

I, THE UNDERSIGNED, HEREBY CERTIFY THAT THIS PLAT IS CORRECT TO THE BEST OF MY KNOWLEDGE AND BELIEF AND SHOWS ALL THE INFORMATION REQUIRED BY LAW AND REGULATIONS ISSUED AND PRESCRIBED BY THE DEPARTMENT OF ENVIRONMENTAL PROTECTION.

P.S. 2270

Michael S. Wolf 7/22/16

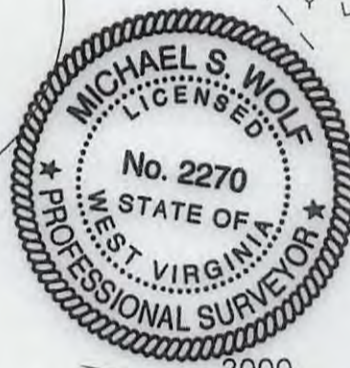

GRAPHIC SCALE IN FEET

COMPANY: **SWN** Production Company, LLC

 (+) DENOTES LOCATION OF WELL ON UNITED STATES TOPOGRAPHIC MAPS WVDEP OFFICE OF OIL & GAS 601 57TH STREET CHARLESTON, WV 25034	MINIMUM DEGREE OF ACCURACY: 1/200 PROVEN SURVEY SOURCE OF GRADE GPS ELEVATION: (NAVD 88, US FT)	SHAWN COUCH OPERATOR'S WELL #: OHI 10H API WELL #: 47 069 00206 H6A STATE COUNTY PERMIT
	WELL TYPE: OIL WASTE DISPOSAL PRODUCTION DEEP GAS <input checked="" type="checkbox"/> LIQUID INJECTION STORAGE SHALLOW <input checked="" type="checkbox"/> WATERSHED: MCGRAW RUN DISTRICT: LIBERTY COUNTY: OHIO SURFACE OWNER: SHAWN W. COUCH TRUST OIL & GAS ROYALTY OWNER: GEORGE W. COUCH DRILL <input checked="" type="checkbox"/> DRILL DEEPER REDRILL <input type="checkbox"/> FRACTURE OR STIMULATE <input checked="" type="checkbox"/> PLUG OFF OLD FORMATION PERFORATE NEW FORMATION CONVERT <input type="checkbox"/> PLUG & ABANDON <input type="checkbox"/> CLEAN OUT & REPLUG <input type="checkbox"/> OTHER CHANGE (SPECIFY) TARGET FORMATION: MARCELLUS ESTIMATED DEPTH: 6,365 TVD 16,971 TMD	ELEVATION: 1246.9 QUADRANGLE: BETHANY ACREAGE: 121.56 ACREAGE: 121.56

WELL OPERATOR: SWN PRODUCTION COMPANY, LLC ADDRESS: P.O. BOX 1300 CITY: JANE LEW STATE: WV ZIP CODE: 26378	DESIGNATED AGENT: DEE SOUTHALL ADDRESS: P.O. BOX 1300 CITY: JANE LEW STATE: WV ZIP CODE: 26378
--	--

LEGEND: ○ PROPOSED SURFACE HOLE / BOTTOM HOLE ✱ EXISTING / PRODUCING WELLHEAD ✕ ABANDONED WELL ✕ PLUGGED & ABANDONED WELL △ CUT CONDUCTOR (S) EXISTING SPRING (W) EXISTING WATER WELL - - - - - LEASE BOUNDARY - - - - - MARCELLUS DHP - - - - - ABANDONED PATH	REVISIONS: DATE: 7-22-16 DRAWN BY: K. POTH SCALE: 1" = 2000' DRAWING NO: 050-5635 WELL LOCATION PLAT
--	--