

THRASHER

THE THRASHER GROUP, INC.
600 WHITE OAKS BLVD.
BRIDGEPORT, WV 26330
PHONE 304-624-4108

NOTES ON SURVEY

- COORDINATES SYSTEM IS UTM, NAD 83 DATUM, ZONE 17, U.S. FOOT AND WELL COORDINATES ESTABLISHED USING SURVEY GRADE GPS.
- SURFACE AND ROYALTY OWNER INFORMATION AND THEIR BOUNDARIES SHOWN HEREON WERE PLOTTED FROM DEEDS AND/OR TAX PARCEL MAPS PROVIDED BY CLIENT AND FIELD LOCATIONS.
- THIS PLAT DOES NOT REPRESENT A BOUNDARY SURVEY OF THE PARCELS SHOWN HEREON.
- NO DWELLINGS AND BUILDINGS WITHIN 625 FEET OF PROPOSED CENTER OF PAD.
- NO WATER WELLS OR DEVELOPED SPRINGS WITHIN 250 FEET OF PROPOSED WELL.
- NO PERENNIAL STREAMS, LAKES, PONDS, RESERVOIRS OR WETLANDS WITHIN 100 FEET OF THE LIMITS OF DISTURBANCE.
- NO NATURALLY PRODUCING TROUT STREAM WITHIN 300 FEET OF LIMITS OF DISTURBANCE.

LINE	DESCRIPTION	DISTANCE	DESCRIPTION	MONUMENT
L1	N 10°39'32" E	24.53'	SHL TO 069-00072	EXISTING WELL HEAD
L2	N 55°46'47" E	28.02'	SHL TO 069-00105	EXISTING WELL HEAD
L3	N 87°42'37" W	1705.67'	SHL TO LANDMARK	IRF FOUND
L4	S 75°19'02" W	1588.97'	SHL TO LANDMARK	IRF FOUND
L5	S 83°08'14" E	985.57'	SHL TO LP	LANDING POINT

TRACT	SURFACE OWNER	TAX PARCEL	ACRES
1	SHAWN W. COUCH TRUST	3-L4011000000000	121.56
2	PAUL & RHONDA TYRNA	3-L4011400000000	1.24
3	PENELOPE T. MILLER	3-L4011700000000	139.51
4	JAMES W. & HELEN L. LOEW	3-L4011800020000	15.00
5	KEVIN L. & RHONDA L. KIMMINS	3-L4011800030000	29.00
6	HERBERT P. & CAROL A. MINCH	3-L4012000000000	190.721
7	RONALD D. & MARY LEE FEKETE	3-L7000500000000	40.18
8	JOSEPH F. BIPPUS SR (ET AL)	3-L8000100050000	96.315
9	CHARLES E. DAGUE	3-L8001400000000	2.399
10	TUNNEL RIDGE, LLC	3-L8001500000000	19.829
11	THOMAS J. SCHMITT	3-L8001600000000	15.350
12	THOMAS J. SCHMITT	3-L8001600100000	2.700

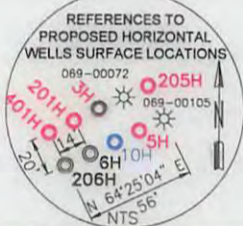

SURFACE HOLE LOCATION (SHL):	
UTM (NAD83, ZONE 17, METERS):	NORTHING: 4,444,244.888
	EASTING: 535,039.574
	NORTHING: 4,444,244.894
	EASTING: 535,039.583
LANDING POINT LOCATION (LPL):	
UTM (NAD83, ZONE 17, METERS):	NORTHING: 4,456,828.925
	EASTING: 535,465.094
	NORTHING: 4,444,196.053
	EASTING: 535,393.338
BOTTOM HOLE LOCATION (BHL):	
UTM (NAD83, ZONE 17, METERS):	NORTHING: 4,441,315.419
	EASTING: 536,541.853
	NORTHING: 4,441,802.905
	EASTING: 536,312.751

I, THE UNDERSIGNED, HEREBY CERTIFY THAT THIS PLAT IS CORRECT TO THE BEST OF MY KNOWLEDGE AND BELIEF AND SHOWS ALL THE INFORMATION REQUIRED BY LAW AND REGULATIONS ISSUED AND PRESCRIBED BY THE DEPARTMENT OF ENVIRONMENTAL PROTECTION.

P.S. 2270



(+) DENOTES LOCATION OF WELL ON UNITED STATES TOPOGRAPHIC MAPS
WVDEP
OFFICE OF OIL & GAS
601 57TH STREET
CHARLESTON, WV 25034

MINIMUM DEGREE OF ACCURACY: 1/200
PROVEN SURVEY SOURCE OF ELEVATION: GRADE GPS (NAVD 88, US FT)

COMPANY: **SWN** Production Company, LLC

SHAWN COUCH
OPERATOR'S WELL #: OHI 10H
API WELL #: 47 069 00206
STATE COUNTY PERMIT

WELL TYPE: OIL WASTE DISPOSAL PRODUCTION DEEP GAS LIQUID INJECTION STORAGE SHALLOW

WATERSHED: MCGRAW RUN
DISTRICT: LIBERTY COUNTY: OHIO
SURFACE OWNER: SHAWN W. COUCH TRUST
OIL & GAS ROYALTY OWNER: GEORGE W. COUCH

DRILL DRILL DEEPER REDRILL FRACTURE OR STIMULATE PLUG OFF OLD FORMATION PERFORATE NEW FORMATION

CONVERT PLUG & ABANDON CLEAN OUT & REPLUG OTHER CHANGE (SPECIFY) AS-DRILLED

TARGET FORMATION: MARCELLUS ESTIMATED DEPTH: 5,365 TVD 16,971 TMD

WELL OPERATOR: SWN PRODUCTION COMPANY, LLC
ADDRESS: P.O. BOX 1300
CITY: JANE LEW STATE: WV ZIP CODE: 26378

DESIGNATED AGENT: DEE SOUTHALL
ADDRESS: P.O. BOX 1300
CITY: JANE LEW STATE: WV ZIP CODE: 26378

LEGEND:	REVISIONS:	DATE:
○ PROPOSED SURFACE HOLE / BOTTOM HOLE		04-28-2017
⊙ EXISTING / PRODUCING WELLHEAD		
⊗ ABANDONED WELL		
⊕ PLUGGED & ABANDONED WELL		
△ CUT CONDUCTOR		
○ EXISTING SPRING		
○ EXISTING WATER WELL		
--- LEASE BOUNDARY		
--- PROPOSED DHP		
--- AS-DRILLED DHP		
		DRAWN BY: K. POTH
		SCALE: 1" = 2000'
		DRAWING NO: 050-5635
		WELL LOCATION PLAT