

Latitude: 40°05'00"

SURFACE HOLE 9885'

BOTTOM HOLE 918'

JACKSON SURVEYING INC.

P.O. Box 1460
677 W. Main St.
Clarksburg, WV 26302
304-623-5851

SURFACE HOLE LOCATION (SHL):
UTM (NAD83, ZONE 17, METERS): NORTHING: 4,433,728.584 EASTING: 536,079.874
TURNING POINT LOCATION (TPL):
UTM (NAD83, ZONE 17, METERS): NORTHING: 4,434,022.820 EASTING: 536,689.100
LANDING POINT LOCATION (LPL):
UTM (NAD83, ZONE 17, METERS): NORTHING: 4,434,217.981 EASTING: 536,674.555
BOTTOM HOLE LOCATION (BHL):
UTM (NAD83, ZONE 17, METERS): NORTHING: 4,436,675.552 EASTING: 535,245.620

GRID NORTH:
UTM, NAD83 DATUM, ZONE 17, US FT

LINE	BEARING	DISTANCE	DESCRIPTION	MONUMENT
L1	N 56°37'55" W	1534.11'	SHL TO LANDMARK	CNR FENCE POST
L2	S 05°59'44" E	856.07'	SHL TO LANDMARK	LARGE STONE
L3	N 64°13'16" E	2219.68'	SHL TO TPL	TPL
LINE	BEARING	DISTANCE	CURVE LENGTH	DESCRIPTION
L4	N 04°15'44" W	642.07'	697.22'	TPL TO LP



BOTTOM HOLE 1355'

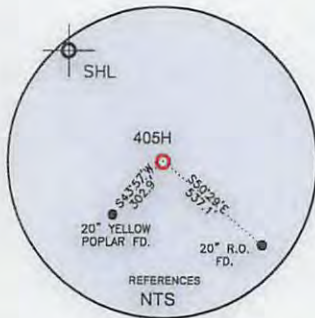
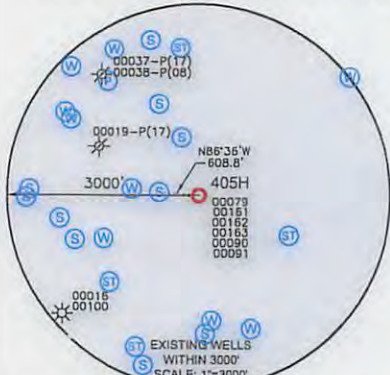
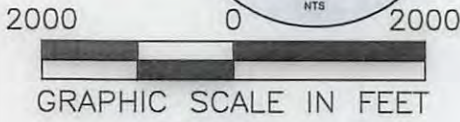

WELL RESTRICTIONS

- NO OCCUPIED DWELLINGS > 2500 SQ FT. WITHIN 825 FEET OF CENTER OF PAD.
- NO AGRICULTURE BUILDINGS > 2500 SQ FT. WITHIN 625 FEET OF CENTER OF PAD.
- WATER WELLS OR DEVELOPED SPRINGS ARE WITHIN 250 FEET OF PROPOSED WELL.
- PERENNIAL STREAMS, LAKES, PONDS, OR RESERVOIRS WITHIN 100 FEET OF THE LIMITS OF DISTURBANCE.
- NO NATURALLY PRODUCING TROUT STREAM WITHIN 300 FEET OF LIMITS OF DISTURBANCE.
- NO GROUND INTAKE OR PUBLIC WATER SUPPLY WITHIN 1000 FEET OF WELL PAD, LIMITS OF DISTURBANCE, E & S CONTROLS OR PUBLIC WATER SUPPLY.

NOTES ON SURVEY

- SURFACE AND ROYALTY OWNER INFORMATION AND THEIR BOUNDARIES SHOWN HEREON WERE PLOTTED FROM DEEDS AND/OR TAX PARCEL MAPS PROVIDED BY CLIENT AND/OR FIELD LOCATIONS.
 - THIS PLAT DOES NOT REPRESENT A BOUNDARY SURVEY OF THE PARCELS SHOWN HEREON.
 - ALL INSETS ARE GRID NORTH UNLESS OTHERWISE DEPICTED.
- I, THE UNDERSIGNED, HEREBY CERTIFY THAT THIS PLAT IS CORRECT TO THE BEST OF MY KNOWLEDGE AND BELIEF AND SHOWS ALL THE INFORMATION REQUIRED BY LAW AND REGULATIONS ISSUED AND PRESCRIBED BY THE DEPARTMENT OF ENVIRONMENTAL PROTECTION.

P.S. 708

David L Jackson

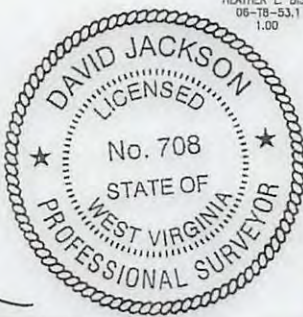

COMPANY:



(+) DENOTES LOCATION OF WELL ON UNITED STATES TOPOGRAPHIC MAPS

WVDEP
OFFICE OF OIL & GAS
601 57TH STREET
CHARLESTON, WV 25034

MINIMUM DEGREE OF ACCURACY: 1/200

PROVEN SURVEY SOURCE OF GRADE GPS ELEVATION: (NAVD 88, US FT)

OPERATOR'S WELL #: 405H

API WELL #: 47 STATE 069 COUNTY 00231 PERMIT

WELL TYPE: OIL WASTE DISPOSAL PRODUCTION DEEP GAS LIQUID INJECTION STORAGE SHALLOW

WATERSHED: MARLOW RUN OF MIDDLE WHEELING CREEK ELEVATION: 1266.8'

DISTRICT: TRIADDELPHIA COUNTY: OHIO QUADRANGLE: VALLEY GROVE, WV

SURFACE OWNER: DOROTHY V. FRYE ACREAGE: ±105.00

OIL & GAS ROYALTY OWNER: DOROTHY V. FRYE ACREAGE: ±105.00

DRILL DRILL DEEPER REDRILL FRACTURE OR STIMULATE PLUG OFF OLD FORMATION PERFORATE NEW FORMATION

CONVERT PLUG & ABANDON CLEAN OUT & REPLUG OTHER CHANGE (SPECIFY)

TARGET FORMATION: MARCELLUS ESTIMATED DEPTH: 6,528 TVD @ 16.761 IPM

WELL OPERATOR: SWN PRODUCTION COMPANY, LLC DESIGNATED AGENT: DEE SOUTHALL

ADDRESS: P.O. BOX 1300 ADDRESS: P.O. BOX 1300

CITY: JANE LEW STATE: WV ZIP CODE: 26378 CITY: JANE LEW STATE: WV ZIP CODE: 26378

LEGEND:

- PROPOSED SURFACE HOLE / BOTTOM HOLE
- ★ EXISTING / PRODUCING WELLHEAD
- LPL ★ LANDING POINT LOCATION
- W EXISTING WATER WELL
- S EXISTING SPRING
- SURVEYED BOUNDARY
- DRILLING UNIT
- == LEASE BOUNDARY
- PROPOSED PATH

REVISIONS:

DATE: 04-21-2017

DRAWN BY: N. MANO

SCALE: 1" = 2000'

DRAWING NO:

WELL LOCATION PLAT 1

**JACKSON SURVEYING
INC.**

P.O. Box 1460
677 W. Main St.
Clarksburg, WV 26302
304-623-5851

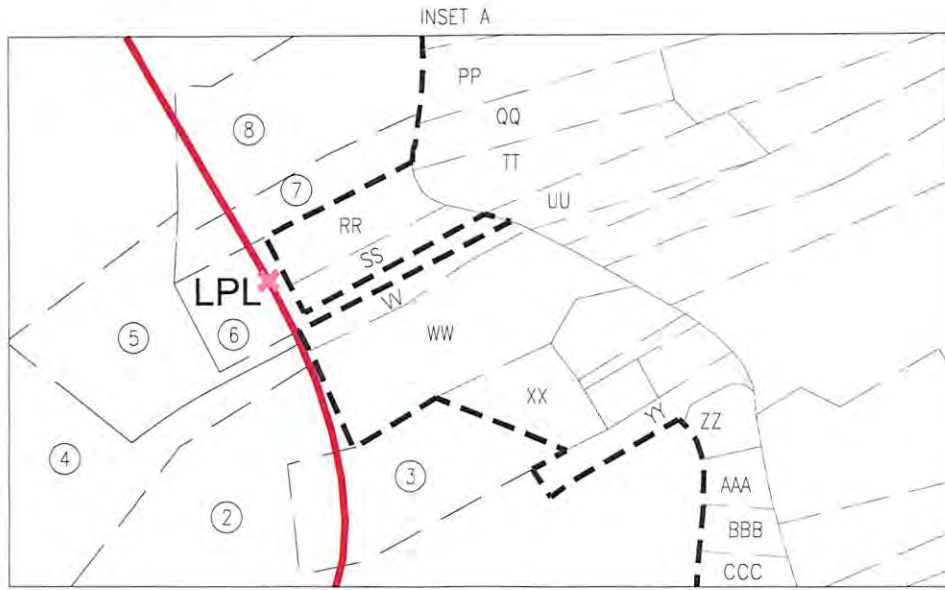

WELL BORE TABLE FOR SURFACE / ROYALTY OWNERS				ADJOINING OWNERS TABLE			
TRACT	SURFACE OWNER (S) / ROYALTY OWNER (R)	TAX PARCEL	ACRES	TRACT	SURFACE OWNER	TAX PARCEL	ACRES
1	DOROTHY V. FRYE (S/R)	06-T14-01	105.00	S	RICHARD HENRY & REBECCA HENRY	06-T3-26	3.58
2	GEORGE L. DUNN & NANCY M. DUNN (S)	06-T9-20	78.076	T	RANDAL ALAN HOWARD	06-T8-16	5.68
3	CHRISTOPHER R. DUNN & TANAKA H. DUNN (S)	06-T9-20.46	1.86	U	EARL THOMAS BEABOUT JR.	06-T9-1.2	2.185
4	SARAH ANN PORTER (S)	06-T9-20.44	4.545	V	ALLEN L. GELLNER & D.M. GELLNER	06-T9-01	3.173
5	PHILLIP MARQUART & KERSTEN MARQUART (S)	06-T9-20.45	1.88	W	LINDA M. ORR & ROBERT BRADY	06-T9-13.11	1.508
6	NICOLE SEIFERT & JAMIE SEIFERT (S)	06-T9-20.51	1.015	X	THOMAS D. STRICKLIN	06-T9-13.7	0.532
7	PATRICIA R. KIRCHNER (S)	06-T9-20.39	1.0	Y	THOMAS D. STRICKLIN	06-T9-13.6	1.82
8	PATRICIA R. KIRCHNER & DONNA K. DUNN (S)	06-T9-20.18	2.46	Z	ROGER FADER	06-T9-13.5	0.479
9	DOROTHY MAE SAMPSON (S)	06-T9-17	23.56	AA	DOUGLAS BLANCO & AUDREY BLANCO	06-T9-12	0.535
10	DALLAS PIKE CAMPGROUND INC. (S)	06-T9-16	53.119	BB	FREDERICK H. TUSTIN & CARLA J. FREDRICK	06-T9-15.4	0.442
11	DALLAS PIKE CAMPGROUND INC. (S)	06-T9-15	1.877	CC	WENDY JO ELDRIDGE & J.L. ELDRIDGE	06-T9-15.7	0.534
12	DALLAS PIKE CAMPGROUND INC. & FREDERICK H. TUSTIN (S)	1-70		DD	GOKUL INC. OF WV	06-T9-14	5.563
13	FREDERICK H. TUSTIN (S)	06-T9-15.1	1.646	EE	LINDA M. ORR & ROBERT BRADY	06-T9-13	7.88
14	EDWARD D. GARRISON (S)	06-T9-11	2.02	FF	PHILIP VERCELLOTTI & F.J. VERCELLOTTI	06-T9-17.7	2.2326
15	MARGARET TUSTIN GREENWALD KLUG (S)	06-T9-09	1.00	GG	CHEROKEE TRADING POST, INC.	06-T9-17.6	4.484
16	ALICIA A. COAD & CHRISTOPHER T. BURGESS (S)	06-T9-08	3.26	HH	VAN A. SAMPSON & B.M. SAMPSON	06-T9-17.8	1.0
17	KENNETH M. PARKER (S)	06-T8-22	6.93	II	DOROTHY M. SAMPSON	06-T9-17.5	0.17
18	MARY F. MCGRATH (S)	06-T8-15.1	1.17	JJ	DOROTHY M. SAMPSON	06-T9-18	0.80
19	JOEL GEORGE MCFARLAND, BRIAN N. MILAN & DON EARL MCFARLAND (S)	06-T8-13	13.75	KK	BRIDGET D. MURRAY & DAVID S. MURRAY	06-T9-17.4	1.21
20	JOEL GEORGE MCFARLAND, BRIAN N. MILAN & DON EARL MCFARLAND (S)	06-T8-12	27.5	LL	FLOYD L. WENSEL & M. WENSEL	06-T9-17.3	0.88
21	KEVIN S. KOSEM & BRENDA A. KOSEM (S)	06-T3-27	164.525	MM	BRIAN D. DOLENCE & DONNA J. DOLENCE	06-T9-17.1	1.04
22	CLYDE E. MCCORD LIFE ESTATE & MELODY E. GARRISON REMAINDERMAN (S)	06-T3-20	45.00	NN	LEONA L. KIRCHNER	06-T9-20.22	0.35
				OO	EVELYN BETH DEGENNARO C/O WESBANCO TRUST DEPT.	06-T9-20.3	2.01
				PP	JEREMY A. DAVIS & AUTUMN L. DAVIS	06-T9-20.17	1.74
				QQ	JAMES E. DUNN & D.M. DUNN	06-T9-20.16	0.9859
				RR	WILLIAM C. SCHUETZ	06-T9-20.6	0.638
				SS	WILLIAM C. SCHUETZ & SANDRA SCHUETZ	06-T9-20.5	0.0391
				TT	JAMES E. DUNN & D.M. DUNN	06-T9-20.8	0.805
				UU	DAVID A. WILLIAMS & JANIE G. WILLIAMS	06-T9-20.11	0.997
				VV	SARAH ANN PORTER	06-T9-20.41	0.385
				WW	NANCY DUNN	06-T9-20.2	1.823
				XX	CONSTANCE L. KERCHER	06-T9-20.49	0.746
				YY	GEORGE L. DUNN & NANCY M. DUNN	06-T9-20.50	0.52
				ZZ	JAMES L. ABERCROMBIE & DIANA L. ABERCROMBIE	06-T9-20.30	0.298
				AAA	JAMES L. ABERCROMBIE & DIANA L. ABERCROMBIE	06-T9-20.29	0.2436
				BBB	ROBERT J. ALOE	06-T9-20.23	0.2383
				CCC	DANIEL L. WHEELER	06-T9-20.31	0.2673
				DDD	DANIEL L. WHEELER	06-T9-20.26	0.110
				EEE	DANIEL L. WHEELER	06-T9-20.37	0.248
				FFF	BRENT A. HILL & PATTY J. HILL	06-T9-20.47	0.285
				GGG	BRENT A. HILL & PATTY J. HILL	06-T9-20.32	0.460
				HHH	DONALD W. PEGG & J.L. PEGG	06-T9-20.1	1.848
				III	GARY FLANEGIN	06-T9-20.20	1.202
				JJJ	MICHAEL W. NASH & C.J. NASH	06-T9-20.19	0.9315
				KKK	LISA A. OLIVER	06-T9-20.21	0.8468

REVISIONS:	COMPANY:			47-069-00231 07/21/2017 R-V A
	OPERATOR'S	CHARLES FRYE OHI		DATE: 04-21-2017
	WELL #:	405H		DRAWN BY: N. MANO
	DISTRICT:	COUNTY:	STATE:	SCALE: N/A
	TRIADELPHIA	OHIO	WV	DRAWING NO:
				WELL LOCATION PLAT 2

WVDEP OOG JUL 20 2017