

SHL Latitude: 40°10'00" 0,000
 BHL Latitude: 40°10'00" 5,762'

RETTEW

RETTEW Associates, Inc.
 27 Travato Street, Suite 101
 Bridgeport, WV 26330
 Phone (800) 738-8395
 Email: rettetw@rettetw.com
 Website: www.rettetw.com

LINE	DESCRIPTION	DISTANCE	DESCRIPTION	MONUMENT
L1	N 43°23'50" E	1,961.13'	SHL TO LANDMARK	
L2	S 80°34'35" W	1,024.69'	SHL TO LANDMARK	
L3	S 31°52'36" W	70.27'	SHL TO REF. PNT.	1/2" REBAR SET
L4	S 36°34'44" E	40.88'	SHL TO REF. PNT.	1/2" REBAR SET
L5	S 42°45'24" W	1,330.34'	SHL TO LP	
L6	S 19°49'45" E	5,497.42'	LP TO BHL	
L7	S 31°47'18" W	14.03'	SHL TO BH	

SURFACE HOLE LOCATION (SHL):
UTM (NAD83, ZONE 17, METERS)
NORTHING: 4,444,681.253
EASTING: 540,546.584
LANDING POINT LOCATION (LPL):
UTM (NAD83, ZONE 17, METERS)
NORTHING: 4,444,383.527
EASTING: 540,271.303
BOTTOM HOLE LOCATION (BHL):
UTM (NAD83, ZONE 17, METERS)
NORTHING: 4,442,807.259
EASTING: 540,839.698

GRID NORTH
 UTM, NAD83 DATUM, ZONE 17, US FT

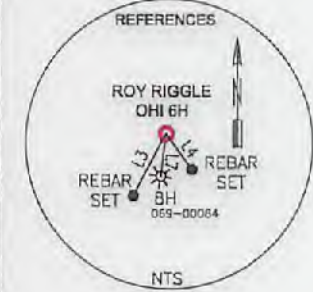
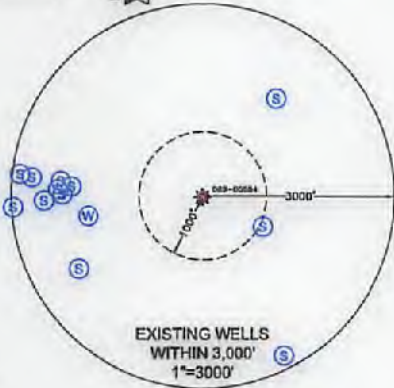

NOTES ON SURVEY

- COORDINATES SYSTEM IS UTM, NAD 83 DATUM, ZONE 17, U.S. FOOT AND WELL COORDINATES ESTABLISHED USING SURVEY GRADE GPS.
- SURFACE AND ROYALTY OWNER INFORMATION AND THEIR BOUNDARIES SHOWN HEREON WERE PLOTTED FROM DEEDS AND/OR TAX PARCEL MAPS PROVIDED BY CLIENT AND FIELD LOCATIONS.
- THIS PLAT DOES NOT REPRESENT A BOUNDARY SURVEY OF THE PARCELS SHOWN HEREON.
- NO DWELLINGS AND BUILDINGS WITHIN 625 FEET OF PROPOSED CENTER OF PAD.
- NO WATER WELLS OR DEVELOPED SPRINGS WITHIN 250 FEET OF PROPOSED WELL.
- NO PERENNIAL STREAMS, LAKES, PONDS, RESERVOIRS OR WETLANDS WITHIN 100 FEET OF THE LIMITS OF DISTURBANCE.
- NO NATURALLY PRODUCING TROUT STREAM WITHIN 300 FEET OF LIMITS OF DISTURBANCE.

I, THE UNDERSIGNED, HEREBY CERTIFY THAT THIS PLAT IS CORRECT TO THE BEST OF MY KNOWLEDGE AND BELIEF AND SHOWS ALL THE INFORMATION REQUIRED BY LAW AND REGULATIONS ISSUED AND PRESCRIBED BY THE DEPARTMENT OF ENVIRONMENTAL PROTECTION.

P.S. 2241

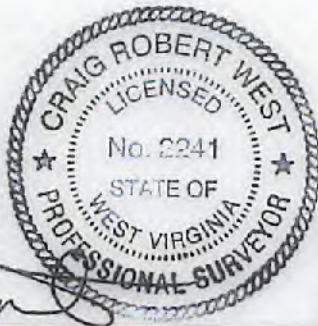

(+) DENOTES LOCATION OF WELL ON UNITED STATES TOPOGRAPHIC MAPS
 WVDEP
 OFFICE OF OIL & GAS
 601 57TH STREET
 CHARLESTON, WV 25034

MINIMUM DEGREE OF ACCURACY: 1/200
 PROVEN SURVEY SOURCE OF GRADE GPS ELEVATION: (NAVD 88, US FT)

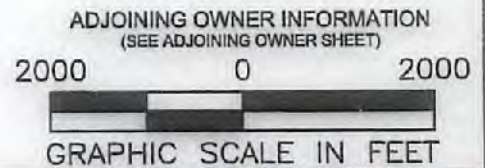
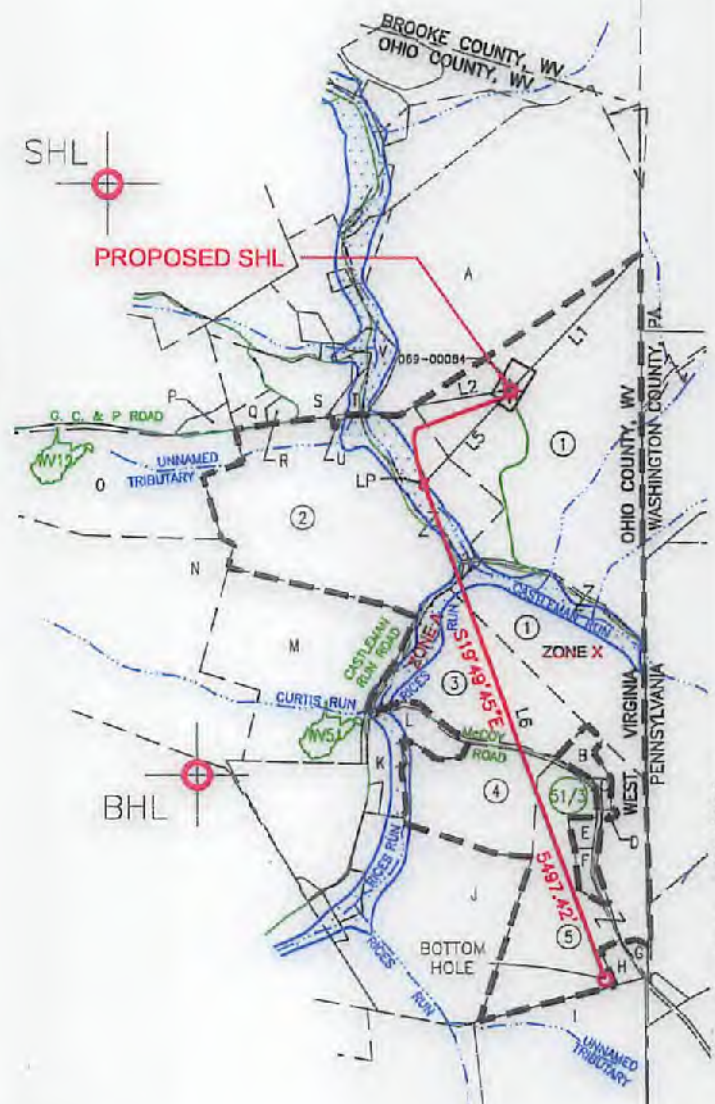

COMPANY: **SWN** Production Company, LLC

ROY RIGGLE OHI
 OPERATOR'S WELL #: 6H
 API WELL #: 47 069 00253
 STATE COUNTY PERMIT

WELL TYPE: OIL WASTE DISPOSAL PRODUCTION DEEP GAS LIQUID INJECTION STORAGE SHALLOW

WATERSHED: CASTLEMAN RUN ELEVATION: 1,252.2± (AS-BUILT)
 DISTRICT: LIBERTY COUNTY: OHIO QUADRANGLE: BETHANY, WV-PA
 SURFACE OWNER: ROY & DEBRA R. RIGGLE ACREAGE: 171.18±
 OIL & GAS ROYALTY OWNER: ROY & DEBRA R. RIGGLE ACREAGE: 171.18±

DRILL DRILL DEEPER REDRILL FRACTURE OR STIMULATE PLUG OFF OLD FORMATION PERFORATE NEW FORMATION
 CONVERT PLUG & ABANDON CLEAN OUT & REPLUG OTHER CHANGE (SPECIFY) _____
 TARGET FORMATION: MARCELLUS ESTIMATED DEPTH: 6,542' TVD 12,429' TMD

WELL OPERATOR: SWN PRODUCTION COMPANY, LLC DESIGNATED AGENT: DEE SOUTHALL
 ADDRESS: P.O. BOX 1300 ADDRESS: P.O. BOX 1300
 CITY: JANE LEW STATE: WV ZIP CODE: 26378 CITY: JANE LEW STATE: WV ZIP CODE: 26378

LEGEND:	REVISIONS:	DATE:
PROPOSED SURFACE HOLE / BOTTOM HOLE EXISTING / PRODUCING WELLHEAD ABANDONED WELL PLUGGED & ABANDONED WELL CUT CONDUCTOR	EXISTING SPRING EXISTING WATER WELL TIE LINE LEASE BOUNDARY MARCELLUS DHP ABANDONED PATH	08-14-2017 DRAWN BY: W. MCCLEAF SCALE: 1" = 200' DRAWING NO: 087569043 WELL LOCATION PLAT



RETTEW Associates, Inc.
27 Travata Street, Suite 101
Bridgeport, WV 28330
Phone (800) 738-8395
Email: rette@rette.com
Website: www.rettew.com

**FINAL
OPERATIONS
TEAM Review
06-14-2017**

GRID NORTH
UTM, NAD83 DATUM, ZONE 17, US FT

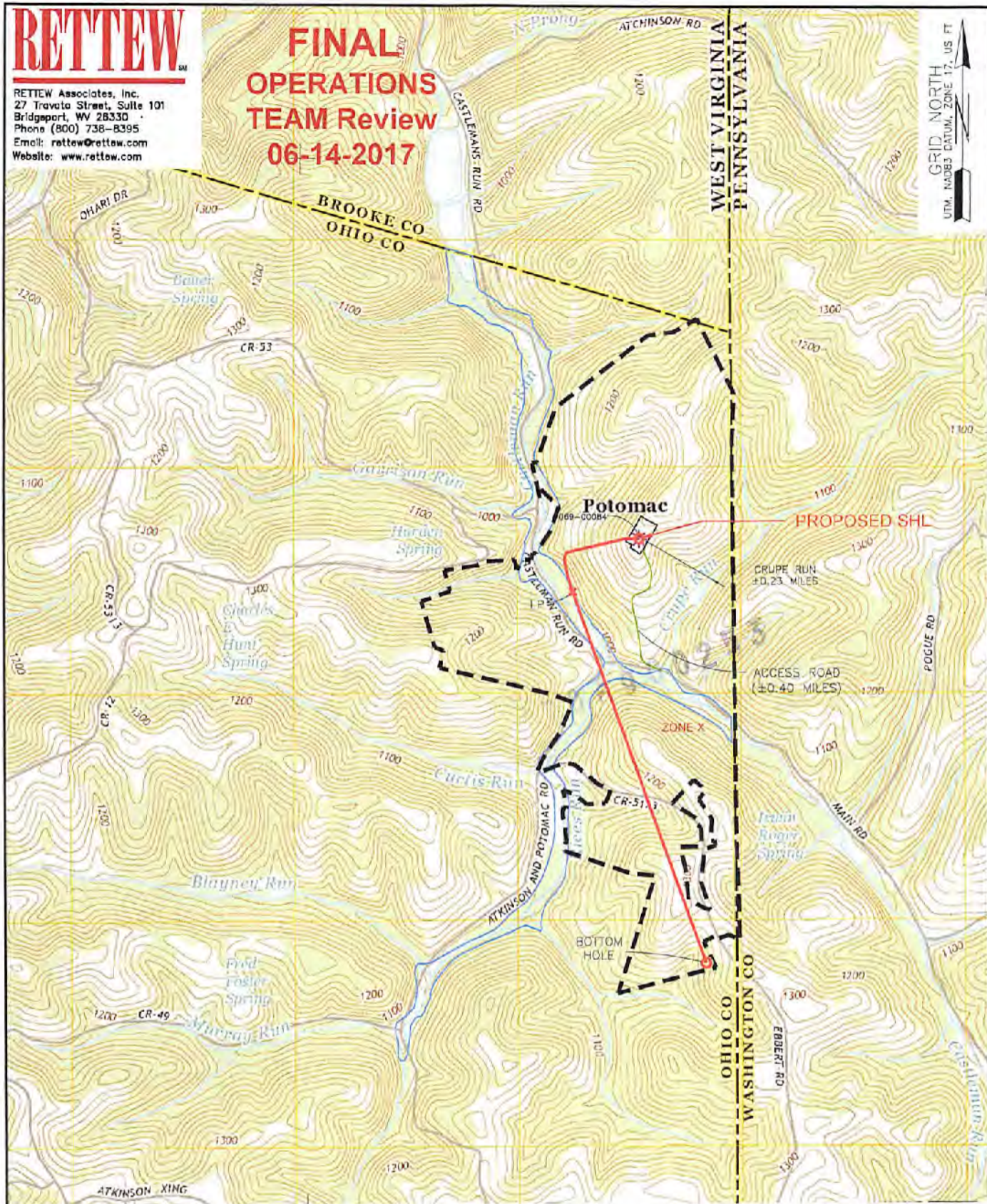

2000 0 2000

WELL: ROY RIGGLE OHI 6H
QUAD: BETHANY, WV-PA

GRAPHIC SCALE IN FEET

<p>NAME AND DISTANCE TO THE NEAREST STREAM: CRUPE RUN IS LOCATED ±0.23 MILES SE OF THE CENTER OF THE DRILL PAD.</p>	<p>STREAM CROSSING COORDINATES (NAD 83): NO NEW CROSSINGS</p>	<p>COMPANY: </p>										
<p>WELL RESTRICTIONS: WELL PAD, LOD, & E & S CONTROL FEATURES TO PERENNIAL STREAM, LAKE, POND, RESERVOIR OR WETLAND: >100 FEET WELL PAD, LOD, & E & S CONTROL FEATURES TO NATURALLY PRODUCING (TRU) STREAM: >300 FEET WELL PAD, LOD, & E & S CONTROL FEATURES TO GROUNDWATER INTAKE OR PUBLIC WATER SUPPLY: >1000 FEET WELL PAD, LOD, & E & S CONTROL FEATURES TO EXISTING WATER WELL OR DEVELOPED SPRING: >250 FEET CENTER OF PAD TO OCCUPIED DWELLING STRUCTURE: >625 FEET CENTER OF PAD TO AGRICULTURAL BUILDINGS LARGER THAN 2500 SQ FT: >625 FEET</p>		<p>OPERATOR'S ROY RIGGLE OHI WELL #: 6H LOCATION: LIBERTY DISTRICT, OHIO COUNTY, WEST VIRGINIA</p>										
<p>FEMA FLOOD INFORMATION: BY GRAPHIC PLOTTING ONLY FEMA FIRM INCORPORATED AREA OF OHIO COUNTY, WEST VIRGINIA; MAP NUMBER 54069C00450; EFFECTIVE DATE: JULY 17, 2006.</p>		<p>SURFACE HOLE LOCATION: RECEIVED Office of Oil and Gas GEOGRAPHIC (NAD83): LATITUDE: 40.151502° LONGITUDE: -80.523939° BOTTOM HOLE LOCATION: GEOGRAPHIC (NAD83): LATITUDE: 40.134804° LONGITUDE: -80.520616° AUG 17 2017 WV Department of Environmental Protection</p>										
<p>LEGEND: PROPOSED SURFACE HOLE / BOTTOM HOLE EXISTING / PRODUCING WELLHEAD ABANDONED WELL PLUGGED & ABANDONED WELL CUT CONDUCTOR ACCESS ROAD ACCESS ROAD TO PREV. SITE HIGHWAY/INTERSTATE COUNTY ROAD</p>		<p>REVISIONS: <table border="1"> <tr><td> </td><td>DATE: 05-30-2017</td></tr> <tr><td> </td><td>DRAWN BY: W. MCCLEAF</td></tr> <tr><td> </td><td>SCALE: 1" = 2000'</td></tr> <tr><td> </td><td>DRAWING NO: 087569043</td></tr> <tr><td> </td><td>TOPOGRAPHIC MAP</td></tr> </table></p>		DATE: 05-30-2017		DRAWN BY: W. MCCLEAF		SCALE: 1" = 2000'		DRAWING NO: 087569043		TOPOGRAPHIC MAP
	DATE: 05-30-2017											
	DRAWN BY: W. MCCLEAF											
	SCALE: 1" = 2000'											
	DRAWING NO: 087569043											
	TOPOGRAPHIC MAP											