

State of West Virginia  
Department of Environmental Protection - Office of Oil and Gas  
Well Operator's Report of Well Work

API 47 - 069 - 00268 County OHIO District TRIADELPHIA  
Quad WHEELING, WV Pad Name TIMMY MINCH-OHI-PAD1 Field/Pool Name PANHANDLE FIELD WET  
Farm name TIMMY B. MINCH & AMY L. MINCH Well Number TIMMY MINCH OHI 6H  
Operator (as registered with the OOG) SWN PRODUCTION COMPANY, LLC  
Address PO BOX 12359 City SPRING State TX Zip 77391-2359

As Drilled location NAD 83/UTM Attach an as-drilled plat, profile view, and deviation survey  
Top hole Northing 4,437,279.326 Easting 530,157.623  
Landing Point of Curve Northing 4,436,890.848 Easting 529,711.273  
Bottom Hole Northing 4,433,511.372 Easting 531,200.560

Elevation (ft) 1208.2' GL Type of Well  New  Existing Type of Report  Interim  Final  
Permit Type  Deviated  Horizontal  Horizontal 6A  Vertical Depth Type  Deep  Shallow  
Type of Operation  Convert  Deepen  Drill  Plug Back  Redrilling  Rework  Stimulate  
Well Type  Brine Disposal  CBM  Gas  Oil  Secondary Recovery  Solution Mining  Storage  Other \_\_\_\_\_  
Type of Completion  Single  Multiple Fluids Produced  Brine  Gas  NGL  Oil  Other \_\_\_\_\_  
Drilled with  Cable  Rotary

Drilling Media Surface hole  Air  Mud  Fresh Water Intermediate hole  Air  Mud  Fresh Water  Brine  
Production hole  Air  Mud  Fresh Water  Brine  
Mud Type(s) and Additive(s)  
SOBM

Date permit issued 04/19/2018 Date drilling commenced 9/23/2018 Date drilling ceased 10/6/2018  
Date completion activities began 1/10/2019 Date completion activities ceased 3/19/2019  
Verbal plugging (Y/N) N Date permission granted N/A Granted by N/A

RECEIVED  
Office of Oil and Gas

Please note: Operator is required to submit a plugging application within 5 days of verbal permission to plug

JUN 18 2019

Freshwater depth(s) ft 306' Open mine(s) (Y/N) depths N  
Salt water depth(s) ft 619' Void(s) encountered (Y/N) depths N  
Coal depth(s) ft 467' Cavern(s) encountered (Y/N) depths N  
Is coal being mined in area (Y/N) N

WV Department of  
Environmental Protection

Reviewed  
C-AD 9-9-19

Reviewed by:  
89919

API 47-069 - 00268 Farm name TIMMY B. MINCH & AMY L. MINCH Well number TIMMY MINCH OHI 6H

CASING STRINGS	Hole Size	Casing Size	Depth	New or Used	Grade wt/ft	Basket Depth(s)	Did cement circulate (Y/N) * Provide details below*
Conductor	24	20	126'	NEW	J-55/94#		Y
Surface	17.5	13.375	572'	NEW	J-55/54.5#	489.3'/448.9'	Y
Coal	SEE SURFACE						
Intermediate 1	12.25	9.625	1,917'	NEW	J-55/36#		Y
Intermediate 2							
Intermediate 3							
Production	8.75/8.50	5.5	19,033'	NEW	HCP-110/20#		Y
Tubing		2.375	6,833'	NEW	L-80/4.7#		N
Packer type and depth set							

Comment Details \_\_\_\_\_

CEMENT DATA	Class/Type of Cement	Number of Sacks	Slurry wt (ppg)	Yield (ft <sup>3</sup> /sks)	Volume (ft <sup>3</sup> )	Cement Top (MD)	WOC (hrs)
Conductor	CLASS A	GROUT TO SURFACE				SURFACE	24
Surface	CLASS A	473	15.60	1.20	567.6	SURFACE	8
Coal	SEE SURFACE						
Intermediate 1	CLASS A	742	15.60	1.19	882.98	SURFACE	8
Intermediate 2							
Intermediate 3							
Production	CLASS A	3,716	15.60	1.19	4,422.04	SURFACE	24
Tubing							

Drillers TD (ft) 19,033' Loggers TD (ft) 19,033'  
 Deepest formation penetrated MARCELLUS Plug back to (ft) N/A  
 Plug back procedure N/A

Kick off depth (ft) 5,636'

Check all wireline logs run  caliper  density  deviated/directional  induction  
 neutron  resistivity  gamma ray  temperature  sonic

Well cored  Yes  No Conventional Sidewall Were cuttings collected  Yes  No

DESCRIBE THE CENTRALIZER PLACEMENT USED FOR EACH CASING STRING \_\_\_\_\_

SURFACE: 7 CENTRALIZERS - EVERY THIRD JOINT OF CASING  
 INTERMEDIATE: 24 CENTRALIZERS - EVERY THIRD JOINT OF CASING  
 PRODUCTION: 181 CENTRALIZERS - EVERY THIRD JOINT FROM SURFACE TO TOP OF CURVE, THEN EVERY JOINT UNTIL TD

WAS WELL COMPLETED AS SHOT HOLE  Yes  No DETAILS \_\_\_\_\_

RECEIVED  
Office of Oil and Gas

WAS WELL COMPLETED OPEN HOLE?  Yes  No DETAILS \_\_\_\_\_

JUN 18 2019

WERE TRACERS USED  Yes  No TYPE OF TRACER(S) USED \_\_\_\_\_

WV Department of  
Environmental Protection

API 47-069-00268 Farm name TIMMY B. MINCH & AMY L. MINCH Well number TIMMY MINCH OHI 6H

**PERFORATION RECORD**

Stage No.	Perforation date	Perforated from MD ft.	Perforated to MD ft.	Number of Perforations	Formation(s)
	SEE	ATTACHMENT	1		

Please insert additional pages as applicable.

**STIMULATION INFORMATION PER STAGE**

Complete a separate record for each stimulation stage.

Stage No.	Stimulations Date	Ave Pump Rate (BPM)	Ave Treatment Pressure (PSI)	Max Breakdown Pressure (PSI)	ISIP (PSI)	Amount of Proppant (lbs)	Amount of Water (bbls)	Amount of Nitrogen/other (units)
	SEE	ATTACHMENT	2					

**RECEIVED**  
 Office of Oil and Gas  
 JUN 18 2019

Please insert additional pages as applicable.

API 47- 069 - 00268 Farm name TIMMY B. MINCH & AMY L. MINCH Well number TIMMY MINCH OHI 6H

<u>PRODUCING FORMATION(S)</u>	<u>DEPTHS</u>	
<u>MARCELLUS</u>	<u>6,076'</u> TVD	<u>6,655'</u> MD
_____	_____	_____
_____	_____	_____
_____	_____	_____

Please insert additional pages as applicable.

GAS TEST  Build up  Drawdown  Open Flow OIL TEST  Flow  Pump  
 SHUT-IN PRESSURE Surface \_\_\_\_\_ psi Bottom Hole \_\_\_\_\_ psi DURATION OF TEST \_\_\_\_\_ hrs  
 OPEN FLOW Gas \_\_\_\_\_ mcfpd Oil \_\_\_\_\_ bpd NGL \_\_\_\_\_ bpd Water \_\_\_\_\_ bpd GAS MEASURED BY  
 Estimated  Orifice  Pilot

<u>LITHOLOGY/ FORMATION</u>	<u>TOP</u>	<u>BOTTOM</u>	<u>TOP</u>	<u>BOTTOM</u>	<u>DESCRIBE ROCK TYPE AND RECORD QUANTITY AND TYPE OF FLUID (FRESHWATER, BRINE, OIL, GAS, H<sub>2</sub>S, ETC)</u>
	<u>DEPTH IN FT NAME TVD</u>	<u>DEPTH IN FT TVD</u>	<u>DEPTH IN FT MD</u>	<u>DEPTH IN FT MD</u>	
	<u>0</u>		<u>0</u>		
	<u>SEE</u>	<u>ATTACHMENT</u>	<u>3</u>		

Please insert additional pages as applicable.

Drilling Contractor SWN DRILLING COMPANY  
 Address PO BOX 12359 City SPRING State TX Zip 77391-2359  
 Logging Company BAKER HUGHES  
 Address 9110 GROGANS MILL RD City THE WOODLANDS State TX Zip 77380  
 Cementing Company B J SERVICES  
 Address 11211 FM 2920 City TOMBALL State TX Zip 77377  
 Stimulating Company HALLIBURTON ENERGY SERVICES  
 Address 14851 MILNER ROAD, GATE 5A City HOUSTON State TX Zip 77032

Please insert additional pages as applicable.

Completed by BOBBY WILLIS Telephone 832-796-2884  
 Signature [Signature] Title SENIOR REGULATORY ANALYST Date 6/17/2019

RECEIVED  
Office of Oil and Gas  
JUN 18 2019

Submittal of Hydraulic Fracturing Chemical Disclosure Information Attach copy of FRACFOCUS Registry

# Hydraulic Fracturing Fluid Product Component Information Disclosure

Job Start Date:	2/12/2019
Job End Date:	3/12/2019
State:	West Virginia
County:	Ohio
API Number:	47-069-00268-00-00
Operator Name:	Southwestern Energy
Well Name and Number:	Timmy Minch OH1 6H
Latitude:	40.08522520
Longitude:	-80.64260290
Datum:	NAD83
Federal Well:	NO
Indian Well:	NO
True Vertical Depth:	6,270
Total Base Water Volume (gal):	18,622,149
Total Base Non Water Volume:	0

## Hydraulic Fracturing Fluid Composition:

Trade Name	Supplier	Purpose	Ingredients	Chemical Abstract Service Number (CAS #)	Maximum Ingredient Concentration in Additive (% by mass)**	Maximum Ingredient Concentration in HF Fluid (% by mass)**	Comments
Fresh Water	Operator	Base Fluid	Water	7732-18-5	100.00000	83.05657	Density = 8.340
Water	Operator	Carrier	Water	7732-18-5	100.00000	2.41647	



RECEIVED  
Office of Oil and Gas

JUL 29 2019

WV Department of  
Environmental Protection

Ingredients	Listed Above	Listed Above						
			Water	7732-18-5	100.00000	0.82677		
			Water	7732-18-5	95.00000	0.02778		
FRW-15A	BJ Services	Friction Reducer						
				Listed Below				
BE-9W	Halliburton	Biocide						
				Listed Below				
FraCare SI-01	BJ Services	Scale Inhibitor						
				Listed Below				
Sand, White	BJ Services	Proppant						
				Listed Below				
FRW-18	BJ Services	Friction Reducer						
				Listed Below				
SAND-COMMON WHITE-100 MESH, SSA-2	Halliburton	Proppant						
				Listed Below				
SCAL16486A	Nalco	Scale Inhibitor						
				Listed Below				

RECEIVED  
Office of Oil and Gas  
JUL 29 2019  
WV Department of Environment

BIOC11139A	BJ Services	Biocide		Listed Below				
FSTI-CI-01	FSTI	Acid Corrosion Inhibitor		Listed Below				
CALCIUM CHLORIDE - FLAKE	Halliburton	Additive		Listed Below				
FSTI-IC-001	FSTI	Iron Control Agent		Listed Below				
HYDROCHLORIC ACID	Halliburton	Solvent		Listed Below				
SAND-PREMIUM WHITE-40/70	Halliburton	Proppant		Listed Below				
15% HCl	BJ Services	Acid		Listed Below				
Excellerate LX-1	Halliburton	Friction Reducer		Listed Below				
<p>Items above are Trade Names with the exception of Base Water. Items below are the individual ingredients.</p>								
			Crystalline silica, quartz	14808-60-7	100.00000	13.33054		

RECEIVED  
Office of Oil and Gas  
JUL 29 2019  
WV Department of  
Environmental Protection

				Crystalline Silica (Quartz)	14808-60-7	100.00000	0.28233	
				Hydrochloric acid	7647-01-0	15.00000	0.11524	
				Hydrotreated light petroleum distillate	64742-47-8	30.00000	0.02544	
				Polyacrylate	Proprietary	30.00000	0.02544	
				Fatty acid ester	Proprietary	5.00000	0.00848	
				Acetic acid	64-19-7	60.00000	0.00573	
				Hydrochloric acid	7647-01-0	15.00000	0.00478	
				Propylene glycol	57-55-6	60.00000	0.00452	
				Sodium chloride	7647-14-5	5.00000	0.00425	
				Sorbitan, mono-9-octadecenoate, (Z)	1338-43-8	5.00000	0.00424	
				Ethoxylated fatty acid	Proprietary	5.00000	0.00424	
				9-Octadecenamide, n,n-bis-2-(hydroxy-ethyl)-(Z)	93-83-4	5.00000	0.00424	
				Ammonium chloride	12125-02-9	5.00000	0.00424	
				Castor oil, ethoxylated	61791-12-6	5.00000	0.00424	
				Citric acid	77-92-9	40.00000	0.00382	
				Methanol	67-56-1	80.00000	0.00214	
				Amine Triphosphate	Proprietary	30.00000	0.00198	
				Ethylene Glycol	107-21-1	30.00000	0.00198	
				Tributyl tetradecyl phosphonium chloride	81741-28-8	10.00000	0.00075	
				Copolymer of Acrylamide and Sodium Acrylate	25987-30-8	40.00000	0.00051	
				Hydrotreated Light Distillate	64742-47-8	30.00000	0.00038	
				Calcium chloride	10043-52-4	100.00000	0.00028	
				Fatty acids	Trade Secret	10.00000	0.00027	
				Poly (acrylamide-co-acrylic acid) partial sodium salt	62649-23-4	30.00000	0.00018	

RECEIVED  
Office of Oil and Gas  
JUL 29 2019  
WV Department of  
Environmental Protection

Denise Tuck,  
Halliburton, 3000 N.  
Sam Houston Pkwy E.,  
Houston, TX 77032,  
281-871-6226



			Petroleum Distillates	64742-47-8	30.00000	0.00018	
			Benzyl-(C12-C16 Alkyl)- Dimethyl-Ammonium Chloride	68424-85-1	30.00000	0.00014	
			Sorbitan Monooleate	1338-43-8	5.00000	0.00007	
			Nonyl Phenol Ethoxylate	127087-87-0	5.00000	0.00006	
			Glutaraldehyde	111-30-8	10.00000	0.00005	
			Sodium Chloride	7647-14-5	5.00000	0.00003	
			Ethanol	64-17-5	5.00000	0.00002	
			Strontium chloride	10476-85-4	5.00000	0.00001	
			Potassium chloride	7447-40-7	5.00000	0.00001	
			Ethoxylated Alcohol	68551-12-2	2.00000	0.00001	
			Oleamide DEA	93-83-4	2.00000	0.00001	
			Organo phosphorus salt	71050-62-9	5.00000	0.00001	
			Ammonium Chloride	12125-02-9	3.00000	0.00001	
			Polyoxythylene Sorbitan Monooleate	9005-65-6	0.50000	0.00000	

RECEIVED  
Office of Oil and Gas  
JUL 29 2019  
WV Department of  
Environmental Protection

\* Total Water Volume sources may include various types of water including fresh water, produced water, and recycled water

\*\* Information is based on the maximum potential for concentration and thus the total may be over 100%

\*\*\* If you are calculating a percentage of total ingredients do not add the water volume below the green line to the water volume above the green line

Note: For Field Development Products (products that begin with FDP), MSDS level only information has been provided.

Ingredient information for chemicals subject to 29 CFR 1910.1200(i) and Appendix D are obtained from suppliers Material Safety Data Sheets (MSDS)



Well Name: Timmy Minch OHI 6H

Attachment 3

LITHOLOGY/FORMATION	TOP DEPTH, MD (FT)	TOP DEPTH, TVD (FT)	BOTTOM DEPTH, MD (FT)	BOTTOM DEPTH, TVD (FT)	QUANTITY AND TYPE OF FLUID
Base of Fresh Water	0.00	0.00	306.00	306.00	
Top of Salt Water	619.00	619.00	NA	NA	
Pittsburgh Coal	467.00	467.00	480.00	480.00	
Pottsville (ss)	634.00	634.00	663.00	663.00	
Raven Cliff (ss)	930.00	930.00	1378.00	1378.00	
Maxton (ss)	1378.00	1378.00	1624.00	1624.00	
Big Injun (ss)	1624.00	1624.00	6206.00	5648.00	
Rhinstreet (shale)	5912.00	5574.00	6238.00	5841.00	
Middlesex (shale)	6238.00	5841.00	6340.00	5914.00	
Burket (shale)	6340.00	5914.00	6368.00	5933.00	
Tully (ls)	6368.00	5933.00	6447.00	5981.00	
Mahantango (shale)	6447.00	5981.00	6655.00	6076.00	
Marcellus (shale)	6655.00	6076.00	NA	NA	GAS

RECEIVED  
Office of Oil and Gas

JUN 18 2019

WV Department of  
Environmental Protection

**JACKSON SURVEYING INC.**  
 P.O. Box 1460  
 677 W. Main St.  
 Clarksburg, WV 26302  
 304-623-5851

<b>SURFACE HOLE LOCATION (SHL):</b>
UTM (NAD83, ZONE 17, METERS): NORTHING: 4,437,279.326 EASTING: 530,157.623
<b>LANDING POINT (LPL):</b>
UTM (NAD83, ZONE 17, METERS): NORTHING: 4,436,890.848 EASTING: 529,711.273
<b>BOTTOM HOLE LOCATION (BHL):</b>
UTM (NAD83, ZONE 17, METERS): NORTHING: 4,433,511.372 EASTING: 531,200.560

GRID NORTH  
 UTM, NAD83 DATUM, ZONE 17, US FT

Latitude: 40°07'30" SURFACE HOLE 5945'

Latitude: 40°05'00" BOTTOM HOLE 2,577'

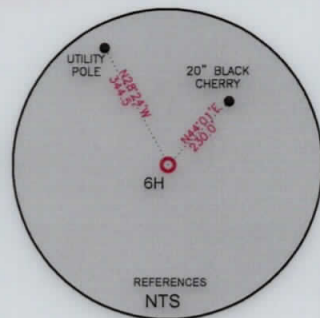

<b>SURFACE HOLE LOCATION (SHL):</b>
UTM (NAD83, ZONE 17, METERS): NORTHING: 4,437,279.368 EASTING: 530,157.565
<b>LANDING POINT (LPL):</b>
UTM (NAD83, ZONE 17, METERS): NORTHING: 4,436,925.400 EASTING: 529,698.953
<b>BOTTOM HOLE LOCATION (BHL):</b>
UTM (NAD83, ZONE 17, METERS): NORTHING: 4,433,512.755 EASTING: 531,199.416

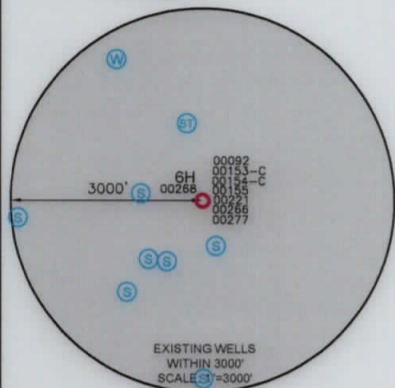
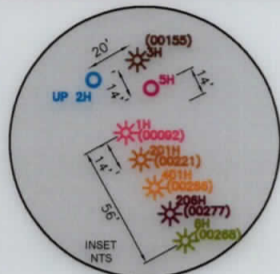

LINE	BEARING	DISTANCE	DESCRIPTION	MONUMENT
L1	N 11°48'57" E	1441.18'	SHL TO LANDMARK	FD. 5/8" REBAR
L2	N 55°23'10" E	1208.74'	SHL TO LANDMARK	FD. 5/8" REBAR
LINE	BEARING	DISTANCE	CURVE LENGTH	DESCRIPTION
L3	S 48°57'56" W	1,941.36'	2449.10'	SHL TO LP

**WELL RESTRICTIONS**

- NO OCCUPIED DWELLINGS > 2500 SQ FT. WITHIN 625 FEET OF CENTER OF PAD.
- NO AGRICULTURE BUILDINGS > 2500 SQ FT. WITHIN 625 FEET OF CENTER OF PAD.
- WATER WELLS OR DEVELOPED SPRINGS ARE WITHIN 250 FEET OF PROPOSED WELL.
- PERENNIAL STREAMS, LAKES, PONDS, OR RESERVOIRS WITHIN 100 FEET OF THE LIMITS OF DISTURBANCE.
- NO NATURALLY PRODUCING TROUT STREAM WITHIN 300 FEET OF LIMITS OF DISTURBANCE.
- NO GROUND INTAKE OR PUBLIC WATER SUPPLY WITHIN 1000 FEET OF WELL PAD, LIMITS OF DISTURBANCE, E & S CONTROLS OR PUBLIC WATER SUPPLY.

**NOTES ON SURVEY**

- SURFACE AND ROYALTY OWNER INFORMATION AND THEIR BOUNDARIES SHOWN HEREON WERE PLOTTED FROM DEEDS AND/OR TAX PARCEL MAPS PROVIDED BY CLIENT AND/OR FIELD LOCATIONS.
- THIS PLAT DOES NOT REPRESENT A BOUNDARY SURVEY OF THE PARCELS SHOWN HEREON.
- ALL INSETS ARE GRID NORTH UNLESS OTHERWISE DEPICTED.

I, THE UNDERSIGNED, HEREBY CERTIFY THAT THIS PLAT IS CORRECT TO THE BEST OF MY KNOWLEDGE AND BELIEF AND SHOWS ALL THE INFORMATION REQUIRED BY LAW AND REGULATIONS ISSUED AND PRESCRIBED BY THE DEPARTMENT OF ENVIRONMENTAL PROTECTION.

P.S. 708

*David L. Jackson*

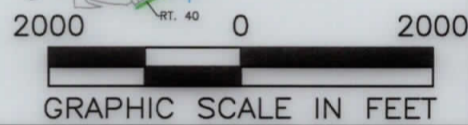
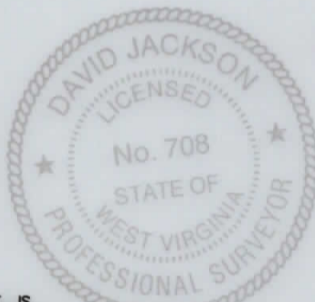

COMPANY: **SWN** Production Company, LLC

OPERATOR'S WELL #:	TIMMY MINCH OHI 6H		
API WELL #:	47	069	00268
	STATE	COUNTY	PERMIT

(+) DENOTES LOCATION OF WELL ON UNITED STATES TOPOGRAPHIC MAPS  
 WVDEP  
 OFFICE OF OIL & GAS  
 601 57TH STREET  
 CHARLESTON, WV 25034

WELL TYPE: OIL  WASTE DISPOSAL  PRODUCTION  DEEP  GAS  LIQUID INJECTION  STORAGE  SHALLOW

WATERSHED: BROWNS RUN OF PETERS RUN OF WHEELING CREEK (HUC-10) ELEVATION: 1208.2'

DISTRICT: TRIADELPHIA COUNTY: OHIO QUADRANGLE: WHEELING, WV

SURFACE OWNER: TIMMY B. MINCH & AMY L. MINCH ACREAGE: ±254.38

OIL & GAS ROYALTY OWNER: TIMMY B. MINCH & AMY L. MINCH ACREAGE: ±254.38

DRILL  DRILL DEEPER  REDRILL  FRACTURE OR STIMULATE  PLUG OFF OLD FORMATION  PERFORATE NEW FORMATION

CONVERT  PLUG & ABANDON  CLEAN OUT & REPLUG  OTHER CHANGE  (SPECIFY) ASDRILLED

TARGET FORMATION: MARCELLUS ESTIMATED DEPTH: 6,273 TVD 19,033 TMD

WELL OPERATOR: SWN PRODUCTION COMPANY, LLC ADDRESS: 1300 FORT PIERPONT ROAD, SUITE 200 CITY: MORGANTOWN STATE: WV ZIP CODE: 26508

DESIGNATED AGENT: BRITTANY WOODY ADDRESS: 1300 FORT PIERPONT ROAD, SUITE 200 CITY: MORGANTOWN STATE: WV ZIP CODE: 26508

<b>LEGEND:</b>	— SURVEYED BOUNDARY	<b>REVISIONS:</b>	DATE: 02-28-2019
○ PROPOSED SURFACE HOLE / BOTTOM HOLE	— DRILLING UNIT		
⊙ EXISTING / PRODUCING WELLHEAD	== LEASE BOUNDARY		
LPL* LANDING POINT LOCATION	— ASDRILLED PATH		
⊙ EXISTING WATER WELL	— PROPOSED PATH		
⊙ EXISTING SPRING			
			DRAWN BY: N. MANO
			SCALE: 1" = 2000'
			DRAWING NO:
			WELL LOCATION PLAT

Longitude: 80°37'30" SURFACE HOLE 11,682'  
 Longitude: 80°37'30" SURFACE HOLE 14,480'

**JACKSON SURVEYING  
INC.**

P.O. Box 1460  
677 W. Main St.  
Clarksburg, WV 26302  
304-623-5851

WELL BORE TABLE FOR SURFACE / ROYALTY OWNERS		
TRACT	SURFACE OWNER (S) / ROYALTY OWNER (R)	TAX PARCEL
1	TIMMY B. MINCH & AMY L. MINCH (S/R)	06-T2-18
TRACT	SURFACE OWNER	TAX PARCEL
2	CHARLES MONFRADI & DOLORES MONFRADI (S)	04-R17-58
3	WILLIAM A. ORUM & CYNTHIA ORUM (S)	06-T7-178
4	FRANCIS L. BRADEN (S)	06-T7-97
5	JAMES D. MILLER JR. & CAROLINE KUCHAR MILLER (S)	06-T7-112
6	YE OLDE COUNTRY CHURCH OF FAITH TRUSTEES (S)	06-T7-112.2
7	J.D. MILLER JR. & CAROLINE K. MILLER (S)	06-T7-117
8	JOHN T. CRISWELL & CATHERINE ANN CRISWELL (S)	06-T7-150.1
9	WILLIAM R. RICKER & KATHY L. RICKER (S)	06-T7-150
10	TERESA GELLNER HULS (S)	06-T7-152
11	JOHN J. CORBETT (S)	06-T7-163
12	JOHN J. CORBETT (S)	06-T12-5
13	MIDDLE CREEK GARAGE INC. (S)	07-TW1-9

ADJOINING OWNERS TABLE			ADJOINING OWNERS TABLE		
TRACT	SURFACE OWNER	TAX PARCEL	TRACT	SURFACE OWNER	TAX PARCEL
A	JON BARRY & JAYMIE BARRY	04-R17D-3	CCC	CHARLES A. BLISS ST. & MARY E. BLISS	06-T7-164
B	V.J. SOVINSKI & H.G. SOVINSKI	04-R17D-28	DDD	CHARLES A. BLISS ST. & MARY E. BLISS	06-T7-164.1
C	J.G. DEEDS & M.K. GARRISON	04-R17D-30	EEE	WILLIAM JAY BRINKMEIER	06-T7-165.1
D	L & B DEVELOPMENT, LLC	04-R17D-1	FFF	EDWARD M. EDGE & CHRISTINE B. EDGE	06-T7-165
E	RONALD J. POCKL	06-T2-20.1	GGG	OHIO VALLEY INDUSTRY & BUSINESS DEVELOPMENT CORPORATION	06-T7-166.1
F	MORGAN A. WOJCHOWSKI	06-T2-20	HHH	GREGORY J. GEORGE & JENNIFER S. GEORGE	06-T7-163.19
G	SHAWN A. HODGSON & LESLIE G. HODGSON	04-R17-62	III	MIDDLE CREEK GARAGE, INC.	06-T7-166
H	DANNY MINCH & GINA MINCH	04-R17-61	JJJ	RANDY APOSTOLEC	07-TW1-1.1
I	TIMMY B. MINCH & AMY L. MINCH	04-R17-63	KKK	WOODROW J. KNOLLINGER JR.	07-TW1-3.2
J	JUNIPER LODGE, INC.	06-T2-19	LLL	COUSINS REALTY INC.	07-TW1-7.1
K	WILLIAM A. ORUM & CYNTHIA E. ORUM	06-T2-19.1	MMM	COUSINS REALTY INC.	07-TW1-7
L	M.D. ORUM, W.B. ORUM, ELDER B. PENNINGTON & K.D. ORUM	06-T7-135.1	NNN	DWK RENTALS LLC	07-TW1-8
M	JEFFERY L. AUBER	06-T7-112.1	OOO	WV DEPARTMENT OF TRANSPORTATION DIVISION OF HIGHWAYS	NATIONAL ROAD
N	JO ANN AUBER LLC	06-T7-112.4	PPP	MIDDLE CREEK GARAGE, INC.	07-TW1-11
O	SHARON ANN AUBER	06-T7-112.3	QQQ	MIDDLE CREEK GARAGE, INC.	07-TW1-15
P	WHEELING NATURAL GAS CO.	06-T7-112.5	RRR	MIDDLE CREEK GARAGE, INC.	06-T12-6
Q	JAMES D. MILLER JR. & CAROLINE KUCHAR MILLER	06-T7G-34	SSS	KEVIN S. KOSEM & BRENDA A. KOSEM	07-TW2-11
R	LINDA M. DAVIS	06-T7G-13	TTT	MIDDLE CREEK GARAGE, INC.	07-TW1-19
S	WILLIAM W. WADE & LINDA J. WADE	06-T7G-15	UUU	MIDDLE CREEK GARAGE, INC.	07-TW1-20
T	JAMES D. MILLER JR. & CAROLINE KUCHAR MILLER	06-T7G-33	VVV	BDDE PROPERTIES, LLC	06-T12-4
U	ALBERT M. GARDNER	06-T7-113	WWW	LEWIS E. MCGRATH SR. & DOLORES I. MCGRATH	06-T7-126.3
V	DOROTHY B. BROEMSEN	06-T7-113.1	XXX	JAY A. POWELL & LISA P. POWELL	06-T7-157
W	DEBORAH L. RATHJEN	06-T7-114.1	YYY	DANIEL F. OCH	06-T7-156
X	DEBORAH L. RATHJEN	06-T7-114	ZZZ	RICHARD J. FITZPATRICK, SHERRI L. FITZPATRICK & THOMAS W. FITZPATRICK	06-T7-153
Y	R.H. ALBERT & E.R. ALBERT	06-T7-115	AAAA	DANIEL F. OCH	06-T7-155
Z	GARY WALTER & SUSAN WALTER	06-T7-148.4	BBBB	JAMES D. MILLER JR. & CAROLINE KUCHAR MILLER	06-T7-117.2
AA	JOHN T. CRISWELL & C.A. CRISWELL	06-T7-148.3	CCCC	CHAD W. BROADWATER & REBECCA L. BROADWATER	06-T7-67.16
BB	JOHN T. CRISWELL & C.A. CRISWELL	06-T7-148.1	DDDD	TODD M. SCHIRTZINGER & JENNY S. SCHIRTZINGER	06-T7-67.17
CC	JOHN T. CRISWELL & C.A. CRISWELL	06-T7-149	EEEE	WILLIAM O. LEWIS IV & CANDICE M. LEWIS	06-T7-67.19
DD	GARY R. WALTER & SUSAN L. WALTER	06-T7-148	FFFF	THOMAS L. FOLMAR & DONNA LYNNE FOLMAR	06-T7-67.18
EE	STEVEN A. MOORE & LISA K. MOORE	06-T7-148.2	GGGG	FRANCES L. BRADEN	06-T7-67
FF	REGIS G. WENZEL & J.R. WENZEL	06-T7G-4	HHHH	JASON B. BIRCH & JESSICA L. BIRCH	06-T7-97.2
GG	JAMES L. HEATH	06-T7G-3	IIII	JONATHAN BRUCE WHARTON	06-T7-97.3
HH	DONALD N. HARRIS & J.A. HARRIS	06-T7-147.1	JJJJ	KENNETH SPENCER & STEPHANIE SPENCER	06-T7-67.6
II	DONALD JEFFREY HARRIS	06-T7-147	KKKK	GERALD BISCHOF & ROSETTA J. BISHOF	06-T7-67.7
JJ	DAVID A. SCHMID & E.T. SCHMID	06-T7-146	LLLL	DEEDRA DAVIS	06-T7-67.5
KK	KATHERINE M. PAPANIMITRIOU	06-T7-145	MMMM	RONALD A. ZANDRON & PATRICIA L. ZANDRON	06-T7-67.8
LL	KATHERINE M. FIGARETTI & ANTHONY F. FIGARETTI	06-T7-143.1	NNNN	DALE A. FORESTER & CAROL ANN FORESTER	06-T7-67.9
MM	KATHERINE M. FIGARETTI & ANTHONY F. FIGARETTI	06-T7-143	OOOO	MARIO B. JULIAN & LOIS R. JULIAN	06-T7-67.13
NN	GARY E. LAUDERMILT, SR. & MARY ANN LAUDERMILT	06-T7-142	PPPP	BENJAMIN ELLWOOD & DANIELLE ELLWOOD	06-T7-67.23
OO	PATRICK RYAN SPEAKER & CASEY MARIE HERCULES	06-T7-158	QQQQ	CAYLA J. BLACK & MATTHEW D. BLACK	06-T7-67.10
PP	LYLE HEARN & KIMBERLIE HEARN	06-T7-173	RRRR	FRANCES L. BRADEN 2016 IRREVOCABLE TRUST DATED AUGUST 10, 2016	06-T7-67
QQ	CECELIA BOYD	06-T7-172	SSSS	EARL BRADEN & F.L. BRADEN	10-W56-3
RR	AUGUST J. HANSON & LISA M. HANSON	06-T7-163.20	TTTT	DONALD A. BRADEN & RHONDA L. BRADEN	06-T7-97.1
SS	ROBERT W. GALBREATH & DEBRA J. GALBREATH	06-T7-163.11	UUUU	GLORIA KALB	06-T2-15.3
TT	THOMAS R. MORGAN & ANN Y. MORGAN	06-T7-163.5	VVVV	RICHARD D. BORDER JR.	04-R17-58.5
UU	ROGER L. KENT JR & MELINDA J. KENT	06-T7-163.15	WWWW	REX D. LASURE & N.A. ENDRIZZI	04-R17-58.4
VV	ROGER L. KENT JR & MELINDA J. KENT	06-T7-163.18	XXXX	REX D. LASURE & N.A. ENDRIZZI	04-R17-58.3
WW	TODD FULLERTON	06-T7-163.16	YYYY	JAMES HOHMAN & M. HOHMAN	04-R17-58.2
XX	ROBERT M. TUCKER & REBECCA E. TUCKER	06-T7-163.12	ZZZZ	TIMMY B. MINCH & AMY L. MINCH	04-R17-58.1
YY	GREGORY A. GAUDINO & ANNETTE M. GAUDINO	06-T7-163.13	AAAAA	ROBERT WILLIAM MINCH JR & BARBARA JEAN MINCH	04-R17-57.2
ZZ	BUSAINA KHALIL	06-T7-163.7			
AAA	BUSAINA KHALIL	06-T7-163.6			
BBB	JAMES SIMMS	06-T7-163.17			

REVISIONS:	COMPANY:	 	
	OPERATOR'S	TIMMY MINCH OHI	API #
	WELL #:	6H	47-069-00268
	DISTRICT:	COUNTY:	STATE:
	TRIADPHIA	OHIO	WV
			DATE: 02-28-2019
			DRAWN BY: N. MANO
			SCALE: N/A
			DRAWING NO:
			WELL LOCATION PLAT 2