

BOTTOM HOLE LATITUDE: 40°07'30" ← 1585'

SURFACE HOLE LATITUDE: 40°07'30" ← 3278'



www.jhacompanies.com
68011 Vineyard Road
St. Clairsville, Ohio 43950
740-696-6100

NOTES ON SURVEY

1. COORDINATE SYSTEM IS UTM NAD 83 DATUM, ZONE 17, U.S. FOOT AND WELL COORDINATES ESTABLISHED USING SURVEY GRADE GPS.
2. SURFACE AND ROYALTY OWNER INFORMATION AND THEIR BOUNDARIES SHOWN HEREON WERE PLOTTED FROM DEEDS AND/OR TAX PARCEL MAPS PROVIDED BY CLIENT AND/OR FIELD LOCATIONS.
3. THIS PLAT DOES NOT REPRESENT A BOUNDARY SURVEY OF THE PARCELS SHOWN HEREON.
4. NO DWELLINGS OR BUILDINGS WITHIN 625 FEET OF PROPOSED CENTER OF PAD
5. NO PERENNIAL STREAMS, LAKES, PONDS, RESERVOIRS OR WETLANDS WITHIN 100 FEET OF THE LIMITS OF DISTURBANCE.
6. NO NATURALLY PRODUCING TROUT STREAM WITHIN 300 FEET OF THE LIMITS OF DISTURBANCE.
7. NO WATER WELLS OR DEVELOPED SPRINGS WITHIN 250 FEET OF PROPOSED WELL.

01/18/2019

PROPOSED SURFACE HOLE

LPL
S82°11'37"W
1992.37'

SHL

GRID NORTH
UTM, NAD83 DATUM, ZONE 17, US F

SURFACE HOLE LONGITUDE: -80°35'00"

BOTTOM HOLE LONGITUDE: -80°35'00"

WELL LAYOUT

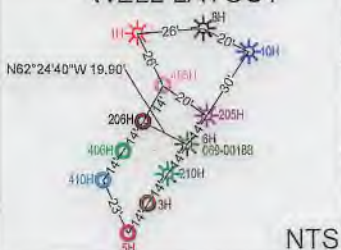

NTS

EXISTING WELLS WITHIN 3000'



| |
|---|
| SURFACE HOLE LOCATION (SHL): UTM (NAD83, ZONE 17, METERS): NORTHING: 4440485.31 EASTING: 534504.43 |
| LANDING POINT LOCATION (LPL): UTM (NAD83, ZONE 17, METERS): NORTHING: 4440392.79 EASTING: 533904.46 |
| BOTTOM HOLE LOCATION (BHL): UTM (NAD83, ZONE 17, METERS): NORTHING: 4438250.68 EASTING: 535031.39 |

| LINE | BEARING | DISTANCE |
|------|-------------|----------|
| L1 | S10°03'52"W | 1395.08' |
| L2 | S52°38'01"W | 1101.42' |

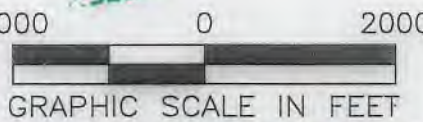

I, THE UNDERSIGNED, HEREBY CERTIFY THAT THIS PLAT IS CORRECT TO THE BEST OF MY KNOWLEDGE AND BELIEF AND SHOWS ALL THE INFORMATION REQUIRED BY LAW AND REGULATIONS ISSUED AND PRESCRIBED BY THE DEPARTMENT OF ENVIRONMENTAL PROTECTION.

P.S. 2041

COMPANY:

SWN

Production Company, LLC

SWN

Production Company™



(+) DENOTES LOCATION OF WELL ON UNITED STATES TOPOGRAPHIC MAPS

WVDEP
OFFICE OF OIL & GAS
601 57TH STREET
CHARLESTON, WV 25034

MINIMUM DEGREE OF ACCURACY: 1/200
PROVEN SURVEY SOURCE OF ELEVATION: GRADE GPS (NAVD 88, US FT)

GLENN DIDRIKSEN OHI
OPERATOR'S WELL #: 206H
API WELL #: 47 069 00292
STATE COUNTY PERMIT

WELL TYPE: OIL WASTE DISPOSAL PRODUCTION DEEP GAS LIQUID INJECTION STORAGE SHALLOW

WATERSHED: UPPER OHIO SOUTH
DISTRICT: LIBERTY COUNTY: OHIO
SURFACE OWNER: GLENN DIDRIKSEN
OIL & GAS ROYALTY OWNER: D&D FAST FOODS, INC
DRILL DRILL DEEPER REDRILL FRACTURE OR STIMULATE PLUG OFF OLD FORMATION PERFORATE NEW FORMATION

CONVERT PLUG & ABANDON CLEAN OUT & REPLUG OTHER CHANGE (SPECIFY)
TARGET FORMATION: MARCELLUS ESTIMATED DEPTH: 6,511' TVD 15,089.7'TMD

WELL OPERATOR: SWN PRODUCTION COMPANY, LLC
ADDRESS: P.O. BOX 1300
CITY: JANE LEW STATE: WV ZIP CODE: 26378

DESIGNATED AGENT: BRITTANY WOODY
ADDRESS: P.O. BOX 1300
CITY: JANE LEW STATE: WV ZIP CODE: 26378

| | | |
|---|-------------------|--|
| LEGEND: ● PROPOSED SURFACE HOLE / BOTTOM HOLE ⊙ EXISTING / PRODUCING WELLHEAD LPL* LANDING POINT LOCATION ⊙ EXISTING WATER WELL ⊙ EXISTING SPRING | REVISIONS: | DATE: 10-09-2018 |
| --- PUBLIC ROAD --- SURVEYED BOUNDARY ===== LEASE BOUNDARY --- PROPOSED PATH | | DRAWN BY: D. REED SCALE: 1" = 2000' DRAWING NO: 2017-342 WELL LOCATION PLAT |

WV Department of Environmental Protection

01/18/2019

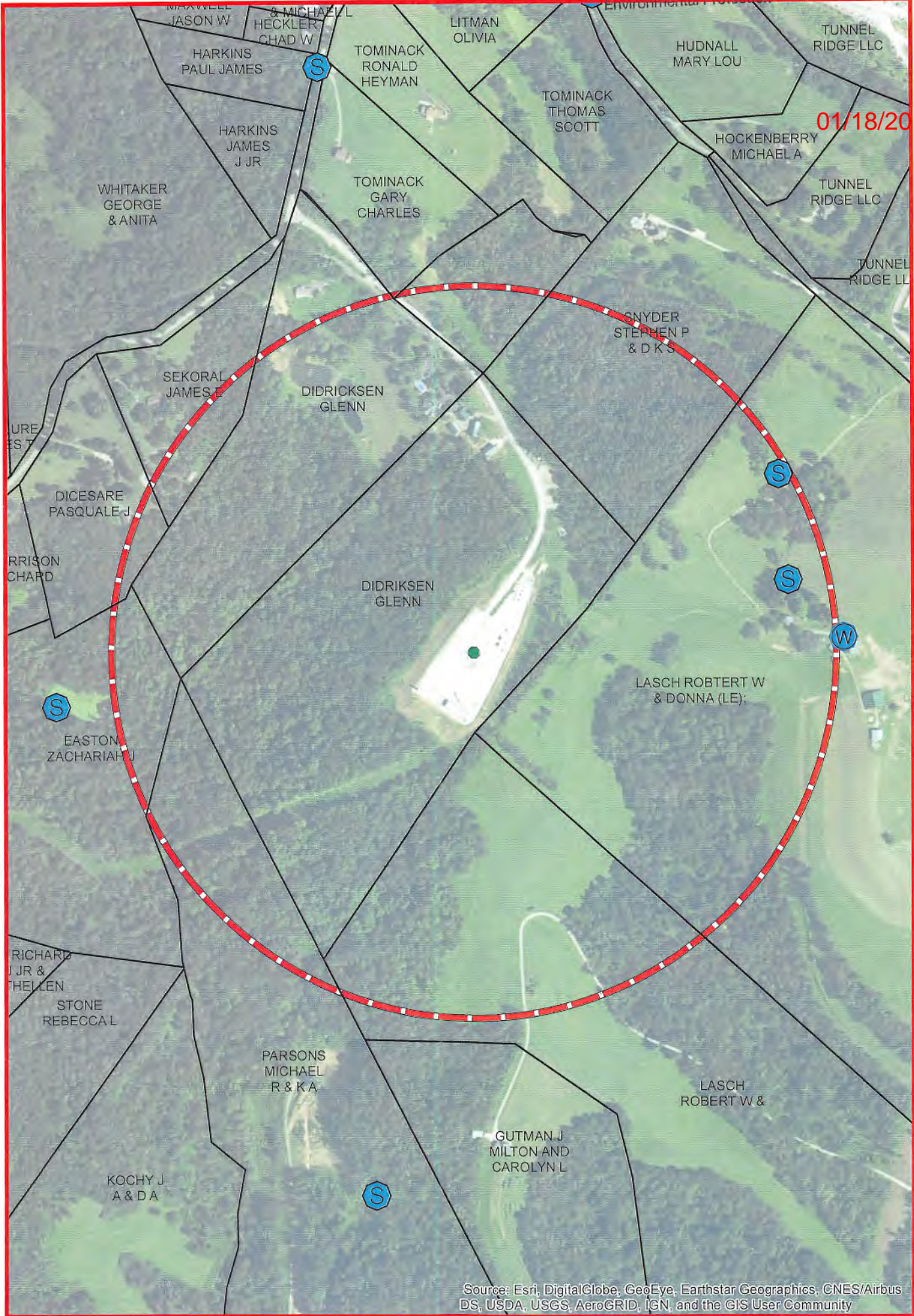

Source: Esri, DigitalGlobe, GeoEye, Earthstar Geographics, CNES/Airbus DS, USDA, USGS, AeroGRID, IGN, and the GIS User Community

The intent of this map is for general reference only. Information on this map was created using the best available data at the time but is not guaranteed accurate.

| | | | | |
|--|---------------------|--|--|------------------------|
| Water Purveyor Map | | | Well Pad: Glenn Didriksen OHI Pad | County: OHIO |
| Map by: speart NAD 1983 BLM Zone 17N ftUS | Date: 7/21/2017 | | Glenn Didriksen OHI Coordinates: 40.114083, -80.595038 | |
| | | | | |