

BOTTOM HOLE LATITUDE: 40°07'30" 959'

SURFACE HOLE LATITUDE: 40°07'30" 3300'

**JHA** SURVEYORS  
ENGINEERS  
ENVIRONMENTAL  
GIS MAPPING  
www.jhacompanies.com  
68011 Vineyard Road  
St. Clairsville, Ohio 43950  
740-695-6100

**NOTES ON SURVEY**

1. COORDINATE SYSTEM IS UTM NAD 83 DATUM, ZONE 17, U.S. FOOT AND WELL COORDINATES ESTABLISHED USING SURVEY GRADE GPS.
2. SURFACE AND ROYALTY OWNER INFORMATION AND THEIR BOUNDARIES SHOWN HEREON WERE PLOTTED FROM DEEDS AND/OR TAX PARCEL MAPS PROVIDED BY CLIENT AND/OR FIELD LOCATIONS.
3. THIS PLAT DOES NOT REPRESENT A BOUNDARY SURVEY OF THE PARCELS SHOWN HEREON.
4. NO DWELLINGS OR BUILDINGS WITHIN 625 FEET OF PROPOSED CENTER OF PAD
5. NO PERENNIAL STREAMS, LAKES, PONDS, RESERVOIRS OR WETLANDS WITHIN 100 FEET OF THE LIMITS OF DISTURBANCE.
6. NO NATURALLY PRODUCING TROUT STREAM WITHIN 300 FEET OF THE LIMITS OF DISTURBANCE.
7. NO WATER WELLS OR DEVELOPED SPRINGS WITHIN 250 FEET OF PROPOSED WELL.

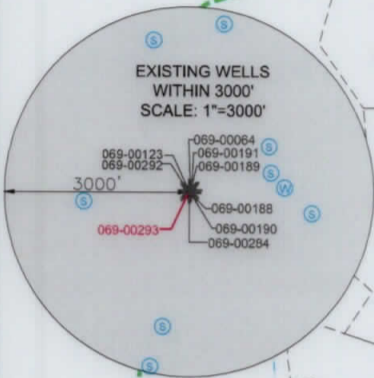
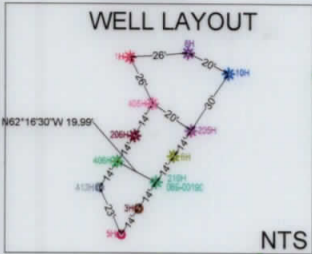

<b>SURFACE HOLE LOCATION (SHL):</b>
UTM (NAD83, ZONE 17, METERS): NORTHING: 4440481.72 EASTING: 534502.07
<b>LANDING POINT LOCATION (LPL):</b>
UTM (NAD83, ZONE 17, METERS): NORTHING: 4440257.96 EASTING: 533730.19
<b>BOTTOM HOLE LOCATION (BHL):</b>
UTM (NAD83, ZONE 17, METERS): NORTHING: 4437031.81 EASTING: 535231.28
<b>SURFACE HOLE LOCATION (SHL):</b>
UTM (NAD83, ZONE 17, METERS): NORTHING: 4440481.72 EASTING: 534502.07
<b>LANDING POINT LOCATION (LPL):</b>
UTM (NAD83, ZONE 17, METERS): NORTHING: 4440309.41 EASTING: 533710.79
<b>BOTTOM HOLE LOCATION (BHL):</b>
UTM (NAD83, ZONE 17, METERS): NORTHING: 4437032.09 EASTING: 535238.97

I, THE UNDERSIGNED, HEREBY CERTIFY THAT THIS PLAT IS CORRECT TO THE BEST OF MY KNOWLEDGE AND BELIEF AND SHOWS ALL THE INFORMATION REQUIRED BY LAW AND REGULATIONS ISSUED AND PRESCRIBED BY THE DEPARTMENT OF ENVIRONMENTAL PROTECTION.

P.S. 2041

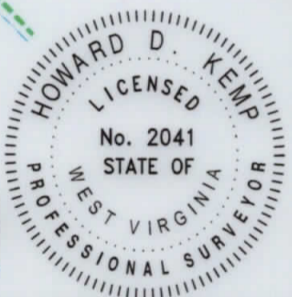

LINE	BEARING	DISTANCE
L1	S10°18'03"W	1407.94'
L2	S52°24'25"W	1114.82'

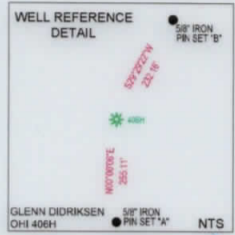

COMPANY: **SWN** Production Company, LLC

(+) DENOTES LOCATION OF WELL ON UNITED STATES TOPOGRAPHIC MAPS  
WVDEP  
OFFICE OF OIL & GAS  
601 57TH STREET  
CHARLESTON, WV 25034

MINIMUM DEGREE OF ACCURACY: 1/200  
PROVEN SURVEY GRADE GPS ELEVATION: (NAVD 88, US FT)

GLENN DIDRIKSEN OH  
OPERATOR'S WELL #: 406H  
API WELL #: 47 069 293  
STATE COUNTY PERMIT

WELL TYPE: OIL  WASTE DISPOSAL  PRODUCTION  DEEP  GAS  LIQUID INJECTION  STORAGE  SHALLOW   
 WATERSHED: UPPER OHIO SOUTH ELEVATION: 1383.0'  
 DISTRICT: LIBERTY COUNTY: OHIO QUADRANGLE: VALLEY GROVE, WV  
 SURFACE OWNER: GLENN DIDRIKSEN ACREAGE: ±47.93  
 OIL & GAS ROYALTY OWNER: D&D FAST FOODS, INC ACREAGE: ±47.93  
 DRILL  DRILL DEEPER  REDRILL  FRACTURE OR STIMULATE  PLUG OFF OLD FORMATION  PERFORATE NEW FORMATION   
 CONVERT  PLUG & ABANDON  CLEAN OUT & REPLUG  OTHER CHANGE  (SPECIFY) AS-DRILLED  
 TARGET FORMATION: MARCELLUS ESTIMATED DEPTH: 6,561' TVD 19,227' TMD

WELL OPERATOR: SWN PRODUCTION COMPANY, LLC DESIGNATED AGENT: BRITTANY WOODY  
 ADDRESS: 1300 FORT PIERPONT DRIVE, SUITE 201 ADDRESS: 1300 FORT PIERPONT DRIVE, SUITE 201  
 CITY: MORGANTOWN STATE: WV ZIP CODE: 26508 CITY: MORGANTOWN STATE: WV ZIP CODE: 26508

<b>LEGEND:</b>	<b>REVISIONS:</b>	<b>DATE:</b> 10-15-2019
● EXISTING BOTTOM HOLE	— ACCESS ROAD	
⊙ EXISTING / PRODUCING WELLHEAD	— PUBLIC ROAD	
LPL* EXISTING LANDING POINT LOCATION	— FLOOD PLAIN	
● PROPOSED SURFACE HOLE / BOTTOM HOLE	— LEASE BOUNDARY	
LPL* PROPOSED LANDING POINT LOCATION	— AS-DRILLED PATH	
	— PROPOSED PATH	
		<b>DRAWN BY:</b> R.GRIMES
		<b>SCALE:</b> 1" = 2000'
		<b>DRAWING NO:</b> 2017-342
		<b>WELL LOCATION PLAT</b>

WELL BORE TABLE FOR SURFACE / ROYALTY OWNERS		
TRACT	SURFACE OWNER (S) / ROYALTY OWNER (R)	TAX PARCEL
1	GLENN DIDRIKSEN (S) D&D FAST FOODS, INC (R)	03-L7-0042.0000
TRACT	SURFACE OWNER	TAX PARCEL
2	GLENN DIDRIKSEN	03-L7-0037.0000
3	RICHARD MORRISON	03-L7-0034.0000
4	ROGER A. & KAREN F. HUNT	03-L7-0024.0001
5	JAY R. & JODI A. HUNT	03-L10-0034.0000
6	RICHARD J., JR. & BETHELLEN ROY	03-L10-0031.0000
7	REBECCA L. STONE	03-L10-0030.0000
8	REBECCA L. STONE	03-L10-0029.0001
9	LINDA A. GILMORE, BARBARA J. BELL, DONNA M. ROBBINS, JOHN E. KOCHY & REBECCA L. STONE	03-L10-0029.0000
10	MICHAEL R. & KATHERINE A. PARSONS	03-L10-0035.0003
11	BRUCE A. & BRENDA J. PARSONS	03-L10-0035.0000
12	HARRY F., JR. & KRISTINE METZ	03-L10-0035.0002
13	CLARENCE A. A. WOOD	03-L10-0036.0004
14	MICHELLE L. HORBATAK	03-L10-0036.0003
15	DAVID A. & FLORENCE D. BLOWERS	03-L10-0036.0006
16	LANCE H., JR. & SHAENAN G. MILLER	03-L10-0036.0000
17	RONALD W. HOUCINS	03-L10-0036.0005
18	KIMBERLY ANN STEVENSON	03-L13-0005.0002
19	KIMBERLY STEVENSON	03-L13-0005.0005
20	RICHARD G. DEEVER	03-L13-0016.0000

ADJOINING OWNERS TABLE		
TRACT	SURFACE OWNER	TAX PARCEL
A	RONALD HEYMAN TOMINACK	03-L7-0039.0002
B	DENISE KNOUSE-SNYDER & STEPHEN P. SNYDER	03-L7-0042.0001
C	ROBERT W. & DONNA LASCH (L/E); BARBARA JO HINERMAN	03-L10-0040.0000
D	ROBERT W. & DONNA LASCH (L/E); LINDA JEAN STONE	03-L10-0039.0000
E	J. MILTON & CAROLYN L. GUTMAN	03-L10-0039.0001
F	MATTHEW J. & JUDITH M. PADDEN	03-L10-0038.0000
G	CURTIS ROBERT HARRIS	03-L10-0037.0000
H	ARCH J. DIERINGER, JR.	03-L10-0045.0001
I	C.A. EVANS & R.A. DIERINGER	03-L13-0021.0001
J	ARCH J. DIERINGER, JR.	03-L13-0021.0000
K	ARLEY NEMO	03-L13-0020.0000
L	ARLEY NEMO	03-L13-0016.0001
M	RICHARD DEEVER	03-L13-0020.0001
N	GREGORY R. GANTZER	03-L13-0019.0000
O	ALVIN YODER	03-L13-0021.0002
P	ALVIN YODER	03-L13-0022.0000
Q	HORST LOHR	03-L13-0017.0000
R	THOMAS E. SEIFERT	03-L13-0017.0002
S	JAMES E. & MARY E. EBBERT	03-L13-0018.0000
T	GARY LEE & P.J. EBBERT	08-VG8-0001.0000
U	NORMA J. & MICHAEL C. ELTRINGHAM	08-VG8-0001.0001
V	A.R. & HILDA M. WALKER	08-VG8-0005.0000
W	FRANKLIN COSTANZO	08-VG8-0004.0000
X	ALBERT J. TRAGER	08-VG10-0003.0000
Y	KARL L. SR. & CAROL J. KOSEM	08-VG10-0002.0000
Z	KARL L. & C.J. KOSEM	08-VG10-0002.0001
AA	PAUL R., SR. & C.G. TEMPLIN	08-VG10-0001.0000
AB	GERALD T. & ANNA M. MOORE	06-T3-0015.0003
AC	CHERYL L. & H.E. HOLMAN	06-T3-0013.0000
AD	HARRY E. & C.L. HOLMAN	06-T3-0012.0000
AE	KEITH E. & C.J. BARON	03-L13-0015.0000
AF	GARY L. & MARY C. DEMERSKI	03-L13-0014.0000
AG	JAMES C. & D.L. KNIGHT	03-L13-0013.0000
AH	STEVEN P. SHEARER	03-L13-0012.0002
AI	JOLLY W., SR. & SARAH JANE WHEELER; ET AL	03-L13-0012.0000
AJ	JOLLY W., SR. & SARAH JANE WHEELER; ET AL	03-L13-0011.0001
AK	KEITH & CAROLYN BARON	03-L13-0011.0000
AL	KEITH E. & CAROLYN J. BARON	03-L13-0011.0002
AM	JAMES E., JR. & B.J. WHEELER	03-L13-0011.0002
AN	JAMES E., JR. & B.J. WHEELER	03-L13-0009.0000
AO	JAMES E. WHEELER, III & CHRISTINE WHEELER	03-L13-0008.0000
AP	JAMES E. WHEELER, III & CHRISTINE WHEELER	03-L13-0008.0001
AQ	RHONDA L. FLANEGIN	03-L13-0007.0000
AR	TYSON L. & VANESSA LOVERIDGE	03-L13-0006.0000
AS	OHIO COUNTY BOARD OF COMMISSIONERS	03-L13-0006.0003
AT	KIMBERLY STEVENSON, JAMES STEVENSON & BRENDA STEVENSON-DELGADO	03-L13-0006.0001
AU	JAMES ALAN STEVENSON	03-L13-0005.0004
AV	SANDRA LYNN STEVENSON-MOKROS	03-L13-0005.0003
AW	BRENDA J. & E. DELGADO	03-L13-0005.0001
AX	CECILEA DELGADO-MOORE & JOSHUA MOORE	03-L13-0005.0006
AY	RONALD W. HOUCINS	03-L13-0004.0003
AZ	OHIO COUNTY BOARD OF COMMISSIONERS	03-L13-0003.0001
BA	THOMAS R. & S.O. ABRAHAM	03-L10-0026.0000
BB	MICHELLE L. HORBATAK	03-L10-0036.0001
BC	CLARENCE A. WOOD & MILDRED L. WOOD	03-L10-0036.0007
BD	JOYCE E. KIMPEL	03-L10-0048.0000
BE	JEAN P. & L.P. LOUSTAU (RESV LF: CAROLINE L. BYRUM)	03-L10-0027.0000
BF	CHARLES & FLORA DIETRICH	03-L10-0035.0001
BG	MICHAEL R. & K.A. PARSONS	03-L10-0027.0002
BH	CAROLINE LOUSTAU-BYRUM	03-L10-0027.0003
BI	CAROLINE LOUSTAU-BYRUM	03-L10-0027.0001
BJ	GLEN L. & R.S. WALTERS	03-L10-0028.0000
BK	LUTZ F. & DORIS J. ALBRECHT	03-L10-0028.0005
BL	MICHAEL E. & EILEEN A. MURPHY	03-L10-0032.0000
BM	CHARLES WILLIAM MURPHY	03-L10-0010.0006
BN	CHARLES W. MURPHY, JR.	03-L10-0010.0001
BO	CHARLES CLARK MILTON, JR.	03-L10-0008.0000
BP	CHARLES W. STALNAKER & SANDRA B. STALNAKER	03-L7-0024.0000
BQ	RICHARD ARMSTRONG, JR.	03-L7-0025.0001
BR	GEORGE & ANITA WHITAKER	03-L7-0027.0000
BS	JAMES T. MCCLURE	03-L7-0033.0000
BT	PASQUALE J. DICESARE	03-L7-0034.0001
BU	JAMES E. SEKORAL	03-L7-0035.0000
BV	JAMES J. HARKINS, JR.	03-L7-0038.0000
BW	GARY CHARLES TOMINACK	03-L7-0039.0004

REVISIONS:

COMPANY:

**SWN**  
Production Company, LLC

**SWN**  $\frac{R^+}{A} \rightarrow V^+$   
Production Company™

OPERATOR'S GLENN DIDRIKSEN OHI

DATE: 10-15-2019

WELL #: 406H

DRAWN BY: R.GRIMES

DISTRICT:  
LIBERTY

COUNTY:  
OHIO

STATE:  
WV

SCALE: N/A

DRAWING NO: 2017-342

WELL LOCATION PLAT

PROPERTY NUMBER 2501165766

PAD ID 3001155800