

issued 5-18-71
 MINIMUM ERROR OF CLOSURE 1 IN 200
 SOURCE OF ELEVATION USGS Elev @ Intersection of Shultz & Pickens Run Road Elev. 662.0
 "I, THE UNDERSIGNED, HEREBY CERTIFY THAT THIS MAP IS CORRECT TO THE BEST OF MY KNOWLEDGE AND BELIEF AND SHOWS ALL THE INFORMATION REQUIRED BY PARAGRAPH 6 OF THE RULES AND REGULATIONS OF THE OIL AND GAS SECTION OF THE MINING LAWS OF WEST VIRGINIA."

Company Westrans Petroleum, Inc.
 Address 299 Park Ave. New York, N.Y.
 Farm R.L. INGRAM
 Tract _____ Acres 110.5 Lease No. _____
 Well (Farm) No. 1 Serial No. _____
 Elevation (Spirit Level) 771.9
 Quadrangle Marietta EC
 County Pleasants District Jefferson
 Engineer Raymond B. Lohr
 Engineer's Registration No. 4801
 File No. _____ Drawing No. _____
 Date Sept 20, 1968 Scale 1" = 660

STATE OF WEST VIRGINIA
 DEPARTMENT OF MINES
 OIL AND GAS DIVISION
 CHARLESTON
WELL LOCATION MAP
 FILE NO. Pleas-647-PP-P
 + Denotes location of well on United States Topographic Maps, scale 1 to 62,500, latitude and longitude lines being represented by border lines as shown.
 - Denotes one inch spaces on border line of original tracing.

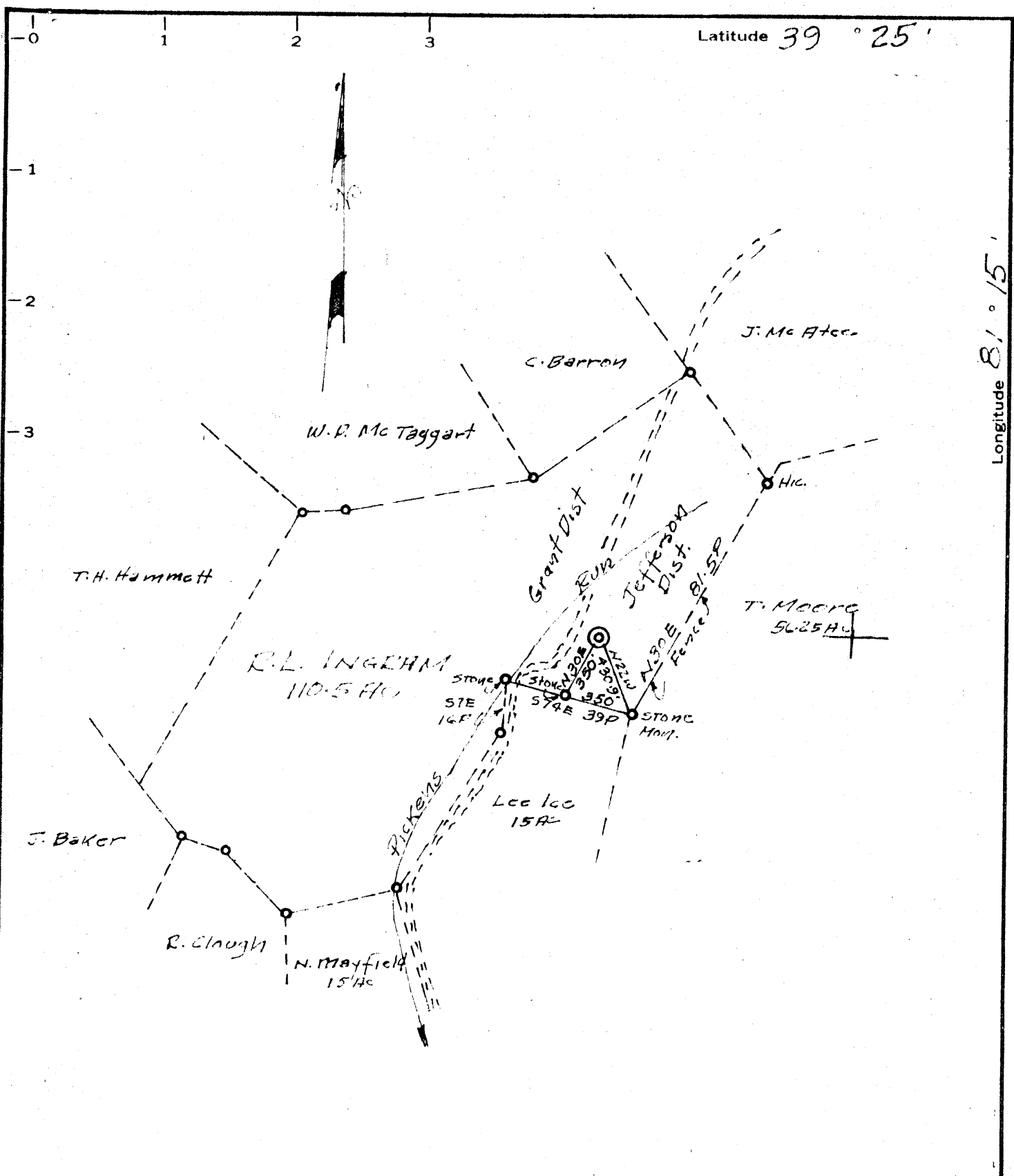

MINIMUM ERROR OF CLOSURE 1 IN 200

71-29-69

SOURCE OF ELEVATION USGS Elev @ Intersection of Shultz

~~New Location~~

7 Pickens River Road Elev. 662.0

Drill Deeper

"I, THE UNDERSIGNED, HEREBY CERTIFY THAT THIS MAP IS CORRECT TO THE BEST OF MY KNOWLEDGE AND BELIEF AND SHOWS ALL THE INFORMATION REQUIRED BY PARAGRAPH 6 OF THE RULES AND REGULATIONS OF THE OIL AND GAS SECTION OF THE MINING LAWS OF WEST VIRGINIA"

Abandonment

Partial Plugging

Company Northwest Petroleum, Inc.
 Address 299 Park Ave. New York, N.Y.
 Farm R.L. INGHAM
 Tract _____ Acres 110.5 Lease No. _____
 Well (Farm) No. 1 Serial No. _____
 Elevation (Spirit Level) 776.0
 Quadrangle Marietta 60
 County Jefferson District Jefferson
 Engineer Raymond E. Coffey
 Engineer's Registration No. 4801
 File No. _____ Drawing No. _____
 Date Sept 20, 1968 Scale 1" = 660'

STATE OF WEST VIRGINIA
 DEPARTMENT OF MINES
 OIL AND GAS DIVISION
 CHARLESTON

WELL LOCATION MAP
 FILE NO. Pleas-647-PP

| Denotes location of well on United States Topographic Maps, scale 1 to 62,500, latitude and longitude lines being represented by border lines as shown.

— Denotes one inch spaces on border line of original tracing.

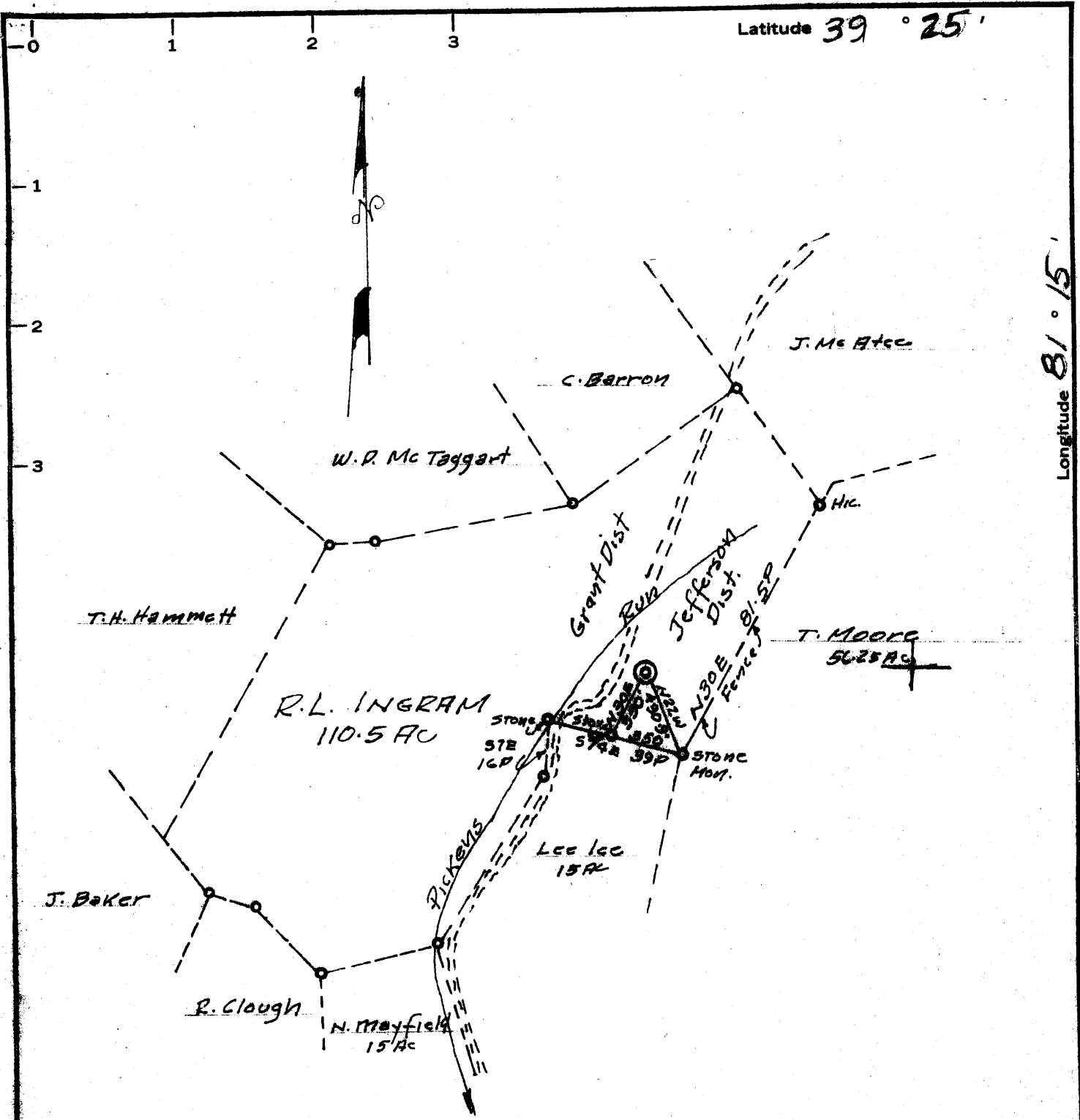

MINIMUM ERROR OF CLOSURE 1 in 200
 SOURCE OF ELEVATION USGS Elev @ Intersection of Shultz
& Pickens Run Road Elev. 662.0

New Location
 Drill Deeper
 Abandonment

"I, THE UNDERSIGNED, HEREBY CERTIFY THAT THIS MAP IS CORRECT TO THE BEST OF MY KNOWLEDGE AND BELIEF AND SHOWS ALL THE INFORMATION REQUIRED BY PARAGRAPH 6 OF THE RULES AND REGULATIONS OF THE OIL AND GAS SECTION OF THE MINING LAWS OF WEST VIRGINIA."

Company Wentons Petroleum, Inc.
 Address 299 Park Ave. New York, N.Y.
 Farm R.L. Ingram
 Tract _____ Acres 110.5 Lease No. _____
 Well (Farm) No. 1 Serial No. _____
 Elevation (Spirit Level) 771.9
 Quadrangle Marietta EC
 County Pleasants District Jefferson
 Engineer Raymond B. Jones
 Engineer's Registration No. 4801
 File No. _____ Drawing No. _____
 Date Sept 20, 1968 Scale 1" = 660

STATE OF WEST VIRGINIA
 DEPARTMENT OF MINES
 OIL AND GAS DIVISION
 CHARLESTON
WELL LOCATION MAP
 FILE NO. Pleas-647

+ Denotes location of well on United States Topographic Maps, scale 1 to 62,500, latitude and longitude lines being represented by border lines as shown.
 - Denotes one inch spaces on border line of original tracing.



STATE OF WEST VIRGINIA
DEPARTMENT OF MINES
OIL AND GAS DIVISION

Rotary
Spudder
Cable Tools
Storage

Oil Dry

Oil or Gas Well (KIND)

Quadrangle Marietta
Permit No. PLEAS-647

WELL RECORD

Company Westrans Petroleum, Inc.
Address 299 Park Avenue, New York, N. Y.
Farm R. L. Ingram Acres 110.5
Location (waters) Pickens Run
Well No. One Elev. 771.9
District Jefferson County Pleasants
The surface of tract is owned in fee by R. L. Ingram
Address St. Marys, W. Va.
Mineral rights are owned by R. L. Ingram
Address St. Marys, W. Va.
Drilling commenced 10-26-68
Drilling completed 12-18-68
Date Shot From To
With
Open Flow /10ths Water in Inch
/10ths Merc. in Inch
Volume Cu. Ft.
Rock Pressure lbs. hrs.
Oil bbls., 1st 24 hrs.

Casing and Tubing	Used in Drilling	Left in Well	Packers
Size			Kind of Packer
16			
13	15"	15'	
10	337'		Size of
8 1/4	1631		Depth set
6 5/8			
5 3/16	3489	3489	
4 1/2			
3			Perf. top <u>2795</u>
2			Perf. bottom <u>3128</u>
Liners Used			Perf. top <u>3263</u>
			Perf. bottom <u>3410</u>

WELL ACIDIZED (DETAILS)
WELL FRACTURED (DETAILS) 12-28-68 - Two Zones 2795-3128; 3263-3410. 1700 bbl water
32,000 lb. 20-40 sand - 1150 gal. Reg HcL acid.
RESULT AFTER TREATMENT (Initial open Flow or bbls.) 24,000 cu. ft. 24 Mcf
ROCK PRESSURE AFTER TREATMENT 480# HOURS 48 hrs.
Fresh Water small flow Feet 208 Salt Water Feet
Producing Sand Devonian Sh Depth

Attach copy of cementing record.
CASING CEMENTED 4 1/2" SIZE 3489 No. Ft. 12-23-68 Date
Amount of cement used (bags) 450 sx Lite Poz
Name of Service Co. Dowell
NO
COAL WAS ENCOUNTERED AT FEET INCHES
FEET INCHES FEET INCHES
FEET INCHES FEET INCHES

Formation	Color	Hard or Soft	Top	Bottom	Oil, Gas or Water	Depth	Remarks
Soil			0	15			Casing
Red Rock			15	100			15' 14" Con- ductor 10-26-68
Slate			100	150			337' 10" 11-3-68
Red Rock			150	178			
Lime			178	198			1631' 8" 11-21-68
Sand			198	215	Water @ 208		3489' 4 1/2" 12-23-68
Slate			215	283			
Sand			283	300			
Slate			300	320			
Sand			320	410			
Lime			410	430			
Sand			430	464			
Slate			464	550			
Sand			550	580			
Slate			580	758			
Lime			758	770			
Sand			770	801			
Slate			801	815			
Lime Dark			815	848			
Slate			848	940			
Sand			940	1023			
Slate			1023	1030			

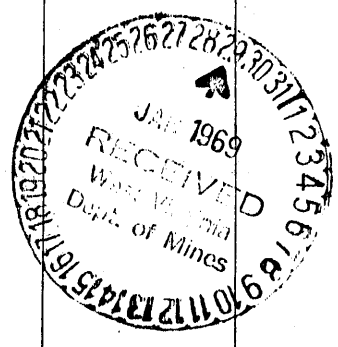

3504
1625
TR 79 expl. Seepage

Formation	Color	Hard or Soft	Top $\%$	Bottom	Oil, Gas or Water	Depth Found	Remarks
Injun Sand			1030	1080			
Squaw Sand			1080	1196	Bad Hole	Shot at 1080	Show of oil
Lime			1196	1255			
Slate Shells			1255	1305			
Lime			1305	1342			
Slate Shells			1342	1600			
Brown Shale			1600	1614			
Berea Sand			1614	1625			
Lime			1625	1900			
Slate Shells			1900	1919			
Gritty Lime			1919	2003			
Slate Shells			2003	3120			
Gray Shale			3120	3204			
Gritty Lime			3204	3305			
Brown Gritty Shale			3305	3345			
Slate Shells			3345	3504	TD		
<p>PI Rpt 5/23/69</p> <p>5/16 Perf @ 1108, Fract.</p> <p>5/23 IP 6 BOPD</p>							

Date January 27, 1969
APPROVED Westmans Petroleum, INC Owner
By Thomas J. Richards
(Title)



STATE OF WEST VIRGINIA
DEPARTMENT OF MINES
OIL AND GAS WELLS DIVISION

Rotary
Spudder
Cable Tools
Storage

Quadrangle Marietta
Permit No. PLEAS-647

WELL RECORD

Oil or Gas Well OIL
(KIND)

Company WESTRANS PETROLEUM, INC.
Address 299 Park Avenue, New York, N. Y.
Farm R. L. Ingram Acres 110.5
Location (waters) Pickens Run
Well No. ONE Elev. 771.9
District Jefferson County Pleasants
The surface of tract is owned in fee by R. L. Ingram
Address St. Marys, W. Va.
Mineral rights are owned by R. L. Ingram
Address St. Marys, W. Va.
Drilling commenced 10-26-68
Drilling completed 12-18-68
Date Shot From To
With
Open Flow /10ths Water in Inch
/10ths Merc. in Inch
Volume Cu. Ft.
Rock Pressure lbs. hrs.
Oil bbls., 1st 24 hrs.
WELL ACIDIZED (DETAILS)
WELL FRACTURED (DETAILS) SEE REVERSE SIDE

Casing and Tubing	Used in Drilling	Left in Well	Packers
Size			Kind of Packer
16			
13	15'	15'	
10	337'	337	Size of
8 1/4	1631	pulled	
6 5/8			Depth set
5 3/16			
4 1/2	3489	1210	
3			Perf. top <u>1126</u>
2			Perf. bottom <u>1146</u>
Liners Used			Perf. top Perf. bottom

Attach copy of cementing record. SEE REVERSE SIDE
CASING CEMENTED SIZE No. Ft. Date
Amount of cement used (bags)
Name of Service Co.
COAL WAS ENCOUNTERED AT FEET INCHES
FEET INCHES FEET INCHES
FEET INCHES FEET INCHES

RESULT AFTER TREATMENT (Initial open Flow or bbls.) 6 BOPD
ROCK PRESSURE AFTER TREATMENT N R HOURS
Fresh Water Small flow Feet 208 Salt Water Feet
Producing Sand Squaw Sand Depth 1136 - 99

Formation	Color	Hard or Soft	Top	Bottom	Oil, Gas or Water	Depth	Remarks
Soil			0	15			
Red Rock			15	100			Casing
Slate			100	150			
Red Rock			150	178			15' 14" Conduc-
Lime			178	198			tor 10-26-68
Sand			198	215	Water @ 208		337' 10" 11-3-68
Slate			215	283			
Sand			283	300			1631' 8" 11-21-68
Slate			300	320			3489' 4 1/2" 12-23-68
Sand			320	410			
Lime			410	430			
Sand Salt			430	464			
Slate			464	550			
Sand Salt			550	580			
Slate			580	758			
Lime			758	770			
Sand			770	801			
Slate			801	815			
Lime Dark L L			815	848			
Slate			848	940			
Sand K			940	1023			
Slate			1023	1030			
Injun Sand			1030	1080			
Squaw Sand			1080	1196			Bad Hole Shot at 1137 - show of oil
Lime			1196	1255			
Slate shells			1255	1305			
Lime			1305	1342			
Slate shells			1342	1600			
Brown shale			1600	1614			
Berea Sand			1614	1625			

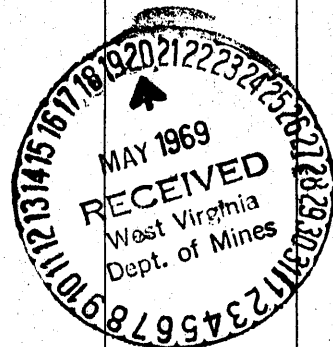

(over) 3504
1625
1879

MAY 27 1969

1277

Formation	Color	Hard or Soft	Top 10	Bottom	Oil, Gas or Water	Depth Found	Remarks
Lime			1625	1900			
Slate shells			1900	1919			
Gritty lime			1919	2003			
Slate shells			2003	3120			
Gray shale			3120	3204			
Gritty lime			3204	3305			
Brown gritty shale		<i>Dun Shales</i>	3305	3345			
Slate shells			3345	3504			
TOTAL DEPTH				3504			
<p>Ran 4½" csg. to 3489 & Dowell cemented w/450 cf pozmix cement On 12-28-68 McCullough perforated 3263 - 76 & 3322 - 30 & 3406-10 Halliburton frace w/1204 bbl. water & 24,000# 20-40 sand Set bridge plug @ 3170 Perforated 3125 - 28 & 2797 - 2837 Halliburton fraced w/460 bbl. water & 8,000# 20-40 sand. Final open flow for above 2 shale zones showed 24,000 cf & 480# in 48 hours Cut 4½" casing @ 2150' - plugged back to 1250' - reran 4½" casing to 1210' & Halliburton cemented w/150 cf pozmix cement On 3-14-69 Birdwell perforated 1175 to 1199 w/10 holes - Halliburton fraced w/680 bbl. water & 25,000# 20-40 sand Set bridge plug @ 1150' Perforated 1126 to 1146' w/14 holes Fraced w/655 bbl. water & 25,000# 20-40 sand</p>							

Date May 16, 19 69

APPROVED WESTRANS PETROLEUM, INC., Owner

By Thomas H. Richard
 (Title) Vice President