



1) Date: February 4, 19 83
 2) Operator's Well No. Mon. Power 6
 3) API Well No. 47 073 1597
 State County Permit

DRILLING CONTRACTOR:

Union Drilling, Inc.

STATE OF WEST VIRGINIA
DEPARTMENT OF MINES, OIL AND GAS DIVISION

P.O. Drawer 40
Buckhannon, WV 26201

OIL AND GAS WELL PERMIT APPLICATION

- 4) WELL TYPE: A Oil / Gas _____
 B (If "Gas", Production _____ / Underground storage _____ / Deep _____ / Shallow _____)
- 5) LOCATION: Elevation: 990' Watershed: McElroy Run
 District: Grant County: Pleasants Quadrangle: Willow Island 7.5
- 6) WELL OPERATOR Jenkins Energy Corp. 11) DESIGNATED AGENT Carl Davis
 Address P.O. Box 980 Address P.O. Box 980
Bridgeport, WV 26330 Bridgeport, WV 26330
- 7) OIL & GAS ROYALTY OWNER Monongahela Power Co. et, al 12) COAL OPERATOR None
 Address _____ Address _____
 Acreage _____
- 8) SURFACE OWNER Monongahela Power Co. 13) COAL OWNER(S) WITH DECLARATION ON RECORD:
 Address _____ Name None
 Address _____
 Name _____
 Address _____
- 9) FIELD SALE (IF MADE) TO:
 Address _____
- 10) OIL & GAS INSPECTOR TO BE NOTIFIED
 Name Robert Lowther
 Address General Delivery
Middlebourne, WV 26140
- 15) PROPOSED WORK: Drill / Drill deeper _____ / Redrill _____ / Fracture or stimulate _____
 Plug off old formation _____ / Perforate new formation _____ / FEB 7 - 1983
 Other physical change in well (specify) _____
- 16) GEOLOGICAL TARGET FORMATION, Devonian Shale OIL AND GAS DIVISION
 WV DEPARTMENT OF MINES
- 17) Estimated depth of completed well, 5100' feet
 18) Approximate water strata depths: Fresh, 70 feet; salt, None feet.
 19) Approximate coal seam depths: None Is coal being mined in the area? Yes _____ / No _____

RECEIVED

20) CASING AND TUBING PROGRAM

CASING OR TUBING TYPE	SPECIFICATIONS				FOOTAGE INTERVALS		CEMENT FILL-UP OR SACKS (Cubic feet)	PACKERS
	Size	Grade	Weight per ft.	New	Used	For drilling		
Conductor	11 3/4				X	75'	All	CTS Kinds
Fresh water								
Coal								Sizes
Intermediate	8 5/8	J-55		X		1000'	All	CTS Depths set
Production	4 1/2	J-55		X		5100		550
Tubing								
Liners								Perforations: Top Bottom

21) EXTRACTION RIGHTS

- Check and provide one of the following:
 Included is the lease or leases or other continuing contract or contracts by which I hold the right to extract oil or gas.
 The requirement of Code 22-4-1-(c) (1) through (4). (See reverse side for specifics.)

22) ROYALTY PROVISIONS

Is the right to extract, produce or market the oil or gas based upon a lease or other continuing contract or contracts providing for flat well royalty or any similar provision for compensation to the owner of the oil or gas in place which is not inherently related to the volume of oil or gas so extracted, produced or marketed? Yes No

If the answer above is No, nothing additional is needed. If the answer is Yes, you may use Affidavit Form IV-60.

23) Required Copies (See reverse side.)

24) Copies of this Permit Application and the enclosed plat and reclamation plan have been mailed by registered mail or delivered by hand to the above named coal operator, coal owner(s), and coal lessee on or before the day of the mailing or delivery of this Permit Application to the Department of Mines at Charleston, West Virginia.

Notary: Patricia L Moore
 My Commission Expires January 13, 1993

Signed: Carlton Davis
 Its: DESIGNATED AGENT

OFFICE USE ONLY

Permit number 47-073-1597 **DRILLING PERMIT** February 9 19 83

This permit covering the well operator and well location shown below is evidence of permission granted to drill in accordance with the pertinent legal requirements subject to the conditions contained herein and on the reverse hereof. **Notification must be given to the District Oil and Gas Inspector. (Refer to No. 10) Prior to the construction of roads, locations and pits for any permitted work.** In addition, the well operator or his contractor shall notify the proper district oil and gas inspector 24 hours before actual permitted work has commenced.)

Permit expires October 9, 1983 unless drilling is commenced prior to that date and prosecuted with due diligence.

Bond: <u>Blanket</u>	Agent: <u>ls</u>	Plat: <u>Pl</u>	Casing: <u>Pl</u>	Fee: <u>1309</u>
----------------------	------------------	-----------------	-------------------	------------------

[Signature]
 Administrator, Office of Oil and Gas

Line Item Explanation

- 1) Date of Application
- 2) Your well name and number
- 3) To be filled out by office of oil & gas
- 4A) "Oil" means natural crude oil or petroleum and other hydrocarbons, regardless of gravity, which are produced at the well in liquid form by ordinary production methods and which are not the result of condensation of gas after it leaves underground reservoirs: "Gas" means all natural gas and all other fluid hydrocarbons not defined as oil.
- 4B) "Shallow well" means any well drilled and completed in a formation above the top of the uppermost member of the "Onondaga Group" or a depth less than six thousand feet, whichever is shallower.
 "Deep well" means any well drilled and completed in a formation at or below the top of the uppermost member of the "Onondaga Group" or at a depth less than six thousand feet, whatever is shallower.
- 5) Where well is located
- 6) Before a permit can be issued in a corporation, company partnership, or fictitious name, the name must be registered with the Secretary of State Office
- 7) Use separate sheet if necessary
- 8) Present surface owner at time application is filed.
- 9) Optional
- 11) See Reg. 7.01 relating to code §22-4-1k
- 12) "Coal Operator" means any persons, firm, partnership, partnership association or corporation that proposes to or does operate a coal mine. See Note 24
- 13 & 14) As per §22-4-20; See Note 24
- 15) Work that will be attempted—A separate Form IV-2 shall not be required for fracturing or stimulating a well where fracturing or stimulating is to be part of the work for which a permit is sought and is noted as such on the Form IV-2 filed in connection therewith.
- 16) Anticipated formation for which well will be completed
- 17) Self explanatory
- 18) Depth to deepest freshwater, and shallowest salt water, taken from nearby wells corrected for differences in elevation
- 19) All coal seam depths
- 20) Proposed casing program and cementing refer to Code 22-4-5, 22-4-6, 22-4-7, 22-4-8, 22-4-8a Reg 9.01, 15.01, 15.02, 15.03, 15.04, 25.01, 25.02, 25.03, 25.04
- 21) Code 22-4-11(c) - In lieu of filing the lease or leases or other continuing contract or contracts, the applicant for a permit described herein may file the following:
 - (1) A brief description of the tract of land including the district and county wherein the tract is located;
 - (2) The identification of all parties to all leases or other continuing contractual agreements by which the right to extract, produce or market the oil or gas is claimed;
 - (3) The book and page number wherein each such lease or contract by which the right to extract, produce or market the oil or gas is recorded;
 - (4) A brief description of the royalty provisions of each such lease or contract.
- 22) Code 22-4-11(d) and 22-4-11(e).
- 23) Regulation 7.02 of the Department of Mines provides that the original and four copies of Form IV-2 must be filed with the Department, accompanied by (i) a plat in the form prescribed by Regulation 11, (ii) a bond in one of the forms prescribed by Regulation 12, or in lieu thereof the other security allowed by Code §22-4-2, (iii) Form IV-9, "Reclamation Plan", applicable to the reclamation required by Code §22-4-12b and Regulation 23, (iv) unless previously paid on the same well, the fee required by Code §22-4-12a, and (v) if applicable, the consent required by Code §22-4-8a from the owner of any water well or dwelling within 200 feet of the proposed well.
- 24) **The above named coal operator, coal owner(s), and coal lessee are hereby notified that any objection they wish to make or are required to make by Code §22-4-3 must be filed with the Department of Mines within fifteen (15) days after the receipt of this Application by the Department.**

The following waiver must be completed by the coal operator and by any coal owner or coal lessee who has recorded a declaration under Code 22-4-20, if the permit is to be issued within fifteen (15) days of receipt thereof.

WAIVER

The undersigned coal operator _____ / owner _____ / lessee _____ / of the coal under this well location has examined this proposed well location. If a mine map exists which covers the area of the well location, the well location has been added to the mine map. The undersigned has no objection to the work proposed to be done at this location, provided, the well operator has complied with all applicable requirements of the West Virginia Code and the governing regulations.

Date: _____, 19_____

By _____

Its _____

Item 21

The lands to which this application applies are a part of a 1270.047 acre oil and gas lease, located in Pleasants Co. WV. The lands are a part of the Pleasants Power Station operated by Monongahela Power Company. The property is located in Grant District and lies southeast of State Route 2 on the waters of McElroy Run.

The lands to be developed are a part of that certain oil and gas lease by and between MONONGAHELA POWER COMPANY, an Ohio corporation, THE POTOMAC EDISON COMPANY, a Maryland and Virginia corporation, and WEST PENN POWER COMPANY, a Pennsylvania corporation, as lessors and GENE STALNAKER, INC. as lessee, recorded in Book 176, Page 88 in the County Clerks Office, Pleasants Co. WV. Said lease being further assigned to COLBURN ENERGY CORPORATION, a Delaware corporation which assignment of oil and gas lease is recorded in Book 178, Pages 526 to 552 in the County Clerks Office of Pleasants Co., WV.

JENKINS ENERGY CORPORATION rights to the leasehold estate are derived from a Drilling and Operating Agreement dated December 21, 1982. This agreement designates Jenkins Energy Corporation as operator of the property for and in behalf of Colburn Energy Corporation. This contract is not of record. Lessors retain 15.25% of the market value of all oil and gas produced as a royalty.

ITEM #21 EXTRACTION RIGHTS

CODE 22-4-11 (C)

Attachment to Form IV-2. (6/82)

Oil and Gas Well Permit Application

RECEIVED

FEB 7 - 1983

OIL AND GAS DIVISION
WV DEPARTMENT OF MINES

#1019

IV-9
(Rev 8-81)



DATE July 13, 1982
WELL NO. MON-POWER NO. 6
API NO. 047 - 073 - 1597

State of West Virginia
Department of Mines
Oil and Gas Division

CONSTRUCTION AND RECLAMATION PLAN

COMPANY NAME DAVIS JENKINS-Jenkins Energy Corp DESIGNATED AGENT Carl Davis
Address P.O. BOX 980 BRIDGEPORT, WV 26330 Address P.O. BOX 980 BRIDGEPORT, WV 26330
Telephone 622-3837 Telephone 622-3837

LANDOWNER MONONGAHELA POWER CO. SOIL CONS. DISTRICT UPPER OHIO
Revegetation to be carried out by DAVIS JENKINS - Jenkins Energy Corp. (Agent)

This plan has been reviewed by Upper Ohio SCD. All corrections and additions become a part of this plan: 9/22/82 (Date)
Kenneth R. Mason (SCD Agent) **RECEIVED** FEB 7 - 1983

ACCESS ROAD	LOCATION	OIL AND GAS DIVISION WV DEPARTMENT OF MINES
Structure <u>DRAINAGE DITCH</u> (A)	Structure <u>DIVERSION DITCH</u> (1)	
Spacing <u>N/A</u>	Material <u>EARTHEN</u>	
Page Ref. Manual <u>2-12</u>	Page Ref. Manual <u>2-12</u>	
Structure <u>CROSS DRAIN</u> (B)	Structure <u>SEDIMENT BARRIER</u> (2)	
Spacing <u>AS REQUIRED PER GRADE</u>	Material <u>LOGS & BRUSH</u>	
Page Ref. Manual <u>2-1</u>	Page Ref. Manual <u>2-16</u>	
Structure <u>ROAD CULVERT</u> (C)	Structure _____ (3)	
Spacing <u>one 16"</u>	Material _____	
Page Ref. Manual <u>2-7</u>	Page Ref. Manual _____	

All structures should be inspected regularly and repaired if necessary. All commercial timber is to be cut and stacked and all brush and small timber to be cut and removed from the site before dirt work begins.

REVEGETATION

Treatment Area I	Treatment Area I
Lime _____ Tons/acre or correct to pH <u>6.5</u>	Lime _____ Tons/acre or correct to pH _____
Fertilizer <u>600</u> lbs/acre (10-20-20 or equivalent)	Fertilizer _____ lbs/acre (10-20-20 or equivalent)
Mulch <u>HAY</u> 2 Tons/acre	Mulch _____ Tons/acre
Seed* <u>KY-31</u> 35 lbs/acre	Seed* _____ lbs/acre
<u>LADINO CLOVER</u> 5 lbs/acre	_____ lbs/acre
_____ lbs/acre	_____ lbs/acre

*Inoculate all legumes such as vetch, trefoil and clovers with the proper bacterium. Inoculate with 3X recommended amount.

PLAN PREPARED BY SMITH LAND SURVEYING CO.

ADDRESS 111 SOUTH STREET
GLENVILLE, WV 26351
PHONE NO. 304-462-5634

NOTES: Please request landowners' cooperation to protect new seedling for one growing season. Attach separate sheets as necessary for comments.

ATTACH OR PHOTOCOPY SECTION OF INVOLVED TOPOGRAPHIC MAP. QUADRANGLE WILLOW ISLAND 7.5'

LEGEND











Well Site 

Access Road 

WELL SITE PLAN

Sketch to include well location, existing access road, roads to be constructed, wellsite, drilling pits and necessary structures numbered or lettered to correspond with the first part of this plan. Include all natural drainage.

LEGEND

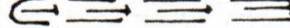
Property boundary 	Diversion 
Road 	Spring 
Existing fence 	Wet spot 
Planned fence 	Building 
Stream 	Drain pipe 
Open ditch 	Waterway 

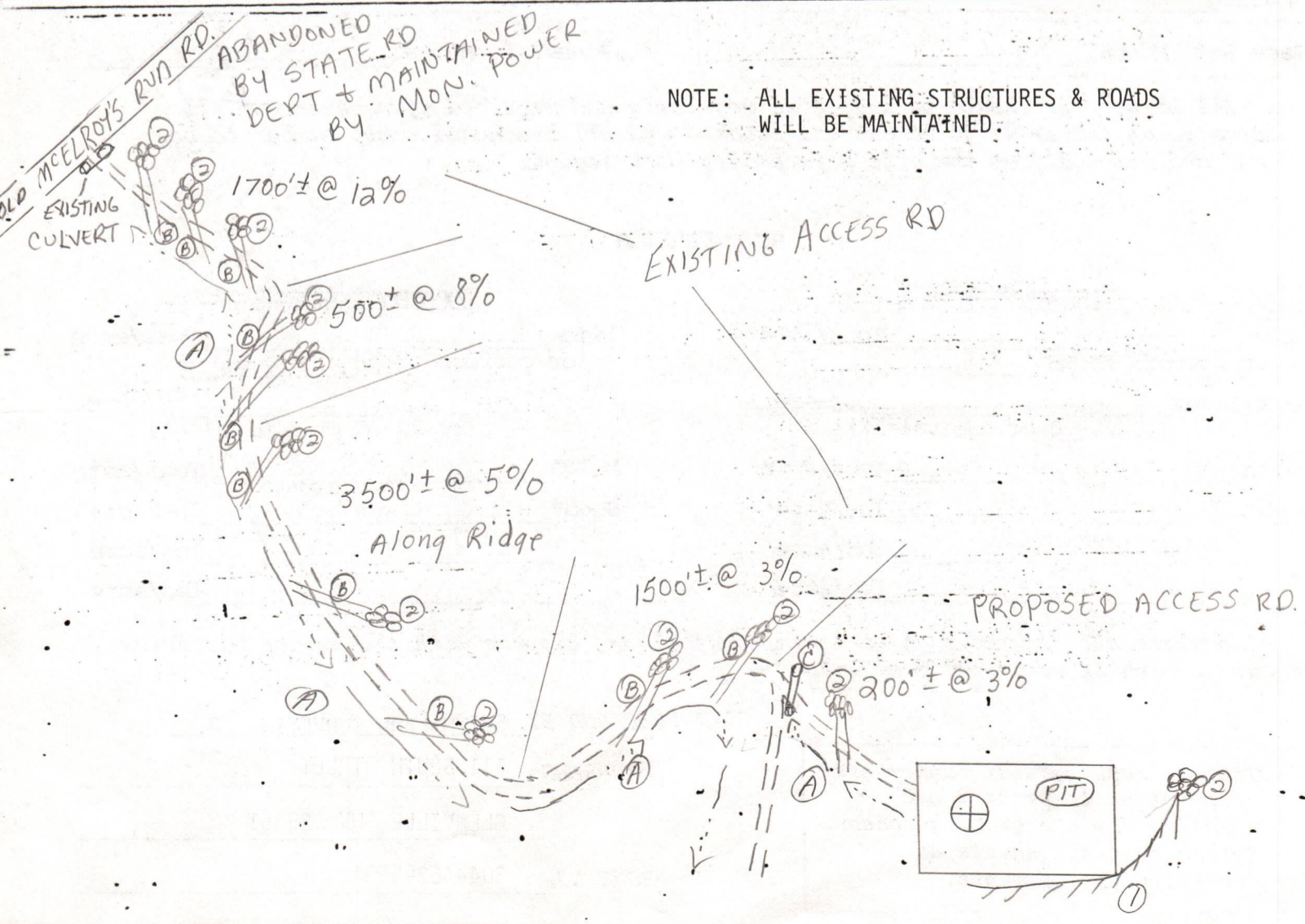

STATE OF WEST VIRGINIA
REPRESENTED BY THE
STATE OF WEST VIRGINIA GEOLOGICAL SURVEY
AND OTHER STATE AGENCIES

4762 1/4 NE
(BELMONT)
NEW MATAMORAS 17 MI
NEWPORT 4.8 MI
17°30' 47.5"

ST MARYS 4 MI
BELMONT 1 MI
476 1 500 000 FEET (W. VA.)

WILLOW ISLAND QUADRANGLE
WEST VIRGINIA-OHIO
7.5 MINUTE SERIES (TOPOGRAPHIC)
SE/4 MARIETTA 15 QUADRANGLE
4762 1 NW
(RAVEN ROCK)
81° 15' 39.22' 30"



073-1597

AN OPERATING UNIT OF THE DOW CHEMICAL COMPANY

REMIT TO:

DOWELL DIVISION
DOW CHEMICAL USA
P O BOX 360182
PITT, PA 15230

INVOICE DATE

05/19/83

PAGE

1

INVOICE NUMBER

01-32-0419

740743
GENE STALNAKER INC

P O BOX 178
GLENVILLE

WV 26351

TYPE SERVICE

CEMENTING
SURFACE/CONDUCTO

JOB SITE	STATE	COUNTY/CITY	SERVICE FROM LOCATION	SHIPPED VIA	CUSTOMER P.O. NO./REF
MCELROY RUN	WV	PLEASANTS	BELPRE, OHIO	DOWELL	VERBAL
JOB LOCATION			DATE OF SERVICE ORDER	AUTHORIZED BY	
GRANT DIST			05/18/83	FRANK AMOS	

ITEM NUMBER	QUANTITY	U/M	DESCRIPTION	UNIT PRICE	AMOUNT
044003025	25	LBS	D29, CELLOPHANE FLAKES	1.10	27.50
056008085	1	EA	BASKET CEMG CASING 8-5/8"	180.00	180.00
050101085	1	EA	SHOE CEM TYPE GUIDE 8-5/8"	190.00	190.00
056702085	1	EA	PLUG CEMG 8-5/8" TOP PLASTIC	70.00	70.00
048002006	1	EA	CASING CMTR, 1001-2000 FT	756.00	756.00
049100000	286	CFT	SERVICE CHG CEMENT MATL LAND	.91	260.26
059200001	15	MI	MILEAGE, EACH SERVICE TRUCK	2.10	31.50
049102001	194	MI	TRANSPORTATION CMNT EQUALIZE	.75	145.50
040001000	205	CFT	D901, CEMENT CLASS A	5.80	1,189.00
045008000	70	CFT	D35, LITEPOZ 3 EXTENDER	2.75	192.50
000401002	140	CFT	D20, BENTONITE BLD-1-4%	0.00	0.00
067005100	700	LBS	S1, DOWFLAKE CALCIUM CHLORIDE	.25	175.00
045014002	500	LBS	D20C, BENTONITE EXTENDER	.12	60.00
DOWELL					
SUB TOTAL --					3,277.76

TERMS

NET AMOUNT DUE 30 DAYS FROM DATE OF INVOICE

WITH QUESTIONS ABOUT YOUR ACCOUNT CALL 713-978-3251
OR WRITE TO DOWELL, CUSTOMER FINANCIAL SERVICES,
P O BOX 4378, HOUSTON, TEXAS 77210

**PAY THIS
AMOUNT** 

3,277.76

INVOICE

AN OPERATING UNIT OF THE DOW CHEMICAL COMPANY

REMIT TO: DOWELL DIVISION
DOW CHEMICAL USA
P O BOX 360182
PITT, PA 15230

INVOICE DATE

05/23/83

INVOICE NUMBER

01-32-0429

740743
GENE STALNAKER INC

P O BOX 178
GLENVILLE

WV 26351

PAGE

1

TYPE SERVICE

CEMENTING
LONG STRING

JOB SITE	STATE	COUNTY/CITY	SERVICE FROM LOCATION	SHIPPED VIA	CUSTOMER P.O. NO./REF.
MON-POWER #6	WV	PLEASANTS	BELPRE, OHIO	DOWELL	VERBAL
JOB LOCATION			DATE OF SERVICE ORDER	AUTHORIZED BY	
GRANT DIST			05/23/83	FRANK STALNAKER	

ITEM NUMBER	QUANTITY	U/M	DESCRIPTION	UNIT PRICE	AMOUNT
048016006	1	STG	CEMENTER-MULTISTAGE-SGLPMP	650.00	650.00
054001044	1	EA	COLLAR 2 STG CEM 4-1/2"	2,285.00	2,285.00
056008044	4	EA	BASKET CEMG CASING 4-1/2"	105.00	420.00
048005006	1	EA	CASING CMTR, 4001-5000 FT	1,090.00	1,090.00
000423001	273	CFT	D804, CMT REGULATED FILLUP/A	8.70	2,375.10
100283000	420	GAL	D827, CHEMICAL WASH CW100	.61	256.20
045014002	250	LBS	D20C, BENTONITE EXTENDER	.12	30.00
045019050	2750	LBS	D42, KOLITE LOST CIRC ADDITI	.34	935.00
000423001	267	CFT	D804, CMT REGULATED FILLUP/A	8.70	2,322.90
100283000	420	GAL	D827, CHEMICAL WASH CW100	.61	256.20
045019050	2650	LBS	D42, KOLITE LOST CIRC ADDITI	.34	901.00
049100000	735	CFT	SERVICE CHG CEMENT MATL LAND	.91	668.85
049102001	313	MI	TRANSPORTATION CMNT EQUALIZE	.75	234.75
059200001	10	MI	MILEAGE, EACH SERVICE TRUCK	2.10	21.00
051003044	1	EA	SHOE FLPR FLT AL 4-1/2"	190.00	190.00
053031044	1	EA	INSERT W/FLEX PLUG 4-1/2"	280.00	280.00
SUB TOTAL --					12,916.00

TERMS NET AMOUNT DUE 30 DAYS FROM DATE OF INVOICE

WITH QUESTIONS ABOUT YOUR ACCOUNT CALL 713-978-3251
OR WRITE TO DOWELL, CUSTOMER FINANCIAL SERVICES,
P O BOX 4378, HOUSTON, TEXAS 77210

PAY THIS AMOUNT ➔

12,916.00

STATE OF WEST VIRGINIA
DEPARTMENT OF MINES
OIL AND GAS WELLS DIVISION

INSPECTOR'S WELL REPORT

 Permit No. 073-1597

 Oil or Gas Well _____
(KIND)

	CASING AND TUBING	USED IN DRILLING	LEFT IN WELL	PACKERS
Company <u>Jenkins Energy corp</u>	Size			
Address <u>Bridgeport w. Va</u>	16			Kind of Packer _____
Farm <u>Monongahela power</u>	13			
Well No. <u>6</u>	10			Size of _____
District <u>Grant</u> County <u>Pleasant</u>	8 1/4			
Drilling commenced <u>5-16-83</u>	6 5/8			Depth set _____
Drilling completed _____ Total depth <u>812</u>	5 3/16			
Date shot _____ Depth of shot _____	3			Perf. top _____
Initial open flow _____ /10ths Water in _____ Inch	2			Perf. bottom _____
Open flow after tubing _____ /10ths Merc. in _____ Inch	Liners Used			Perf. top _____
Volume _____ Cu. Ft.				Perf. bottom _____

CASING CEMENTED _____ SIZE _____ No. FT. _____ Date _____
 NAME OF SERVICE COMPANY _____
 COAL WAS ENCOUNTERED AT _____ FEET _____ INCHES
 _____ FEET _____ INCHES _____ FEET _____ INCHES
 _____ FEET _____ INCHES _____ FEET _____ INCHES

Drillers' Names

Frank Amos Tool pusher
Gene Stalnaker Contractor

Remarks:

RECEIVED

MAY 23 1983

OIL & GAS DIVISION
DEPT. OF MINES

5-18-83

DATE

R.A. Lowther

DISTRICT WELL INSPECTOR

DATE

I hereby certify I visited the above well on this date.

DISTRICT WELL INSPECTOR



IV-35
(Rev 8-81)

RECEIVED
MAR 7 - 1985

OIL & GAS DIVISION
DEPT. OF MINES State of West Virginia
Department of Mines
Oil and Gas Division

Date March 6, 1985
Operator's Well No. Mon-Power # 6
Farm Mon-Power
API No. 47 - 073 - 1597

WELL OPERATOR'S REPORT
OF
DRILLING, FRACTURING AND/OR STIMULATING, OR PHYSICAL CHANGE

WELL TYPE: Oil ___ / Gas x / Liquid Injection ___ / Waste Disposal ___ /
(If "Gas," Production x / Underground Storage ___ / Deep ___ / Shallow x /)

LOCATION: Elevation: 990 Watershed McElroy Run
District: Grant County Pleasants Quadrangle Willow Island 7.5

COMPANY Gene Stalnaker, Inc.
ADDRESS P.O. Box 178 Glenville, WV
DESIGNATED AGENT Gene Stalnaker
ADDRESS P.O. Box 178 Glenville, WV 26351
SURFACE OWNER Monongahela Power Company
ADDRESS Fairmont Ave. Fairmont, WV
MINERAL RIGHTS OWNER Monongahela Power Company
ADDRESS Fairmont Ave. Fairmont, WV
OIL AND GAS INSPECTOR FOR THIS WORK Robert Lowther
ADDRESS Middlebourne, WV
PERMIT ISSUED February 9, 1983
DRILLING COMMENCED May 13, 1983
DRILLING COMPLETED May 23, 1984
IF APPLICABLE: PLUGGING OF DRY HOLE ON CONTINUOUS PROGRESSION FROM DRILLING OR REWORKING. VERBAL PERMISSION OBTAINED ON _____

Casing & Tubing	Used in Drilling	Left in Well	Cement fill up Cu. ft.
Size 20-16 Cond.			
13-10"			
9 5/8			
8 5/8	1150	1123	245 sks
7			
5 1/2			
4 1/2	5059	4909	539 sks.
3			
2			
Liners used			

GEOLOGICAL TARGET FORMATION Marcellus Shale Depth 5200 feet
Depth of completed well 4909 feet Rotary X / Cable Tools _____
Water strata depth: Fresh None feet; Salt 1400 feet
Coal seam depths: n/a Is coal being mined in the area? No

OPEN FLOW DATA

Producing formation Devonian Shale Pay zone depth 2058-4402 feet
Gas: Initial open flow _____ Mcf/d Oil: Initial open flow _____ Bbl/d
Final open flow n/a Mcf/d Final open flow n/a Bbl/d
Time of open flow between initial and final tests n/a hours
Static rock pressure n/a psig (surface measurement) after n/a hours shut in
(If applicable due to multiple completion--)
Second producing formation _____ Pay zone depth _____ feet
Gas: Initial open flow _____ Mcf/d Oil: Initial open flow _____ Bbl/d
Final open flow _____ Mcf/d Oil: Final open flow _____ Bbl/d
Time of open flow between initial and final tests _____ hours
Static rock pressure _____ psig (surface measurement) after _____ hours shut in

(Continue on reverse side)

PLEASANTS 1597

DETAILS OF PERFORATED INTERVALS, FRACTURING OR STIMULATING, PHYSICAL CHANGE, ETC.
 Perforating started in the Gantz section with the top perforation at 2058' and continued with 68 pers through the Kane stage with the bottom perforation at 4402'. There was a 4 stage fracturing job covering the Kane, Elk, Balltown and Gordon formation. We feel that the flow of oil and gas was increased from what was originally encountered due to the operation.

WELL LOG

FORMATION	COLOR	HARD OR SOFT	TOP FEET	BOTTOM FEET	REMARKS Including indication of all fresh and salt water, coal, oil and gas
Soil			0	10	
Sandstone & Shale			10	100	
Sandstone & Shale			100	500	
Sandstone & Shale			500	1000	
Shale			1000	1273	
Sandstone			1273	1345	
Shale			1345	1354	
Greenbrier Limestone			1354	1473	
Shale			1473	1504	
Big Injun			1504	1532	
Shale			1532	1535	
Squaw			1535	1552	
Shale			1552	1936	
Berea			1936	1940	
Shale			1940	2830	
Warren			2830	2860	
Shale			2860	3160	
Speechly			3160	3222	
Shale			3222	3479	
Balltown			3479	3550	
Shale			3550	4378	
Benson			4378	4404	
Shale			4404	5059	

(Attach separate sheets as necessary)

Gene Stalnaker, Inc.

Well Operator

By: Gene Stalnaker

Date: 3-6-85

Note: Regulation 2.02(i) provides as follows:
 "The term 'log' or 'well log' shall mean a systematic detailed geological record of all formations, including coal, encountered in the drilling of a well."

STATE OF WEST VIRGINIA
DEPARTMENT OF MINES
OIL AND GAS WELLS DIVISION

RECEIVED

MAY 23 1983

INSPECTOR'S WELL REPORT

Permit No. 073-1597

OIL & GAS DIVISION
DEPT. OF MINES
(KIND)

Company Jenkins Energy
 Address Bridgeport w. Va.
 Farm Monongahela power
 Well No. 6
 District Grant County Pleasant
 Drilling commenced _____
 Drilling completed _____ Total depth 1150
 Date shot _____ Depth of shot _____
 Initial open flow _____ /10ths Water in _____ Inch
 Open flow after tubing _____ /10ths Merc. in _____ Inch
 Volume _____ Cu. Ft.
 Rock pressure _____ lbs. _____ hrs.
 Oil _____ bbls., 1st 24 hrs.
 Fresh water _____ feet _____ feet
 Salt water _____ feet _____ feet

CASING AND TUBING	USED IN DRILLING	LEFT IN WELL	PACKERS
Size			
16			Kind of Packer _____
13			
10			Size of _____
8 1/4	1123	1123	
6 5/8			Depth set _____
5 3/16			
3			Perf. top _____
2			Perf. bottom _____
Liners Used			Perf. top _____
			Perf. bottom _____

CASING CEMENTED 8 5/8 SIZE 1123 No. ET 5-19-83 Date
 NAME OF SERVICE COMPANY Dowell
 COAL WAS ENCOUNTERED AT _____ FEET _____ INCHES
 _____ FEET _____ INCHES FEET _____ INCHES
 _____ FEET _____ INCHES FEET _____ INCHES

Drillers' Names _____

Remarks: _____

5-19-83

DATE

R. A. Lowther
DISTRICT WELL INSPECTOR

STATE OF WEST VIRGINIA
DEPARTMENT OF MINES
OIL AND GAS WELLS DIVISION

RECEIVED
MAY 31 1983
OIL & GAS DIVISION
DEPT. OF MINE

INSPECTOR'S WELL REPORT

Permit No. 073-1597

Oil or Gas Well _____
(KIND)

Company	CASING AND TUBING	USED IN DRILLING	LEFT IN WELL	PACKERS
Jenkins Energy	Size			
Address Bridgeport W. Va	16			Kind of Packer
Farm Monongahela power	13			
Well No. 6	10			Size of
District Grant County Pleasant	8 3/4			
Drilling commenced	6 3/4			Depth set
Drilling completed 5-22-83 Total depth 5050	5 3/16	4909	4909	
Date shot _____ Depth of shot _____	3			Perf. top
Initial open flow _____ /10ths Water in _____ Inch	2			Perf. bottom
Open flow after tubing _____ /10ths Merc. in _____ Inch	Liners Used			Perf. top
Volume _____ Cu. Ft.				Perf. bottom
Rock pressure _____ lbs. _____ hrs.	CASING CEMENTED <u>4 1/2</u> SIZE <u>4909</u> No. FT <u>5-22-83</u> Date			
Oil _____ bbls., 1st 24 hrs.	NAME OF SERVICE COMPANY <u>Dowell</u>			
Fresh water _____ feet _____ feet	COAL WAS ENCOUNTERED AT _____ FEET _____ INCHES			
Salt water _____ feet _____ feet	_____ FEET _____ INCHES _____ FEET _____ INCHES			
	_____ FEET _____ INCHES _____ FEET _____ INCHES			

Drillers' Names _____

Remarks: _____

5-26-83
DATE

R.A. Lowther
DISTRICT WELL INSPECTOR

STATE OF WEST VIRGINIA
DEPARTMENT OF MINES
OIL AND GAS DIVISION
STATUS INSPECTION REQUEST
INSPECTOR'S COMPLIANCE REPORT

RECEIVED

AUG - 7 1984

OIL & GAS DIVISION
DEPT. OF MINES

Permit No. 073-1597

County. Pleasants

Company. Jenkins Energy Corporation

Farm. Monongahela Power Co.

Inspector. Robert Lowther

Well No. 6

Date. July 30, 1984

Issued. 2-9-83

RULE	DESCRIPTION	IN COMPLIANCE	
		YES	NO
23.06	Notification Prior to starting Work	✓	_____
25.04	Prepared before Drilling to prevent Waste	✓	_____
25.03	High-Pressure Drilling	✓	_____
16.01	Required Permits at Wellsite	✓	_____
15.03	Adequate Fresh Water Casing	✓	_____
15.02	Adequate Coal Casing	_____	_____
15.01	Adequate Production Casing	✓	_____
15.04	Adequate Cement Strength	✓	_____
23.02	Maintained Access Roads	✓	_____
25.01	Necessary Equipment to prevent Waste	✓	_____
23.03	Reclaimed Drilling Site	✓	_____
23.04	Reclaimed Drilling Pits	✓	_____
23.05	No Surface or Underground Pollution	✓	_____
7.03	Identification Markings	✓	_____

COMMENTS: ~~_____~~

This well was drilled

I have inspected the above well and (Have/Have Not) found it to be in compliance with all of the rules and regulations of the Office of Oil and Gas-Department of Mines of the State of West Virginia.

SIGNED: R.A. Lowther

DATE: aug 3, 1984

12/15/84

12/15/84

12/15/84

12/15/84

12/15/84



State of West Virginia
 Department of Mines
 Oil and Gas Division
 Charleston 25305

Barton B. Lay Jr.
 Director

Theodore M. Streit
 Administrator

April 1, 1985

Jenkins Energy Corporation
 P. O. Box 980
 Bridgeport, West Virginia 26330

In Re: PERMIT NO: 47-073-1597
 FARM Monongahela Power Co.
 WELL NO: 6
 DISTRICT: Grant
 COUNTY: Pleasants
 ISSUED: 2-09-83

Gentlemen;

The FINAL INSPECTION REPORT for the above captined well has been received in this office. Only the column checked below applies:

The well designated by the above permit number has been released under your Blanket Bond.

Please return the enclosed cancelled single bond which covered the well designated by the above permit number to the surety company who executed said bond in your behalf, in order that they may give you credit on their records.

Your well record was received and reclamation requirements approved. In accordance with Chapter 22, Article 4, Section 2, the above captined well will remain under bond coverage for life of the well.

Very truly yours,

Theodore M. Streit, Administrator
 Office of Oil & Gas--Dept. Mines

LATITUDE 39°22'30"
39°25'00"

MON-POWER LEASE WELL NO. 6

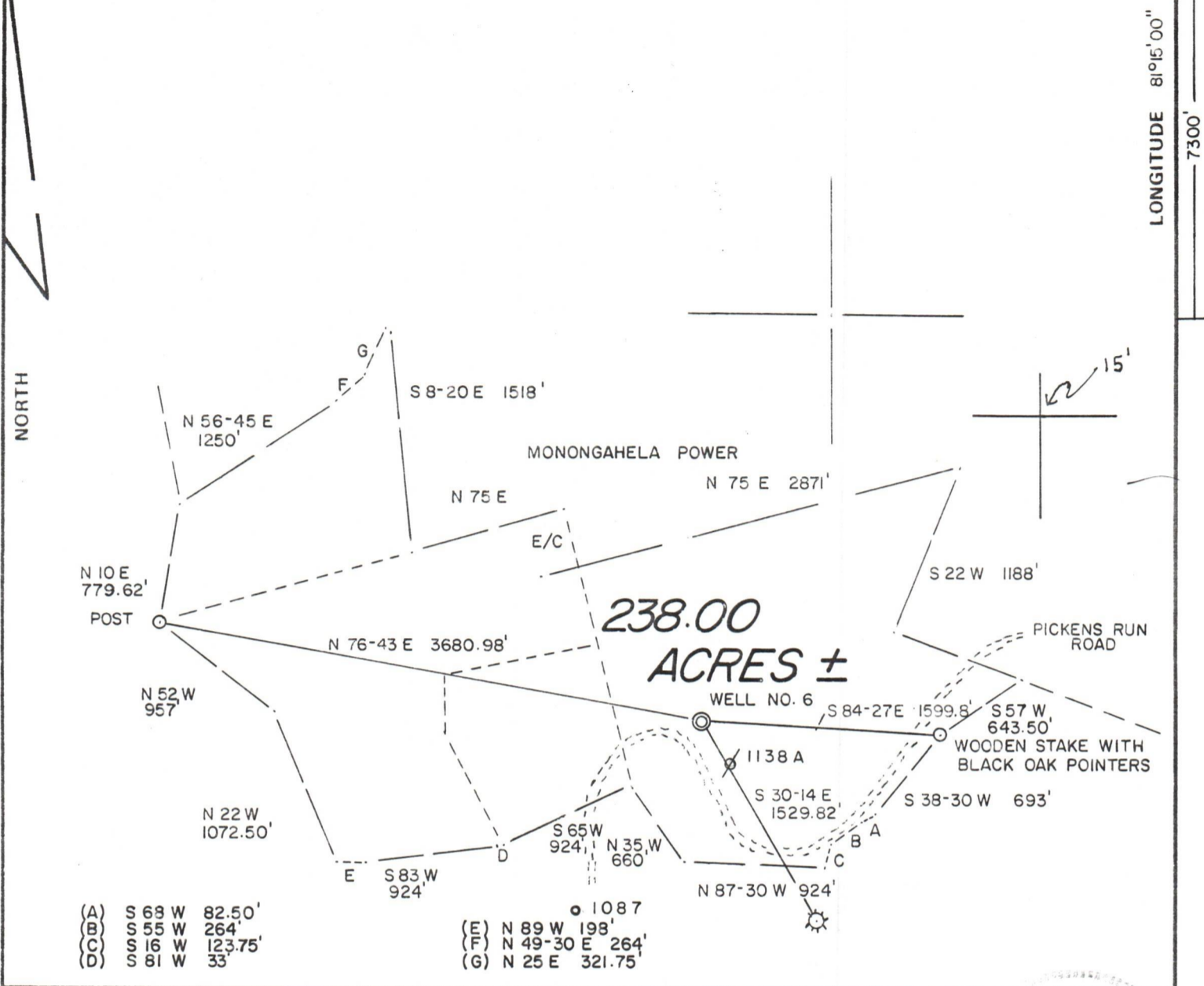

FILE NO. 8-1
DRAWING NO. _____
SCALE 1"=1000'
MINIMUM DEGREE OF ACCURACY 1/200
PROVEN SOURCE OF ELEVATION T.B.M. MON.-POWER CO. ELEV. 826.61'

I THE UNDERSIGNED, HEREBY CERTIFY THAT THIS PLAT IS CORRECT TO THE BEST OF MY KNOWLEDGE AND BELIEF AND SHOWS ALL THE INFORMATION REQUIRED BY LAW AND THE REGULATIONS ISSUED AND PRESCRIBED BY THE DEPARTMENT OF MINES.

(SIGNED) Gregory A. Smith
R.P.E. _____ L.L.S. 677

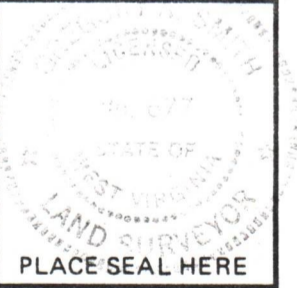

STATE OF WEST VIRGINIA
DEPARTMENT OF MINES
OIL AND GAS DIVISION



DATE JULY 21, 1982
OPERATOR'S WELL NO. 6
API WELL NO. _____
47 - 073 - 1597
STATE COUNTY PERMIT

(+) DENOTES LOCATION OF WELL ON UNITED STATES TOPOGRAPHIC MAPS
WELL TYPE: OIL ___ GAS X LIQUID INJECTION ___ WASTE DISPOSAL ___
(IF "GAS,") PRODUCTION X STORAGE ___ DEEP ___ SHALLOW X
LOCATION: ELEVATION 990' WATER SHED McELROY RUN
DISTRICT GRANT COUNTY PLEASANTS
QUADRANGLE WILLCOW ISLAND 7.5'
SURFACE OWNER MONONGAHELA POWER COMPANY ACREAGE 269.00
OIL & GAS ROYALTY OWNER MONONGAHELA POWER COMPANY LEASE ACREAGE 1158.22
LEASE NO. _____
PROPOSED WORK: DRILL X CONVERT ___ DRILL DEEPER ___ REDRILL ___ FRACTURE OR STIMULATE ___ PLUG OFF OLD FORMATION ___ PERFORATE NEW FORMATION ___ OTHER PHYSICAL CHANGE IN WELL (SPECIFY) _____
PLUG AND ABANDON ___ CLEAN OUT AND REPLUG ___
TARGET FORMATION DEVONIAN SHALE ESTIMATED DEPTH 5100'
WELL OPERATOR JENKINS ENERGY CORP. DESIGNATED AGENT CARL DAVIS
ADDRESS P.O. BOX 980 ADDRESS P.O. BOX 980
BRIDGEPORT, WV 26330 BRIDGEPORT, WV 26330

PLEASANTS 1597