

Latitude 39° 25'

Longitude 81° 15'

Chas. Ruckman, hrs.

Chas. Ruckman, hrs.

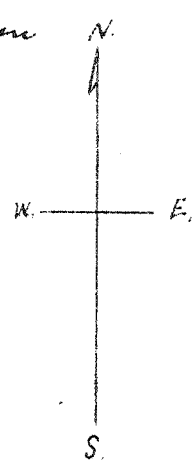
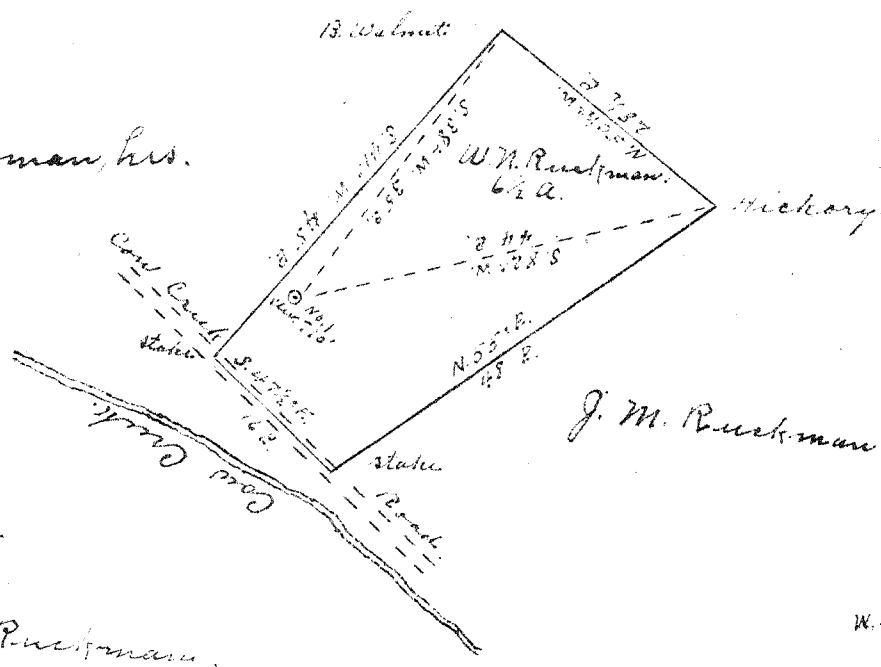

5.44 S
0.28 W

New Location
 Drill Deeper
 Abandonment

Company	Irwin Cooper
Address	St. Marys W.Va.
Farm	W. N. Ruckman
Tract	Acres 6 1/2 Lease No.
Well (Farm) No.	1 Serial No.
Elevation (Spirit Level)	710'
Quadrangle	Marietta O.
County	Pleasants District Jefferson
Engineer	Jno Triplett
Engineer's Registration No.	
File No.	Drawing No.
Date	Oct. 29, 1941 Scale 20 P = 1"

STATE OF WEST VIRGINIA
 DEPARTMENT OF MINES
 OIL AND GAS DIVISION
 CHARLESTON

WELL LOCATION MAP
 FILE NO. PLEAS-178A

+ Denotes location of well on United States Topographic Maps, scale 1 to 62,500, latitude and longitude lines being represented by border lines as shown.
 - Denotes one inch spaces on border line of original tracing.