

TH SHAD 629	BOTTOM HOLE SHAD 629
N) 319104.5	N) 313908.4
E) 1988520.9	E) 1988520.9
LAT.) 39°22'34.0"	LAT.) 39°21'42.7"
LONG.) 79°30'37.9"	LONG.) 79°29'59.7"
DEC. LAT.) 39.378113	DEC. LAT.) 39.361847
DEC. LONG.) 79.510539	DEC. LONG.) 79.499928

TH N 4359573.44  
E 628293.62  
BT N 4358007.02  
E 627297.54

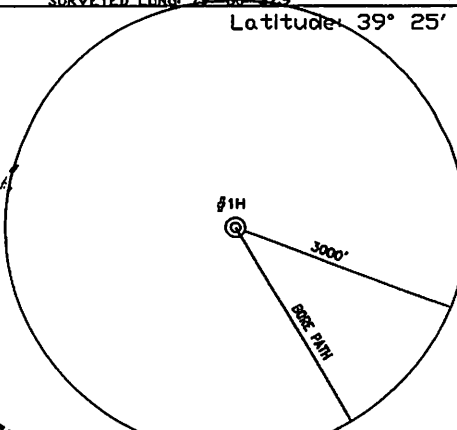

GRIMM LUMBER INC.  
5927.25 TOTAL ACRES  
TAX MAP AND PARCEL  
05-11-4

RAY A. AND  
NAOMI DEBORAH HARDESTY  
207 TOTAL ACRES  
TAX MAP AND PARCEL  
5-6-12

S 81°17'18" W  
895'

S 88°56'33" E  
3017'

GRIMM  
LUMBER #1H

GRIMM LUMBER INC.  
A CORPORATION  
21.33 TOTAL ACRES  
TAX MAP AND PARCEL  
05-12-5

TURNER RD.

ELMER C. GRIMM  
5 TOTAL ACRES  
TAX MAP AND PARCEL  
05-06-06

OVERVIEW

GRIMM LUMBER INC.  
5927.25 TOTAL ACRES  
TAX MAP AND PARCEL  
05-11-4  
LEASE NUMBER  
375997L-599

NTS

WILLIAM AND  
KATHRYN KIFER  
20 TOTAL ACRES  
TAX MAP AND PARCEL  
05-12-4

MICHAEL AND  
LISE MARIE DAUOST  
47.5 TOTAL ACRES  
TAX MAP AND PARCEL  
5-17-3

BOTTOM HOLE  
GRIMM LUMBER  
#1H

REFERENCES

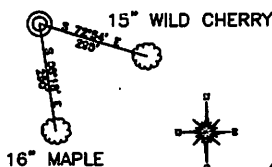

FILE #: CHIEF 001

DRAWING #: BBA 001456

SCALE: 1"=2000'

MINIMUM DEGREE  
OF ACCURACY: 1/200

PROVEN SOURCE SUBMETER MAPPING  
OF ELEVATION: GRADE GPS

I, THE UNDERSIGNED, HEREBY CERTIFY THAT THIS  
PLAT IS CORRECT TO THE BEST OF MY KNOWLEDGE AND  
BELIEF AND SHOWS ALL THE INFORMATION REQUIRED BY  
LAW AND THE REGULATIONS ISSUED AND PRESCRIBED BY  
THE DEPARTMENT OF ENVIRONMENTAL PROTECTION.

Signed: \_\_\_\_\_

L.L.S. #2124 : Ernest J. Benchek III

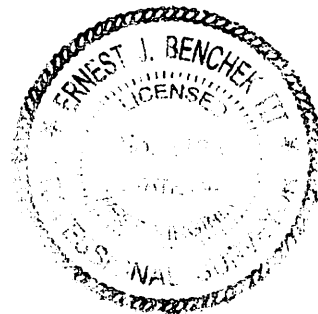

(+) DENOTES LOCATION OF WELL ON  
UNITED STATES TOPOGRAPHIC MAPS  
WVDEP  
OFFICE OF OIL & GAS  
601 57TH STREET  
CHARLESTON, WV 25304

DATE: AUGUST 07, 2010

OPERATOR'S WELL #: GRIMM LUMBER

API WELL #: 47 077 0056749  
STATE COUNTY PERMIT

Well Type:  Oil  Waste Disposal  Production  Deep  
 Gas  Liquid Injection  Storage  Shallow

ELEVATION : 2635'

COUNTY/DISTRICT: PRESTON/UNION

QUADRANGLE: TERRA ALTA 7.5'

SURFACE OWNER: GRIMM LUMBER INC.

ACREAGE: 5,927

OIL & GAS ROYALTY OWNER: GRIMM LUMBER INC.

ACREAGE: 5,927

LEASE NUMBERS: 375997L-599

DRILL  CONVERT  DRILL DEEPER  REDRILL  FRACTURE OR STIMULATE   
PLUG OFF FORMATION  PERFORATE NEW FORMATION  PLUG & ABANDON   
CLEAN OUT & REPLUG  OTHER CHANGE  (SPECIFY): \_\_\_\_\_

TARGET FORMATION: MARCELLUS

ESTIMATED DEPTH: 12,000'

WELL OPERATOR : CHIEF OIL & GAS LLC.

DESIGNATED AGENT : CHAD S. LOVEJOY

ADDRESS: 5956 SHERRY LANE

ADDRESS: 522 NINTH STREET

CITY: DALLAS STATE: TX ZIP CODE: 75225

CITY: HUNTINGTON STATE: WV ZIP CODE: 25701

77-00567A

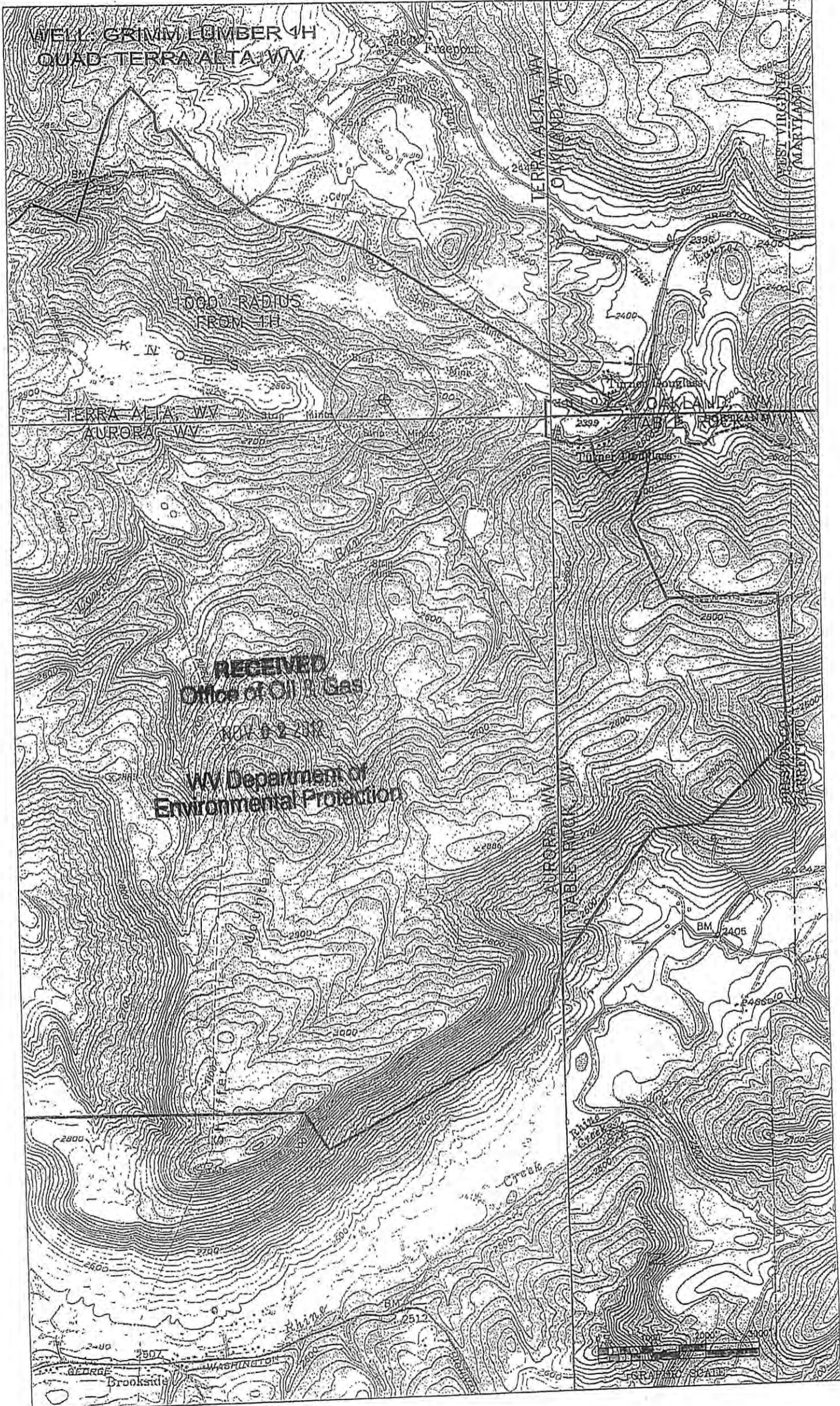

12/14/2012