

77-00628

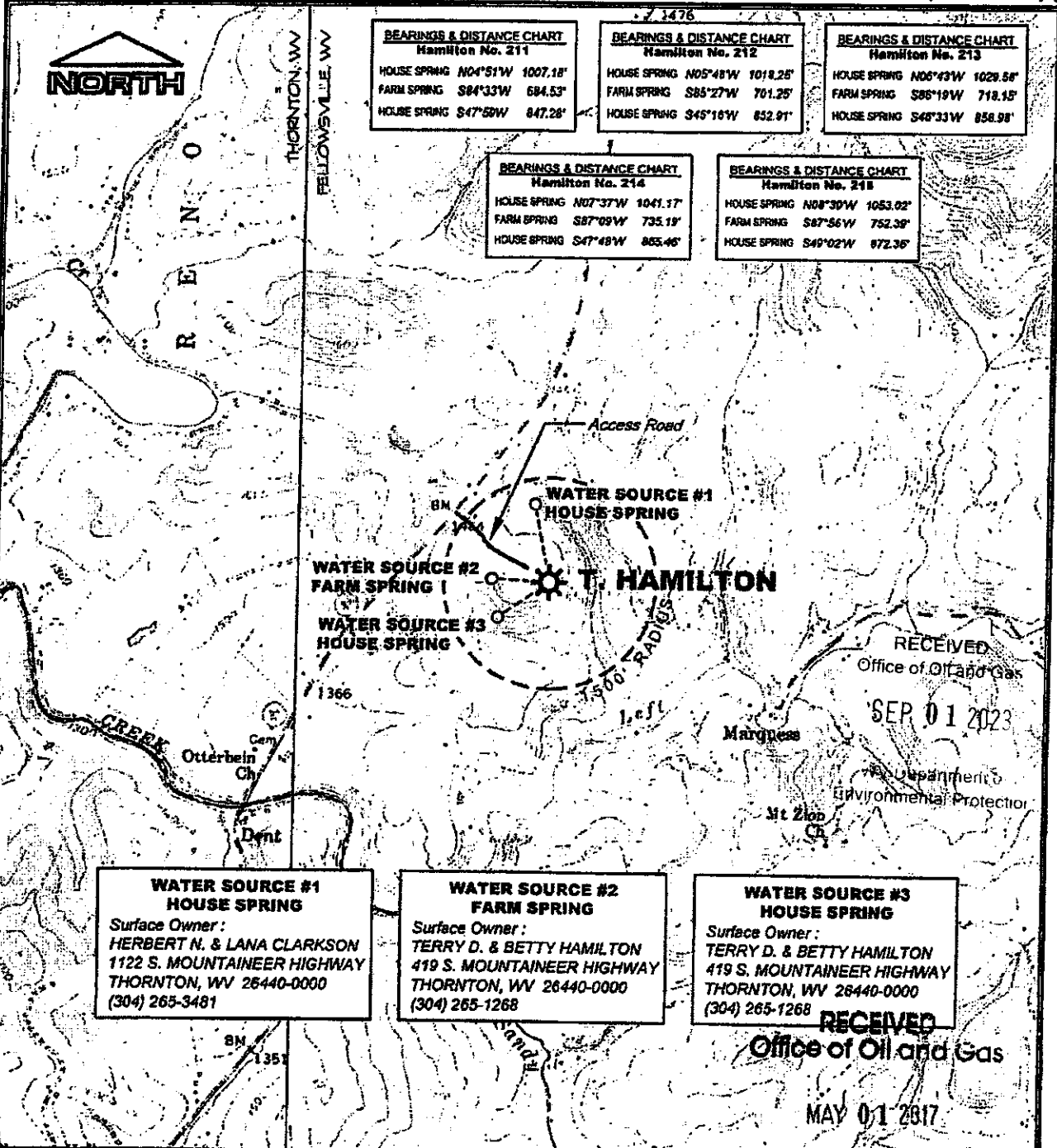

BEARINGS & DISTANCE CHART
Hamilton No. 211

HOUSE SPRING	N04°51'W	1007.18'
FARM SPRING	S84°33'W	684.53'
HOUSE SPRING	S47°50'W	847.28'

BEARINGS & DISTANCE CHART
Hamilton No. 212

HOUSE SPRING	N05°48'W	1018.25'
FARM SPRING	S85°27'W	701.25'
HOUSE SPRING	S45°16'W	852.91'

BEARINGS & DISTANCE CHART
Hamilton No. 213

HOUSE SPRING	N06°43'W	1029.58'
FARM SPRING	S86°19'W	718.15'
HOUSE SPRING	S46°33'W	858.98'

BEARINGS & DISTANCE CHART
Hamilton No. 214

HOUSE SPRING	N07°37'W	1041.17'
FARM SPRING	S87°09'W	735.19'
HOUSE SPRING	S47°49'W	865.46'

BEARINGS & DISTANCE CHART
Hamilton No. 215

HOUSE SPRING	N08°30'W	1053.02'
FARM SPRING	S87°56'W	752.39'
HOUSE SPRING	S49°02'W	872.36'

WATER SOURCE #1
HOUSE SPRING
Surface Owner:
HERBERT N. & LANA CLARKSON
1122 S. MOUNTAINEER HIGHWAY
THORNTON, WV 26440-0000
(304) 265-3481

WATER SOURCE #2
FARM SPRING
Surface Owner:
TERRY D. & BETTY HAMILTON
419 S. MOUNTAINEER HIGHWAY
THORNTON, WV 26440-0000
(304) 265-1268

WATER SOURCE #3
HOUSE SPRING
Surface Owner:
TERRY D. & BETTY HAMILTON
419 S. MOUNTAINEER HIGHWAY
THORNTON, WV 26440-0000
(304) 265-1268

RECEIVED
Office of Oil and Gas
SEP 01 2023
Department of
Environmental Protection

RECEIVED
Office of Oil and Gas
MAY 01 2017

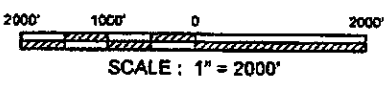

REFERENCE
U.S.G.S. 7.5' TOPOGRAPHIC QUADRANGLES:
FELLOWSVILLE, WV 1958 (P.R. 1976)
THORNTON, WV 1958 (P.R. 1976)

13-284 Hamilton Arsenal Water Source Exhibit

WV Department of
ARSENAL RESOURCES
Environmental Protection

PROPOSED T. HAMILTON WELL
SURROUNDING WATER SOURCES

Drawn by	RLR	2/14
Engineer	DOT	2/14
Checked by	RYS	2/14
	Rev. 4/25/17	Date

Scale: AS SHOWN

Prepared by **MSES consultants, inc.**

1 of 1

08/18/2017

F:\Or-going\Projects\13-284 Mountaineer Keystone Well Survey\13-284 T Hamilton Well\13-284 Hamilton Arsenal Water Source Exhibit.dwg, Hamilton, 4/28/2017 4:37:40 PM, Sharon Cottrell

09/29/2023

Well Map / Parcel	Surface Owner
A - 2511	T. & B. HAMILTON
B - 2772	T. & B. HAMILTON
C - 16136	P. LAREY
D - 18137	D. MATECK
E - 16796	T. & B. HAMILTON
F - 16137	T. & B. HAMILTON
G - 15721	T. & B. HAMILTON
H - 15723	EDWARD RUMER
I - 1219	G. & C. CLUTTER
J - 1677	W. & G. WARDER
K - 1674	F. P. JENNINGS
L - NO. 1287 P	STATE OF WEST VIRGINIA
M - 27158	HERNSHAW FAMILY TRUST
N - 27142	JAMES S. CRAIG
O - 27143	D. HAMILTON

NOTE: See references located by the proposed Hamilton 214 lease.

WELL TIE LINES
 A - N83°2'00"W - 725.73'
 B - S09°23'00"W - 683.51'
 C - S32°51'03"E - 1067.03'

LEGEND
 --- LEASE BOUNDARY
 --- SURFACE PROPERTY LINE
 - - - - - FOR BATTERY MOUND CASERIAL
 --- BATTERY & MOUNTAIN TOWN TOWNSHIP
 * EXISTING WELL

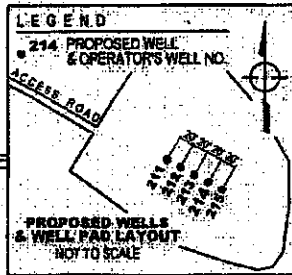
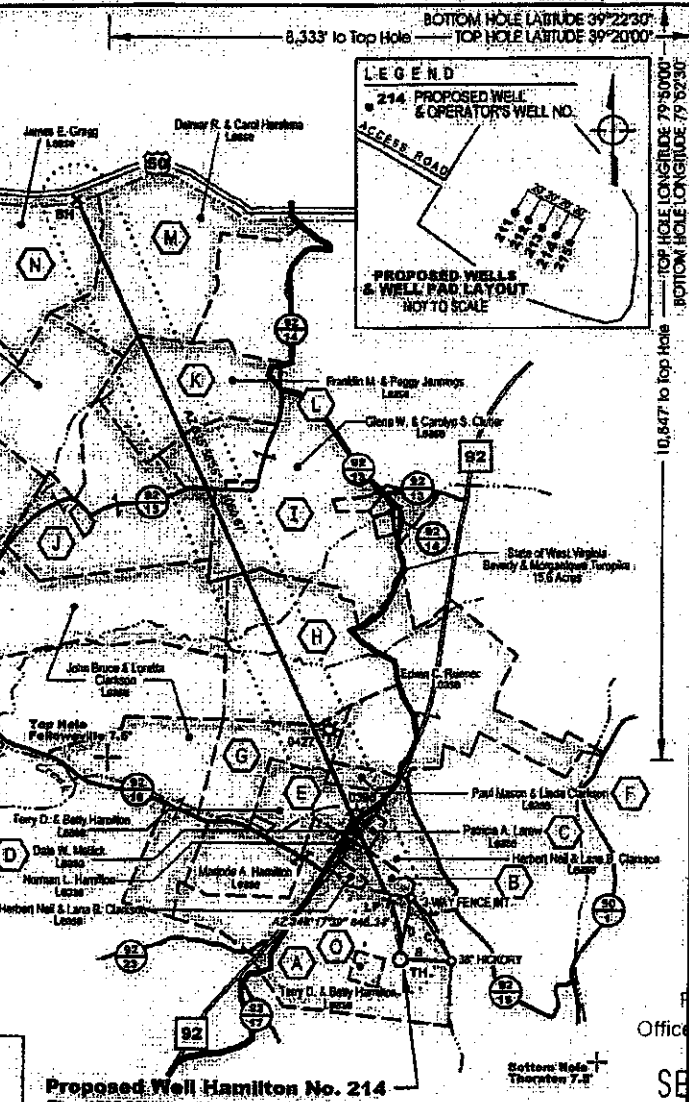
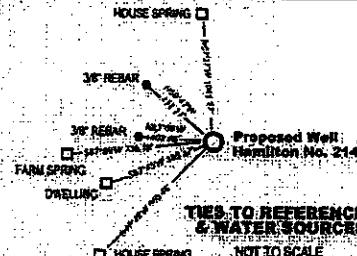
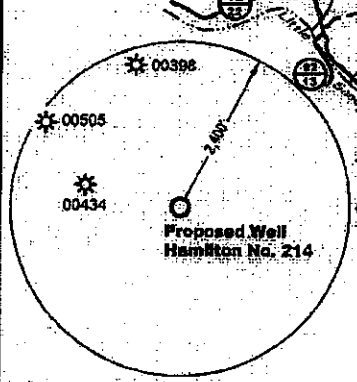

Proposed Well Hamilton No. 214
 Elev. 1562.00'



Hamilton No. 214	UTM Zone 17 meters	Latitude / Longitude (NAD83)
Top Hole (TH)	N4331081.606 E568078.113	N39°18'13.622" W79°5'14.329"
Landing Point (LP)	N4361344.002 E568021.499	N39°18'21.061" W79°5'14.712"
Bottom Hole (BH)	N4354308.719 E596996.336	N39°20'00.708" W79°5'245.084"

RECEIVED
 Office of Oil and Gas
 SEP 01 2023

Department of Environmental Protection

MSEB consultants, inc.
 P.O. Drawer 190, Clarksburg, WV 26302-0190
 Rev. 8/11/17 (804) 824-9700
 FILE NO. 18-284-Hamilton 214 Arsenal Well Plat
 SCALE 1" = 2000' DRAWN BY RLR
 MIN. DEGREE OF ACCURACY 1 in 200
 PROVEN SOURCE OF ELEVATION:
 GPS (SURVEY GRADE)

I, the undersigned, hereby certify that this plat is correct to the best of my knowledge and belief, and that it shows all information required by law and the rules issued and prescribed by the department of environmental protection.
 (SIGNED) *Charles H. Muncy, Jr.*
 R.P.E. 8137 P.S.

WV DEP
 OFFICE OF OIL & GAS
 601 57th STREET
 CHARLESTON, WV 25304
 DATE APRIL 4 20 17
 OPERATOR'S WELL NO. HAMILTON NO. 214
47 077 0062846

WELL TYPE	OIL <input type="checkbox"/> GAS <input checked="" type="checkbox"/> LIQUID INJECTION <input type="checkbox"/> WASTE DISPOSAL <input type="checkbox"/>
IF "GAS", PRODUCTION	STORAGE <input type="checkbox"/> DEEP <input type="checkbox"/> SHALLOW <input checked="" type="checkbox"/>
LOCATION	ELEVATION ORIG. 1582' - AS-BUILT 1563' WATERSHED LITTLE SANDY CREEK DISTRICT RENO COUNTY PRESTON
SURFACE OWNER	TERRY D. & BETTY HAMILTON
OIL & GAS ROYALTY OWNER	T. & B. Hamilton, W. & G. Warder, P. A. Larey, D. W. Matlack, T. & B. Hamilton, F. M. Jennings, P. M. Mason, L. Clarkson, J. E. & C. Clutter, H. Rumer, H. S. E. Rumer, G. W. & C. S. Clutter, F. P. Jennings, W. R. & G. Wagner, J. E. Craig, Steven Robert, R. R. & C. A. Harless
PROPOSED WORK	DRILL <input checked="" type="checkbox"/> CONVERT <input type="checkbox"/> DRILL DEEPER <input type="checkbox"/> REDRILL <input type="checkbox"/> PLUG OFF OLD FORMATION <input type="checkbox"/> PERFORATE NEW FORMATION <input type="checkbox"/> FRACTURE OR SIMULATE <input checked="" type="checkbox"/> OTHER PHYSICAL CHANGE IN WELL (SPECIFY) _____ CLEAN OUT AND REPLUG <input type="checkbox"/> PLUG AND ABANDON <input type="checkbox"/>
TARGET FORMATION	ONONDAGA (PILOT) - MARCELLUS (LATERAL) ESTIMATED DEPTH TVD = 7,810' (PILOT) 7,795' (LATERAL) MD 18,245.9'
WELL OPERATOR	ARSENAL RESOURCES
ADDRESS	8031 WALLACE ROAD, EXTENSION #300 WEXFORD, PA. 15080
DESIGNATED AGENT	WILLIAM VEIGEL
ADDRESS	85 PROFESSIONAL PLACE, SUITE 200 BRIDGEPORT, WV 26330



077

09/29/2023