

NOTES:

All known oil & gas wells within 2,400' of the proposed well location are shown hereon.

The bearings and distances shown hereon are based on the WV State Plane Coordinate System, NAD 27 South Zone.

West Virginia State Plane
 South Zone NAD '27
 N 570,438.20 : E 1,747,369.71
 UTM 17 - NAD 83 - Meters
 N 4,268,692.67 : E 423,037.60

FILE #: _____
 DRAWING #: Vance 1 ww6
 SCALE: 1" = 1000'
 MINIMUM DEGREE OF ACCURACY: 1 : 12,729
 PROVEN SOURCE OF ELEVATION: Global Positioning System (GPS)

I THE UNDERSIGNED, HEREBY CERTIFY THAT THIS PLAT IS CORRECT TO THE BEST OF MY KNOWLEDGE AND BELIEF AND SHOWS ALL THE INFORMATION REQUIRED BY LAW AND THE REGULATIONS ISSUED AND PRESCRIBED BY THE DEPARTMENT OF ENVIRONMENTAL PROTECTION.

Signed: Don K. Cunningham
 R.P.E.: _____ L.L.S.: 701

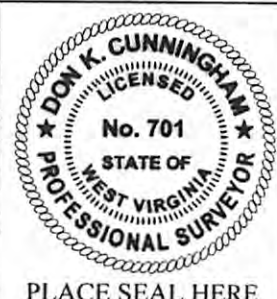

(+) DENOTES LOCATION OF WELL ON UNITED STATES TOPOGRAPHIC MAPS
 WVDEP
 OFFICE OF OIL & GAS
 601 57TH STREET
 CHARLESTON, WV 25304



DATE: November 7, 2011
 OPERATOR'S WELL #: Vance 1
 API WELL #: 47 079 01536
 STATE COUNTY PERMIT

Well Type: Oil Waste Disposal Production Deep
 Gas Liquid Injection Storage Shallow

CANCELLED

WATERSHED: Unnamed Tributary of Buffalo Creek ELEVATION: 931.10'
 COUNTY/DISTRICT: Putnam / Union QUADRANGLE: Winfield
 SURFACE OWNER: Golden L. Vance, et ux ACREAGE: 84.359
 OIL & GAS ROYALTY OWNER: Frank Hardy ACREAGE: 880
 LEASE #: WV07902817 DRILL CONVERT DRILL DEEPER REDRILL FRACTURE OR STIMULATE
 PLUG OFF OLD FORMATION PERFORATE NEW FORMATION PLUG & ABANDON
 CLEAN OUT & REPLUG OTHER CHANGE (SPECIFY): _____
 TARGET FORMATION: Rhinestreet ESTIMATED DEPTH: 4,741'
 WELL OPERATOR Mountaineer Gas Services, LLC DESIGNATED AGENT Marc Watkins
 Address 4700 MacCorkle Avenue SE, Suite 500 Address 4700 MacCorkle Avenue
 City Charleston State WV Zip Code 25304 City Charleston State WV Zip Code 25304