

FILE NO. BEDFORDLAND#9.DGN
 DRAWING NO. BEDFORD LAND #9
 SCALE 1" = 1000'
 MINIMUM DEGREE OF ACCURACY 1:200
 PROVEN SOURCE OF ELEVATION OPERATOR'S WELL RECORDS

I THE UNDERSIGNED, HEREBY CERTIFY THAT THIS PLAT IS CORRECT TO THE BEST OF MY KNOWLEDGE AND BELIEF AND SHOWS ALL THE INFORMATION REQUIRED BY LAW AND THE REGULATIONS ISSUED AND PRESCRIBED BY THE DEPARTMENT OF ENVIRONMENTAL PROTECTION.
 (SIGNED) [Signature]
 R.P.E. _____ L.L.S. 647

PLACE SEAL HERE

STATE OF WEST VIRGINIA
 DIVISION OF ENVIRONMENTAL PROTECTION
 OIL AND GAS DIVISION

DATE FEBRUARY 28, 20 03
 OPERATOR'S WELL NO. BEDFORD LAND NO. 9
 API WELL NO. SER. NO. 035520

WELL TYPE: OIL GAS LIQUID INJECTION WASTE DISPOSAL
 (IF 'GAS,') PRODUCTION STORAGE DEEP SHALLOW X

LOCATION: ELEVATION 1400 WATER SHED TRIBUTARY OF CLEAR FORK
 DISTRICT CLEAR FORK COUNTY RALEIGH
 QUADRANGLE Dorothy EAGLES W 7.5'

SURFACE OWNER PENN VIRGINIAN COAL COMPANY ACREAGE 500
 OIL & GAS ROYALTY OWNER PENN VIRGINIAN COAL COMPANY LEASE ACREAGE 8.406
 LEASE NO. 009965

PROPOSED WORK: DRILL CONVERT DRILL DEEPER REDRILL FRACTURE OR STIMULATE PLUG OFF OLD FORMATION PERFORATE NEW FORMATION OTHER PHYSICAL CHANGE IN WELL (SPECIFY) _____

PLUG AND ABANDON X CLEAN OUT AND REPLUG _____

TARGET FORMATION _____ ESTIMATED DEPTH _____

WELL OPERATOR EQUITABLE PRODUCTION CO. DESIGNATED AGENT RICHARD SMELTZER
 ADDRESS P.O. BOX 2347, CHARLESTON, WV 25328 ADDRESS SAME

MAR 21 2003

COUNTY NAME RALEIGH
 PERMIT 0264 P

CO: 081 PMT: 264
 Loc Disitized from OGIS 7.5' Mylar
 QUAD: 325 DATE: 9-FEB-90
 LAT: 38 00.0 Miles South: 2.68
 LONG: 81 25.0 Miles West : 1.40

Latitude 38° 00'

Longitude 81° 25'

John H. Burnett

The accuracy of this survey is within the limits prescribed by The Oil & Gas Division of The Dept. of Mines.

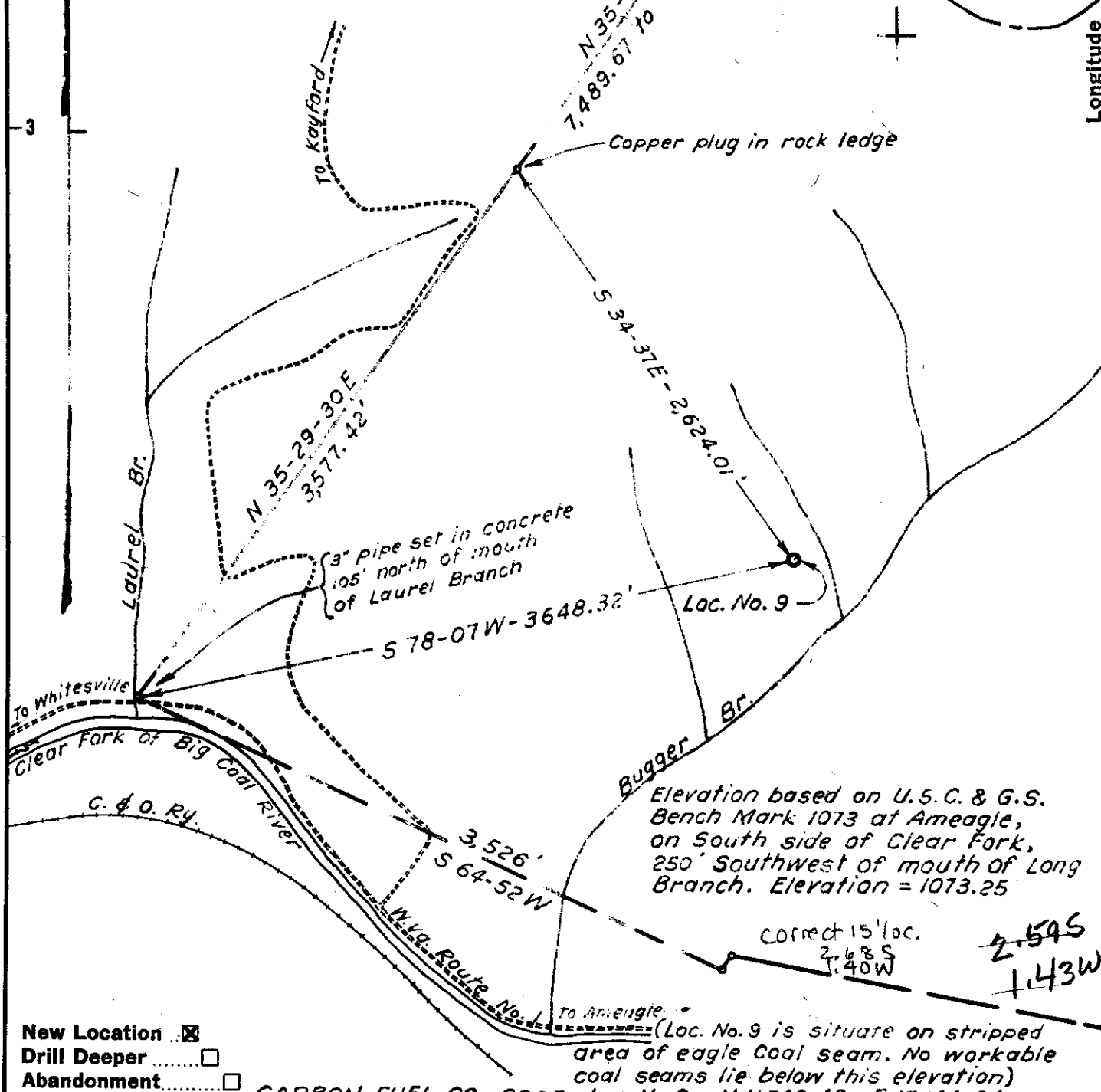

CARBON FUEL CO. COOR.-Loc. No. 9 = N 16,740.49 - E 17,144.84

(Loc. No. 9 is situate on stripped area of eagle coal seam. No workable coal seams lie below this elevation)

Company	ASHLAND OIL & REFINING CO.
Address	CHARLESTON, WEST VIRGINIA
Farm	BEDFORD LAND CO.
Tract	Acres 8406 Lease No. 9965
Well (Farm) No.	9 Serial No. 3552
Elevation (Spirit Level)	1400.0
Quadrangle	ECCLES NW
County	RALEIGH District CLEAR FORK
Engineer	J. H. BURNETT
Engineer's Registration No.	1442
File No.	19A Drawing No.
Date	MAR. 14, 1963 Scale ~ 1" = 800'

STATE OF WEST VIRGINIA
 DEPARTMENT OF MINES
 OIL AND GAS DIVISION
 CHARLESTON

WELL LOCATION MAP
 FILE NO. RAV-264

+ Denotes location of well on United States Topographic Maps, scale 1 to 62,500, latitude and longitude lines being represented by border lines as shown.
 - Denotes one inch spaces on border line of original tracing.

0-6 B (262) ✓



STATE OF WEST VIRGINIA
DEPARTMENT OF MINES
OIL AND GAS DIVISION

Quadrangle Eccles

WELL RECORD

Oil or Gas Well Gas

Permit No. RAL-234

Company <u>Ashland Oil & Refining Company</u>	Casing and Tubing	Used in Drilling	Left in Well	Packers
Address <u>Box 1913, Charleston 27, West Virginia</u>				
Farm <u>Bedford Land Company</u> Acres <u>8406</u>				
Location (waters) <u>Bigger Br. of Clear Fork of Big Coal River</u> Size				
Well No. <u>9 - 3552</u> Elev. <u>1407' KB</u>	16"	16'	16'	Kind of Packer
District <u>Clear Fork</u> County <u>Raleigh</u>	13			
The surface of tract is owned in fee by <u>Bedford Land Co.</u>	10			Size of
<u>1310 Kanawha Valley Bldg., Charleston 1, W. Va.</u> Address	8 5/8"	1665'	1665'	Depth set
Mineral rights are owned by <u>Same</u>	6 3/4"			
Address	5 3/16"			Perf. <u>1 1/2" 1 shot ea. c.</u>
Drilling commenced <u>March 27, 1963</u>	2 1/2"	2798'	2798'	Perf. top
Drilling completed <u>April 8, 1963</u>	2			Perf. bottom <u>2652'</u>
Date Shot From To	Liners Used			Perf. top <u>2674'</u>
Well				Perf. bottom <u>2681'</u>
Open Flow /10ths Water in Inch				Perf. bottom <u>2700'</u>
/10ths Merc. in Inch				
Volume Cu. Ft.				
Rock Pressure lbs. hrs.				
Oil bbls., 1st 24 hrs.				
WELL ACIDIZED				

16" 1 1/2" 1 sk. c. c.
CASING CEMENTED 8 5/8" SIZE 50 SX. No. Ft. Date
CEMENTED 4 1/2" with 40 sx. cement & 40 sx. litopoz
COAL WAS ENCOUNTERED AT 180 FEET 36 INCHES
220 FEET 48 INCHES FEET INCHES
FEET INCHES FEET INCHES

WELL FRACTURED 5-7-63 with 250 gals. mud acid, 31,500 lbs. sand and 530 bbls. treated water.
RESULT AFTER TREATMENT Final open flow 8/10 W 2" - 119,000 cu. ft. - Weir
ROCK PRESSURE AFTER TREATMENT 144 hours - 495 p.s.i.
Fresh Water Feet Salt Water Feet

Formation	Color	Hard or Soft	Top	Bottom	Oil, Gas or Water	Depth	Remarks
Sand			0	180			
Cor			180	183			
Shale & Sand			183	220			
Coal			220	224			
Shale & Sand			224	530			
Sand			530	1610			
Red Rock & Shale			1610	1660			
Sand & Shale			1660	2045			
Sand			2045	2125			
Shale & Lime			2125	2220			
Big Lime	661?		2220	2498	Gas	2280'	show
Injun Sand			2498	2560			
Weir			2560	2702			
Sand & Shale			2702	2825			
TOTAL DEPTH				2825			



STATE OF WEST VIRGINIA
DIVISION OF ENVIRONMENTAL PROTECTION
OFFICE OF OIL AND GAS

AFFIDAVIT OF PLUGGING AND FILLING WELL

AFFIDAVIT SHOULD BE IN TRIPLICATE, one copy mailed to the Division, one copy to be retained by the Well Operator and the third copy (and extra copies if required) should be mailed to each coal operator at their respective addresses.

Farm name: Penn Virginia Coal company Operator Well No: Bedford Land # 9

LOCATION: Elevation: 1400 ft. Quadrangle: Eccles 7.5
District: Clear Fork County: Raleigh
Latitude: 14,490' Feet South of 38 Deg. 00 Min. 00 Sec.
Longitude: 7265' Feet West of 81 Deg. 25 Min. 00 Sec.

Well Type: OIL _____ GAS XXXX

Company: Equitable Production Company Coal Operator Penn Virginia Coal Company
P. O. Box 2347 or Owner P. O. Box 336
Charleston, WV 25302 Duffield, Va 24224

Agent: Steve Perdue

Permit Issued Date: 3/17/03

AFFIDAVIT

STATE OF WEST VIRGINIA,
County of Raleigh ss:

Randy Riddle and William Steele being first duly sworn according to law depose and say that they are experienced in the work of plugging and filling oil and gas wells and were employed by the above named well operator, and participated in the work of plugging and filling the above well, and Rick Campbell Oil and Gas Inspector representing the Director, say that said work was commenced on the 21 day of July, 2003 and that the well was plugged and filled in the following manner:

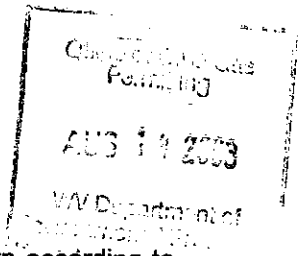

TYPE	FROM	TO	PIPE REMOVED	LEFT
6% Gel	between all	plugs	2703 1 1/2 tubing	0
cement	2503	2403 (9 sks)	2195 4 1/2 casing	603 ft 4 1/2
cement	2245	2145 (18 sks)	925 8 7/8 casing	740 ft 8 7/8
cement	1708	1608 (28 sks)		
cement	1450	1350 (28 sks)		Perf. 8 7/8 (1450-1300)
Cement	945	845 (16 sks)		1140
Cement	600	500 (50 sks)		
cement	270	0 (150 sks)		

8/15/03

Description of monument: Partial Plugging / Well still in production and that the work of partial plugging and filling said well was completed on the 28 day of July, 2003. 7" casing 36in above ground with api number

And further deponents saith not. Randy Riddle

William Steele

Sworn and subscribe before me this 28 day of July, 2003
My commission expires: 5/3/05

[Signature]
Notary Public

Oil and Gas Inspector: Richard J. Campbell

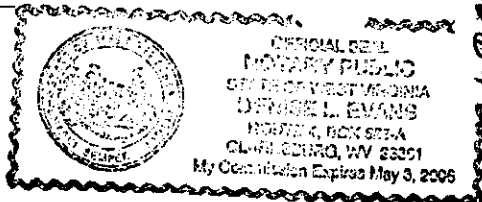

AUG 15 2003

RAI 0204