

REFERENCES NO SCALE

FILE NO. _____
 DRAWING NO. _____
 SCALE 1"=1000'
 MINIMUM DEGREE OF ACCURACY 1/10000
 PROVEN SOURCE OF ELEVATION BM 2376 SOUTH OF LOCATION

I THE UNDERSIGNED, HEREBY CERTIFY THAT THIS PLAT IS CORRECT TO THE BEST OF MY KNOWLEDGE AND BELIEF AND SHOWS ALL THE INFORMATION REQUIRED BY LAW AND THE REGULATIONS ISSUED AND PRESCRIBED BY THE DEPARTMENT OF MINES.
 (SIGNED) Raymond Brown
 R. P. E. _____ L. L. S. 736

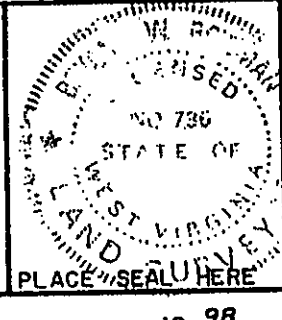

WEST VIRGINIA
 DIVISION OF ENVIRONMENTAL PROTECTION
 OFFICE OF OIL AND GAS
 #10 McJUNKIN ROAD
 NITRO, WEST VIRGINIA 25143-2506



DATE JUNE 14 19 98
 OPERATOR'S WELL NO. 24C-WB6R
 API WELL NO. 47-081-01148CP
 STATE COUNTY PERMIT

WELL TYPE: OIL ___ GAS X LIQUID INJECTION ___ WASTE DISPOSAL ___
 (IF "GAS", PRODUCTION X STORAGE ___ DEEP ___ SHALLOW ___)
 LOCATION: ELEVATION 2530.48 WATER SHED RIGHT FORK OF DIXON'S BRANCH
 DISTRICT TOWN COUNTY RALEIGH
 QUADRANGLE PAX, WV 7.5'
 SURFACE OWNER _____ ACREAGE _____
 OIL & GAS ROYALTY OWNER WILLIS BRANCH COAL COMPANY LEASE ACREAGE 58 OF 2500±
 LEASE NO. _____
 PROPOSED WORK: DRILL X CONVERT ___ DRILL DEEPER ___ REDRILL ___ FRACTURE OR
 STIMULATE ___ PLUG OFF OLD FORMATION ___ PERFORATE NEW
 FORMATION ___ OTHER PHYSICAL CHANGE IN WELL (SPECIFY) _____
 PLUG AND ABANDON ___ CLEAN OUT AND REPLUG _____
 TARGET FORMATION OPEN MINE IN BECKLEY COAL-1470'E ESTIMATED DEPTH 1600'
 WELL OPERATOR PENN VIRGINIA OIL & GAS CORP DESIGNATED AGENT MR. HARRY JEWEL
 ADDRESS 999 EXECUTIVE PARK BLVD., SUITE 300 ADDRESS PO BOX 460
KINGSPORT, TN 37660 RAVENCLIFF, WY 25913

RAL 1148 CP

✓ ✓

12100'

NO KNOWN WATER WELLS WITHIN 1000'

LATITUDE 37°55'00"

TO TWO 1/2" IRON
PINS
N133°47'59"E
225.283'

S07°58'56"E
10596.016'

WILLIS BRANCH COAL COMPANY
PARCEL "B" OF DEED BOOK 61 PAGE 482

WILLIS BRANCH COAL COMPANY
PARCEL "J" OF DEED BOOK 61 PAGE 482

PLATEAU DISTRICT

FAYETTE COUNTY

RALEIGH COUNTY

TOWN DISTRICT

MAYNOR BRANCH

CLEAR FORK
DISTRICT

1099C

HANSFORD SMOKELESS COLLIERS, INC.
COORDINATES
40977.816
5888.310

N08°48'25"W
10429.106'

WILLIS BRANCH
COAL CO.
PARCEL "H"
DEED BOOK 61
PAGE 490 (MINERAL)

PROPOSED WELL

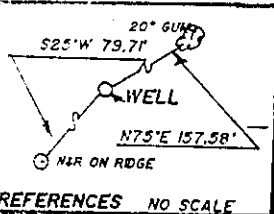

WEST VIRGINIA STATE PLANE COORDINATES
319599.506
1913883.533
NAD 27

REFERENCES NO SCALE

FILE NO. _____
DRAWING NO. _____
SCALE 1"=1000'
MINIMUM DEGREE OF
ACCURACY 1/10000
PROVEN SOURCE OF
ELEVATION BM 2376 SOUTH OF
LOCATION

I THE UNDERSIGNED, HEREBY CERTIFY
THAT THIS PLAT IS CORRECT TO THE
BEST OF MY KNOWLEDGE AND BELIEF AND
SHOWS ALL THE INFORMATION REQUIRED
BY LAW AND THE REGULATIONS ISSUED
AND PRESCRIBED BY THE DEPARTMENT OF
MINES.
(SIGNED) Ronald Brown
R.P.E. _____ L.L.S. 736



WEST VIRGINIA
DIVISION OF ENVIRONMENTAL PROTECTION
OFFICE OF OIL AND GAS
#10 McJUNKIN ROAD
NITRO, WEST VIRGINIA 25143-2506



DATE JUNE 14 19 98
OPERATOR'S WELL NO. 24C-WB6R
API WELL NO. 47-081-01148C
STATE COUNTY PERMIT

WELL TYPE: OIL _____ GAS X LIQUID INJECTION _____ WASTE DISPOSAL _____
(IF "GAS", PRODUCTION X STORAGE _____ DEEP _____ SHALLOW _____
LOCATION: ELEVATION 2530.48 WATER SHED RIGHT FORK OF DIXON'S BRANCH
DISTRICT TOWN COUNTY RALEIGH
QUADRANGLE PAX, WV 7.5'

SURFACE OWNER _____ ACREAGE _____
OIL & GAS ROYALTY OWNER WILLIS BRANCH COAL COMPANY LEASE ACREAGE 58± OF 2500±
LEASE NO. _____

PROPOSED WORK: DRILL X CONVERT _____ DRILL DEEPER _____ REDRILL _____ FRACTURE OR
STIMULATE _____ PLUG OFF OLD FORMATION _____ PERFORATE NEW
FORMATION _____ OTHER PHYSICAL CHANGE IN WELL (SPECIFY) _____

PLUG AND ABANDON Bonny mine CLEAN OUT AND REPLUG _____
TARGET FORMATION OPEN MINE IN BECKLEY COAL-1470' ESTIMATED DEPTH 1600' 6-6,000
WELL OPERATOR PENN VIRGINIA OIL & GAS CORP DESIGNATED AGENT MR. HARRY JEWEL
ADDRESS 999 EXECUTIVE PARK BLVD., SUITE 300 ADDRESS PO BOX 460
KINGSPORT, TN 37660 RAVENCLIFF, WV 25913

LONGITUDE 81°15'00"

14250'

RAL 1148C

WR-35

31-Jul-98
API # 47- 81-01148 C

State of West Virginia
Division of Environmental Protection
Section of Oil and Gas

Well Operator's Report of Well Work

Farm name: WILLIS BRANCH COAL CO Operator Well No.: 24C-WB6R

LOCATION: Elevation: 2,530.48 Quadrangle: PAX

District: TOWN County: RALEIGH
Latitude: 14250 Feet South of 37 Deg. 55Min. 0 Sec.
Longitude 12100 Feet West of 81 Deg. 15 Min. 0 Sec.

Company: PENN VIRGINIA OIL AND GAS
999 EXEC. PARK BLVD., STE. 300
KINGSPORT, TN 37660-0000

Agent: HARRY JEWELL, III

Inspector: RODNEY DILLON
Permit Issued: 07/31/98
Well work Commenced: 08/24/98
Well work Completed: 09/02/98
Verbal Plugging
Permission granted on:
Rotary Cable Rig
Total Depth (feet) 1479'
Fresh water depths (ft) Damp at 195'

Casing & Tubing Size	Used in Drilling	Left in Well	Cement Fill Up Cu. Ft.
9 5/8"	27'	27'	0
7"	873'	873'	184

Salt water depths (ft) _____

Is coal being mined in area (Y/N)? N
Coal Depths (ft): 95-96, 145-148, 165-167,
295-297, 422-425, 545-548, 745-747,
1230-1232

OPEN FLOW DATA

Producing formation Beckley Coal - Open Mine Pay zone depth (ft) _____
Gas: Initial open flow _____ MCF/d Oil: Initial open flow _____ Bbl/d
Final open flow show of gas _____ MCF/d Final open flow _____ Bbl/d
Time of open flow between initial and final tests _____ Hours
Static rock Pressure N/A psig (surface pressure) after _____ Hours

Second producing formation _____ Pay zone depth (ft) _____
Gas: Initial open flow _____ MCF/d Oil: Initial open flow _____ Bbl/d
Final open flow _____ MCF/d Final open flow _____ Bbl/d
Time of open flow between initial and final tests _____ Hours
Static rock Pressure _____ psig (surface pressure) after _____ Hours

NOTE: ON BACK OF THIS FORM PUT THE FOLLOWING: 1). DETAILS OF PERFORATED INTERVALS, FRACTURING OR STIMULATING, PHYSICAL CHANGE, ETC. 2). THE WELL LOG WHICH IS A SYSTEMATIC DETAILED GEOLOGICAL RECORD OF ALL FORMATIONS, INCLUDING COAL ENCOUNTERED BY THE WELLBORE.

For: PENN VIRGINIA OIL AND GAS CORPORATION

By: William M. Ryan
Date: 1/21/99

FEB 19 1999

RALEIGH 1148 C

FORM WR-35R
(REVERSE)

PERMIT #: 47-081-01148C
WELL#: 24C-WB6R

<u>FORMATIONS</u>	<u>TOP</u>	<u>BOTTOM</u>	<u>REMARKS</u>
Sand & Shale	0	220	
Shale	220	470	
Sand	470	545	
Shale	545	570	
Sand	570	620	
Shale	620	695	
Sand	695	795	
Shale	795	845	
Sand	845	1195	
Shale	1195	1270	
Sand & Shale	1270	1295	
Shale	1295	1320	
Sand	1320	1420	
Sand & Shale	1420	1445	
Shale	1445	1476	
Open Mine	1476	1479	No shows reported