

West Virginia State Plane
 NAD 27 - SOUTH
 N 289,725.79
 E 1,922,036.35

Lat. 37° 50' 00"

Long. 81° 15' 00"

13,800'

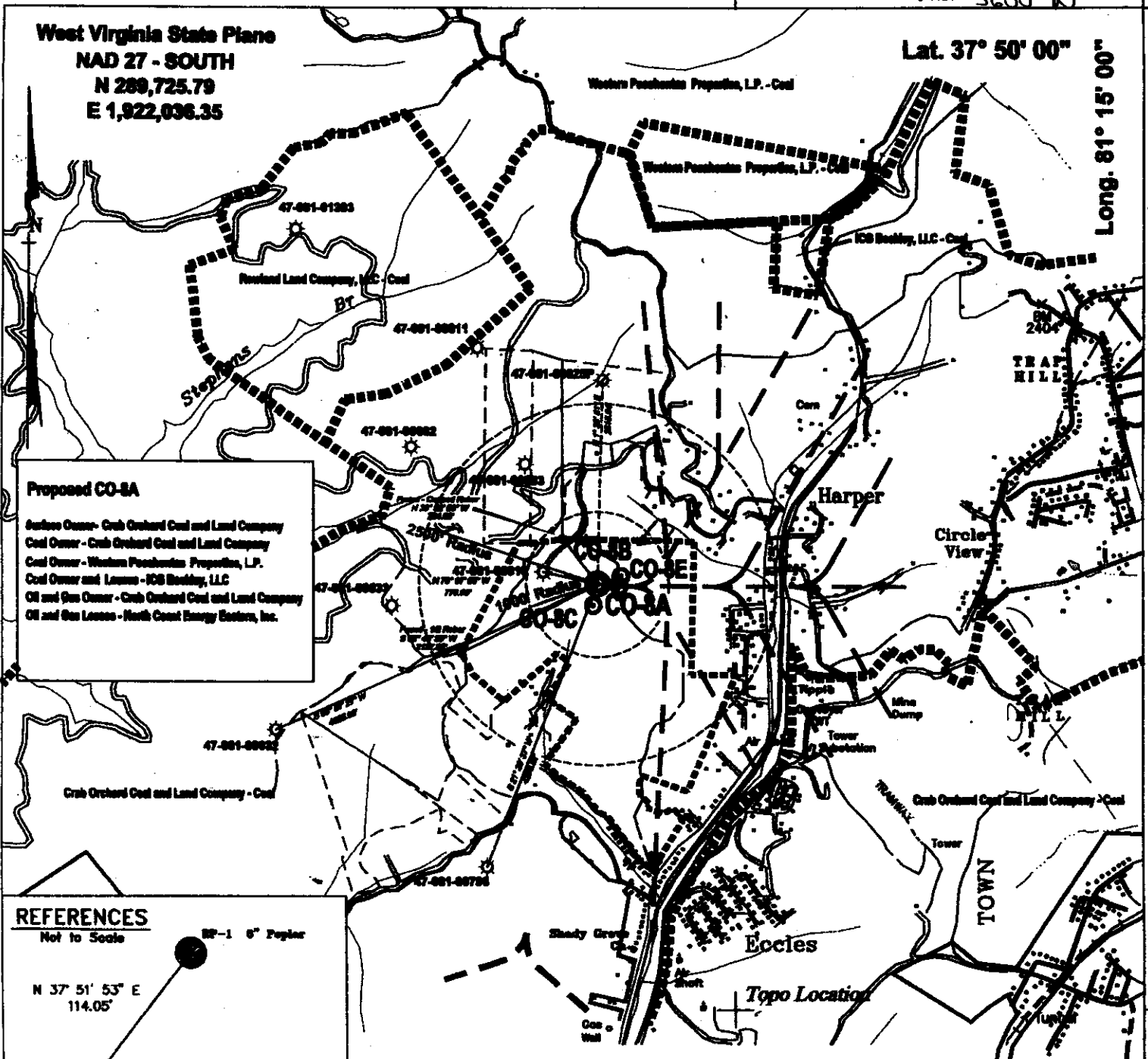

Proposed CO-8A

Surface Owner - Crab Orchard Coal and Land Company
 Coal Owner - Crab Orchard Coal and Land Company
 Coal Owner - Western Piedmont Properties, L.P.
 Coal Owner and Lessee - ICB Booby, LLC
 Oil and Gas Owner - Crab Orchard Coal and Land Company
 Oil and Gas Lessee - North Coast Energy Eastern, Inc.

REFERENCES

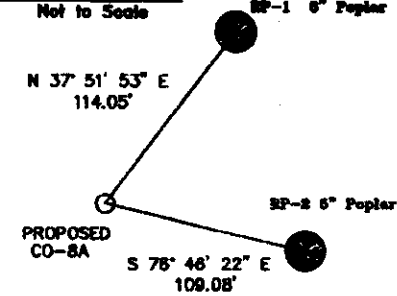

(+) Denotes location of well on USGS map.
 Surface Tract Information taken from Raleigh County Tax Records
 No known domestic water users within 1000' of proposed location

FILE No. CDX Gas

DIRECTORY C:\Data\Plats\ICG Property\CO-8

DRAWING NAME CO-8A.dwg

SCALE 1" = 2000'

MINIMUM DEGREE OF

ACCURACY 1:2500

PROVEN SOURCE OF

ELEVATION GPS GLOBAL POSITIONING SYSTEM (Sub meter accuracy)

THIS PLAT IS CORRECT TO THE BEST OF MY KNOWLEDGE AND BELIEF AND SHOWS ALL THE INFORMATION REQUIRED BY LAW AND THE REGULATIONS ISSUED AND PRESCRIBED BY THE DEPARTMENT OF MINES.

(SIGNED) *W. Claude Brown*
 R.P.E. R.P.S.

STATE OF WEST VIRGINIA
DEPARTMENT OF ENVIRONMENTAL PROTECTION
OFFICE OF OIL AND GAS
CHARLESTON, WV



DATE August 31, 2008

OPERATOR'S WELL No. CO-8A

47 - 081 - 1431 W
 API WELL No. STATE COUNTY PERMIT

WELL TYPE: OIL GAS X LIQUID INJECTION WASTE DISPOSAL
 (IF "GAS") PRODUCTION STORAGE DEEP SHALLOW CBM X
 LOCATION: ELEVATION 2311.54 WATER SHED TRIBUTARY OF MILLERS CAMP BRANCH
 DISTRICT TRAP HILL COUNTY RALEIGH
 QUADRANGLE ECCLES, WV

SURFACE OWNER CRAB ORCHARD COAL AND LAND COMPANY
 ROYALTY OWNER REFER TO APPLICATION

ACREAGE 1221.47 (Tax Map 6 Parcel 1)
 LEASE ACREAGE _____

LEASE No. _____
 PROPOSED WORK: DRILL X CONVERT DRILL DEEPER REDRILL FRACTURE OR
 STIMULATE PLUG OFF OLD FORMATION PERFORATE NEW
 FORMATION OTHER PHYSICAL CHANGE IN WELL (SPECIFY) Rework
well to intercept proposed CO-8E horizontal well

PLUG AND ABANDON CLEAN OUT AND REPLUG _____
 TARGET FORMATION POCA NO. 2 & 2A AND PENN COALS
 WELL OPERATOR CDX Gas, LLC
 ADDRESS 101 N. KANAWHA ST.
BECKLEY, WV 25801

ESTIMATED DEPTH 1250' 08/10/2008
 DESIGNATED AGENT MICHAEL McCOWN
 ADDRESS 803 QUARRIER ST. SUITE 400
CHARLESTON, WV 25301

RAL 1431 W

West Virginia State Plane
NAD 27 - SOUTH
N 289,725.79
E 1,922,036.35

Lat. 37° 50' 00"
Long. 81° 15' 00"

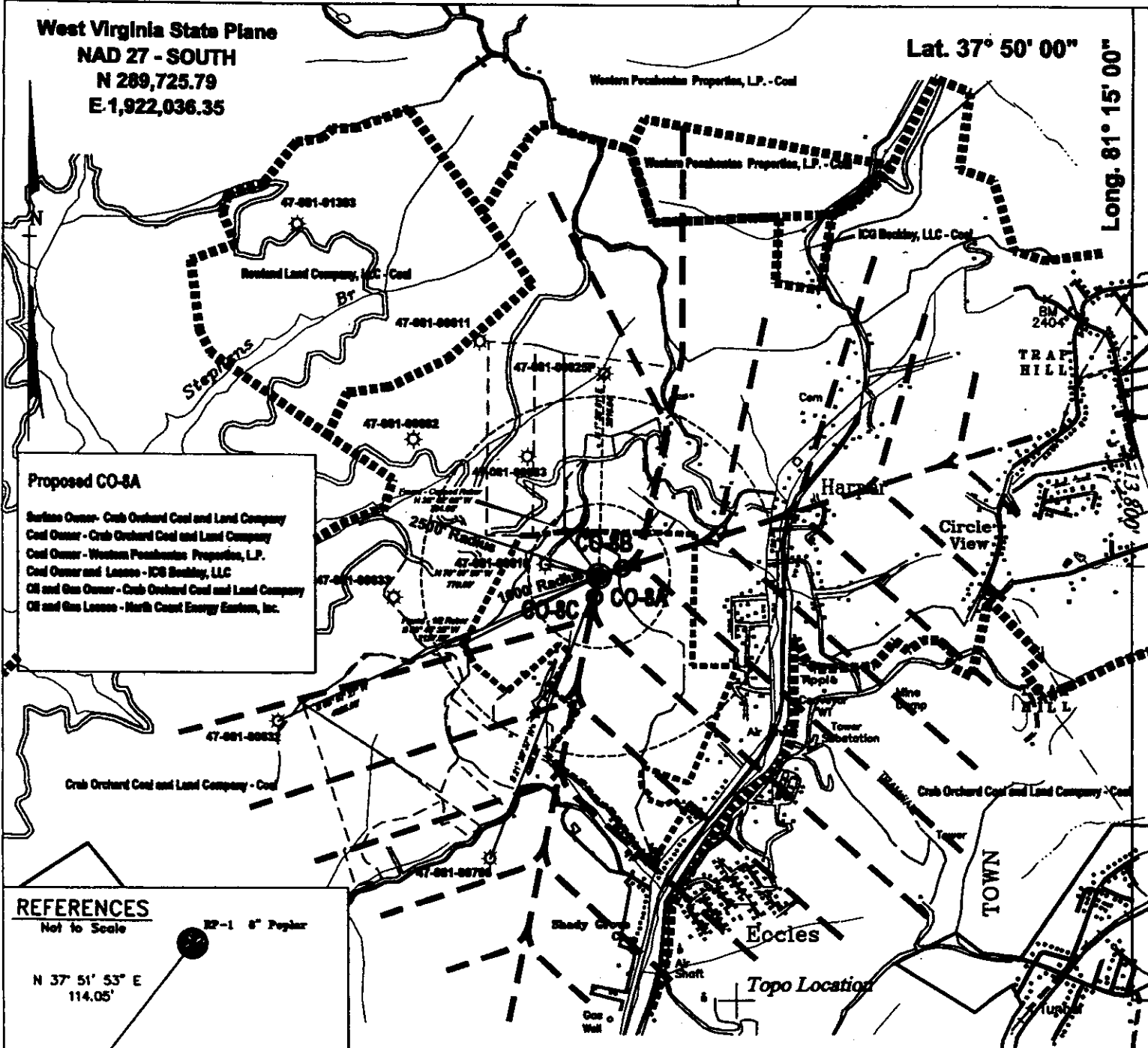

Proposed CO-8A

Surface Owner - Crab Orchard Coal and Land Company
Coal Owner - Crab Orchard Coal and Land Company
Coal Owner - Western Pennsylvania Properties, L.P.
Coal Owner and Lessee - ICG Beckley, LLC
Oil and Gas Owner - Crab Orchard Coal and Land Company
Oil and Gas Lessee - North Coast Energy Eastern, Inc.

REFERENCES

Not to Scale

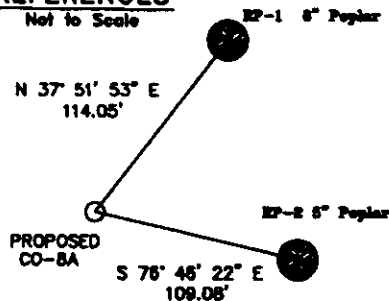

(+) Denotes location of well on USGS map.
Surface Tract Information taken from Raleigh County Tax Records
No known domestic water users within 1000' of proposed location (Water Wells)
Public Water System Service Area.

FILE No. CDX Gas
DIRECTORY C:\Data\Plots\ICG Property\CO-8
DRAWING NAME CO-8A.dwg
SCALE 1" = 2000'
MINIMUM DEGREE OF ACCURACY 1 : 2500
PROVEN SOURCE OF ELEVATION GPS GLOBAL POSITIONING SYSTEM (Sub meter accuracy)

THIS PLAT IS CORRECT TO THE BEST OF MY KNOWLEDGE AND BELIEF AND SHOWS ALL THE INFORMATION REQUIRED BY LAW AND THE REGULATIONS ISSUED AND PRESCRIBED BY THE DEPARTMENT OF MINES.

(SIGNED)

R.P.

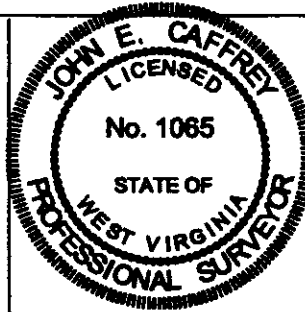

**STATE OF WEST VIRGINIA
DEPARTMENT OF ENVIRONMENTAL PROTECTION
OFFICE OF OIL AND GAS
CHARLESTON, WV**



DATE APRIL 13, 2007
OPERATOR'S WELL No. CO-8A

47 - 081 - 01431C

API WELL No. STATE COUNTY PERMIT

WELL TYPE: OIL GAS LIQUID INJECTION WASTE DISPOSAL
(IF "GAS") PRODUCTION STORAGE DEEP SHALLOW CBM
LOCATION: ELEVATION 2311.54 WATER SHED TRIBUTARY OF MILLERS CAMP BRANCH
DISTRICT TRAP HILL COUNTY RALEIGH
QUADRANGLE ECCLES, WV

SURFACE OWNER CRAB ORCHARD COAL AND LAND COMPANY
ROYALTY OWNER REFER TO APPLICATION

ACREAGE 1221.47 (Tax Map 6 Parcel 1)
LEASE ACREAGE _____

LEASE No. _____
PROPOSED WORK: DRILL CONVERT _____ DRILL DEEPER REDRILL _____ FRACTURE OR
STIMULATE _____ PLUG OFF OLD FORMATION _____ PERFORATE NEW
FORMATION _____ OTHER PHYSICAL CHANGE IN WELL (SPECIFY) _____
MAY 25 2007

PLUG AND ABANDON _____ CLEAN OUT AND REPLUG _____
TARGET FORMATION POCA NO. 2 & 3 AND PENN COALS
WELL OPERATOR CDX Gas, LLC
ADDRESS 101 N. KANAWHA ST.
BECKLEY, WV 25801

ESTIMATED DEPTH 1250'
DESIGNATED AGENT MICHEAL McCOWN
ADDRESS 803 QUARRIER ST. SUITE 400
CHARLESTON, WV 25301

RAL 1431C