

West Virginia State Plane
NAD 27 - SOUTH
N 289,433.25
E 1,921,975.64

Lat. 37° 50' 00"

Long. 81° 15' 00"

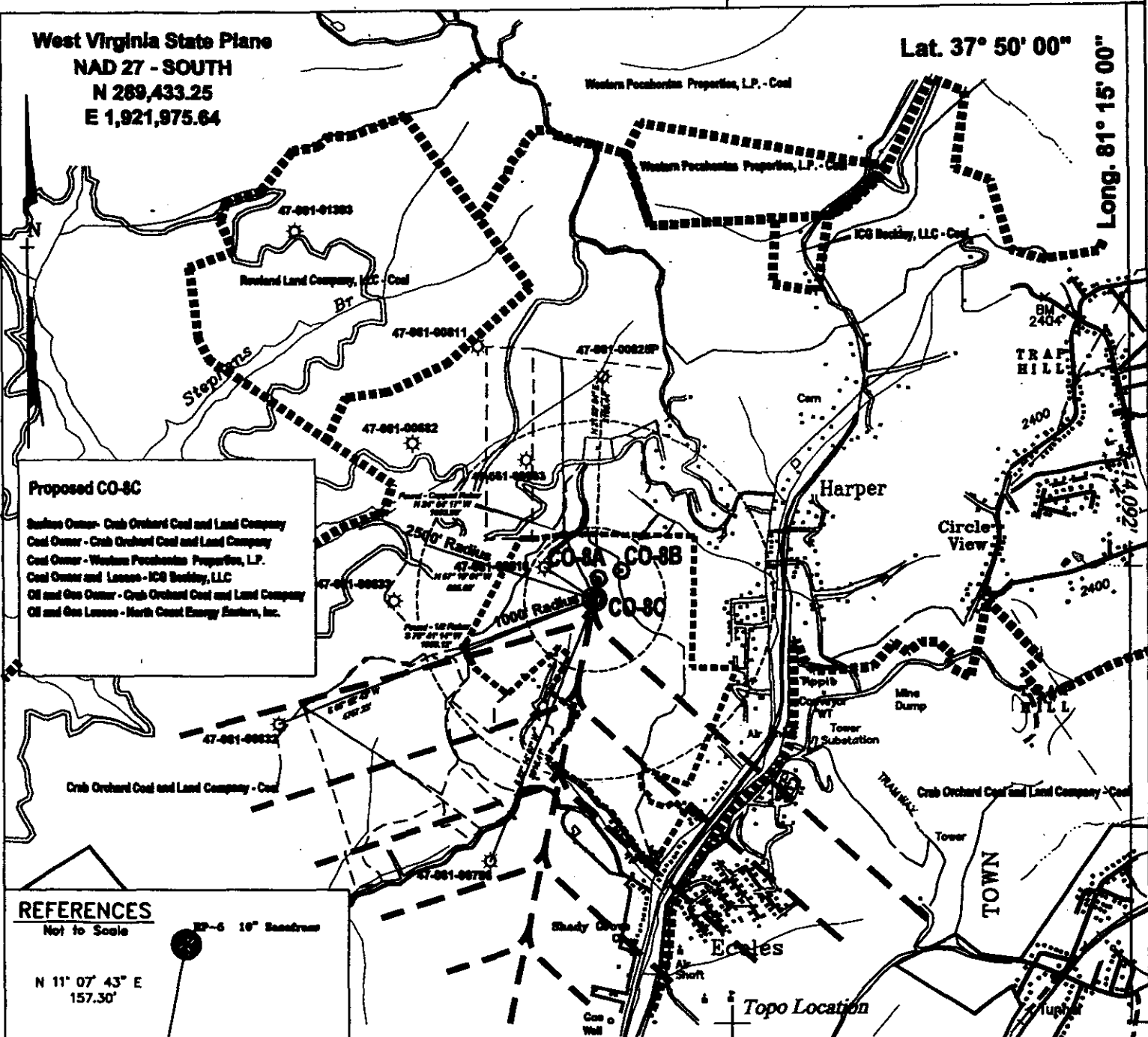

Proposed CO-8C

Surface Owner - Crab Orchard Coal and Land Company
Coal Owner - Crab Orchard Coal and Land Company
Coal Owner - Western Pechonias Properties, L.P.
Coal Owner and Lessee - ICS Beckley, LLC
Oil and Gas Owner - Crab Orchard Coal and Land Company
Oil and Gas Lessee - North Coast Energy Services, Inc.

REFERENCES

Not to Scale

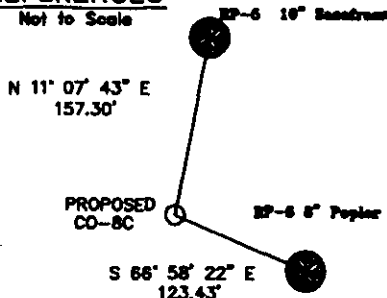

(+) Denotes location of well on USGS map.
Surface Tract Information taken from Raleigh County Tax Records
No known domestic water users within 1000' of proposed location (Water Wells)
Public water system serves Area

FILE No. CDX Gas
DIRECTORY C:\Data\Plots\ICG Property\CO-8
DRAWING NAME CO-8C.dwg
SCALE 1" = 2000'
MINIMUM DEGREE OF
ACCURACY 1: 2500
PROVEN SOURCE OF
ELEVATION GPS GLOBAL POSITIONING
SYSTEM (Sub meter accuracy)

THIS PLAT IS CORRECT TO THE BEST OF MY
KNOWLEDGE AND BELIEF AND SHOWS ALL THE
INFORMATION REQUIRED BY LAW AND THE REGU-
LATIONS ISSUED AND PRESCRIBED BY THE
DEPARTMENT OF MINES.

(SIGNED)

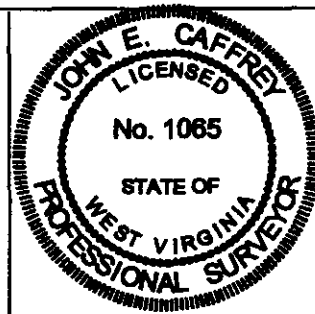

**STATE OF WEST VIRGINIA
DEPARTMENT OF ENVIRONMENTAL PROTECTION
OFFICE OF OIL AND GAS
CHARLESTON, WV**



DATE APRIL 13, 2007

OPERATOR'S WELL No. CO-8C

47 - 081 - 01433C

API WELL No. STATE COUNTY PERMIT

WELL TYPE: OIL GAS LIQUID INJECTION WASTE DISPOSAL
(IF "GAS") PRODUCTION STORAGE DEEP SHALLOW CBM
LOCATION: ELEVATION 2247.64 WATER SHED TRIBUTARY OF MILLERS CAMP BRANCH
DISTRICT TRAP HILL COUNTY RALEIGH
QUADRANGLE ECCLES, WV

SURFACE OWNER CRAB ORCHARD COAL AND LAND COMPANY
ROYALTY OWNER REFER TO APPLICATION

ACREAGE 1221.47 (Tax Map 6 Parcel 1)
LEASE ACREAGE _____

LEASE No. _____
PROPOSED WORK: DRILL CONVERT DRILL DEEPER REDRILL FRACTURE OR
STIMULATE PLUG OFF OLD FORMATION PERFORATE NEW
FORMATION OTHER PHYSICAL CHANGE IN WELL (SPECIFY) _____

MAY 25 2007

PLUG AND ABANDON _____ CLEAN OUT AND REPLUG _____
TARGET FORMATION POCA NO. 2 & 3 AND PENN COALS
WELL OPERATOR CDX Gas, LLC
ADDRESS 101 N. KANAWHA ST.

ESTIMATED DEPTH 1250'
DESIGNATED AGENT MICHEAL McCOWN
ADDRESS 803 QUARTER ST. SUITE 400

RA 1433C