

WW-7
8-30-06



West Virginia Department of Environmental Protection
Office of Oil and Gas

WELL LOCATION FORM: GPS

API: 47-081-01454 WELL NO.: CO-4C

FARM NAME: Beaver Coal Company

RESPONSIBLE PARTY NAME: Summit Appalachia Operating Company, LLC

COUNTY: Raleigh DISTRICT: Trap Hill

QUADRANGLE: Eccles

SURFACE OWNER: Beaver Coal Company

ROYALTY OWNER: _____

UTM GPS NORTHING: - 4181064

UTM GPS EASTING: 473966 GPS ELEVATION: 2300.76

The Responsible Party named above has chosen to submit GPS coordinates in lieu of preparing a new well location plat for a plugging permit or assigned API number on the above well. The Office of Oil and Gas will not accept GPS coordinates that do not meet the following requirements:

1. Datum: NAD 1983, Zone: 17 North, Coordinate Units: meters, Altitude: height above mean sea level (MSL) – meters.
2. Accuracy to Datum – 3.05 meters
3. Data Collection Method:
Survey grade GPS _____: Post Processed Differential _____

Real-Time Differential _____

Mapping Grade GPS X: Post Processed Differential _____

Real-Time Differential _____

RECEIVED
Office of Oil and Gas

AUG 23 2022

4. Letter size copy of the topography map showing the well location. I the undersigned, hereby certify this data is correct to the best of my knowledge and belief and shows all the information required by law and the regulations issued and prescribed by the Office of Oil and Gas.

Tom Statler
Signature

Production Foreman
Title

10-11-22
Date

**Proposed CBM Wells
CO-4A, B, C and D**
December 18, 2007
Scale 1" = 2000'

RECEIVED
Office of Oil & Gas
SEP 14 2022
WV Department of
Environmental Protection

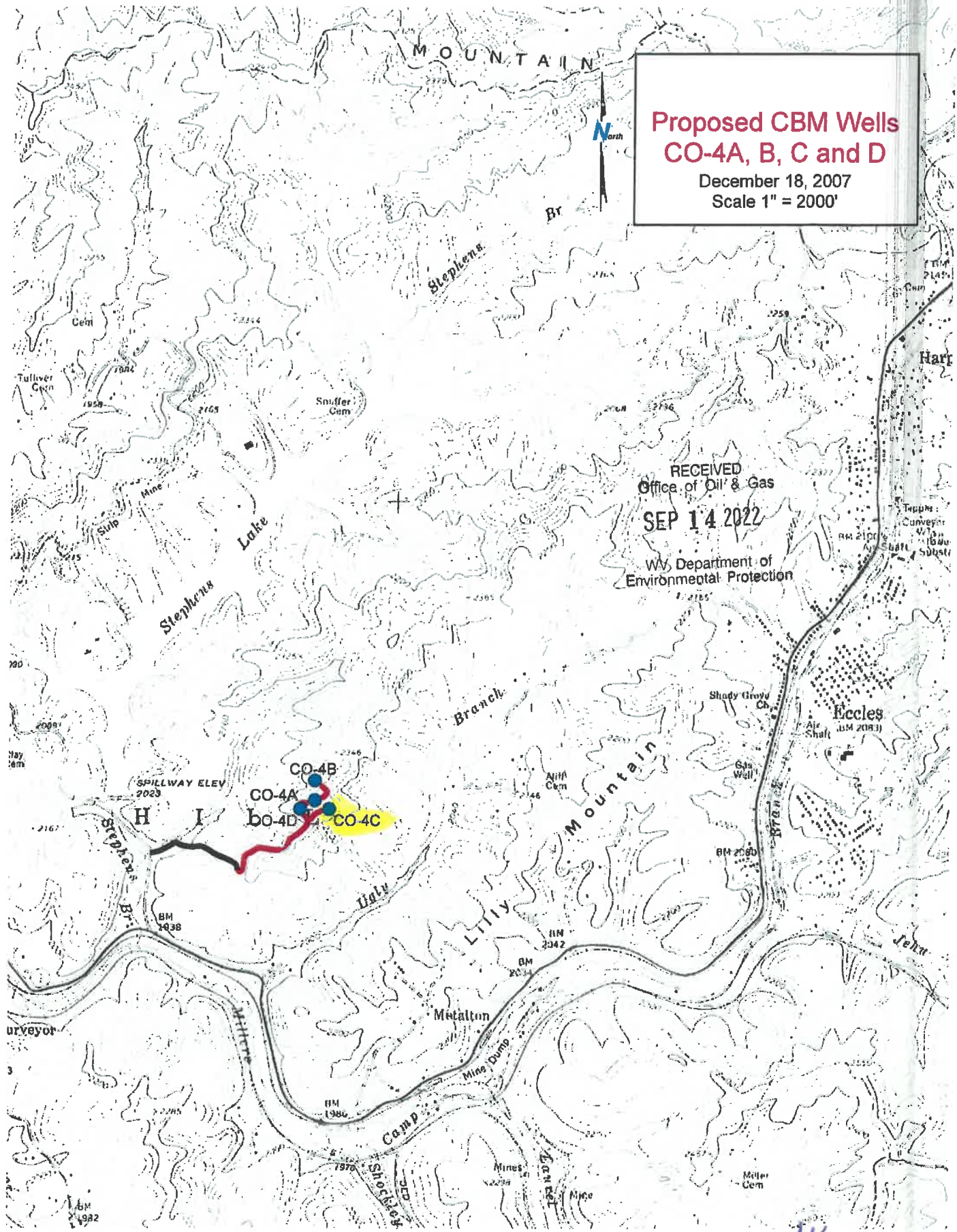

[Handwritten signature]