

Latitude 38° 00'

Longitude 81° 30'

1.28 W  
1.96 S

\* 3918  
ABANDONED

COAL RIVER MINING  
& LUMBER CO.

Mouth of  
Toms Br.

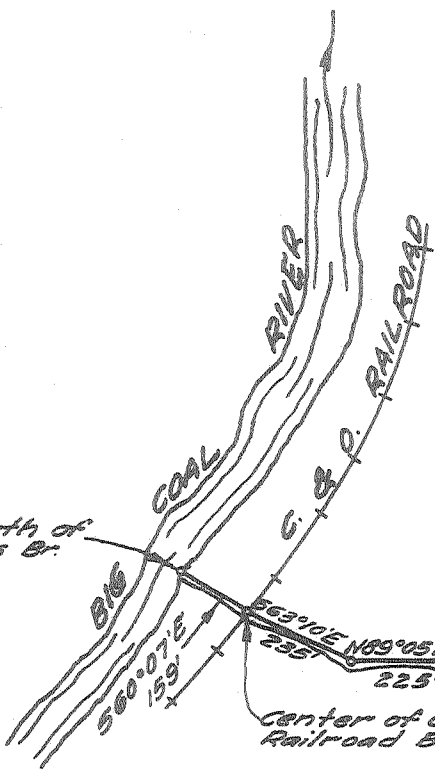

J. A. BARRETT

Small White  
Oak on Ridge  
Pine stump  
on Cliff

BENCH MARK DESCRIPTION

"□" Cut on Northwest Abutment of  
C. & O. R.R. Bridge over Toms Branch.  
Elev. 835.74'

DEGREE OF ACCURACY

One Part in Two Hundred.

- Fracture Before 6/5/27
- New Location
- Drill Deeper
- Redrill
- Abandonment

I, the undersigned, hereby certify that this map is correct to the best of my knowledge and belief and shows all the information required by Paragraph 5 of the Rules and Regulations of the Oil and Gas Section of the Mining Laws of West Virginia.

The accuracy of this survey is within the limits and as prescribed in paragraph 5 by the Oil and Gas Division of the Department of Mines Regulations.  
PROVEN ELEVATION 835.74

Company UNITED FUEL GAS CO.  
 Address CHARLESTON, W. VA.  
 Farm COAL RIVER MINING & LUMBER CO.  
 Tract \_\_\_\_\_ Acres 3,000 Lease No. 17120  
 Well (Farm) No. \_\_\_\_\_ Serial No. 3935  
 Elevation (Spirit Level) 889.39'  
 Quadrangle BALD KNOB - NE  
 County RALBIGH District CLEAR FORK  
 Engineer O. J. Spinks  
 Engineer's Registration No. 2712  
 File No. 06-33 Drawing No. \_\_\_\_\_  
 Date JUNE 21, 1966 Scale 1" = 400'

STATE OF WEST VIRGINIA  
DEPARTMENT OF MINES  
OIL AND GAS DIVISION  
CHARLESTON

WELL LOCATION MAP  
FILE NO. BAL-3-A

+ Denotes location of well on United States Topographic Maps, scale 1 to 62,500 latitude and longitude lines being represented by border lines as shown.

- Denotes one inch spaces on border line of original tracing.