

6-10-27-103 P

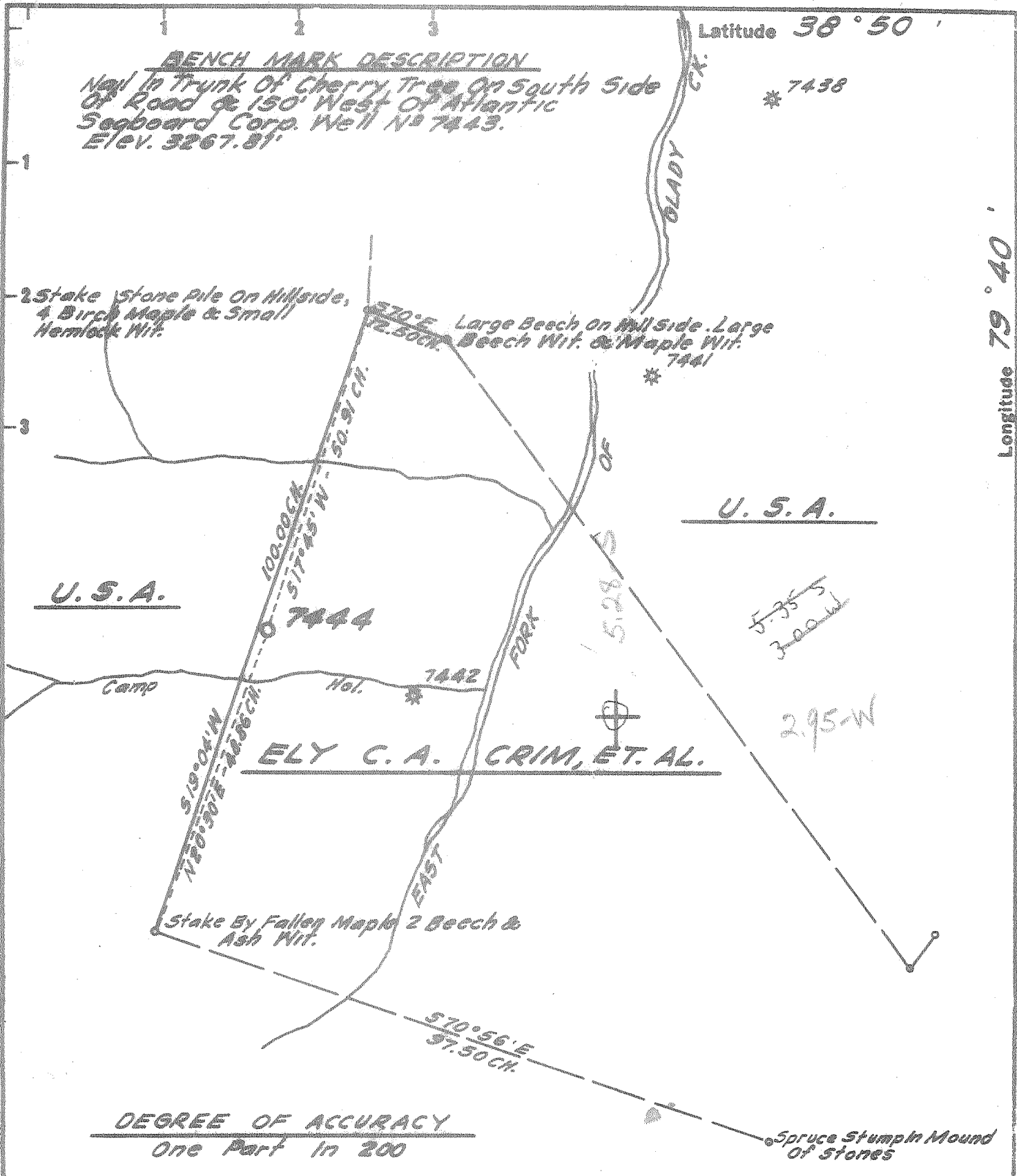

Fracture	<input type="checkbox"/>
Before 6/5/27	<input type="checkbox"/>
New Location	<input checked="" type="checkbox"/>
Drill Deeper	<input type="checkbox"/>
Redrill	<input type="checkbox"/>
Abandonment	<input type="checkbox"/>

I, the undersigned, hereby certify that this map is correct to the best of my knowledge and belief and shows all the information required by Paragraph 5 of the Rules and Regulations of the Oil and Gas Section of the Mining Laws of West Virginia.

The accuracy of this survey is within the limits and as prescribed in paragraph 5 by the Oil and Gas Division of the Department of Mines Regulations.

PROVEN ELEVATION $3267.81'$

Company ATLANTIC SEABOARD CORP.
 Address CHARLESTON, W. VA.
 Farm ELY C. A. CRIM, ET. AL.
 Tract _____ Acres 883 Lease No. AS-620-
 Well (Farm) No. _____ Serial No. 7444
 Elevation (Spirit Level) 3300.36'
 Quadrangle HORTON-SW
 County RANDOLPH District DRY FORK
 Engineer Hubert R. Howell
 Engineer's Registration No. 2529
 File No. 164-87 Drawing No. _____
 Date APRIL 26, 1966 Scale 1" = 1320'

STATE OF WEST VIRGINIA
 DEPARTMENT OF MINES
 OIL AND GAS DIVISION
 CHARLESTON

WELL LOCATION MAP
 FILE NO. RAN-125

+ Denotes location of well on United States Topographic Maps, scale 1 to 62,500 latitude and longitude lines being represented by border lines as shown.

- Denotes one inch spaces on border line of original tracing.

9-0 261 DEEP WELL } Oriskany Storage
 } TR. = Helderberg



STATE OF WEST VIRGINIA
DEPARTMENT OF MINES
OIL AND GAS DIVISION

Rotary
Spudder
Cable Tools
Storage

Quadrangle Horton

Permit No. RAN.-125

WELL RECORD

Oil or Gas Well Gas Storage
(KIND)

Company Atlantic Seaboard Corporation
Address P.O. Box 1273 Charleston, W.Va. 25325
Ely C.A. Crim, et al
(U.S.A. - Surface) Acres
Location (waters) East Fork of Gladly Creek
Well No. X-77-7444 Elev. 3388.36'
District Dry Fork County Randolph
The surface of tract is owned in fee by
Address
Mineral rights are owned by Elizabeth A. Crawford Vilseck, et al
4 So. Randolph St. Address Elkins, W.Va. 26031
Drilling commenced 7-3-66
Drilling completed 7-12-66
Date Shot From To

Casing and Tubing	Used in Drilling	Left in Well	Feet
Size			
16			
13 3/8		45' Cemented	
10			
9-5/8"		1602' Cemented	
7"		5176' Cemented	
5 3/16			
4 1/2			
3			
2 3/8		5396'	
Liners Used			

Open Flow /10ths Water in Inch
 /10ths Merc. in Inch
Volume 7,270,000 - Oriskany Cu. Ft.
Rock Pressure 1610 lbs. = hrs.
Oil bbls. 1st 24 hrs.
WELL ACIDIZED (DETAILS)
WELL FRACTURED (DETAILS)

Attach copy of cementing record.
CASING CEMENTED SIZE No. Ft. Date
Amount of cement used (bags)
Name of Service Co.
COAL WAS ENCOUNTERED AT FEET INCHES
 FEET INCHES FEET INCHES
 FEET INCHES FEET INCHES

RESULT AFTER TREATMENT (Initial open flow or bbls.)
ROCK PRESSURE AFTER TREATMENT HOURS
Fresh Water 225 Feet Salt Water Feet
Producing Sand Depth

Formation	Color	Hard or Soft	Top	Bottom	Oil, Gas or Water	Depth	Remarks
Surface			0	30	Water at 225'		
and			30	220			
Sand & Shale			220	865	All gas test - show when drilling completed		
Shale			865	1100			
Sand & Shale			1100	1507	Test before acidized - show		
Sand			1507	1905	Acidized 7-15-66 with 12,000 gallons		
Shale			1905	2610	28% Hcl acid, 4,000 gallons water		
Sand & Shale			2610	3362	overflush		
Shale			3362	4395	Test after acidized 7# spring gauge		
Lime			4395	4410	thru 4" 7,270 M		
Shale			4410	4650			
Tully Lime			4650	4675			
Marcellus			4675	4980	Shut in 7-21-66		
Onondaga Lime			4980	5025			
Chert - NEVIL			5025	5125			
Shale - NEEDMORE			5125	5171			
Oriskany			5171	5385			
Helderberg			5385				
Total Depth			5400'				

495

5171
3385
1783

