



STATE OF WEST VIRGINIA
DEPARTMENT OF MINES

RECEIVED

SEP 17 1980

Oil and Gas Division

OIL & GAS DIVISION
DEPT. OF MINES

OIL AND GAS WELL PERMIT APPLICATION

TO THE DEPARTMENT OF MINES,

Charleston, W. Va.

DATE September 9, 1980

Surface Owner AMAX Coal Company, a Div. of AMAX Inc. Company AMAX Petroleum Corporation

Address 105 S. Meridian, Indianapolis, Ind. 46225 Address 1300 West Belt, Houston, TX 77042

Mineral Owner AMAX Coal Company, a Div. of AMAX Inc. Farm B. Hamilton Tract Acres 198

Address (Same) Location (waters) Laurel Creek of Middle Fork Ri

Coal Owner AMAX Coal Company, a Div. of AMAX Inc. Well No. B. Hamilton #3 Elevation 2440

Address 105 S. Meridian, Indianapolis, Ind. 46225 District Roaring Creek County Randolph

Coal Operator AMAX Coal Company, a Div. of AMAX Inc. Quadrangle Ellamore, W. Va. 7.5 minute

Address (Same)

THIS PERMIT MUST BE POSTED AT THE WELL SITE

All provisions being in accordance with Chapter 22, of the W. Va. Code, the location is hereby approved for drilling. This permit shall expire if operations have not commenced by 5-30-81.

[Signature]
Deputy Director - Oil & Gas Division

INSPECTOR TO BE NOTIFIED Robert Stewart

ADDRESS P.O. Box 345, Jane Lew, W. Va. 26378

PHONE 884-7782

GENTLEMEN:

The undersigned well operator is entitled to drill upon the above named farm or tract of land for oil and gas, having fee title thereto, (or as the case may be) under grant or lease dated April 3 1980 by AMAX Coal Company made to AMAX Petroleum Corporation and recorded on the 12th day of May 1980, in Randolph County, Book 330 Page 424

NEW WELL DRILL DEEPER REDRILL FRACTURE OR STIMULATE
 OIL AND GAS WELL ORIGINALLY DRILLED BEFORE JUNE 5, 1969.

The enclosed plat was prepared by a registered engineer or licensed land surveyor and all coal owners and/or operators have been notified as of the above date.

The above named coal owners and/or operator are hereby notified that any objection they wish to make, or are required to make by Section 3 of the Code, must be received by, or filed with the Department of Mines within ten (10) days. *

Copies of this notice and the enclosed plat were mailed by registered mail, or delivered to the above named coal operators or coal owners at their above shown respective address _____ day _____ before, or on the same day with the mailing or delivery of this copy to the Department of Mines at Charleston, West Virginia.

PLEASE SUBMIT COPIES OF ALL GEOPHYSICAL LOGS DIRECTLY TO:

WEST VIRGINIA GEOLOGICAL AND ECONOMIC SURVEY
P. O. BOX 879
MORGANTOWN, WEST VIRGINIA 26505
AC-304 - 292-6331

Very truly yours,

(Sign Name) AMAX Petroleum Corporation
Well Operator

Address of Well Operator 1300 West Belt
Street Street
Houston
City or Town
Texas 77042
State

03/22/2024

*SECTION 3 If no objections are filed or found by the Department of mines, within said period of ten days from the receipt of notice and plat by the department of mines, to said proposed location, the department shall forthwith issue to the well operator a permit reciting the filing of such plat, that no objections have been made by the coal operators or found thereto by the department and that the same is approved and the well operator authorized to proceed.

BLANKET BOND

47-083-0358

PERMIT NUMBER

"I have read and understand the reclamation requirements as set forth in Chapter 22, Article 4, Section 12-b and will carry out the specified requirements."

Signed by [Signature]

THIS IS AN ESTIMATE ONLY
ACTUAL INFORMATION WILL BE SUBMITTED ON OG-10 UPON COMPLETION

PROPOSED WORK ORDER TO X DRILL _____ DEEPEN _____ FRACTURE STIMULATE _____
 DRILLING CONTRACTOR: (If Known) _____ RESPONSIBLE AGENT: _____
 NAME Ray Resources NAME Bob Schmalhausen
 ADDRESS 630 Commerce Square, Charleston, W.VA. ADDRESS 1300 West Belt, Houston, TX 77042
 TELEPHONE 304/344-8393 TELEPHONE 713/978-7700
 ESTIMATED DEPTH OF COMPLETED WELL: 5,200' ROTARY X CABLE TOOLS _____
 PROPOSED GEOLOGICAL FORMATION: _____
 TYPE OF WELL: OIL _____ GAS X COMB. _____ STORAGE _____ DISPOSAL _____
 RECYCLING _____ WATER FLOOD _____ OTHER _____

TENTATIVE CASING PROGRAM:

CASING AND TUBING SIZE	USED FOR DRILLING	LIFT IN WELL	CEMENT FILL UP OR SACKS - CUBIC FT.
20 - 16			
13 - 10	Conductor	± 50	Cmt to Surface
9 - 5/8			
8 - 5/8	Surface	± 1200	Cmt to Surface
7			
5 ½			
4 ½	Production	± 5200	Cmt to cover all potential completion zones
3			Perf. Top
2			Perf. Bottom
Liners			Perf. Top
			Perf. Bottom

APPROXIMATE FRESH WATER DEPTHS 11 FEET _____ SALT WATER _____ FEET _____
 APPROXIMATE COAL DEPTHS 55, 420, 670
 IS COAL BEING MINED IN THE AREA? No BY WHOM? _____

TO DRILL:

SUBMIT FIVE (5) COPIES OF OG - 1, \$100.00 PERMIT FEE, PERFORMANCE BOND AND PERMANENT COPY OF PLAT.

TO DRILL DEEPER OR REDRILL:

SUBMIT FIVE (5) COPIES OF OG - 1, SHOWING ORIGINAL PERMIT NUMBER AND PERFORMANCE BOND. ON WELLS DRILLED PRIOR TO 1929, A PERMANENT COPY OF THE PLAT AND THE ORIGINAL WELL RECORD MUST ALSO BE SUBMITTED.

TO FRACTURE - STIMULATE:

OIL AND/OR GAS WELL ORIGINALLY DRILLED BEFORE JUNE 5, 1929, FIVE (5) COPIES OG - 1, PERFORMANCE BOND, PERMANENT PLAT AND ORIGINAL WELL RECORD.

OIL AND/OR GAS WELL ORIGINALLY DRILLED ON AND/OR AFTER JUNE 5, 1929, FIVE COPIES OG - 1, SHOWING ORIGINAL PERMIT NUMBER AND PERFORMANCE BOND.

Required forms must be filed within ninety (90) days of completion for bond release. Inspector to be notified twenty-four (24) hours in advance.

The following waiver must be completed by the coal operator if the permit is to be issued within ten days of receipt thereof.

WAIVER: I the undersigned, Attorney in Fact AMAX Coal Company, a Div. of AMAX Inc. Owner or Operator of the coal under this lease have examined and place on our mine maps this proposed well location.
 We the AMAX Coal Company have no objections to said well being drilled at this location, providing operator has complied with all rules and regulations in Articles 4, 5, and 7, Chapter 22 of the West Virginia Code. **03/22/2024**

Wayne S. Kelly
 Attorney in Fact For Coal Company

Official Title

WELL SITE PLAN

- | | | | |
|---------------------------|--|------------|--|
| Legend: Property Boundary | | Diversion | |
| Road | | Spring | |
| Existing Fence | | Wet Spot | |
| Planned Fence | | Building | |
| Stream | | Drain Pipe | |
| Open Ditch | | Waterway | |

Sketch to include well location, existing access road, roads to be constructed, wellsite, drilling pits and necessary structures numbered or lettered to correspond with first part of this plan. Include all natural drainage.

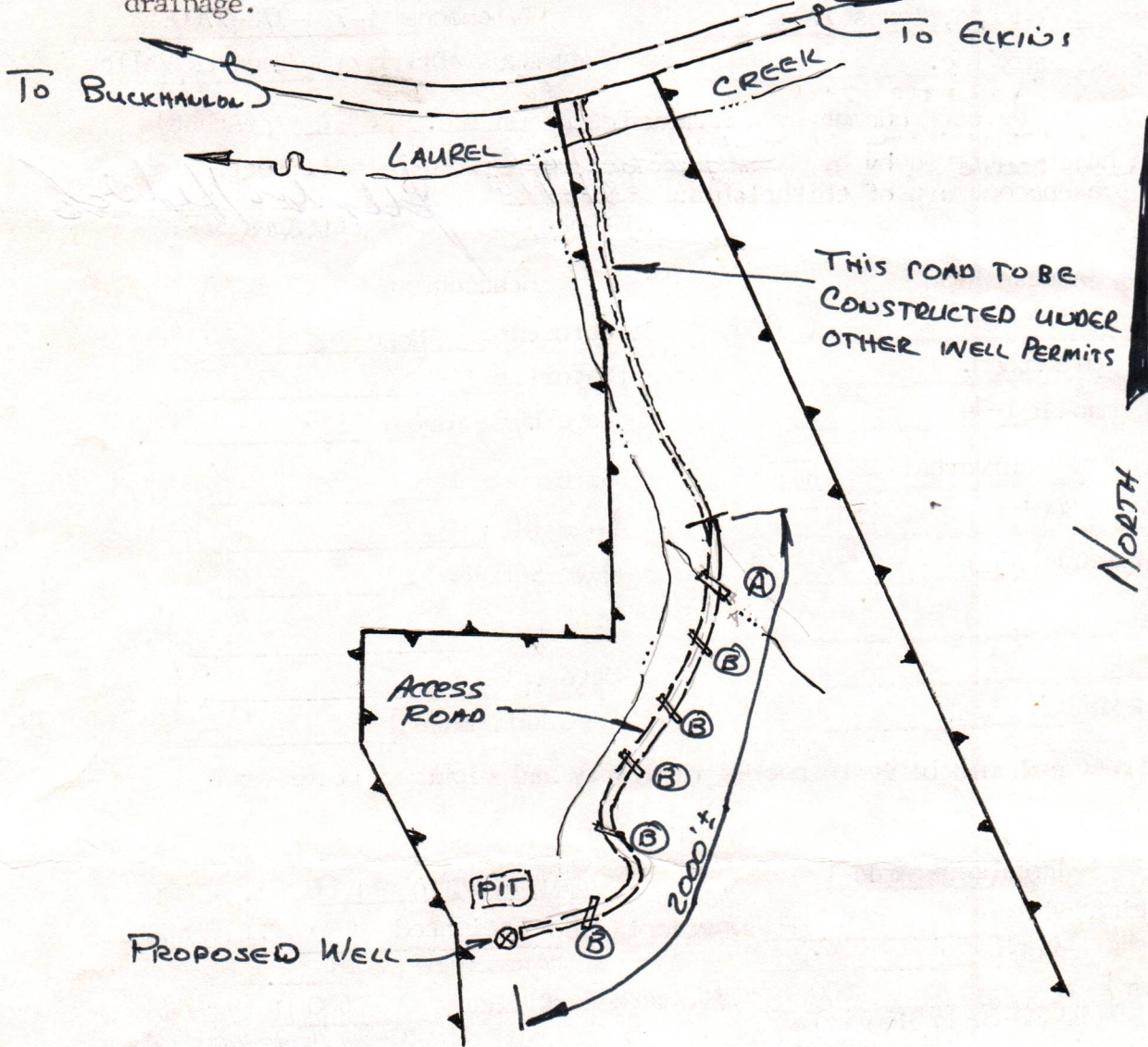

Comments:

- 1.) Disturbed area to be kept to a minimum.
- 2.) Cut slopes to be 2:1.
- 3.) New access road to follow old logging road. Road to be widened with the trees to be stacked and burned.
- 4.) New culverts to be at natural drains areas or at 300' max. Ditches to be cut on the uphill side of road where necessary.

Please request landowners cooperation to protect new seeding for one planting season.

03/22/2024

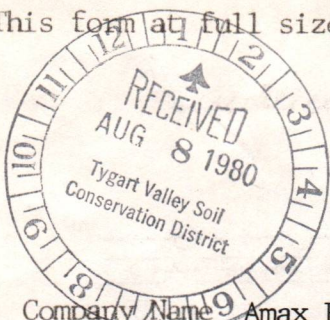

Date _____ 19____
Well No. B. HAMILTON # 3
API No. 47-083-0358

STATE OF WEST VIRGINIA
OFFICE OF OIL AND GAS

Company Name Amax Petroleum Inc. Designated Agent Kenneth I. Reiss
Address P.O. Box 42806 Address P.O. Box 42806 Houston, Texas
Telephone Houston, Texas 77042 Telephone 1-713-978-7700
Landowner Amax Inc. Soil Cons. District Tygart's Valley

Revegetation to be carried out by Amax Petroleum Inc. (Agent)

This plan has been reviewed by Tygart's Valley SCD. All corrections and additions become a part of this plan. 8/8/80 (Date) [Signature] (SCD Agent)

Access Road	Location
Structure <u>30" culvert</u> (A)	Structure <u>None</u> (1)
Spacing <u>In stream.</u>	Material _____
Page Ref. Manual <u>I-24</u>	Page Ref. Manual _____
Structure <u>12" culverts</u> (B)	Structure _____ (2)
Spacing <u>300'</u>	Material _____
Page Ref. Manual <u>I-8</u>	Page Ref. Manual _____
Structure _____ (C)	Structure _____ (3)
Spacing _____	Material _____
Page Ref. Manual _____	Page Ref. Manual _____

All structures should be inspected regularly and repaired if necessary.

Revegetation

Treatment Area I		Treatment Area II	
Lime Estimated _____ 3 Tons/acre	or correct to pH <u>6.5</u>	Lime Estimated _____ 3 Tons/acre	or correct to pH <u>6.5</u>
Fertilizer <u>600</u> lbs./acre	(10-20-20 or equivalent)	Fertilizer <u>600</u> lbs./acre	(10-20-20 or equivalent)
Mulch <u>Hay</u> 2 Tons/acre		Mulch <u>Hay</u> 2 Tons/acre	
Seed* <u>Kentucky 31</u> 40 lbs./acre		Seed* <u>Kentucky 31</u> 40 lbs./acre	
<u>Birdsfoot Trefoil</u> 10 lbs./acre		<u>Birdsfoot Trefoil</u> 10 lbs./acre	
<u>Ryegrass</u> 10 lbs./acre		<u>Ryegrass</u> 10 lbs./acre	

*Inoculate all legumes such as vetch, trefoil and clovers with the proper bacterium. Inoculate with 3X recommended amount.

BOND DRILL

Attach or photocopy section of involved Topographic map. Quadrangle Ellamore, W.Va.

Legend: Well Site
 Access Road

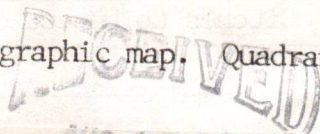

AMAX PETROLEUM CORPORATION

1300 WEST BELT P. O. BOX 42806 HOUSTON, TEXAS 77042
TELEPHONE (713) 978-7700 TELEX 79-1435

FENTON EASTERLING
Vice President
Production

April 30, 1981

RECEIVED
JFH
MAY - 4 1981

State of West Virginia
Department of Mines
Oil & Gas Division
Charleston, West Virginia 25305

OIL & GAS DIVISION
DEPT. OF MINES

Gentlemen:

We respectfully request permission to change the names of the following wells located in Randolph County:

<u>Present Lease & Well No.</u>	<u>Permit No.</u>	<u>Proposed Lease & Well No.</u>
B. Hamilton No. 1	47-083-0356	Parks No. 1
B. Hamilton No. 2	47-083-0357	Parks No. 2
B1 Hamilton No. 3	47-083-0358	Parks No. 3
B. Hamilton No. 4	47-083-0359	Towers No. 1
B. Hamilton No. 5	47-083-0360	Towers No. 2
J. Moyle No. 1	47-083-0361	Blackburn No. 1
J. Moyle No. 2	47-083-0362	Blackburn No. 2
J. Brown No. 1	47-083-0452	Crowl No. 1
J. Brown No. 2	47-083-0453	Crowl No. 2
J.T. Cain No. 1	47-083-0454	Crowl No. 3
P.J. Coyne No. 1	47-083-0455	Greer No. 1
P.J. Coyne No. 2	47-083-0456	Greer No. 2

If additional information is required, please advise.

Regards,

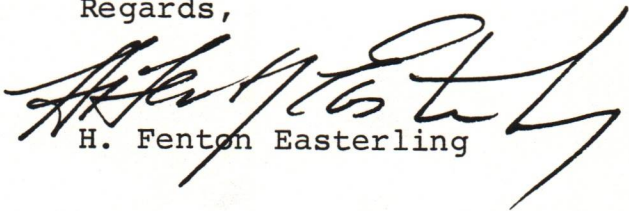
H. Fenton Easterling

HFE:mlm

03/22/2024

Formation	Color	Hard or Soft	Top Feet	Bottom Feet	Oil, Gas or Water	Remarks
Big Lime			1,272'	1,348'		
Big Injun			1,349'	1,406'		
Sand & Shale			1,407'	1,515'		
Pocono			1,516'	1,528'		
Sand & Shale			1,529'	1,894'		
4th Sand			1,895'	1,951'		
Sand & Shale			1,952'	2,157'		
5th Sand			2,158'	2,183'		
Sand & Shale			2,184'	2,261'		
Speechly			2,262'	2,273'		
Sand & Shale			2,274'	2,820'		
Balltown			2,821'	2,844'		
Sand & Shale			2,845'	3,579'		
Riley			3,580'	3,649'		
Sand & Shale			3,650'	3,741'		
Benson			3,742'	3,805'		
Sand & Shale			3,806'	3,950'		
1st Elk			3,951'	3,984'		
Sand & Shale			3,985'	4,101'		
2nd Elk			4,102'	4,257'		
Sand & Shale			4,258'	5,060'		
Haverty			5,061'	5,106'		
Sand & Shale			5,107'	5,165'		
4th Elk			5,166'	5,180'		
Sand & Shale			5,181'	5,241'		
Fox			5,242'	5,246'		
Sand & Shale			5,247'	5,401'		
Total Depth				5,401'		

Date August 26 ^{03/22/2024}, 19 81

APPROVED AMAX PETROLEUM CORPORATION Owner

By Reggie Johnson
Reggie Johnson

RECEIVED

AUG 31 1981

State of West Virginia
 OIL AND GAS DIVISION Department of Mines
 WV DEPARTMENT OF MINES Oil and Gas Division

WELL RECORD

Well Type: Oil ___ / Gas X / Liquid Injection ___ / Waste Disposal ___ /
 (If "Gas", Production X / Underground storage ___ / Deep ___ / Shallow X /
 Location: Elevation: 2,440' Watershed Laurel Creek of Middle Fork River
 District: Roaring Creek County: Randolph Quadrangle: 7.5 min.
 Well Operator AMAX Petroleum Corporation Designated Agent W. M. Woodroe
 Address 1300 West Belt Address Charleston National Plaza
Houston, Texas 77042 Charleston, W. Va. 25301
 Permitted Work: Drill X / Covert ___ / Drill deeper: ___ / Redrill ___ /
 Fracture or stimulate ___ / Plug off old formation ___ /
 Preforate new formation ___ / Other physical change in well (specify) ___

Permit Issued on 9/30/80

Oil & Gas Inspector for This Work:
 Name: Robert Stewart
 Address: P. O. Box 345
Jane Lew, W. Va. 26378

Geological Target Formation: Elk Depth 5,200 feet
 Depth of completed well, 5,401' feet Rotary X / Cable Tools ___ /
 Water strata depth: Fresh 25 feet; Salt; ___ feet.
 Coal seam depths: ___ Is coal being mined in the area? ___
 Work was commenced 4/21/81, and completed 5/12/81

Casing and Tubing Program

Casing or Tubing Type	Specifications				Footage Intervals		Cement Fill-Up Or Sacks (cubic feet)	
	Size	Grade	Weight per ft	New	Used	For drilling		Left in well
Conductor	11 ³ / ₄ "			X		35'	35'	15 sx. std. 1 sx. CaCl ₂
Fresh Water								
Coal								
Intermediate	8 ⁵ / ₈ "		23#/ft.	X		1,139'	1,139'	Cmt. to surf.
Production	4 ¹ / ₂ "		10.5#/ft	X		5,392'	5,392'	Cmt. to 2000'
Tubing								
Liners								

Well Treatment details:

Perforate Haverty @ 5,093'-98', 5,081'-89', 5,071'-79' & 5,061'-67' w/1SPF.
 Frac'd w/250 gal. 15% HCl + 120 bbls. gel & 15,000# 80/100 @ 30 BPM & 2,900#.
 Followed w/375 bbls. gel & 60,000# 20/40 @ 33 BPM & 2,700#. Perforate 2nd Elk
 4,245'-53' & 4,189'-97', 4,175'-78', 4,102'-10' w/1SPF, Frac'd w/500 gal. 15%
 HCl & 120 bbls. gel & 15,000# 80/100 @ 36 BPM & 2,400#. Followed w/270 bbls. gel
 & 35,000# 20/40 @ 38 BPM & 2,200#. Perforate Benson @ 3,788'-92', 3,765'-71',
 3,742'-50' & Riley @ 3,580'-92', 3,596'-603' & 3,623'-27' w/1SPF. Frac'd w/500
 gal. 15% HCl + 120 bbls. gel & 20,000# 80/100 @ 43 BPM & 1,900#. Followed w/
 240 bbls. gel & 60,000# 20/40 @ 45BPM & 1,800#.
 Gas: Initial open flow, ___ Mcf/d Oil: Initial open flow, ___ Bbl/d
 Final open flow, 797 Mcf/d Final open flow, ___ Bbl/d
 Static Rock Pressure, 1,500 psig (surface measurement) after 72 hours shut in.

(Well log on reverse side)

STATE OF WEST VIRGINIA
DEPARTMENT OF MINES
OIL AND GAS WELLS DIVISION

RECEIVED

APR 20 1981

INSPECTOR'S WELL REPORT

OIL & GAS DIVISION
DEPT. OF MINES GAS

Permit No. 083-0358

Company ANAX Petroleum
 Address HOUSTON, TEXAS
 Farm B. HAMILTON
 Well No. # 3
 District REARING CREEK County RANDOLPH
 Drilling commenced 4-17-81
 Drilling completed _____ Total depth _____
 Date shot _____ Depth of shot _____
 Initial open flow _____ /10ths Water in _____ Inch
 Open flow after tubing _____ /10ths Merc. in _____ Inch
 Volume _____ Cu. Ft.
 Rock pressure _____ lbs. _____ hrs.
 Oil _____ bbls., 1st 24 hrs.
 Fresh water _____ feet _____ feet
 Salt water _____ feet _____ feet

CASING AND TUBING	USED IN DRILLING	Left in Well	PACKERS
Size			
16			Kind of Packer
13			
10			Size of
8 1/4			
6 3/4			Depth set
5 3/16			
3			Perf. top
2			Perf. bottom
Liners Used			Perf. top
			Perf. bottom

CASING CEMENTED _____ SIZE _____ No. FT _____ Date _____
 NAME OF SERVICE COMPANY _____
 COAL WAS ENCOUNTERED AT _____ FEET _____ INCHES
 _____ FEET _____ INCHES _____ FEET _____ INCHES
 _____ FEET _____ INCHES _____ FEET _____ INCHES

Drillers' Names RAY Resources Rig -14

Remarks: Move Rig - SPD

4-16-81
DATE

Robert Stewart 511
DIRECTOR
03/22/2024

DEPARTMENT OF MINES

OIL AND GAS WELLS DIVISION

INSPECTOR'S PLUGGING REPORT

Permit No. _____ Well No. _____

COMPANY _____ ADDRESS _____

FARM _____ DISTRICT _____ COUNTY _____

Filling Material Used _____

Liner Location Amount Packer Location

PLUGS USED AND DEPTH PLACED			BRIDGES		CASING AND TUBING		
CEMENT-THICKNESS	WOOD-SIZE	LEAD	CONSTRUCTION	LOCATION	RECOVERED	SIZE	LOST

Drillers' Names _____

Remarks: _____

DATE _____ hereby certify I visited the _____ well on this date

STATE OF WEST VIRGINIA
DEPARTMENT OF MINES
OIL AND GAS WELLS DIVISION

INSPECTOR'S WELL REPORT

Permit No. 083-0358

Oil or Gas Well GAS

Company	CASING AND TUBING	USED IN DRILLING	Left in Well	PACKERS
<u>AMAX PRODUCTIONS</u>				
Address <u>HOUSTON TEXAS</u>	Size			Kind of Packer
Farm <u>B. HAMILTON</u>	16			
Well No <u># 3</u>	13			Size of
District <u>BOARING CREEK</u> County <u>RANDOLPH</u>	<u>8 7/8</u>		<u>1139</u>	<u>235 SKS</u>
Drilling commenced <u>4-17-81</u>	6 3/4			Depth set
Drilling completed _____ Total depth _____	5 3/16			
Date shot _____ Depth of shot _____	3			Perf. top
Initial open flow _____ /10ths Water in _____ Inch	2			Perf. bottom
Open flow after tubing _____ /10ths Merc. in _____ Inch	Liners Used			Perf. top
Volume _____ Cu Ft.				Perf. bottom
Rock pressure _____ lbs. _____ hrs.	CASING CEMENTED <u>8 7/8</u> SIZE <u>1139</u> No. FT. _____ Date <u>4-24-81</u>			
Oil _____ bbls., 1st 24 hrs.	NAME OF SERVICE COMPANY <u>HALLIBURTON</u>			
Fresh water _____ feet _____ feet	COAL WAS ENCOUNTERED AT _____ FEET _____ INCHES			
Salt water _____ feet _____ feet	_____ FEET _____ INCHES _____ FEET _____ INCHES			
	_____ FEET _____ INCHES _____ FEET _____ INCHES			

Drillers' Names RAY Resources Rig 14

Remarks: Cement To SURFACE
LOG COAL

RECEIVED

APR 27 1981

OIL & GAS DIVISION
DEPT. OF MINES

4-24-81

DATE

Robert Stewart 511
DIRECTOR

03/22/2024

DEPARTMENT OF MINES

OIL AND GAS WELLS DIVISION

INSPECTOR'S PLUGGING REPORT

Permit No. _____ Well No. _____

COMPANY _____ ADDRESS _____

FARM _____ DISTRICT _____ COUNTY _____

Filling Material Used _____

Liner	Location	Amount	Packer	Location
PLUGS USED AND DEPTH PLACED		BRIDGES		CASING AND TUBING
CEMENT-THICKNESS	WOOD-SIZE	LEAD	CONSTRUCTION LOCATION	RECOVERED SIZE LOST

Drillers' Names _____

Remarks: _____

DATE _____ hereby certify I visited the _____ well on this date

DISTRICT SUPERVISOR
03/22/2024

STATE OF WEST VIRGINIA
DEPARTMENT OF MINES
OIL AND GAS WELLS DIVISION

RECEIVED

JAN 10 1983

INSPECTOR'S WELL REPORT

OIL AND GAS DIVISION
WV DEPARTMENT OF MINES

Permit No. 093-0358

Oil or Gas Well _____
(KIND)

Company ANAX Petroleum
 Address HOUSTON TX
 Farm B. HAMILTON
 Well No. # 3
 District BARING CREEK County RANDOLPH
 Drilling commenced 4-17-81
 Drilling completed _____ Total depth _____
 Date shot _____ Depth of shot _____
 Initial open flow _____ /10ths Water in _____ Inch
 Open flow after tubing _____ /10ths Merc. in _____ Inch
 Volume _____ Cu. Ft.
 Rock pressure _____ lbs. _____ hrs.
 Oil _____ bbls., 1st 24 hrs.
 Fresh water _____ feet _____ feet
 Salt water _____ feet _____ feet

CASING AND TUBING	USED IN DRILLING	LEFT IN WELL	PACKERS
Size			
16			Kind of Packer _____
13			
10			Size of _____
8 1/4			
6 3/4			Depth set _____
5 3/16			
3			Perf. top _____
2			Perf. bottom _____
Liners Used			Perf. top _____
			Perf. bottom _____

CASING CEMENTED _____ SIZE _____ No. FT. _____ Date _____
 NAME OF SERVICE COMPANY _____
 COAL WAS ENCOUNTERED AT _____ FEET _____ INCHES
 _____ FEET _____ INCHES FEET _____ INCHES
 _____ FEET _____ INCHES FEET _____ INCHES

Drillers' Names _____

Remarks:

OK To Release

1-5-83

DATE

Robert Stewart 03/22/2024

DISTRICT WELL INSPECTOR

Form 26
2/16/82

STATE OF WEST VIRGINIA
DEPARTMENT OF MINES
OIL AND GAS WELLS DIVISION

INSPECTOR'S PLUGGING REPORT

Permit No. _____

Well No. _____

COMPANY _____ ADDRESS _____

FARM _____ DISTRICT _____ COUNTY _____

Filling Material Used _____

Liner	Location		Amount	Packer	Location		
PLUGS USED AND DEPTH PLACED			BRIDGES		CASING AND TUBING		
CEMENT-THICKNESS	WOOD-SIZE	LEAD	CONSTRUCTION-LOCATION		RECOVERED	SIZE	LOST

Drillers' Names _____

Remarks: _____

_____ I hereby certify I visited the above well on this date.
DATE

03/22/2024

DISTRICT WELL INSPECTOR



State of West Virginia
Department of Mines
Oil and Gas Division
Charleston 25305

WALTER N. MILLER
DIRECTOR

THEODORE M. STREIT
ADMINISTRATOR

February 1, 1983

Amax Petroleum Corp.
P. O. Box 42806
Houston, Texas 77042

Gentlemen:

The required records and reports have been received in this office and the District Inspectors have submitted FINAL INSPECTIONS for the following wells listed below:

<u>PERMIT NUMBER</u>	<u>FARM AND WELL NUMBER</u>	<u>DISTRICT</u>
RAN-0358	B. Hamilton, Parks #3	Roaring Creek
RAN-0359	B. Hamilton, Towers #1	Roaring Creek
RAN-0360	B. Hamilton, Towers #2	Roaring Creek

In accordance with Chapter 22, Article 4, Section 2, the above captioned wells will remain under bond coverage for "life of wells." Reclamation requirements have been approved.....

Very truly yours,

Theodore M. Streit, Administrator
Office of Oil & Gas-Dept. Mines

TMS/

03/22/2024

1.0 API well number: (If not available, leave blank. 14 digits.)	47-083-0358
2.0 Type of determination being sought: (Use the codes found on the front of this form.)	Section of NGPA 103 Category Code 1
3.0 Depth of the deepest completion location: (Only needed if sections 103 or 107 in 2.0 above.)	5098 feet
4.0 Name, address and code number of applicant: (35 letters per line maximum. If code number not available, leave blank.)	Name AMAX Petroleum Corporation P. O. Box 42806 Houston TX 77042 City Houston TX 77042 State TX Zip Code 77042
5.0 Location of this well: [Complete (a) or (b).] (a) For onshore wells (35 letters maximum for field name.) (b) For OCS wells:	Field Name Roaring Creek County Randolph State WV
(b) For OCS wells:	Area Name Block Number Date of Lease: Mo. Day Yr. OCS Lease Number
(c) Name and identification number of this well: (35 letters and digits maximum.) (d) If code 4 or 5 in 2.0 above, name of the reservoir: (35 letters maximum.)	Parks No. 3
6.0 (a) Name and code number of the purchaser: (35 letters and digits maximum. If code number not available, leave blank.) (b) Date of the contract:	Name Buyer Code Mo. Day Yr.
(c) Estimated annual production:	180 MMcf.
(a) Base Price (\$/MMBTU) (b) Tax (c) All Other Prices [Indicate (+) or (-).] (d) Total of (a), (b) and (c)	* * * *
7.0 Contract price: (As of filing date. Complete to 3 decimal places.)	* * * *
8.0 Maximum lawful rate: (As of filing date. Complete to 3 decimal places.)	2 5 1 4
9.0 Person responsible for this application:	Name Norman B. Gove Title Vice President Signature Norman B. Gove Date Application is Completed October 2, 1981 Phone Number 713/978-7700

* No contract has been finalized or sales made as of the date of this application.

FT1900806/2-2

Agency Use Only
Date Received by Juris. Agency
OCT 18 1981
Date Received by FERC

202/22/131

00118 1981

AMAX
000746

PARTICIPANTS:

DATE: JAN 14 1982

BUYER-SELLER CODE

WELL OPERATOR: AMAX Petroleum Corp.

000446

FIRST PURCHASER: Columbia Gas Trans.

OTHER: _____

W. Va. Department of Mines, Oil & Gas Division
 WELL DETERMINATION FILE NUMBER
81-10-13-103-083-0358
 Use Above File Number on all Communications
 Relating to Determination of this Well

Qualifies J. H. Huggins

CHECK EACH ITEM AS COMPLETE OR NOTE WHAT IS MISSING

ITEM NO.

- 1. FERC -121 Items not completed - Line No. 7.0 all 8.0 bcd
- 2. IV-1 Agent WM Woodroe
- 3. IV-2 Well Permit
- 4. IV-6 Well Plat
- 5. IV-35 Well Record Drilling _____ Deepening _____
- 6. IV-36 Gas-Oil Test: Gas Only _____ Was Oil Produced? _____ Ratio
- 7. IV-39 Annual Production _____ years
- 8. IV-40 90 day Production _____ Days off line: _____
- 9. IV-48 Application for certification. Complete? _____
- 10-17. IV Form 51 - 52 - 53 - (54) - 55 - 56 - 57 - 58 Complete? Affidavit Signed
- 18-28. Other: Survey _____ Logs _____ Geological Charts _____
 Structure Map _____ 1: 4000 Map _____ Well Tabulations _____
 Gas Analyses _____
- (5) Date commenced: 4-21-81 Date completed 5-12-81 Deepened _____
- (5) Production Depth: 5093-98 4245-53 3788-92 3623-27
- (5) Production Formation: Haverly 2nd Elk Benson Riley
- (5) Final Open Flow: 797 mcf
- (5) After Frac. R. P. 1500 # 72 hrs
- (6) Other Gas Test: _____
- (7) Avg. Daily Gas from Annual Production: _____
- (8) Avg. Daily Gas from 90-day ending w/1-120 days _____
- (8) Line Pressure: _____ PSIG from Daily Report _____
- (5) Oil Production: _____ From Completion Report _____
- 10-17. Does lease inventory indicate enhanced recovery being done No
- 10-17. Is affidavit signed? Notarized? 03/22/2024
- Does official well record with the Department confirm the submitted information? Yes
- Additional information _____ Does computer program confirm? _____
- Was Determination Objected to _____ By Whom? _____

Date October 2 1981

Parks No. 3
NGPA Sec. 103

STATE OF WEST VIRGINIA
DEPARTMENT OF MINES, OIL AND GAS DIVISION

Operator's Well No. _____
API Well No. 47 - 083 - 0357
State County Permit

WELL CLASSIFICATION FORM
NEW ONSHORE PRODUCTION WELL
NGPA Section 103

DESIGNATED AGENT W. M. Woodroe
ADDRESS Charleston National Plaza
Charleston, W. Va. 25301

WELL OPERATOR AMAX Petroleum Corporation
ADDRESS P. O. Box 42806
Houston, Texas 77042

LOCATION: Elevation 2440'
Watershed Laurel Creek of Middle Fork River
Roaring
Dist. Creek County Randolph Quad. Ellamore 7.5

GAS PURCHASER *
ADDRESS *
*

Gas Purchase Contract No. *
Meter Chart Code -
Date of Contract *

* No contract has been finalized or sales made as of the date of this application.

* * * * *

Date surface drilling was begun: April 21, 1981

Indicate the bottom hole pressure of the well and explain how this was calculated:

BHP = 1686

$$BHP = PSI + \frac{(0.01878) (PSI) (G) (L)}{TSI}$$

PSI = 1515
G = .65
L = 5096
TSI = 548

PSI = Shut-in wellhead pressure in PSIA
G = Gas gravity (assuming 0.65)
L = Average length of flow string (feet)
TSI = Average shut-in well temperature (degrees R)

$$\frac{BHT + 520}{2} = TSI$$

BHT = degrees R absolute

AFFIDAVIT

I, Norman B. Gove, having been first sworn according to law state that surface drilling of the well for which this determination is sought was begun on or after February 19, 1977; the well satisfies applicable state or federal well spacing requirements and the well is not within a proration unit, in existence at the time surface drilling began, which was applicable to the reservoir from which gas is or will be produced and which applied to any other well producing gas in commercial quantities or on which surface drilling began on or after February 19, 1977, and which was capable of producing gas in commercial quantities. I state, further, that I have concluded, to the best of my information, knowledge and belief, that the well for which this determination is sought is a new onshore production well and that I am not aware of any information not described in the application which is inconsistent with this conclusion.

Norman B. Gove

TEXAS
STATE OF ~~WEST VIRGINIA~~,

COUNTY OF HARRIS, TO WIT:

I, Gloria Kessler, a Notary Public in and for the state and county aforesaid, do certify that Norman B. Gove, whose name is signed to the writing above, bearing date the 2 day of October, 1981, has acknowledged the same before me, in my county aforesaid.

Given under my hand and official seal this 6th day of October, 1981.

My term of office expires on the 5th day of January, 1984.

[NOTARIAL SEAL]

Gloria G. Kessler
Notary Public

03/22/2024