

STATE OF WEST VIRGINIA  
DEPARTMENT OF MINES, OIL AND GAS DIVISION

Date: October 7, 19 80

Operator's  
Well No. R. Wilson #1

API Well No. 47-083-0370  
State County Permit

OIL AND GAS WELL PERMIT APPLICATION

WELL TYPE: Oil  / Gas  /  
(If "Gas", Production  / Underground storage  / Deep  / Shallow )  
LOCATION: Elevation: 2340 Watershed: Hell Run of Middle Fork River  
District: Roaring Creek County: Randolph Quadrangle: Ellamore - 7.5 min.

WELL OPERATOR R&B Petroleum, Inc.  
Address 250 Park Ave.  
New York, NY 10177

DESIGNATED AGENT John S. Bailey, Jr.  
Address 214 Eighth Street  
Parkersburg, WV 26101

OIL & GAS  
ROYALTY OWNER Russell O. Wilson  
Address 11A Gate Way  
Elkins, WV 26241

COAL OPERATOR None  
Address \_\_\_\_\_

SURFACE OWNER Meadowlark Farms, Inc. and/or  
Address Parkersburg, WV / Amax Coal Co.  
105 S. Meridian St., Indianapolis, Ind.  
Acreage 14

COAL OWNER(S) WITH DECLARATION ON RECORD:  
Name Amax, Inc., on behalf of its Division  
Amax Coal  
Address 105 S. Meridian St.  
Indianapolis, Ind. 1980

FIELD SALE (IF MADE) TO:  
Name \_\_\_\_\_  
Address \_\_\_\_\_

Name \_\_\_\_\_  
Address OIL & GAS DIVISION  
DEPT. OF MINES

OIL & GAS INSPECTOR TO BE NOTIFIED  
Name Robert Stewart  
Address Jane Lew, WV  
(304) 884-7782

COAL LESSEE WITH DECLARATION ON RECORD:  
Name None  
Address \_\_\_\_\_

The undersigned well operator is entitled to operate for oil or gas purposes at the above location under/a deed  / lease  / other contract  dated 10/1/80 / dated March 26, 1980, to the undersigned well operator from Russell O. Wilson and Mary M. Wilson of said deed, lease, or other contract has been recorded:]

Recorded on April 10, 1980, in the office of the Clerk of the County Commission of Randolph County, West Virginia, in Deed Book 330 at page 69. A permit is requested as follows:

PROPOSED WORK: Drill  / Drill deeper  / Redrill  / Fracture or stimulate  /  
Plug off old formation  / Perforate new formation  /  
Other physical change in well (specify) \_\_\_\_\_

--planned as shown on the work order on the reverse side hereof.  
The above named coal operator, coal owner(s), and coal lessee are hereby notified that any action they wish to make or are required to make by Code § 22-4-3 must be filed with the Department of Mines within fifteen (15) days after the receipt of this Application by the Department.

Copies of this Permit Application and the enclosed plat and reclamation plan have been mailed by registered mail or delivered by hand to the above named coal operator, coal owner(s), and coal lessee before the day of the mailing or delivery of this Permit Application to the Department of Mines at Reston, West Virginia.

PLEASE SUBMIT COPIES OF ALL PHYSICAL LOGS DIRECTLY TO:  
WEST VIRGINIA OIL AND GAS OBSERVATION COMMISSION  
WASHINGTON STREET EAST  
RESTON, WV 25311

**BLANKET BOND**

R&B Petroleum, Inc.  
Well Operator  
By [Signature]  
Its President

03/22/2024



[08-78]

PROPOSED WORK ORDER

THIS IS AN ESTIMATE ONLY:  
ACTUAL INFORMATION MUST BE SUBMITTED ON FORM IV-35 UPON COMPLETION:

DRILLING CONTRACTOR (IF KNOWN) \_\_\_\_\_

Address \_\_\_\_\_

GEOLOGICAL TARGET FORMATION, Benson

Estimated depth of completed well, 3900' feet Rotary  / Cable tools \_\_\_\_\_ /

Approximate water strata depths: Fresh, 100 feet; salt, 600 feet.

Approximate coal seam depths: 200-600' Is coal being mined in the area? Yes \_\_\_\_\_ / No  /

CASING AND TUBING PROGRAM

CASING OR TUBING TYPE	SPECIFICATIONS				FOOTAGE INTERVALS		CEMENT FILL-UP OR SACKS (Cubic feet)	PACKERS
	Size	Grade	Weight per ft	New	Used	For drilling		
Conductor	13"						20'	Kinds
Fresh water								
Coal								Sizes
Intermediate	8 5/8"						1000'	250 sks
Production	4 1/2"						3900'	500 "
Tubing								Depths set
Liners								Perforations:
								Top Bottom

**NOTE:** Regulation 7.02 of the Department of Mines provides that the original and four copies of Form IV-2 must be filed with the Department, accompanied by (i) a plat in the form prescribed by Regulation 11, (ii) a bond in one of the forms prescribed by Regulation 12, or in lieu thereof the other security allowed by Code § 22-4-2, (iii) Form IV-9, "Reclamation Plan", applicable to the reclamation required by Code § 22-4-12b and Regulation 23, (iv) unless previously paid on the same well, the fee required by Code § 22-4-12a, and (v) if applicable, the consent required by Code § 22-4-8a from the owner of any water well or dwelling within 200 feet of the proposed well.

A separate Form IV-2 shall not be required for fracturing or stimulating a well where fracturing or stimulating is to be part of the work for which a permit is sought and is noted as such on the Form IV-2 filed in connection therewith.

**THIS PERMIT MUST BE POSTED AT THE WELL SITE**

All provisions being in accordance with Chapter 22, of the W. Va. Code, the location is hereby approved for drilling \_\_\_\_\_. This permit shall expire if operations have not commenced by 7-13-81.

*[Signature]*  
Deputy Director - Oil & Gas Division

The following waiver must be completed by the coal operator and by any coal owner or coal lessee who has recorded a declaration under Code § 22-4-20, if the permit is to be issued within fifteen (15) days of receipt thereof:

W A I V E R

The undersigned coal operator \_\_\_\_\_ / owner \_\_\_\_\_ / lessee \_\_\_\_\_ / of the coal under this well location has examined this proposed well location. If a mine map exists which covers the area of the well location, the well location has been added to the mine map. The undersigned has no objection to the work proposed to be done at this location, provided, the well operator has complied with all applicable requirements of the West Virginia Code and the governing regulations.

03/22/2024

re: \_\_\_\_\_, 19\_\_\_\_

By \_\_\_\_\_

Its \_\_\_\_\_



WELL SITE PLAN

- |         |                   |  |            |  |
|---------|-------------------|--|------------|--|
| Legend: | Property Boundary |  | Diversion  |  |
|         | Road              |  | Spring     |  |
|         | Existing Fence    |  | Wet Spot   |  |
|         | Planned Fence     |  | Building   |  |
|         | Stream            |  | Drain Pipe |  |
|         | Open Ditch        |  | Waterway   |  |

Sketch to include well location, existing access road, roads to be constructed, wellsite, drilling pits and necessary structures numbered or lettered to correspond with first part of this plan. Include all natural drainage.

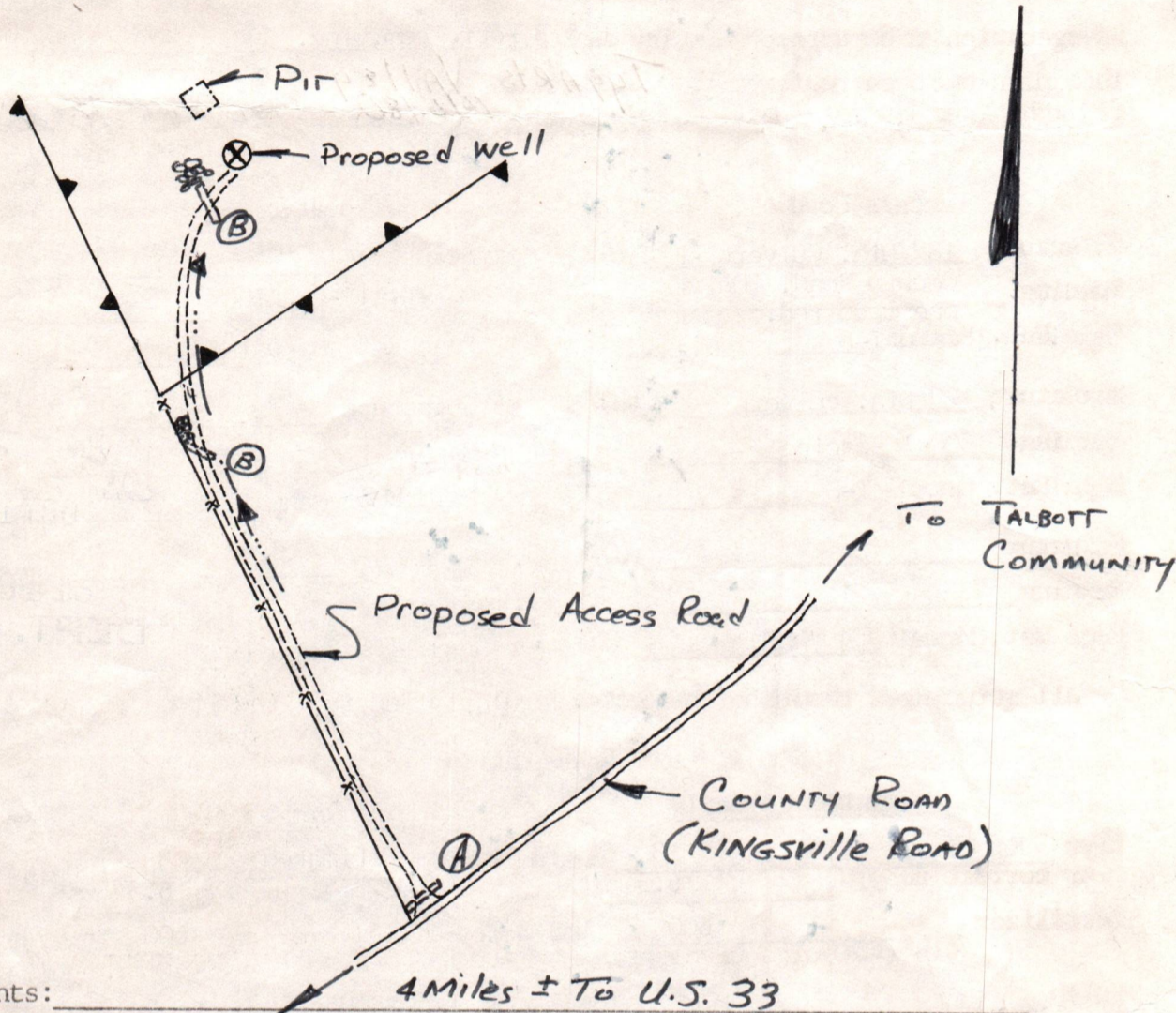

Comments:

- 1.) Disturbed area to be kept to a minimum.
- 2.) Cut slopes to be 2:1.
- 3.) New culverts to be at natural drains or 300' max. spacing. Ditches to be cut on uphill side of road as necessary.
- 4.) Timber to be cut, stacked and burned.

Please request landowners cooperation to protect new seeding for one planting season.

03/22/2024



This form at full size is 8 1/2 x 14 allowing room for sketch and topo map.

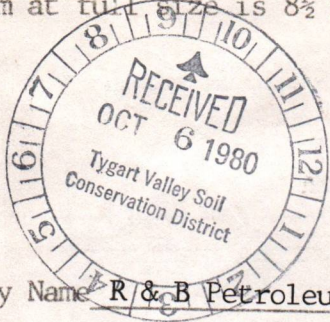

Date 10-6-1980  
Well No. R. Wilson #1  
API No. \_\_\_\_\_

STATE OF WEST VIRGINIA  
OFFICE OF OIL AND GAS

Company Name R & B Petroleum, Inc. Designated Agent Mike Ross  
Address 250 Park Ave. Address Coalton, W. VA.  
Telephone New York, New York Telephone 304-636-4398  
Landowner Meadowlark Farms, Inc. Soil Cons. District Tygart Valley

Revegetation to be carried out by R & B Petroleum, Inc. (Agent)

This plan has been reviewed by Tygart Valley SCD. All corrections and additions become a part of this plan. 10/6/80 (Date) [Signature] (SCD Agent)

Access Road \_\_\_\_\_  
Structure 18" Dia. Culvert at (A)  
Spacing County Road. Only  
Page Ref. Manual I-8  
one required.

Location \_\_\_\_\_  
Structure \_\_\_\_\_ (1)  
Material \_\_\_\_\_  
Page Ref. Manual \_\_\_\_\_

Structure 12" Dia. culvert (B)  
Spacing 300' spacing  
Page Ref. Manual I-8

Structure \_\_\_\_\_  
Material \_\_\_\_\_  
Page Ref. Manual \_\_\_\_\_

Structure \_\_\_\_\_ (C)  
Spacing \_\_\_\_\_  
Page Ref. Manual \_\_\_\_\_

Structure \_\_\_\_\_ (3)  
Material \_\_\_\_\_  
Page Ref. Manual \_\_\_\_\_  
OIL & GAS DIVISION  
DEPT. OF MINES

All structures should be inspected regularly and repaired if necessary.

Revegetation

Treatment Area I

Treatment Area II

Lime Estimated 3 Tons/acre  
or correct to pH 6.5

Lime Estimated 3 Tons/acre  
or correct to pH 6.5

Fertilizer 600 lbs./acre  
(10-20-20 or equivalent)

Fertilizer 600 lbs./acre  
(10-20-20 or equivalent)

Mulch Hay 2 Tons/acre

Mulch Hay 2 Tons/acre

Seed\* Kentucky 31 40 lbs./acre  
Birdsfoot Trefoil 10 lbs./acre  
Ryegrass 10 lbs./acre

Seed\* Kentucky 31 40 lbs./acre  
Birdsfoot Tre 10 lbs./acre  
Ryegrass 10 lbs./acre

\*Inoculate all legumes such as vetch, trefoil and clovers with the proper bacterium. Inoculate with 3X recommended amount.

Attach or photocopy section of involved Topographic map. Quadrangle Ellamore, W. VA.

Legend: ⊙ Well Site

— Access Road





**AMAX** **COAL COMPANY**  
A DIVISION OF AMAX INC.

105 SOUTH MERIDIAN STREET, INDIANAPOLIS, INDIANA 46225 • (317) 266-2626

December 2, 1980

Department of Mines  
Oil and Gas Division  
1615 Washington Street, East  
Charleston, West Virginia 25311

Re: R & B Petroleum, Inc.  
R. Wilson #1  
Roaring Creek District  
Randolph County, W. Va.

*Row-370*

RECEIVED

DEC 11 1980

OIL & GAS DIVISION

Dear Sirs:

The AMAX Coal Company has received notification that a permit application is being filed to drill the above-mentioned well. The AMAX Coal Company will offer no objection to the drilling of this proposed well provided the applicant intends to drill the proposed well subject to the following conditions:

1. All drilling and casing of the well shall be done in compliance with the laws and regulations of the State of West Virginia for wells drilled through workable coal beds.
2. All workable coal seams regardless of depth shall be plugged in accordance with the rules and regulations of the State of West Virginia, specifically as outlined in Article 4, Chapter 22 of the West Virginia Code.
3. R & B Petroleum, Inc. - - will provide AMAX with a density and natural gamma ray log at a 5"=100' scale covering the interval from total depth to ground surface. In addition, one copy of any other geophysical log shall be sent to AMAX. However, AMAX Coal Company retains the option to run their own logs or have this service contracted out. Please contact Mr. David Darko (317/266-2633) for questions on this procedure.

03/22/2024



Department of Mines  
Page Two  
December 2, 1980

4. Copies of the completion report, OG-10, and plugging affidavit, OG-8, if applicable, shall be sent to AMAX Coal Company, Attention: James W. Faber.

Sincerely,

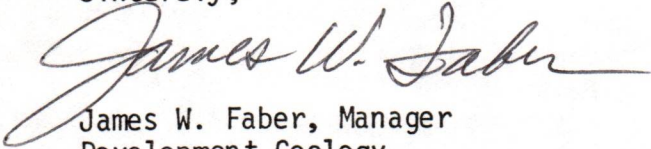

James W. Faber, Manager  
Development Geology

JWF/mdt

Enclosures

cc: R & B Petroleum, Inc.  
David A. Darko

RECEIVED

DEC 11 1980

OIL & GAS DIVISION  
DEPT. OF MINES

---

The above stipulations are agreed to as a condition for obtaining a drilling permit.

  
\_\_\_\_\_  
Representative of R & B Petroleum, Inc.

12/5/80  
\_\_\_\_\_  
(Date)

03/22/2024









**RECEIVED**

MAY 11 1981

STATE OF WEST VIRGINIA  
DEPARTMENT OF MINES

OIL & GAS DIVISION  
DEPT. OF MINES

Oil and Gas Division  
WELL RECORD

Union Drilling, Inc.  
Rig #4

Rotary X Oil \_\_\_\_\_  
Cable \_\_\_\_\_ Gas X \_\_\_\_\_  
Recycling \_\_\_\_\_ Comb. \_\_\_\_\_  
Water Flood \_\_\_\_\_ Storage \_\_\_\_\_  
Disposal \_\_\_\_\_ (Kind) \_\_\_\_\_

Quadrangle Ellamore  
Permit No. 47-083-0370

Company R & B Petroleum, Inc.  
Address 250 Park Ave., New York, NY 10017  
Farm Russell Wilson Acres 18  
Location (waters) Hell Run of Middle Fork River  
Well No. 1 Elev. 2340'  
District Roaring Creek County Randolph  
The surface of tract is owned in fee by Meadow  
Lark Farms - Amax Coal Co.  
Address 105 S. Meridian St., Indianapolis, Ind.  
Mineral rights are owned by \_\_\_\_\_  
Address \_\_\_\_\_  
Drilling Commenced 2-28-81  
Drilling Completed 3-6-81  
Initial open flow 45 M cu. ft. \_\_\_\_\_ bbls.  
Final production 500 M cu. ft. per day \_\_\_\_\_ bbls.  
Well open 4 hrs. before test 540# RP.

Casing and Tubing	Used in Drilling	Left in Well	Cement fill up Cu. ft. (Sks.)
Size 20-16			
Cond. <del>2 1/2</del> 11 3/4	15'	15'	
9 5/8			
8 5/8	810'	810'	210 Sks.
7			
5 1/2			
4 1/2	-	5148	820 Sks.
3			
2			
Liners Used			

Well treatment details:

Attach copy of cementing record.

1st Stage - 500 Gal. HCl, 150 Sks. 80/100, 300 Sks. 20/40 wi 450 B.W.  
BD --, ATP 3015, AIR 26.4 BPM, ISI 3100  
2nd Stage - 500 Gal. HCl, 150 Sks. 80/100, 300 Sks. 20/40 wi 425 B.W.  
BD 3500, ATP 2450, AIR 36.4 BPM, ISI 2200  
3rd Stage - 500 Gal. HCl, 150 Sks. 80/100, 300 Sks. 20/40 wi 385 B.W.  
BD 2700, ATP 1690, AIR 36.7, ISI 1600

Coal was encountered at \_\_\_\_\_ Feet \_\_\_\_\_ Inches  
Fresh water \_\_\_\_\_ Feet \_\_\_\_\_ Salt Water \_\_\_\_\_ Feet \_\_\_\_\_  
Producing Sand Elk, Benson, Riley, Squaw Depth See Below

Formation	Color	Hard or Soft	Top Feet	Bottom Feet	Oil, Gas or Water	* Remarks
Top Soil			0	5		
Sand and Shale			5	131		Damp @ 61'
Coal			131	137		1/2" Stream Water @ 137'
Sand and Shale			137	1204		
Little Lime			1204	1226		
Sand and Shale			1226	1257		
Big Lime			1257	1380		
Big Injun			1380	1490		
Sand and Shale			1490	2794		
Balltown			2794	2835		
Sand and Shale			2835	3840		Gas Chk. @ 3600' - No Show
Sand and Shale			3840	3865		
Sand and Shale			3865	5030		Gas Chk. @ 4008' - 45 M Gas Chk. @ 4822' - 15 M
Elk			5030			
TOTAL DEPTH				5200		Gas Chk. @ 5200' - 45 M
Well Logged By Basin Surveys						Holes 12
Initial Open Flow - 45 Mcf Per Day						Elk 5036 - 5042 12 Benson - Riley 3678 - 3682 4 3698 - 3702 4 3826 - 3830 6 Squaw 1554 - 1562 10

03/22/2024



STATE OF WEST VIRGINIA  
DEPARTMENT OF MINES  
OIL AND GAS WELLS DIVISION

INSPECTOR'S WELL REPORT

Permit No. 083-0370

Oil or Gas Well GAS  
KIND

Company	Address	Farm	Well No.	District	Drilling commenced	Drilling completed	Date shot	Initial open flow	Open flow after tubing	Volume	Stock pressure	Oil	Fresh water	Salt water	CASING AND TUBING	USED IN DRILLING	Left in Well	PACKERS
															Size	Kind of Packer	Size of	Depth set
<u>R+B Petroleum</u>	<u>Buck Hannon</u>	<u>MEADOWLARK FARMS</u>	<u># 1</u>	<u>ROARING CREEK</u> County <u>RAVENS</u>	<u>2-28-81</u>													

Drillers' Names Union Rig - 4

Remarks: Move Rig SPUD

**RECEIVED**  
MAR - 3 1981

OIL & GAS DIVISION  
DEPT. OF MINES

2-28-81  
DATE

Robert Stewart 511  
DISTRICT SUPERVISOR  
03/22/2024







STATE OF WEST VIRGINIA  
DEPARTMENT OF MINES  
OIL AND GAS WELLS DIVISION

INSPECTOR'S WELL REPORT

Permit No. 083-0370

Oil or Gas Well GAS  
(KIND)

Company	CASING AND TUBING	USED IN DRILLING	LEFT IN WELL	PACKERS
<u>R+B Petroleum</u>	Size			
Address <u>N 9</u>	16			Kind of Packer
Farm <u>MEADOWLARK FARMS</u>	13			
Well No. <u>#1</u>	10			Size of
District <u>ROARING CREEK</u> County <u>RANDOLPH</u>	8 1/4			
Drilling commenced <u>2-28-81</u>	6 5/8			Depth set
Drilling completed _____ Total depth _____	5 3/16			
Date shot _____ Depth of shot _____	3			Perf. top
Initial open flow _____ /10ths Water in _____ Inch	2			Perf. bottom
Open flow after tubing _____ /10ths Merc. in _____ Inch	Liners Used			Perf. top
Volume _____ Cu. Ft.				Perf. bottom
Rock pressure _____ lbs. _____ hrs.	CASING CEMENTED _____ SIZE _____ No. FT. _____ Date _____			
Oil _____ bbls., 1st 24 hrs.	NAME OF SERVICE COMPANY _____			
Fresh water _____ feet _____ feet	COAL WAS ENCOUNTERED AT _____ FEET _____ INCHES			
Salt water _____ feet _____ feet	_____ FEET _____ INCHES _____ FEET _____ INCHES			
	_____ FEET _____ INCHES _____ FEET _____ INCHES			

Drillers' Names \_\_\_\_\_

RECEIVED

Remarks:

O.K. To Release

NOV 3 - 1982

OIL AND GAS DIVISION  
WV DEPARTMENT OF MINES

10-30-82

DATE

Robert Stewart 54  
03/22/2024  
DISTRICT WELL INSPECTOR









State of West Virginia

Department of Mines

Oil and Gas Division

Charleston 25305

WALTER N. MILLER  
DIRECTOR

January 6, 1983

R & B Petroleum, Inc.  
123 Main Street  
White Plains, N. Y. 10601

Dear Sir:

The required records and reports have been received in this office and the District Inspectors have submitted Final Inspections for the following wells listed below:

<u>PERMIT NO.</u>	<u>FARM AND WELL NUMBER</u>	<u>DISTRICT</u>
BAR-1683-REN.	Geneva K. Ware, #1	Valley
RAN-0370	Russell O. Wilson, #1	Roaring Creek
RAN-0371	J. P. Keeley, Jr., #2	Roaring Creek
RAN-0372	J. P. Keeley, Jr., #3	Roaring Creek
RAN-0407-REN.	J. P. Keeley, Jr., #5	Roaring Creek
RAN-0694	Skidmore Heirs, #3	Roaring Creek

In accordance with Chapter 22, Article 4, Section 2, the bond coverage for above captioned wells will stay in force for life of well. Reclamation requirements have been approved.....

Very truly yours,

Theodore M. Streit

03/22/2024







PARTICIPANTS:

DATE: JUL 20 1981

BUYER-SELLER C

WELL OPERATOR: R+B Petroleum, Inc.

02303a

FIRST PURCHASER: Partnership Properties Co.

014529

OTHER: \_\_\_\_\_

W. Va. Department of Mines, Oil & Gas Division  
 WELL DETERMINATION FILE NUMBER  
81-5-27-103-083 = 0370  
 Use Above File Number on all Communications  
 Relating to Determination of this Well

~~470830254~~ 1000'  
2000

*ok - plat*  
*Qualifies F. H. Huzzey*

CHECK EACH ITEM AS COMPLETE OR NOTE WHAT IS MISSING

ITEM NO.

- 1. FERC -121 ✓ Items not completed - Line No. 7.0 b,c
- 2. IV-1 Agent ✓ John S. Bailey
- 3. IV-2 Well Permit ✓
- 4. IV-6 Well Plat ✓
- 5. IV-35 Well Record ✓ Drilling ✓ Deepening -
- 6. IV-36 Gas-Oil Test: Gas Only \_\_\_\_\_ Was Oil Produced? \_\_\_\_\_ Ratio \_\_\_\_\_
- 7. IV-39 Annual Production - years
- 8. IV-40 90 day Production - Days off line: -
- 9. IV-48 Application for certification. Complete? ✓
- 10-17. IV Form 51 - 52 - 53 - (54) - 55 - 56 - 57 - 58 Complete? ✓ Affidavit Signed ✓
- 18-28. Other: Survey \_\_\_\_\_ Logs \_\_\_\_\_ Geological Charts \_\_\_\_\_  
 Structure Map \_\_\_\_\_ 1: 4000 Map \_\_\_\_\_ Well Tabulations \_\_\_\_\_  
 Gas Analyses \_\_\_\_\_
- (5) Date commenced: 2-28-81 Date completed 3-6-81 Deepened -
- (5) Production Depth: 5036-42, 3678-3830, 1554-62
- (5) Production Formation: EIK, Benson, Riley, Squaw
- (5) Final Open Flow: 500 MCF
- (5) After Frac. R. P. 540# 4 hrs
- (6) Other Gas Test: \_\_\_\_\_
- (7) Avg. Daily Gas from Annual Production: \_\_\_\_\_
- (8) Avg. Daily Gas from 90-day ending w/1-120 days \_\_\_\_\_
- (8) Line Pressure: \_\_\_\_\_ PSIG from Daily Report \_\_\_\_\_
- (5) Oil Production: \_\_\_\_\_ From Completion Report \_\_\_\_\_
- 0-17. Does lease inventory indicate enhanced recovery being done NO
- 0-17. Is affidavit signed? ✓ Notarized? ✓ 03/22/2024
- Does official well record with the Department confirm the submitted information? yes
- Additional information \_\_\_\_\_ Does computer program confirm? \_\_\_\_\_
- Is Determination Objected to \_\_\_\_\_ By Whom? \_\_\_\_\_

5



STATE OF WEST VIRGINIA  
DEPARTMENT OF MINES, OIL AND GAS DIVISION

Date May 20, 1981

Operator's Well No. R. Wilson #1  
API Well No. 47 - 083 - 0370  
State County Permit

WELL CLASSIFICATION FORM  
NEW ONSHORE PRODUCTION WELL  
NGPA Section 103

DESIGNATED AGENT JOHN S. BAILEY, ESQ.  
ADDRESS 214 EIGHTH STREET  
PARKERSBURG, WV 26101

LOCATION: Elevation 2340'  
Watershed Hell Run of Middle Fork River  
Dist. Ro. Creek County Randolph Quad. Ellamore-7.5

Gas Purchase Contract No. NONE ASSIGNED  
Meter Chart Code NONE ASSIGNED  
Date of Contract NONE ASSIGNED

WELL OPERATOR R&B PETROLEUM, INC.  
ADDRESS 250 PARK AVENUE  
NEW YORK, NY 10177  
Partnership Properties  
GAS PURCHASER Co.  
ADDRESS 717 17th Street  
Denver, Colorado 80201

\* \* \* \* \*

Date surface drilling was begun: 2/28/81

Indicate the bottom hole pressure of the well and explain how this was calculated:

624.6 PSI

Column weight factor determined from gas compressibility factor; this factor then multiplied times depth to center of pay zone.

AFFIDAVIT

I, Helen A. Russo, having been first sworn according to law state that surface drilling of the well for which this determination is sought was begun on or after February 19, 1977; the well satisfies applicable state or federal well spacing requirements and the well is not within a proration unit, in existence at the time surface drilling began, which was applicable to the reservoir from which gas is or will be produced and which applied to any other well producing gas in commercial quantities or on which surface drilling began on or after February 19, 1977, and which was capable of producing gas in commercial quantities. I state, further, that I have concluded, to the best of my information, knowledge and belief, that the well for which this determination is sought is a new onshore production well and that I am not aware of any information not described in the application which is inconsistent with this conclusion.

Helen A. Russo T

New York  
STATE OF ~~NEW YORK~~  
COUNTY OF New York, TO WIT:

I, Julia M. Carney, a Notary Public in and for the state and county aforesaid, do certify that Helen A. Russo whose name is signed to the writing above, bearing date the 20 day of May, 1981, has acknowledged the same before me, in my county aforesaid.

Given under my hand and official seal this 20 day of May, 1981.

My term of office expires on the 30 day of March, 1983.

[NOTARIAL SEAL]

Julia M. Carney  
Notary Public

JULIA M. CARNEY  
NOTARY PUBLIC, State of New York  
03/22/2024  
Commission Expires