

STATE OF WEST VIRGINIA
DEPARTMENT OF MINES, OIL AND GAS DIVISION

OIL AND GAS WELL PERMIT APPLICATION

WELL TYPE: Oil / Gas XX /
(If "Gas", Production XX / Underground storage / Deep / Shallow XX /)

LOCATION: Elevation: 2292' Watershed: Devil Run
District: Roaring Creek County: Randolph Quadrangle: ELLAMORE

WELL OPERATOR FME Oil & Gas Properties, Inc. DESIGNATED AGENT Paul Bowles
Address Suite 305, 7030 So. Yale Address P.O. Box 1386
Tulsa, Oklahoma 74136 Charleston, W. Va. 25320

OIL & GAS ROYALTY OWNER Armand Ricottilli
Address Box 25 Star Route
Coalton, W. Va. 26257

COAL OPERATOR
Address

ACREAGE 159
SURFACE OWNER Armand Ricottilli
Address Box 25 Star Route
Coalton, W. Va. 26257
ACREAGE 159

COAL OWNER(S) WITH DECLARATION ON RECORD:
Name Armand Ricottilli
Address Box 25 Star Route
Coalton, W. Va. 26257
Name
Address

FIELD SALE (IF MADE) TO:
Name
Address

COAL LESSEE WITH DECLARATION ON RECORD:
Name
Address
RECEIVED
DEC 22 1980

OIL & GAS INSPECTOR TO BE NOTIFIED
Name Robert Stewart
Address P.O. Box 345
Jane Lew, W. Va. 26378

OIL & GAS DIVISION
DEPT. OF MINES

The undersigned well operator is entitled to operate for oil or gas purposes at the above location under a deed / lease XXX / other contract / dated 10/15, 19 79, to the undersigned well operator from Armand Ricottilli

[If said deed, lease, or other contract has been recorded:]
Recorded on Dec. 20, 19 79, in the office of the Clerk of the County Commission of Randolph County, West Virginia, in Deed Book 302 at page 480. A permit is requested as follows:

PROPOSED WORK: Drill XX / Drill deeper / Redrill / Fracture or stimulate /
Plug off old formation / Perforate new formation /
Other physical change in well (specify)

—planned as shown on the work order on the reverse side hereof.

The above named coal operator, coal owner(s), and coal lessee are hereby notified that any objection they wish to make or are required to make by Code § 22-4-3 must be filed with the Department of Mines within fifteen (15) days after the receipt of this Application by the Department.

Copies of this Permit Application and the enclosed plat and reclamation plan have been mailed by registered mail or delivered by hand to the above named coal operator, coal owner(s), and coal lessee on or before the day of the mailing or delivery of this Permit Application to the Department of Mines at Charleston, West Virginia.

PLEASE SUBMIT COPIES OF ALL GEOPHYSICAL LOGS DIRECTLY TO:
WEST VIRGINIA OIL AND GAS CONSERVATION COMMISSION
1615 WASHINGTON STREET EAST
CHARLESTON, WV 25311
TELEPHONE: (304) 348-3092

(Forment From: Partnership Properties)
FME Oil and Gas Properties, Inc.
Well Operator

By Alvin Sorenson
Its Agent

BLANKET BOND

03/22/2024

[08-78]

PROPOSED WORK ORDER

THIS IS AN ESTIMATE ONLY:
ACTUAL INFORMATION MUST BE SUBMITTED ON FORM IV-35 UPON COMPLETION

DRILLING CONTRACTOR (IF KNOWN) Unknown
Address _____

GEOLOGICAL TARGET FORMATION, Fox

Estimated depth of completed well, 5400' feet Rotary XX/ Cable tools /
Approximate water strata depths: Fresh, feet; salt, feet.
Approximate coal seam depths: Is coal being mined in the area? Yes / No XX /

CASING AND TUBING PROGRAM

CASING OR TUBING TYPE	SPECIFICATIONS				FOOTAGE INTERVALS		CEMENT FILL-UP OR SACKS (Cubic feet)	PACKERS
	Size	Grade	Weight per ft	New	Used	For drilling		
Conductor	11 3/4"			X		20'	20'	Kinds
Fresh water								
Coal								Sizes
Intermediate	8 5/8"	20#	20#	X		900'	900'	To Surface
Production	4 1/2"	10 1/2#	10 1/2#	X		5400'	5400'	375 SKS 540' Depths set
Tubing								or as reqd by rule
Liners								15.01 Perforations:
								Top Bottom

NOTE: Regulation 7.02 of the Department of Mines provides that the original and four copies of Form IV-2 must be filed with the Department, accompanied by (i) a plat in the form prescribed by Regulation 11, (ii) a bond in one of the forms prescribed by Regulation 12, or in lieu thereof the other security allowed by Code § 22-4-2, (iii) Form IV-8, "Reclamation Plan", applicable to the reclamation required by Code § 22-4-12b and Regulation 23, (iv) unless previously paid on the same well, the fee required by Code § 22-4-12a, and (v) if applicable, the consent required by Code § 22-4-8a from the owner of any water well or dwelling within 200 feet of the proposed well.

A separate Form IV-2 shall not be required for fracturing or stimulating a well where fracturing or stimulating is to be part of the work for which a permit is sought and is noted as such on the Form IV-2 filed in connection therewith.

THIS PERMIT MUST BE POSTED AT THE WELL SITE

All provisions being in accordance with Chapter 22, of the W. Va. Code, the location is hereby approved for Drilling. This permit shall expire if operations have not commenced by 8-23-81.

J. J. Muzzy
Deputy Director - Oil & Gas Division

The following waiver must be completed by the coal operator and by any coal owner or coal lessee who has recorded a declaration under Code § 22-4-20, if the permit is to be issued within fifteen (15) days of receipt thereof:

W A I V E R

The undersigned coal operator / owner XXX / lessee / of the coal under this well location has examined this proposed well location. If a mine map exists which covers the area of the well location, the well location has been added to the mine map. The undersigned has no objection to the work proposed to be done at this location, provided, the well operator has complied with all applicable requirements of the West Virginia Code and the governing regulations.

03/22/2024

Date: 12-22, 1980

By Armand Picotelli
Its _____

Well Site Plan

- | | | | | |
|----------------|------------------|--|------------|--|
| Legend: | Property Boundry | | Diversion | |
| | Road | | Spring | |
| | Existing Fence | | Wet Spot | |
| | Planned Fence | | Building | |
| | Stream | | Drain Pipe | |
| | Open Ditch | | Waterway | |

Sketch to include well location, existing access road, roads to be constructed, wellsite, drilling pits and necessary structures numbered or lettered to correspond with first part of this plan. Include all natural drainage.

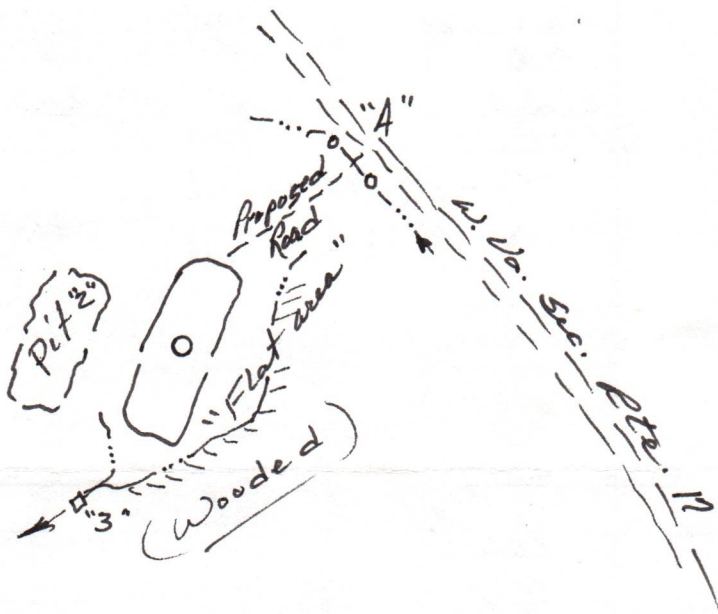

1. All Marketable Timber to be cut and Stacked.
2. All Brush to be Disposed of before earthwork begins.
3. Cut area will have 2:1 slope unless in rock
4. Drainage will be maintained after reclamation is completed.
5. Pit Location is subject to change

Comments: _____

Signature: Alvin Loren RT4 Box 444 Buckhannon 472-0007
 Agent Address Phone Number

03/22/2024

Please request landowners cooperation to protect new seeding for one growing season.



Date Dec. 18 19 80
Well No. FMF-Ricottilli #1
API No. 47 - 083 - 395
State West Virginia County Lincoln Permit 395

STATE OF WEST VIRGINIA
OFFICE OF OIL AND GAS

Company Name FMF Oil Gas Properties, Inc. Designated Agent Paul Bowles
Address Tulsa, Oklahoma 74136 Address Charleston W. Va.
Telephone 918-492-3656 Telephone 344-9621
Landowner Armand Ricottilli Soil Cons. District Tygart's Valley

Revegetation to be carried out by operator (Agent)

This plan has been reviewed by Tygart Valley SCD. All corrections and additions become a part of this plan. 12-19-80 Junior Hefrik (Date) (SCD Agent)

Access Road	Location
Structure <u>Culvert</u> (A)	Structure <u>Diversion</u> (1)
Spacing <u>12" Dia. Min.</u>	Material <u>Soil</u>
Page Ref. Manual <u>1-8</u>	Page Ref. Manual <u>1-9</u>
Structure <u>Open Ditch</u> (B)	Structure <u>Drilling Pit</u> (2)
Spacing <u>—</u>	Material <u>Soil</u>
Page Ref. Manual <u>1-11</u>	Page Ref. Manual <u>—</u>
Structure <u>—</u> (C)	Structure <u>Silt Trap</u> (3)
Spacing <u>—</u>	Material <u>Soil</u>
Page Ref. Manual <u>—</u>	Page Ref. Manual <u>—</u>

All structures should be inspected regularly and repaired if necessary.

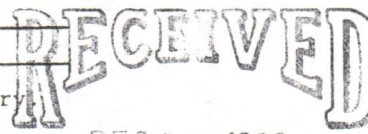

DEC 22 1980

Revegetation

Treatment Area I

Lime 3 Tons/acre
or correct to pH 6.5

Fertilizer 600 lbs/acre
(10-20-20 or equivalent)

Mulch Hay 2 Tons/Acre

Seed* Ky31 Tall Fescue 30 lbs/acre
Birdsfoot Trefoil 10 lbs/acre
Domestic Ryegrass 10 lbs/acre

Treatment Area II

Lime 3 Tons/acre
or correct to pH 6.5

Fertilizer 600 lbs/acre
(10-20-20 or equivalent)

Mulch Hay 2 Tons/Acre

Seed* Ky31 Tall Fescue 30 lbs/acre
Birdsfoot Trefoil 10 lbs/acre
Domestic Ryegrass 10 lbs/acre

OIL & GAS DIVISION
DEPT. OF MINES

*Inoculate all legumes such as vetch, trefoil and clovers with the proper bacterium. Inoculate with 3X recommended amount.

Attach or photocopy section of involved Topographic map. Quadrangle Ellamore.

Legend: Well Site
 Access Road



Formation	Color	Hard or Soft	Top Feet	Bottom Feet	Oil, Gas or Water	Remarks
Big Lime			1220	1300		
Big Injun			1300	1440		
Shale			1440	1870		
and			1870	2120		
Shale			2120	2300		
5th Sand			2300	2330		
Shale & Silt			2330	3830		
Benson			3830	3905		
Silt & Shale			3905	5005		
Haverty			5005	5065	Gas Show	
Shale			5065	5476		
T D			5476			

03/22/2024

Date Jun 13 1981

APPROVED J. H. H. H. Owner

By C. H. H. H.

Date: 5-13-81
 Operator's
 Well No. RICOTILLI # 1
 API Well No. 47-0830395

RECEIVED

JUN 25 1981
 State of West Virginia
 Department of Mines
 Oil and Gas Division
 OIL & GAS DIVISION WELL RECORD
 DEPT. OF MINES

Well Type: Oil ___ / Gas X / Liquid Injection ___ / Waste Disposal ___ /
 (If "Gas", Production X / Underground storage ___ / Deep ___ / Shallow ___ /
 Location: Elevation: 2292 Watershed Devil Run
 District: ~~Devil Run~~ Roaring Creek County: Randolph Quadrangle: Ellamore
 Well Operator FMF Oil & Gas Properties, Inc. Designated Agent Alvin Sorcan
 Address Suite 305, 7030 S Yale Address Rt. 4 Box 444
Tulsa, OK 74177 Buckhannon, W.V.

Permitted Work: Drill X / Covert ___ / Drill deeper. ___ / Redrill ___ /
 Fracture or stimulate X / Plug off old formation ___ /
 Preforate new formation ___ / Other physical change in well (specify) ___

Permit Issued on 12-22-80

Oil & Gas Inspector for This Work:
 Name: Robert Stewart
 Address: P.O. Box 345
Jane Lew, W.V.

Geological Target Formation: Haverty - Fox Depth 5400 feet
 Depth of completed well, 5476 feet Rotary X / Cable Tools ___ /
 Water strata depth: Fresh 40 feet; Salt; ___ feet.
 Coal seam depths: 463-65 Is coal being mined in the area? No
 Work was commenced 4-11-81, and completed 4-18-81

Casing and Tubing Program

Casing or Tubing Type	Specifications				Footage Intervals		Cement Fill-Up Or Sacks (cubic feet)
	Size	Grade	Weight per ft	New	Used	For drilling	
Conductor	11-3/4			X		X	
Fresh Water							
Coal							
Intermediate	8-5/8		20#	X			1084 To Surface
Production Tubing	4-1/2		10-1/2#	X			5198 640 sks. poz/
Liners							

Well Treatment details:
 FRAC: 5-1-81 PERFS: (3826-34), (4428-32), (5018-30)
 1st Stage Hav-Elk-Brkd 2200 Av.R. Av. Press. 3500 T.Fluid 480 Sand L 395
 2nd Stage Benson Non Visible 35.4 2400 425 360
 ISIP 1 1500#
 2 1000#

03/22/2024

Gas: Initial open flow, Smell Mcf/d Oil: Initial open flow, _____ Bbl/d
 Final open flow, 28/10 4" H2o888 Mcf/d Final open flow, _____ Bbl/d
 Static Rock Pressure, 1650 psig (surface measurement) after 72 hours shut in.

888,000

(Well log on reverse side)

STATE OF WEST VIRGINIA
DEPARTMENT OF MINES
OIL AND GAS WELLS DIVISION

RECEIVED

APR 10 1981

INSPECTOR'S WELL REPORT

OIL & GAS DIVISION GAS
DEPT. OF MINES

Permit No. 083-0395

Company	CASING AND TUBING	USED IN DRILLING	Left in Well	PACKERS
<u>EMF Oil & Gas</u>				
<u>Buckhannon</u>	Size			
<u>Armand Ricottilli</u>	16			Kind of Packer
<u># 1</u>	13			
<u>Roaring Creek County Randolph</u>	10			Size of
<u>4-8-81</u>	8 1/4			
	6 3/4			Depth set
	5 3/16			
	3			Perf. top
	2			Perf. bottom
	Liners Used			Perf. top
				Perf. bottom
	CASING CEMENTED	SIZE	No. FT	Date
	NAME OF SERVICE COMPANY			
	COAL WAS ENCOUNTERED AT			
	FEET	INCHES	FEET	INCHES
	FEET	INCHES	FEET	INCHES
	FEET	INCHES	FEET	INCHES

Drillers' Names Falcon Rig - 3

Remarks: Move Rig SPUD

4-8-81
DATE

Robert Stewart 511
DIRECTOR OF MINES
03/22/2024

DEPARTMENT OF MINES
OIL AND GAS WELLS DIVISION
INSPECTOR'S PLUGGING REPORT

Permit No. _____ Well No. _____
COMPANY _____ ADDRESS _____
FARM _____ DISTRICT _____ COUNTY _____

Filling Material Used _____

Liner	Location		Amount		Packer		Location		
	PLUGS USED AND DEPTH PLACED				BRIDGES		CASING AND TUBING		
CEMENT-THICKNESS	WOOD-SIZE	LEAD	CONSTRUCTION LOCATION		RECOVERED	SIZE	LOST		

Drillers' Names _____

Remarks: _____

_____ hereby certify I visited the _____ well on this date:
DATE _____ DISTRICT WELL INSPECTOR _____

03/22/2024

RECEIVED

OG-11

STATE OF WEST VIRGINIA
DEPARTMENT OF MINES
OIL AND GAS WELLS DIVISION

JUL 2 - 1982
OIL AND GAS DIVISION
WV DEPARTMENT OF MINES

INSPECTOR'S WELL REPORT

Permit No. 083-0395

Oil or Gas Well GAS
(KIND)

Company <u>ENF oil & GAS</u>	CASING AND TUBING	USED IN DRILLING	LEFT IN WELL	PACKERS
Address <u>Belington</u>	Size			
Farm <u>A Ricottilli</u>	16			Kind of Packer
Well No. <u>#1</u>	13			
District <u>Roaring Creek</u> County <u>RANDOLPH</u>	10			Size of
Drilling commenced <u>4-8-81</u>	8 1/4			
Drilling completed _____ Total depth _____	6 5/8			Depth set
Date shot _____ Depth of shot _____	5 3/16			
Initial open flow _____ /10ths Water in _____ Inch	3			Perf. top
Open flow after tubing _____ /10ths Merc. in _____ Inch	2			Perf. bottom
Volume _____ Cu. Ft.	Liners Used			Perf. top
Rock pressure _____ lbs. _____ hrs.				Perf. bottom
Oil _____ bbls., 1st 24 hrs.	CASING CEMENTED _____ SIZE _____ No. FT. _____ Date _____			
Fresh water _____ feet _____ feet	NAME OF SERVICE COMPANY _____			
Salt water _____ feet _____ feet	COAL WAS ENCOUNTERED AT _____ FEET _____ INCHES			
	_____ FEET _____ INCHES _____ FEET _____ INCHES			
	_____ FEET _____ INCHES _____ FEET _____ INCHES			

Drillers' Names _____

Remarks: O.K. TO Release

6-30-82
DATE

Robert Stewart
03/22/2024 511
DISTRICT WELL INSPECTOR

STATE OF WEST VIRGINIA
DEPARTMENT OF MINES
OIL AND GAS WELLS DIVISION
INSPECTOR'S PLUGGING REPORT

Permit No. _____ Well No. _____

COMPANY _____ ADDRESS _____

FARM _____ DISTRICT _____ COUNTY _____

Filling Material Used _____

Liner	Location	Amount	Packer	Location		
PLUGS USED AND DEPTH PLACED			BRIDGES	CASING AND TUBING		
CEMENT-THICKNESS	WOOD-SIZE	LEAD	CONSTRUCTION-LOCATION	RECOVERED	SIZE	LOST

Drillers' Names _____

Remarks: _____

DATE I hereby certify I visited the above well on this date.

03/22/2024
DISTRICT WELL INSPECTOR



State of West Virginia

Department of Mines
Oil and Gas Division

Charleston 25305

WALTER N. MILLER
DIRECTOR

THEODORE M. STREIT
ADMINISTRATOR

July 13, 1982

FMF Oil & Gas Properties
537 Springvale Road
Great Falls, Virginia 22066

Dear Sir:

The required records and reports have been received in this office and the District Inspectors have submitted Final Inspections for the following wells listed below:

<u>PERMIT NO.</u>	<u>FARM AND WELL NUMBER</u>	<u>DISTRICT</u>
083-0294	Armand Ricottilli, Armand #1, FMF-1A	Roaring Creek
083-0394	Donald & Patsy Anderson, #1	Roaring Creek
083-0395	Armand Ricottilli, #1	Roaring Creek
083-0409	Patrick Tahaney Heirs, #1	Roaring Creek
083-0431	Paul R. Flanagan, #1	Roaring Creek

In accordance with Chapter 22, Article 4, Section 2, the bond coverage for above captioned wells will stay in force for life of well. Reclamation requirements have been approved.

Very truly yours,

Theodore M. Streit

TMS:rl

03/22/2024

REC'D
NOV 17 1981
OIL & GAS DIVISION
DEPT. OF ENERGY

1.0 API well number (If not available, leave blank. 14 digits.)	47-083-0395							
2.0 Type of determination being sought (Use the codes found on the front of this form.)	102 Section of NGPA	4 Category Code						
3.0 Depth of the deepest completion location (Only needed if sections 103 or 107 in 2.0 above.)	_____ feet							
4.0 Name, address and code number of applicant (35 letters per line maximum. If code number not available, leave blank.)	FMF Oil & Gas Properties 537 Springvale Road Great Falls, Virginia 22066		Seller Code					
5.0 Location of this well. (Complete (a) or (b).) (a) For onshore wells (15 letters maximum for field name.)	Roaring Creek Randolph County		West Va. State					
(b) For OCS wells	Date of Lease Mo Day Yr		Block Number OCS Lease Number					
(c) Name and identification number of this well (35 letters and digits maximum.)	Ricotilli #1							
(d) If code 4 or 5 in 2.0 above, name of the reservoir (35 letters maximum.)	Devil Run							
6.0 (a) Name and code number of the purchaser (35 letters and digits maximum. If code number not available, leave blank.)	Columbia Gas Transmission Corp.		004030 Buyer Code					
(b) Date of the contract	Under Negotiation Mo Day Yr							
6.1 Estimated annual production	45 MMcf							
7.0 Contract price (As of filing date. Complete to 3 decimal places.)	(a) Base Price (\$/MMBTU)	(b) Tax	(c) All Other Prices (Indicate (+) or (-).)	(d) Total of (a), (b) and (c)				
8.0 Maximum lawful rate (As of filing date. Complete to 3 decimal places.)	Initial Not yet	102 or 107 in production	NGPA Pricing	---				
9.0 Person responsible for the application	Frank M. Foley		President Title					
<table border="1"> <tr> <td>Agency Use Only</td> </tr> <tr> <td>Received by Juris. Agency</td> </tr> <tr> <td>NOV 17 1981</td> </tr> <tr> <td>Received by FERC</td> </tr> </table>	Agency Use Only	Received by Juris. Agency	NOV 17 1981	Received by FERC	Sept 1, 1981 Date of Application Is Completed		703/759-4545 Phone Number	
Agency Use Only								
Received by Juris. Agency								
NOV 17 1981								
Received by FERC								

Nov 13

03/22/2024

MAR 23 1982

BUYER-

SELLER: FMF Oil + Gas Properties

NA

FIRST PURCHASER: Negotiating Columbia

004030

OTHER:

W. Va. Department of Mines, Oil & Gas Division
WELL DETERMINATION FILE NUMBER

81-11-17 - 102-083 = 0395

Use Above File Number on all Communications
Relating to Determination of this Well

The well is located
near

~~Referred for complete well record & formation structure map~~
Qualifies
J. H. Huzzey

CHECK EACH ITEM AS COMPLETE OR NOTE WHAT IS MISSING

ITEM NO.

- 1. FERC -121 Items not completed - Line No. 7.0 8.0 all
- 2. IV-1 Agent: Paul Bowles
- 3. IV-2 Well Permit _____
- 4. IV-6 Well Plat
- 5. IV-35 Well Record Drilling Deepening _____
- 6. IV-36 Gas-Oil Test: Gas Only _____ Was Oil Produced? _____ Ratio _____
- 7. IV-39 Annual Production _____ years
- 8. IV-40 90 day Production _____ Days off line: _____
- 9. IV-48 Application for certification. Complete?
- 10-17. IV Form 51 - 52 - (53) - 54 - 55 - 56 - 57 - 58 Complete? Affidavit Signed
- 18-28. Other: Survey _____ Logs _____ Geological Charts _____
Structure Map _____ 1: 4000 Map _____ Well Tabulations _____
Gas Analyses _____
- (5) Date commenced: 4-11-81 Date completed 4-18-81 Deepened _____
- (5) Production Depth: 5005 - 65
- (5) Production Formation: Haverly
- (5) Final Open Flow: 388 mcf
- (5) After Frac. R. P. 1650 # 72 hrs
- (6) Other Gas Test: _____
- (7) Avg. Daily Gas from Annual Production: _____
- (8) Avg. Daily Gas from 90-day ending w/1-120 days _____
- (8) Line Pressure: _____ PSIG from Daily Rep
- (5) Oil Production: _____ From Completion Report _____
- 10-17. Does lease inventory indicate enhanced recovery being done No
- 10-17. Is affidavit signed? Notarized?
- Does official well record with the Department confirm the submitted information? 03/22/2024
- Additional information _____ Does computer program confirm? _____
- Was Determination Objected to _____ By Whom? _____

HHH

... records not reasonably available to you... determination of eligibility? Yes ___ No X. If yes, identify such records and indicate their location, if known:

Are you aware of any other information which would tend to be inconsistent with the information specified above? Yes ___ No X. If yes, indicate the type and source of the information.

- 1) Was natural gas produced from the reservoir in commercial quantities prior to April 20, 1977? Yes ___ No X.
- 2) Was the reservoir penetrated by an old well from which oil or gas was produced in commercial quantities from any other reservoir? Yes ___ No X.
- 3) If the answer to 2) is "yes", could natural gas have been produced in commercial quantities prior to April 20, 1977 from any old well so indicated? Yes ___ No ___.
- 4) If the gas is to be produced through an old well, were suitable production and gathering facilities available on April 20, 1977? Yes ___ No ___.
- 5) If the answer to 3) or 4) is "yes", attach a separate sheet explaining why you believe the well, for which a determination is sought, can be qualified as a new onshore reservoir well and include any information which would support your conclusion.

BOTTOM HOLE PRESSURE DATA

Indicate the bottom hole pressure of the well and explain how this was calculated.

$$BHP = P_1 + P_1 (e^{GL/53.34T} - 1) \quad BHP = 1665 + 1665 (e^{(.60)(4428)/(53.34)(571)} - 1)$$

$$P_1 = 1665 \text{ PSIA} \quad G = .60$$

$$T = 571 \text{ (R)} \quad L = 4428 \quad BHP = 1815$$

AFFIDAVIT

I, Frank M. Foley, having been first sworn according to law, state that I have caused to be made a diligent search of those records hereinbefore indicated in the manner herein described, that the information contained in this document is true and accurate and that on the basis of the records and examinations hereinbefore described, and to the best of my information, knowledge and belief, the well for which this determination is sought is a well producing from a new onshore reservoir.

Frank M. Foley
President
FMF Oil & Gas Properties

STATE OF ~~WEST~~ VIRGINIA, at Large
COUNTY OF _____, TO WIT:

I, Sharon Parrott, a Notary Public in and for the state and county aforesaid, do certify that Frank M. Foley, whose name is signed to the writing above, bearing date the 1st day of Sept, 1981, has acknowledged the same before me, in my county aforesaid.

Given under my hand and official seal this 1st day of Sept, 1981.
My term of office expires on the 14 day of March, 1983.

[NOTARIAL SEAL]

Sharon Parrott
Notary Public

03/22/2024

DATE ^{Nov 13} Sept 1 1981, 19__

STATE OF WEST VIRGINIA
DEPARTMENT OF MINES, OIL AND GAS DIVISION

Operator's Well No. Ricotilli #1
API Well No: 47 - 083 - 0395
State County Permit

WELL CLASSIFICATION FORM

NEW ONSHORE RESERVOIR WELL

NGPA Section 102(c)(1)(C) Category 4

DESIGNATED AGENT Paul Bowles, Esquire
Bowles, McDavid, Graff & Love
ADDRESS Box 1386
Charleston, West Va. 25325

WELL OPERATOR FMF Oil & Gas Properties

ADDRESS 537 Springvale Road
Great Falls, Va. 22066

GAS PURCHASER Columbia Gas Transmission

ADDRESS 1700 MacCorkel Avenue
Charleston, West Va. 25314

LOCATION: Elevation 2292
Watershed Devil Run
Dist. Roaring Creek County Randolph Quad. Ellamore
Gas Purchase Contract No. Under Negotiation

Meter Chart Code _____
Date of Contract _____

* * * * *

List all records reasonably available to you which contain information relevant to a determination of eligibility (including production records, B&O Tax Records and royalty payment records) and indicate the location of such records:

The OG-10's available from the Department of Mines, Office of Oil & Gas, Charleston, West Va.

Logs of the Mary Vedonic wells.

Describe the search made of any records listed above: _____ and _____

Study of the OG-10's for date well drilled, productive sand for comparison to FMF wells.

Mary Vedonic logs used to prepare subsurface cross section to show distinctive resevoir from which FMF well is productive.

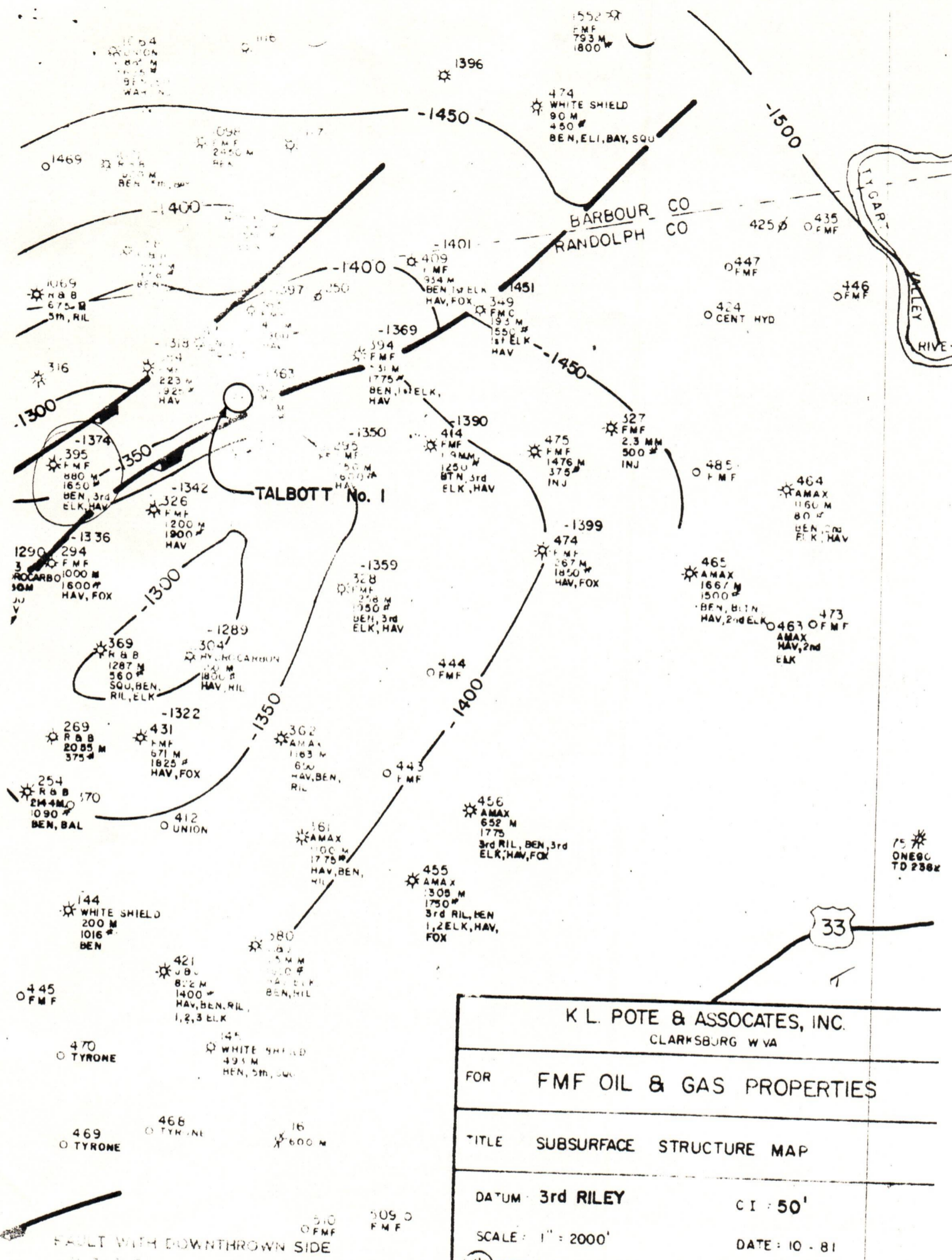

K L. POTE & ASSOCIATES, INC. CLARKSBURG W VA	
FOR FMF OIL & GAS PROPERTIES	
TITLE SUBSURFACE STRUCTURE MAP	
DATUM: 3rd RILEY	CI: 50'
SCALE: 1" = 2000'	DATE: 10 - 81
 WELL PRODUCING FROM MAPPED DATUM.	

03/22/2024