

**FRANK BALL LEASE
44 ACRES
WELL NO. 7
47-085-00206**

(UTM(M) ZONE 17 NORTH)
NAD'83 GEO. LAT-(N) 39.249357 LONG-(W) 81.065820
NAD'83 UTM (M) N. 4,344,451 E. 494,321

6,840' 4708500206 LATITUDE 39°15'00"

LONGITUDE 81°02'30"

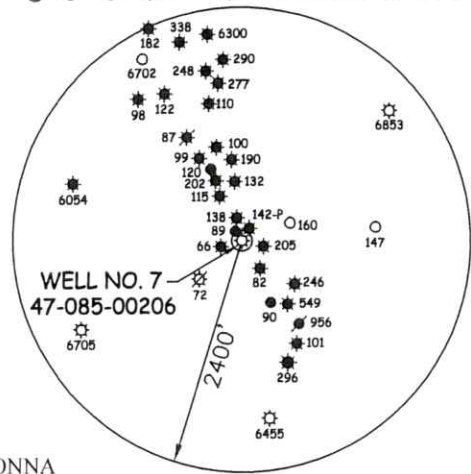

NAD'83 GRID NORTH

P/O 3-28-30.1
CHARLES W.
CUNNINGHAM
P/O 11 AC.

3-28-30.2
JACOB PAUL & DONNA
JEAN GRIFFITH
24 AC.

3-28-30
CHARLES W.
CUNNINGHAM
33 AC.

3-28-30.1
CHARLES W.
CUNNINGHAM
P/O 11 AC.

3-28-40.1
CHARLES W. &
CHARLENE
CUNNINGHAM
2.5 AC.

WELL NO. 7
47-085-00206

3-28-31.1
JACOB & DONNA
GRIFFITH
5 AC.

3-28-31.2
JACOB & DONNA
GRIFFITH
LOT

LEGEND

- LEASE LINE
- SURFACE LINE
- TIE LINE
- CREEK
- ROAD
- COUNTY ROUTE
- PROPOSED WELL
- EXISTING WELL
- PERMITTED WELL
- DISTRICT-TAXMAP-PARCEL 00-00-00

NOTES ON SURVEY

1. WELL SPOT CIRCLE & TOPO MARK SCALE IS 1"=2000'.



12 Ventnor Drive | P.O. Box 150 | Glenville, WV 26031 | 304.462.5634
1412 Kanawha Boulevard, East | Charleston, WV 25301 | 304.346.3952
254 East Beckley Bypass | Beckley, WV 25801 | 304.255.5296
slsvv.com

I THE UNDERSIGNED, HEREBY CERTIFY THAT THIS PLAT IS CORRECT TO THE BEST OF MY KNOWLEDGE AND BELIEF AND SHOWS ALL THE INFORMATION REQUIRED BY LAW AND THE REGULATIONS ISSUED AND PRESCRIBED BY THE DIVISION OF ENVIRONMENTAL PROTECTION.

P.S. 849 *Gregory A. Smith*



(+) DENOTES LOCATION OF WELL ON UNITED STATES TOPOGRAPHIC MAPS.
DATE DECEMBER 8, 20 22
REVISED _____, 20 ____
OPERATORS WELL NO. 7
API WELL NO. 47 - 085 - 00206-P
STATE COUNTY PERMIT

MINIMUM DEGREE OF ACCURACY 1 / 2500 FILE NO. 9301-SURV-WELL-08500206-MT-R00-221209.dwg
HORIZONTAL & VERTICAL CONTROL DETERMINED BY DGPS (SUBMETER MAPPING GRADE TIE TO CORS NETWORK) SCALE 1" = 100'

STATE OF WEST VIRGINIA
DIVISION OF ENVIRONMENTAL PROTECTION
OFFICE OF OIL AND GAS



WELL TYPE: OIL _____ GAS X LIQUID INJECTION _____ WASTE DISPOSAL _____ IF "GAS" PRODUCTION _____ STORAGE _____ DEEP _____ SHALLOW X

LOCATION:
ELEVATION 985' WATERSHED TRIBUTARY OF LOST RUN OF NORTH FORK HUGHES RIVER
DISTRICT CLAY COUNTY RITCHIE QUADRANGLE HARRISVILLE 7.5'

SURFACE OWNER CHARLES W. CUNNINGHAM ACREAGE 11±
ROYALTY OWNER ANDREW WIGNER HEIRS OR ASSIGNS ACREAGE 44±

PROPOSED WORK:
DRILL _____ CONVERT _____ DRILL DEEPER _____ REDRILL _____ FRACTURE OR STIMULATE _____ PLUG OFF OLD FORMATION _____ PERFORATE NEW FORMATION _____ PLUG AND ABANDON X CLEAN OUT AND REPLUG _____ OTHER _____
PHYSICAL CHANGE IN WELL (SPECIFY) _____ TARGET FORMATION INJUN
ESTIMATED DEPTH 1969'

WELL OPERATOR UNKNOWN WVDEP PAID PLUGGING CONTRACT DESIGNATED AGENT JASON HARMON, WVDEP
ADDRESS 601 57TH STREET ADDRESS 601 57TH STREET
CHARLESTON, WV 25304 (WVDEP) CHARLESTON, WV 25304

01/06/2023

COUNTY NO. PERMIT

FRANK BALL LEASE 47-085-00206

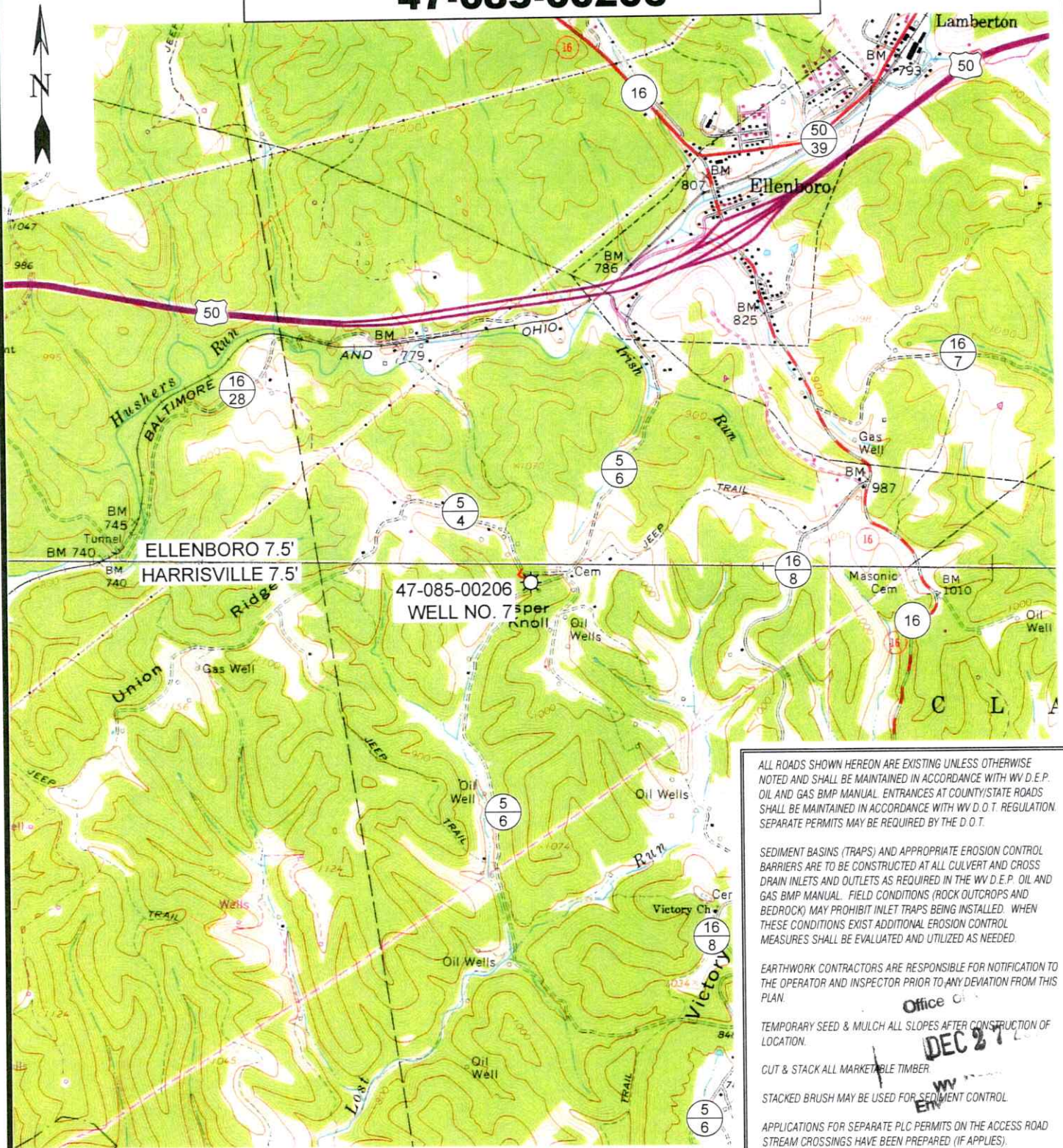

ALL ROADS SHOWN HEREON ARE EXISTING UNLESS OTHERWISE NOTED AND SHALL BE MAINTAINED IN ACCORDANCE WITH WV D.E.P. OIL AND GAS BMP MANUAL. ENTRANCES AT COUNTY/STATE ROADS SHALL BE MAINTAINED IN ACCORDANCE WITH WV D.O.T. REGULATION. SEPARATE PERMITS MAY BE REQUIRED BY THE D.O.T.

SEDIMENT BASINS (TRAPS) AND APPROPRIATE EROSION CONTROL BARRIERS ARE TO BE CONSTRUCTED AT ALL CULVERT AND CROSS DRAIN INLETS AND OUTLETS AS REQUIRED IN THE WV D.E.P. OIL AND GAS BMP MANUAL. FIELD CONDITIONS (ROCK OUTCROPS AND BEDROCK) MAY PROHIBIT INLET TRAPS BEING INSTALLED. WHEN THESE CONDITIONS EXIST ADDITIONAL EROSION CONTROL MEASURES SHALL BE EVALUATED AND UTILIZED AS NEEDED.

EARTHWORK CONTRACTORS ARE RESPONSIBLE FOR NOTIFICATION TO THE OPERATOR AND INSPECTOR PRIOR TO ANY DEVIATION FROM THIS PLAN.

Office
DEC 27
 WV
 EN

TEMPORARY SEED & MULCH ALL SLOPES AFTER CONSTRUCTION OF LOCATION.

CUT & STACK ALL MARKETABLE TIMBER

STACKED BRUSH MAY BE USED FOR SEDIMENT CONTROL

APPLICATIONS FOR SEPARATE PLC PERMITS ON THE ACCESS ROAD STREAM CROSSINGS HAVE BEEN PREPARED (IF APPLIES).

- = EXISTING CULVERT
- = PROPOSED CULVERT 15' MIN. UNLESS OTHERWISE NOTED
- = PROPOSED STREAM CROSSING
- = APPROXIMATE LIMITS OF DISTURBANCE



12 Vanhorn Drive | P.O. Box 150 | Glenview, WV 26351 | 304.462.5654
 1412 Kanawha Boulevard, East | Charleston, WV 25301 | 304.346.3952
 254 East Beckley Bypass | Beckley, WV 25801 | 304.255.5296
www.sls.com

SCALE: 1"=2000'

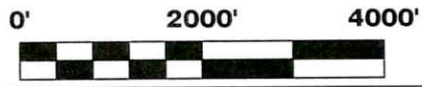

**TOPO SECTION OF HARRISVILLE, WV
7.5' TOPO QUADRANGLE**

DRAWN BY JDR	FILE NO. 9301	DATE 12-12-22	CADD FILE: 9301-SURV-REC-000-JDR-221212.DWG
------------------------	-------------------------	-------------------------	---