

47 085 00659

TH: 5220' LAT: 39-17-30

Joe Parks #23
West Virginia Department of Environmental Protection

Joe Parks #23 coordinates are
NAD 83 N: 285,412.52 E: 1,479,884.95
NAD 83 Lat: 39.270712 Long: -81.226772
NAD 83 UTM N: 4,346,842.97 E: 480,438.45
West Virginia Coordinate system of 1983 (North Zone)
based upon Differential GPS Measurements.
Plat orientation, corner and well ties are based upon
the grid north meridian.
Well location references are based upon the grid north
meridian.
UTM coordinates are NAD83, Zone 17, Meters.

GRID NORTH

TH: 7633' LON: 81-12-30

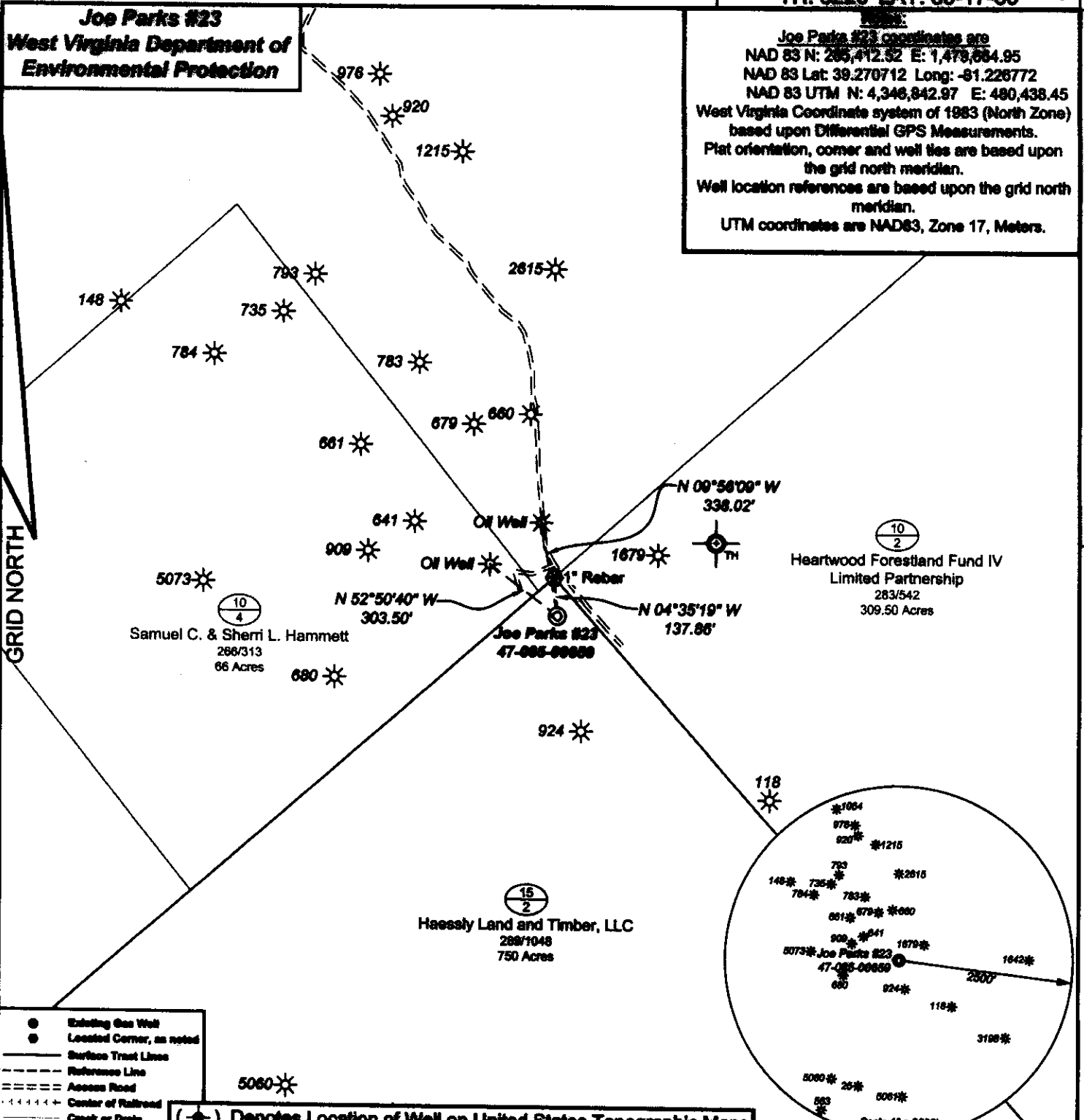

- Existing Gas Well
- Located Corner, as noted
- Surface Tract Lines
- - - Reference Line
- ==== Access Road
- ++++ Center of Railroad
- ~~~~~ Creek or Drain

(O) Denotes Location of Well on United States Topographic Maps

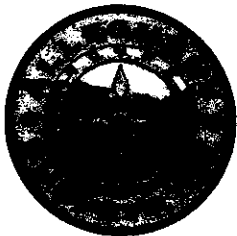

I, the undersigned, hereby certify that this plat is correct to the best of my knowledge and belief and shows all the information required by law and the regulations issued and prescribed by the Department of Environmental Protection.

[Signature]
P.S. 2092

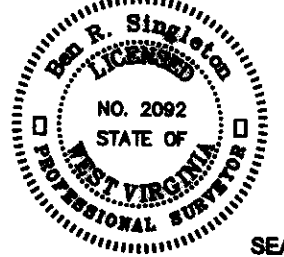

SEAL

FILE NO: 42-23
DRAWING NO: Joe Parks #23
SCALE: 1" = 500'
MINIMUM DEGREE OF ACCURACY: 1:2500
PROVEN SOURCE OF ELEVATION: NGS CORS Station

STATE OF WEST VIRGINIA
DEPARTMENT OF ENVIRONMENTAL PROTECTION
OIL AND GAS DIVISION

DATE: March 06 20 23
OPERATOR'S WELL NO.: Joe Parks #23
API WELL NO
47 - 085 - 00659
STATE COUNTY PERMIT

WELL TYPE: OIL GAS LIQUID INJECTION WASTE DISPOSAL
(IF GAS) PRODUCTION: STORAGE DEEP SHALLOW
LOCATION: ELEVATION: 936' WATERSHED Nuttall Fork QUADRANGLE: Schultz
DISTRICT: Grant COUNTY: Ritchie 05/11/2023
SURFACE OWNER: Haessly Land and Timber, LLC ACREAGE: 750
ROYALTY OWNER: LEASE NO: ACREAGE:
PROPOSED WORK: DRILL CONVERT DRILL DEEPER FRACTURE OR STIMULATE PLUG OFF OLD FORMATION
 PERFORATE NEW FORMATION OTHER PHYSICAL CHANGE IN WELL (SPECIFY)
 PLUG AND ABANDON CLEAN OUT AND REPLUG TARGET FORMATION: Unknown ESTIMATED DEPTH: Unknown

WELL OPERATOR: Unknown - DEP Paid Plugging Contract WVDEP DESIGNATED AGENT: H. Jason Harmon
ADDRESS: 601 57th Street ADDRESS: 601 57th Street
Charleston, WV 25304 Charleston, WV 25304

WW-9

EG23023 (47-085-00659)

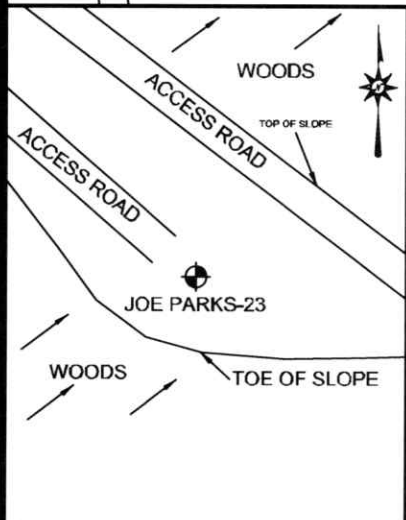
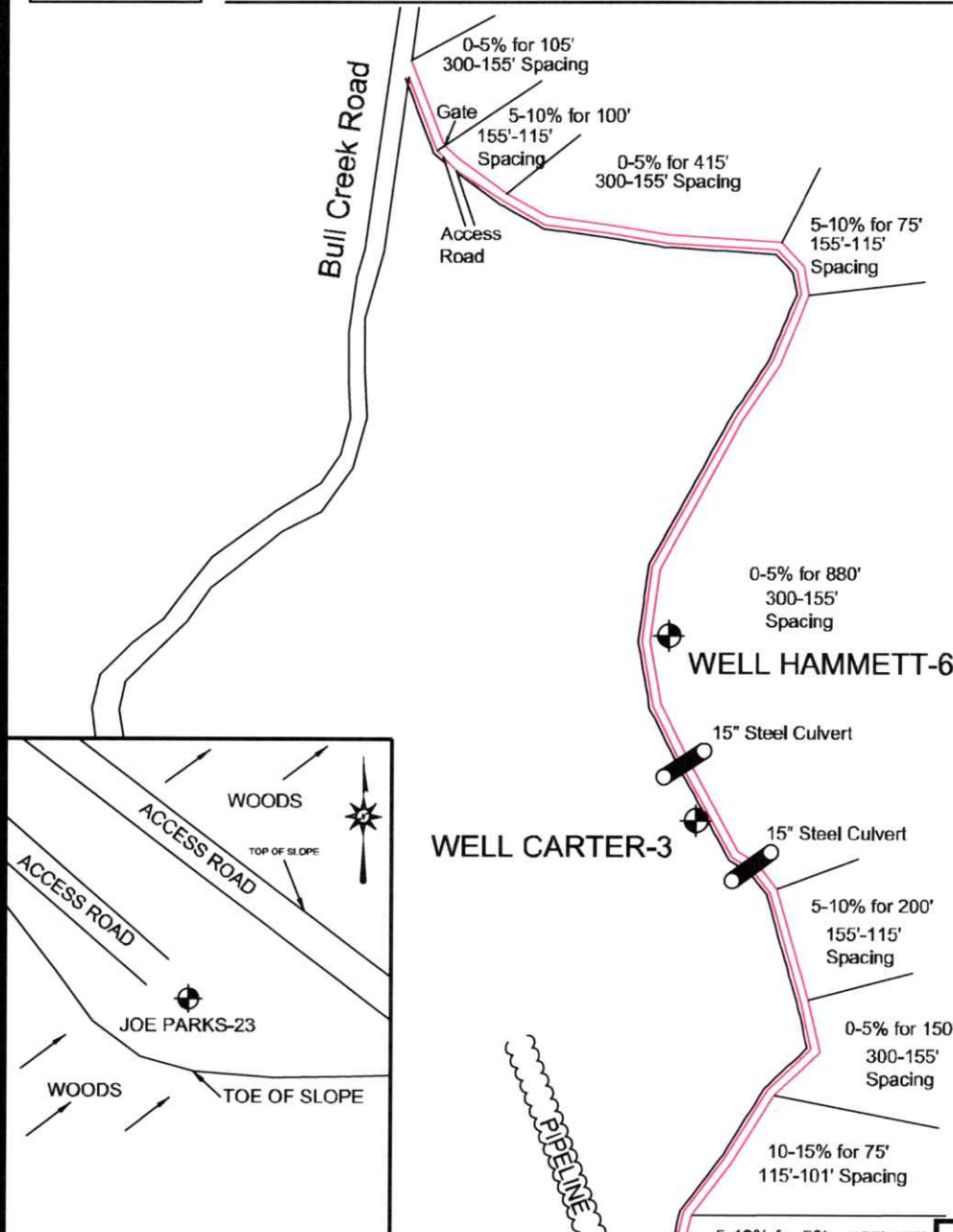

RECEIVED
Office Of Oil and Gas
APR 12 2023
WV Department of
Environmental Protection

Unless otherwise noted, all roads shown hereon are existing and shall be maintained in accordance with WV D.E.P., Office of Oil and Gas Erosion and Sediment Control Field Manual as revised 5/2017. Entrances upon county/state roads shall be maintained in accordance with WV D.O.T. regulations, however, separate permits may be required by the WV D.O.T.

Sediment basins (traps) and appropriate erosion control barriers are to be constructed at all culverts and cross-drains as required in the aforementioned Erosion and Sediment Control Field Manual. Where field conditions dictate, alternative erosion control measures shall be enacted as required.

Earthwork contractors are responsible for notification to the operator and inspector prior to any deviation from this plan.

DRAWN BY: Mason Thomas

DATE: March 6, 2023

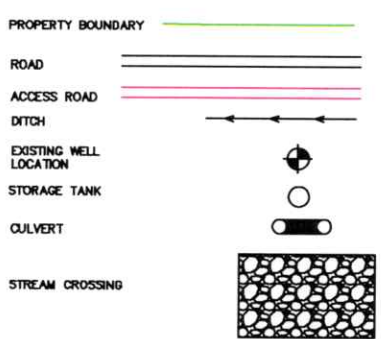

SURVEYING AND MAPPING SERVICES PERFORMED BY:
ALLEGHENY SURVEYS, INC.
1-800-482-8606
P.O. BOX 438
BIRCH RIVER, WV 26610
PH: (304) 649-8606
FAX: (304) 649-8608

WW-9

EG23023 (47-085-00659)

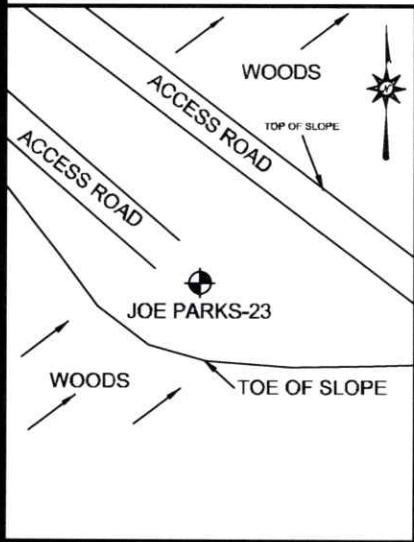
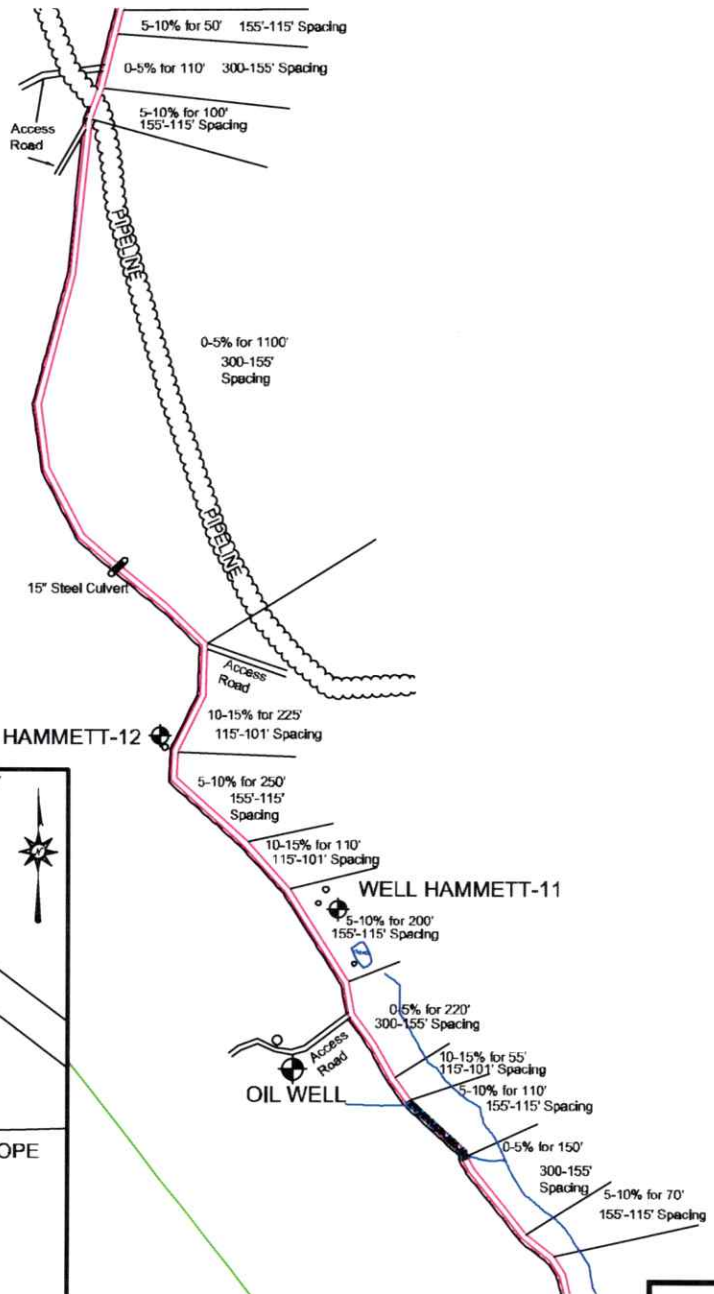

RECEIVED
 Office Of Oil and Gas
 APR 12 2023
 WV Department of
 Environmental Protection

Unless otherwise noted, all roads shown hereon are existing and shall be maintained in accordance with WV D.E.P., Office of Oil and Gas Erosion and Sediment Control Field Manual as revised 5/2012. Entrances upon county/state roads shall be maintained in accordance with WV D.O.T. regulations, however, separate permits may be required by the WV D.O.T.

Sediment basins (traps) and appropriate erosion control barriers are to be constructed at all culverts and cross-drains as required in the aforementioned Erosion and Sediment Control Field Manual. Where field conditions dictate, alternative erosion control measures shall be enacted as required.

Earthwork contractors are responsible for notification to the operator and inspector prior to any deviation from this plan.

DRAWN BY: Mason Thomas

DATE: March 6, 2023

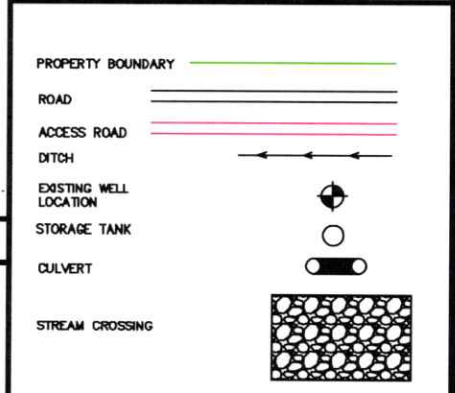

SURVEYING AND MAPPING SERVICES PERFORMED BY:
ALLEGHENY SURVEYS, INC.

1-800-482-8606
 P.O. BOX 438
 BIRCH RIVER, WV 26610
 PH: (304) 649-8606
 FAX: (304) 649-8608

05/11/2023

WW-9

EG23023 (47-085-00659)

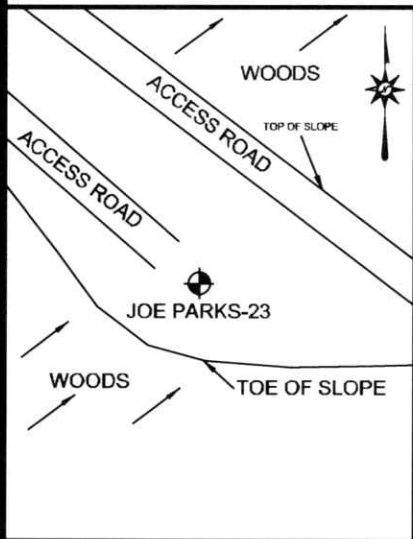
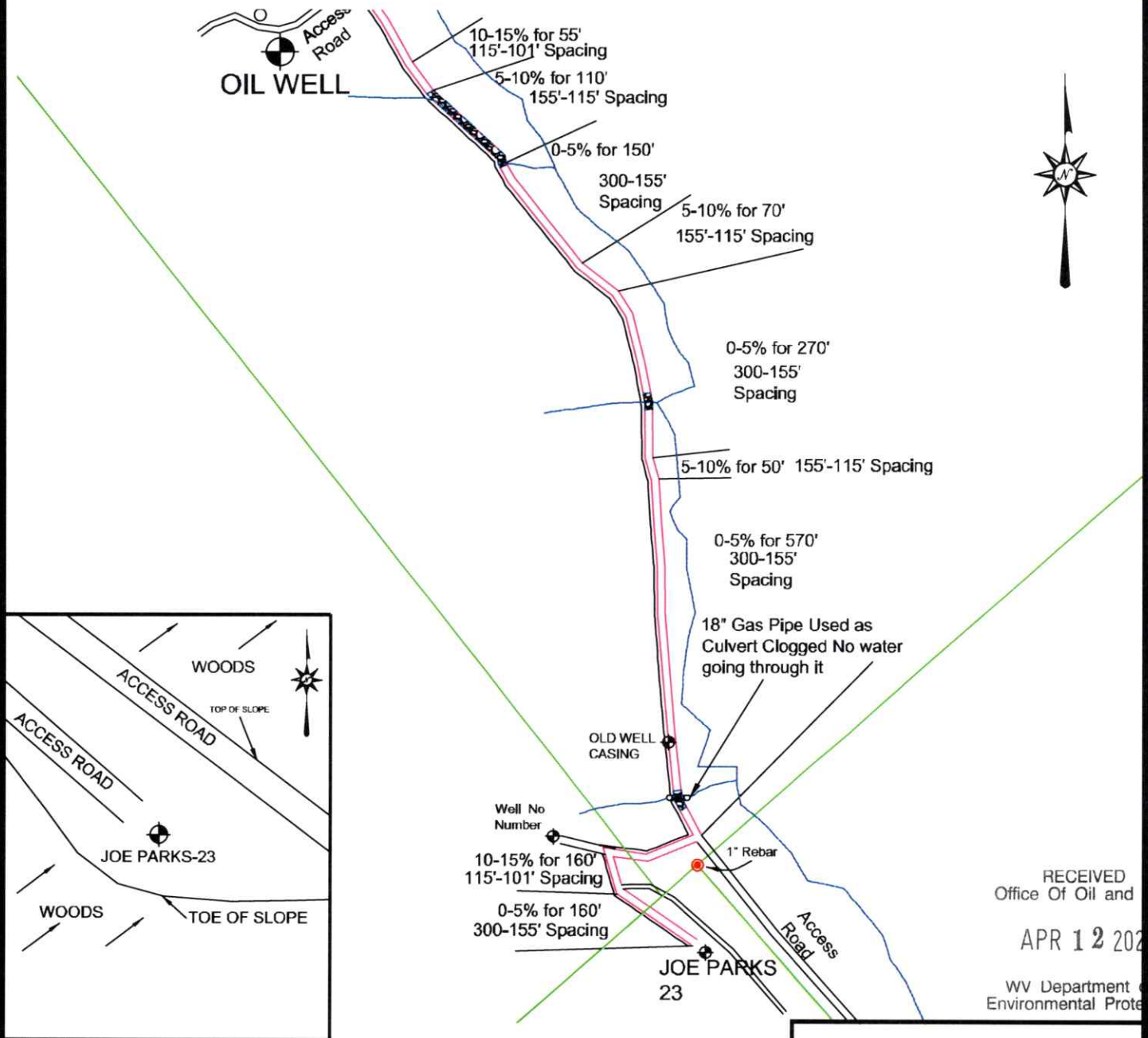

RECEIVED
Office Of Oil and Gas
APR 12 2023
WV Department of
Environmental Protection

Unless otherwise noted, all roads shown hereon are existing and shall be maintained in accordance with WV D.E.P., Office of Oil and Gas Erosion and Sediment Control Field Manual as revised 5/2012

Entrances upon county/state roads shall be maintained in accordance with WV D.O.T. regulations, however, separate permits may be required by the WV D.O.T.

Sediment basins (traps) and appropriate erosion control barriers are to be constructed at all culverts and cross-drains as required in the aforementioned Erosion and Sediment Control Field Manual. Where field conditions dictate, alternative erosion control measures shall be enacted as required.

Earthwork contractors are responsible for notification to the operator and inspector prior to any deviation from this plan.

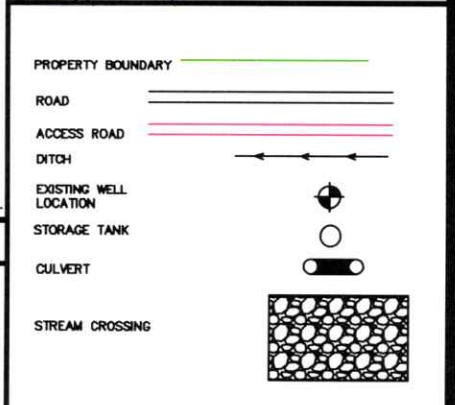

DRAWN BY: Mason Thomas

DATE: March 6, 2023



SURVEYING AND MAPPING SERVICES PERFORMED BY:
ALLEGHENY SURVEYS, INC.
1-800-482-8606
P.O. BOX 438
BIRCH RIVER, WV 26610
PH: (304) 649-8606
FAX: (304) 649-8608

05/11/2023