



STATE OF WEST VIRGINIA  
DEPARTMENT OF MINES  
OIL AND GAS DIVISION

NOTICE OF PROPOSED LOCATION OF OIL AND GAS WELL

To THE DEPARTMENT OF MINES,  
Charleston, W. Va.

coal  
COAL OPERATOR OR COAL OWNER

Alice Vandergift Earl Hardman agent  
NAME OF WELL OPERATOR

Smithville W.V.  
COMPLETE ADDRESS

Jan 24, 1958  
PROPOSED LOCATION

Grant Murphy District  
Ritchie County

Well No. 1 Lat. 39° 10' Lon. 81° 00' Elev. 1053

Henry Elliott Farm  
(now I.N. Elliott)

GENTLEMEN:

The undersigned well operator is entitled to drill upon the above named farm or tract of land for oil and gas, having fee title thereto, (or as the case may be) under grant or lease dated Aug 28, 1953, made by I.N. Elliott, to Earl Hardman, and recorded on the \_\_\_\_\_ day of \_\_\_\_\_, in the office of the County Clerk for said County in Book \_\_\_\_\_, page \_\_\_\_\_.

The enclosed plat was prepared by a competent engineer and shows the proposed location of a well to be drilled for oil and gas by the undersigned well operator on the farm and in the Magisterial District and County above named, determined by survey and courses and distances from two permanent points, or land marks.

The undersigned well operator is informed and believes there are no coal operators operating beds of coal beneath said farm or tract of land on which said well is located, or within 500 feet of the boundaries of the same, who have mapped their workings and filed their maps as required by law, excepting the coal operators or coal owners (if any) above named as addressees.

The above named coal operators or coal owners (if any) are notified that any objections they may desire to make to such proposed location, or which they are required to make by Section 3 of said Code, if the drilling of a well at said proposed location will cause a dangerous condition in or about their respective coal mines, must be received by, or filed with the Department of Mines within ten\* days from the receipt of a copy of this notice and accompanying plat by said Department. Said coal operators are further notified that forms for use in making such objections will be furnished to them by the Department of Mines promptly on request and that all such objections must set forth as definitely as is reasonably possible the ground or grounds on which such objections are based and indicate the direction and distance the proposed location should be moved to overcome same.

(The next paragraph is to be completed only in Department's copy.)

Copies of this notice and the enclosed plat were mailed by registered mail, or delivered to the above named coal operators or coal owners at their above shown respective address \_\_\_\_\_ day \_\_\_\_\_ before, or on the same day with the mailing or delivery of this copy to the Department of Mines at Charleston, West Virginia.

Very truly yours,

Earl Hardman agent  
WELL OPERATOR

Smithville W.V.  
STREET

Smithville  
CITY OR TOWN

W.V.  
STATE

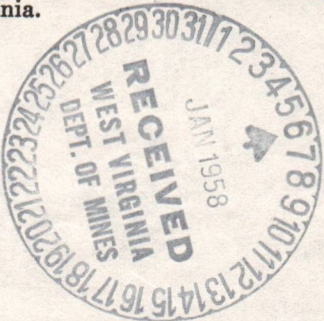

Address of Well Operator }

05/10/2024

\*Section 3 . . . . If no such objections be filed or be found by the department of mines, within said period of ten days from the receipt of said notice and plat by the department of mines, to said proposed location, the department shall forthwith issue to the well operator a drilling permit reciting the filing of such plat, that no objections have been made by the coal operators to the location, or found thereto by the department, and that the same is approved and the well operator authorized to proceed to drill at said location.

1844

RIT-1844 PERMIT NUMBER

1844-D  
Issued 8-20-62

RECEIVED

FEB 4 1975

OIL & GAS DIVISION  
DEPT. OF MINES

ASSIGNMENT

KNOW ALL MEN BY THESE PRESENTS: That the Undersigned, being one of the owners of the hereinafter described leasehold estate and trustee for the below list of all other owners, for and in consideration of the sum of Ten Dollars (\$10.00), cash in hand paid, and other good and valuable considerations: The receipt of which is hereby acknowledged, do hereby assign, set over and convey unto Global Petroleum Investment, Inc., all of the right, title and interest in and to the following described lease and lease-hold estate thereby created, as well as the oil and gas well situate thereon, and all personal property thereunto appurtenant, situate in Ritchie County, West Virginia, and more particularly described as follows:

That certain lease for oil and gas purposes, containing Twenty Six and one quarter ( 26 1/4 ) acres, more or less, situate in Murphy District, Ritchie County, West Virginia, and which was acquired by Earl Hardman from O.N. Elliott, et al and recorded in Deed Book No. 85 at page 38: of record in the County Court of Ritchie County, West Virginia, dated the 28th. day of August, 1956, and also being the same lease reassigned by Earl Hardman, by Agreement, dated January 30th., 1958, recorded in Lease Book No. 87, at page 196, of record in the County Court of Ritchie County, West Virginia, to Alice M. Vandergrift.

Witness the following signatures and seal on this the 23rd. day of March, 1974.

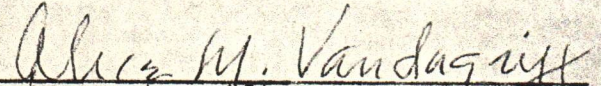
  
Alice M. Vandergrift, Attorney & Trustee

List of shareholders in Mercury Oil and Gas Well #1.

- |                   |                               |
|-------------------|-------------------------------|
| E.S. Vaughan      | Phyllis Thomas                |
| G.A. Campbell     | Victor A. Smith               |
| John W. Straton   | James V. Stanley              |
| Harry F. Bell     | George, Therese & David Rauch |
| Mrs. J.W. Bailey  | Rupert S. Eaves               |
| P.E. Heskins      | R.F. Stevens                  |
| J.N. Bailey       | Ralph Mangum                  |
| Julia L. Craddock | M.D. Haney, Jr.               |
| Annette P. Smiley | Walter W. Baker               |
| Harold L. Born    | Charles E. Summers            |
| Eugene Thomas     |                               |
| D.C. Vickery      |                               |
| Christie Haney    |                               |

Sworn to and subscribed before me this 14 day of JUNE, 1974.

STATE OF WEST VIRGINIA

COUNTY OF Wood to wit:

I, Charles Joseph Will, a Notary Public, within and for said County and State, do hereby certify that Alice M. Vandergrift, who signed the writing above, has this day and in my said County, before me, acknowledged the said writing to be her lawful signature.

  
Notary Public

05/10/2024

My Commission expires on 7<sup>th</sup> day of JAN, 1981.

8-10  
August 15, 1962

State of West Virginia  
Department of Mines  
Oil and Gas Division  
Charleston, West Virginia

Dear Mrs. Griffith:

I would like to apply to permit to deepen Mercury Oil and Gas well # 1, E.N. Elliott lease, Murphy District, Ritchie county, West Virginia, Permit No. RIT-1844 to the Berea sand. Please mail deepening permit, if approved, to me: 1113 Powers Run Road, Pittsburgh 38, Pa.

Sincerely Yours,

*Alice M. Vandergrift*

Alice M. Vandergrift  
1113 Powers Run Road  
Pittsburgh 38, Pa.

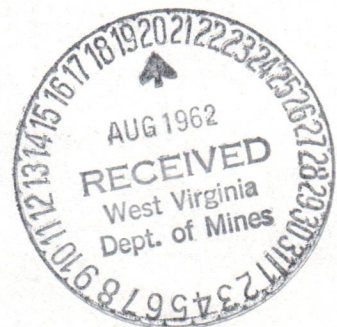

05/10/2024

AM  
February 28, 1963

Mrs Alice M. Vandergrift  
1113 Powers Run Road  
Pittsburgh 38, Pennsylvania

In Re: Rit-1844-D; Henry Elliott  
and I. N. Elliott Tract,  
Murphy District, Ritchie  
County.

Dear Alice;

In August 1962 we issued the deepening Permit for the well described above. And in March of 1963 you requested us to cancel the permit. Evidently, in a telephone conversation you asked us to reinstate deepening permit which we did on June 21, 1963. Was the deepening completed? If so, will you file the usual record on the enclosed forms?

I hope you are still in Palm Beach because the weather here is frightful by our standards. It has been a persistently nasty season.

Very truly yours,

Executive Secretary  
OIL AND GAS DIVISION

MEG/dd

05/10/2024



STATE OF WEST VIRGINIA  
DEPARTMENT OF MINES  
OIL AND GAS DIVISION

Quadrangle Harrisville

Gas-oil

Permit No. RIT-1844

WELL RECORD

Oil or Gas Well Both  
(KIND)

Company Mercury Oil and Gas  
 Address 446 Austin Ave., Pittsburgh, Pa.  
 Farm I. N. Elliott, Et Al Acres 26 1/4  
 Location (waters) Long Run  
 Well No. 1 Elev. 1053'  
 District Murphy County Ritchie  
 The surface of tract is owned in fee by I.N.Elliott  
 Address Washburn, W.Va.  
 Mineral rights are owned by \_\_\_\_\_  
 Address \_\_\_\_\_  
 Drilling commenced February 19, 1958  
 Drilling completed March 17, 1958  
 Date Shot 3/24/58 From \_\_\_\_\_ To \_\_\_\_\_  
 With Hydrafractured with oil.  
 Open Flow 8 /10ths Water in \_\_\_\_\_ Inch  
8 /10ths Merc. in two (2) Inch  
 Volume 4000 BEFORE after fracture Cu. Ft.  
 Rock Pressure 400 lbs. 18 hrs.  
 Oil \_\_\_\_\_ bbls., 1st 24 hrs.  
 Fresh water \_\_\_\_\_ feet \_\_\_\_\_ feet  
 Salt water \_\_\_\_\_ feet \_\_\_\_\_ feet

Casing and Tubing	Used in Drilling	Left in Well	Packers
Size			
16			Kind of Packer _____
13			Fracture packer _____
10	<u>423'</u>	<u>pulled</u>	Size of _____
8 1/4	<u>1214'</u>	<u>pulled</u>	Depth set <u>2080'</u>
6 3/8	<u>2068'</u>	<u>Left</u>	
5 3/16			
3			Perf. top _____
2	<u>2138'</u>	<u>Left</u>	Perf. bottom _____
Liners Used			Perf. top _____
			Perf. bottom _____

CASING CEMENTED No SIZE \_\_\_\_\_ No. Ft. \_\_\_\_\_ Date \_\_\_\_\_  
 No Coal  
 COAL WAS ENCOUNTERED AT \_\_\_\_\_ FEET \_\_\_\_\_ INCHES  
 \_\_\_\_\_ FEET \_\_\_\_\_ INCHES FEET \_\_\_\_\_ INCHES  
 \_\_\_\_\_ FEET \_\_\_\_\_ INCHES FEET \_\_\_\_\_ INCHES

Formation	Color	Hard or Soft	Top	Bottom	Oil, Gas or Water	Depth Found	Remarks
Clay			0	16			
Red Rock			16	25			
Broken sand			25	65			
Rock & Shells			65	80			
Sand			80	109			
Slate & Shells			109	235			
Lime			235	251			
Sand			251	270			
Slate & Shells			270	295			
Lime			295	312			
Red Rock			312	320			
Slate & Shells			320	331			
Sand			331	357			
Slate & Shells			357	463			
Red Rock			463	492			
Sand			492	545			
Slate & Shells			545	580			
Sand			580	635			
Slate & Shells			635	665			
Red Rock			665	675			
Lime			675	690			
Sand			690	723			
Slate & Shells			723	815			
Red Rock			815	835			
Slate & Shells			835	855			
Sand			855	880			
Red Rock			880	905			
Slate & Shells			905	927			
Red Rock			927	949			
Lime			949	961			
Red Rock			961	982			
Sand			982	1025			
Red Rock			1025	1075			
Lime & Slate			1075	1125			
Pink Rock			1125	1147			
Lime			1147	1162			

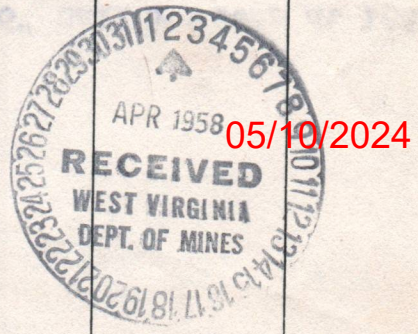

APPROVED \_\_\_\_\_  
 By Alvin M. Vandenberg, agent (Title)  
 Owner \_\_\_\_\_  
 Date March 25 1958  
 Mercury Oil and Gas

Formation	Color	Hard or Soft	Top ↓	Bottom	Oil, Gas or Water	Depth Found	Remarks
Plate & shells			1162	1195			
Pink Rock			1195	1207			
Plate & shells			1207	1250			
Lime			1250	1285			
sand			1285	1349			
Plate & shells			1349	1429			
sand			1429	1460			
Plate & shells			1460	1560			
sand			1560	1584			
Black slate			1584	1591			
sand			1591	1705			
Plate & shells			1705	1841			
Lime			1841	1856			
Plate & shells			1856	1879			
Lime			1879	1890			
Plate		Hard	1890	1894			show of oil 1915' and water
Lime		Hard	1894	1900			3-6" Batters per hr.
Maxon sand			1900	1932			
Broken lime			1932	1977			
Lime			1977	1983			
Plate			1983	1988			
Big Lime			1988	2068			
Top Injun sand			2068	2091			Gas 2039-2097
Injun sand		Hard	2091	2097			
Injun sand		Hard	2097	2117			Gas and show of oil
squaw sand			2117	2128			
Plate			2128	2138			Total depth

05/10/2024



STATE OF WEST VIRGINIA  
DEPARTMENT OF MINES  
OIL AND GAS DIVISION

Drill Deeper *Harrisville*  
Quadrangle *Harrisville*  
Permit No. **4202/01/50**

WELL RECORD

- Rotary
- Spudder
- Cable Tools
- Storage

(KIND)

Company **Mercury Oil and Gas**  
Address **1113 Powers Run Road, Pittsburgh, Pa.**  
Farm **I.N. Elliott** Acres **25**  
Location (waters) **Long Run**  
Well No. **1**  
District **Murphy** County **Ritchie**  
Elev. **I.N. Elliott**  
The surface of tract is owned in fee by **I.N. Elliott**  
Address **Washburn, W.Va.**  
Mineral rights are owned by \_\_\_\_\_  
Address \_\_\_\_\_  
Drilling commenced **September 28, 1963**  
Drilling completed **October 18, 1963**  
Date Shot **Not Shot** From \_\_\_\_\_ To \_\_\_\_\_  
With \_\_\_\_\_  
Open Flow \_\_\_\_\_ /10ths Water in **Dry Hole** Inch \_\_\_\_\_  
Volume \_\_\_\_\_ Cu. Ft. \_\_\_\_\_  
Rock Pressure \_\_\_\_\_ lbs. \_\_\_\_\_ hrs. \_\_\_\_\_  
Oil \_\_\_\_\_ bbls., 1st 24 hrs. \_\_\_\_\_  
WELL ACIDIZED \_\_\_\_\_  
WELL FRACTURED \_\_\_\_\_

RESULT AFTER TREATMENT \_\_\_\_\_  
ROCK PRESSURE AFTER TREATMENT \_\_\_\_\_  
Fresh Water \_\_\_\_\_ No. \_\_\_\_\_ Feet \_\_\_\_\_  
Salt Water \_\_\_\_\_ No. \_\_\_\_\_ Feet \_\_\_\_\_

Formation	Color	Hard or Soft	Top	Bottom	Oil, Gas or Water	Depth	Remarks
Big Injun State Lime & Shell			2122	2155			
			2155	2489'			
							Set bridge back to 2150' and producing from Big Injun formation, as per previous record on file.
							Total depth. Dry Hole

(over)





STATE OF WEST VIRGINIA  
DEPARTMENT OF MINES  
OIL AND GAS DIVISION

11

INSPECTOR'S WELL REPORT

Permit No. Rit-1844

Oil or Gas Well \_\_\_\_\_  
(KIND)

% Earl Hardman  
 Company Alice Vandergrift  
 Address Smithville, W.Va.  
 Farm I.N. Elliott  
 Well No. 1  
 District Murphy County Ritchie  
 Drilling commenced Feb. 5. 1958  
 Drilling completed \_\_\_\_\_ Total depth \_\_\_\_\_  
 Date shot \_\_\_\_\_ Depth of shot \_\_\_\_\_  
 Initial open flow \_\_\_\_\_ /10ths Water in \_\_\_\_\_ Inch  
 Open flow after tubing \_\_\_\_\_ /10ths Merc. in \_\_\_\_\_ Inch  
 Volume \_\_\_\_\_ Cu. Ft.  
 Rock pressure \_\_\_\_\_ lbs. \_\_\_\_\_ hrs.  
 Oil \_\_\_\_\_ bbls., 1st 24 hrs.  
 Fresh water None feet \_\_\_\_\_ feet  
 Salt water \_\_\_\_\_ feet \_\_\_\_\_ feet

CASING AND TUBING	USED IN DRILLING	LEFT IN WELL	PACKERS
Size			Kind of Packer
16			
13			
10	410'		Size of
8 1/4			
6 5/8	1220'		Depth set
5 3/16			
3			Perf. top
2			Perf. bottom
Liners Used			Perf. top
			Perf. bottom

CASING CEMENTED \_\_\_\_\_ SIZE \_\_\_\_\_ No. FT. \_\_\_\_\_ Date \_\_\_\_\_  
 COAL WAS ENCOUNTERED AT \_\_\_\_\_ FEET \_\_\_\_\_ INCHES  
 \_\_\_\_\_ FEET \_\_\_\_\_ INCHES FEET \_\_\_\_\_ INCHES  
 \_\_\_\_\_ FEET \_\_\_\_\_ INCHES FEET \_\_\_\_\_ INCHES

Drillers' Names E.M. Bush & Clifford Ross

Remarks:  
1310' deep drilling



*John E. Lowther*  
 DISTRICT WELL INSPECTOR  
 05/10/2024

Mar. 3, 1958  
DATE

STATE OF WEST VIRGINIA  
 DEPARTMENT OF MINES  
 OIL AND GAS DIVISION  
**INSPECTOR'S PLUGGING REPORT**

Permit No. \_\_\_\_\_ Well No. \_\_\_\_\_

COMPANY \_\_\_\_\_ ADDRESS \_\_\_\_\_

FARM \_\_\_\_\_ DISTRICT \_\_\_\_\_ COUNTY \_\_\_\_\_

Filling Material Used \_\_\_\_\_

Liner \_\_\_\_\_ Location \_\_\_\_\_ Amount \_\_\_\_\_ Packer \_\_\_\_\_ Location \_\_\_\_\_

PLUGS USED AND DEPTH PLACED			BRIDGES	CASING AND TUBING		
CEMENT-THICKNESS	WOOD-SIZE	LEAD	CONSTRUCTION-LOCATION	RECOVERED	SIZE	LOST

Drillers' Names \_\_\_\_\_

Remarks: \_\_\_\_\_

\_\_\_\_\_ I hereby certify I visited the above well on this date.  
DATE

STATE OF WEST VIRGINIA  
DEPARTMENT OF MINES  
OIL AND GAS WELLS DIVISION  
**INSPECTOR'S PLUGGING REPORT**

Permit No. R.T. - 1844 DD-7 Well No. 1

COMPANY Big D. Industrial Equipment Inc. ADDRESS \_\_\_\_\_

FARM J. N. Elliott DISTRICT Murphy COUNTY Ritchie

Filling Material Used \_\_\_\_\_

Liner	Location	Amount	Packer	Location
PLUGS USED AND DEPTH PLACED				
CEMENT-THICKNESS			WOOD-SIZE	
LEAD			CONSTRUCTION-LOCATION	
RECOVERED			SIZE	
LOST				
<u>2130</u>	<u>- 2000</u>	<u>Clay</u>	<u>1290</u>	<u>5 1/2</u>
<u>2000</u>	<u>- 1950</u>	<u>Cem</u>		
<u>1950</u>	<u>- 450</u>	<u>-</u>		
<u>450</u>	<u>- 430</u>	<u>Cem</u>		
<u>430</u>	<u>- 300</u>	<u>Clay</u>		

Drillers' Names Clark  
B. J. Schleder - Spudder

Remarks: Filling with Clay to 12' of Surface

**RECEIVED**  
MAR 10 1975

OIL & GAS DIVISION  
DEPT. OF MINES

3-7-75  
DATE I hereby certify I visited the above well on this date.

DR Goodnight  
DISTRICT WELL INSPECTOR **05/10/2024**

STATE OF WEST VIRGINIA  
DEPARTMENT OF MINES  
OIL AND GAS WELLS DIVISION

INSPECTOR'S WELL REPORT

Permit No. \_\_\_\_\_

Oil or Gas Well \_\_\_\_\_  
(KIND)

Company _____ Address _____ Farm _____ Well No. _____ District _____ County _____ Drilling commenced _____ Drilling completed _____ Total depth _____ Date shot _____ Depth of shot _____ Initial open flow _____ /10ths Water in _____ Inch Open flow after tubing _____ /10ths Merc. in _____ Inch Volume _____ Cu. Ft. Rock pressure _____ lbs. _____ hrs. Oil _____ bbls., 1st 24 hrs. Fresh water _____ feet _____ feet Salt water _____ feet _____ feet	CASING AND TUBING	USED IN DRILLING	LEFT IN WELL	PACKERS
	Size			Kind of Packer _____
	16			
	13			Size of _____
	10			Depth set _____
	8 1/4			
	6 5/8			Perf. top _____
	5 3/16			Perf. bottom _____
	3			Perf. top _____
	2			Perf. bottom _____
	Liners Used _____			Perf. top _____
				Perf. bottom _____

CASING CEMENTED \_\_\_\_\_ SIZE \_\_\_\_\_ No. FT. \_\_\_\_\_ Date \_\_\_\_\_

NAME OF SERVICE COMPANY \_\_\_\_\_

COAL WAS ENCOUNTERED AT \_\_\_\_\_ FEET \_\_\_\_\_ INCHES

\_\_\_\_\_ FEET \_\_\_\_\_ INCHES \_\_\_\_\_ FEET \_\_\_\_\_ INCHES

\_\_\_\_\_ FEET \_\_\_\_\_ INCHES \_\_\_\_\_ FEET \_\_\_\_\_ INCHES

Drillers' Names \_\_\_\_\_

Remarks:

\_\_\_\_\_  
DATE

\_\_\_\_\_  
05/10/2024  
DISTRICT WELL INSPECTOR

RECEIVED

MAR 12 1975

STATE OF WEST VIRGINIA  
DEPARTMENT OF MINES  
OIL AND GAS WELLS DIVISION

OIL & GAS DIVISION  
DEPT. OF MINES

INSPECTOR'S PLUGGING REPORT

Permit No. Rt 1844-DD-P

Well No. 1

COMPANY Big D. Industrial Equipment Inc. ADDRESS \_\_\_\_\_

FARM J. N. Elliott DISTRICT Murphy COUNTY Ritchie

Filling Material Used \_\_\_\_\_

Liner Location Amount Packer Location

PLUGS USED AND DEPTH PLACED			BRIDGES	CASING AND TUBING		
CEMENT-THICKNESS	WOOD-SIZE	LEAD	CONSTRUCTION-LOCATION	RECOVERED	SIZE	LOST
2130 - 2000	Clay			1290	5 1/2	790
2000 - 1950	Cem					
1950 - 450	-					
450 - 430	Cem					
430 - 300	Clay					
300 - 275	Cem					
275 - 200	Clay					

Drillers' Names Clark  
B. I. Schleder - Spudder

Remarks:  
Filling with Clay - 200'

3-10-75  
DATE

I hereby certify I visited the above well on this date.

R. P. Goodright  
05/10/2024  
DISTRICT WELL INSPECTOR

STATE OF WEST VIRGINIA  
DEPARTMENT OF MINES  
OIL AND GAS WELLS DIVISION

## INSPECTOR'S WELL REPORT

Permit No. \_\_\_\_\_

Oil or Gas Well \_\_\_\_\_  
(KIND)

	CASING AND TUBING	USED IN DRILLING	LEFT IN WELL	PACKERS
Company _____	Size _____			
Address _____	16 _____			Kind of Packer _____
Farm _____	13 _____			
Well No. _____	10 _____			Size of _____
District _____ County _____	8 1/4 _____			
Drilling commenced _____	6 5/8 _____			Depth set _____
Drilling completed _____ Total depth _____	5 3/16 _____			
Date shot _____ Depth of shot _____	3 _____			Perf. top _____
Initial open flow _____ /10ths Water in _____ Inch	2 _____			Perf. bottom _____
Open flow after tubing _____ /10ths Merc. in _____ Inch	Liners Used _____			Perf. top _____
Volume _____ Cu. Ft.				Perf. bottom _____
Rock pressure _____ lbs. _____ hrs.	CASING CEMENTED _____ SIZE _____ No. FT. _____ Date _____			
Oil _____ bbls., 1st 24 hrs.	NAME OF SERVICE COMPANY _____			
Fresh water _____ feet _____ feet	COAL WAS ENCOUNTERED AT _____ FEET _____ INCHES			
Salt water _____ feet _____ feet	_____ FEET _____ INCHES _____ FEET _____ INCHES			

Drillers' Names \_\_\_\_\_

Remarks: \_\_\_\_\_

\_\_\_\_\_  
DATE

05/10/2024  
\_\_\_\_\_  
DISTRICT WELL INSPECTOR

RECEIVED

MAR 13 1975

STATE OF WEST VIRGINIA  
DEPARTMENT OF MINES  
OIL AND GAS WELLS DIVISION

OIL & GAS DIVISION  
DEPT. OF MINES

INSPECTOR'S PLUGGING REPORT

Permit No. RIE-1844-DD-P Well No. 1

COMPANY Big D. Industrial Equipment Inc. ADDRESS \_\_\_\_\_

FARM I.N. Elliott DISTRICT Murphy COUNTY Ritchie

Filling Material Used \_\_\_\_\_

Liner Location Amount Packer Location

PLUGS USED AND DEPTH PLACED			BRIDGES	CASING AND TUBING		
CEMENT-THICKNESS	WOOD-SIZE	LEAD	CONSTRUCTION-LOCATION	RECOVERED	SIZE	LOST
2130 - 2000	Clay			1290	5 1/2	790
2000 - 1950	Cem					
1950 - 450	-					
450 - 430	Cem					
430 - 300	Clay					
300 - 275	Cem					
275 - 12	Clay					

Drillers' Names CLARK  
B.I. Schleder - Spudder

Remarks: Job Comm - 2-20-75

3-11-75  
DATE

I hereby certify I visited the above well on this date.

*B.D. Dought*

05/10/2024  
DISTRICT WELL INSPECTOR

STATE OF WEST VIRGINIA  
DEPARTMENT OF MINES  
OIL AND GAS WELLS DIVISION

## INSPECTOR'S WELL REPORT

Permit No. \_\_\_\_\_

Oil or Gas Well \_\_\_\_\_  
(KIND)

	CASING AND TUBING	USED IN DRILLING	LEFT IN WELL	PACKERS
Company _____	Size			
Address _____	16			Kind of Packer _____
Farm _____	13			
Well No. _____	10			Size of _____
District _____ County _____	8 1/4			
Drilling commenced _____	6 5/8			Depth set _____
Drilling completed _____ Total depth _____	5 3/16			
Date shot _____ Depth of shot _____	3			Perf. top _____
Initial open flow _____ /10ths Water in _____ Inch	2			Perf. bottom _____
Open flow after tubing _____ /10ths Merc. in _____ Inch	Liners Used _____			Perf. top _____
Volume _____ Cu. Ft.				Perf. bottom _____
Rock pressure _____ lbs. _____ hrs.	CASING CEMENTED _____ SIZE _____ No. FT. _____ Date _____			
Oil _____ bbls., 1st 24 hrs.	NAME OF SERVICE COMPANY _____			
Fresh water _____ feet _____ feet	COAL WAS ENCOUNTERED AT _____ FEET _____ INCHES			
Salt water _____ feet _____ feet	_____ FEET _____ INCHES _____ FEET _____ INCHES			
	_____ FEET _____ INCHES _____ FEET _____ INCHES			

Drillers' Names \_\_\_\_\_

Remarks:

\_\_\_\_\_  
DATE

05/10/2024  
\_\_\_\_\_  
DISTRICT WELL INSPECTOR





RECEIVED

FEB 4 1975

STATE OF WEST VIRGINIA  
DEPARTMENT OF MINES  
OIL AND GAS WELLS DIVISION

OIL & GAS DIVISION  
DEPT. OF MINES

NOTICE OF INTENTION TO PLUG AND ABANDON WELL

(REQUIRED BY SECTION 9, ARTICLE 4, CHAPTER 22 OF THE CODE)

To THE DEPARTMENT OF MINES,  
Charleston, W. Va.

No Coal

Big D Industrial Equipment Inc.

Coal Operator

Name of Well Operator

Address

414 Union Trust Bldg, Parkersburg W. Va.

Complete Address

26101

Coal Owner

April 22, 1974

Date

WELL TO BE ABANDONED

Address

Murphy District

I.N. Elliott

Ritchie County

Lease or Property Owner

Well No. One

Washburn W. Va.

I.N. Elliott Farm

Address

Inspector Paul Goodnight, Smithville, W. Va. 26178 Telephone 477-2455

TO BE NOTIFIED 24 HOURS IN ADVANCE OF PLUGGING OPERATIONS

Gentlemen:—

The undersigned well operator is about to abandon the above described well and will commence

the work of plugging and abandoning said well on the date inspector is notified (which date shall not be less than five days after the day on which this notice so mailed is received, or in due course should be received by the Department of Mines).

This notice is given you in order that your respective representatives may be present at the plugging and filling of said well. You are further notified that whether you are represented or not represented the undersigned will proceed on that date, or shortly thereafter, to plug and fill said well in the manner required by Section 10, Article 4, Chapter 22 of the Code and given in detail on the reverse side of this notice, in "Work Order."

This notice is being mailed by registered mail to each of you at the above addresses on the above date.

Very truly yours,

Well Operator

NOTE: Upon the abandonment of any well drilled prior to June 1, 1929, a plat prepared by a registered engineer, shall be filed with THREE COPIES OF APPLICATION, (OG-9) AND "WORK ORDER" AND TWO COPIES OF THE WELL RECORD, (OG-10). The map must show the district and county in which the tract of land is located, the name and acreage of same, the name or names of the owners and names of adjacent tracts and the location of the well to be abandoned, determined by survey with the courses and distances of such well from two permanent points or landmarks on said tract, in compliance with Rule 5 of the Rules and Regulations.

NOTE: In case plugging is not commenced within four months from the date of permit, same shall expire and be of no further force or effect.

NOTE: PERMIT IS NON TRANSFERABLE.

05/10/2024

RIT-1844 - DD -P

Permit Number

APPLICANT, FORM OG 8, MANNER WELL PLUGGED MUST BE SUBMITTED TO OBTAIN RELEASE OF WELL UNDER BOND.

BLANKET BOND

PROPOSED MANNER OF PLUGGING AND FILLING WELL

(REQUIRED BY RULES AND REGULATIONS)

WEST VIRGINIA DEPARTMENT OF MINES

OIL AND GAS DIVISION

WORK ORDER

Well to be plugged and filled as follows:

TOTAL DEPTH - Appx. 2130'

Fill with Clay from 2130' - 2000'

Cement - 2000' - 1950'

Clay - 1950' - 1550'

Cement - 1550' - 1500'

Clay - 1500' - 1200'

Cement - 1200' - 1175'

Clay - 1175' - 300'

Cement - 300' - 275'

Clay - 275' - 12'

Cement - Surface and Erect Monument according to Rule 2:14.

To the Department of Mines  
Coal Owner or Operator,  
Lease or Property Owner.

IF PARTIAL PLUGGING  
PLEASE SUBMIT REVISED WELL RECORD  
WHEN WORK IS COMPLETED.

Gentlemen:

This "work order" is submitted for your approval and concurrence and unless notified of your disapproval or non-concurrence, the undersigned will proceed with the plugging and filling of said well in the above described manner on the date inspector is notified after permit is issued.

Very truly yours,

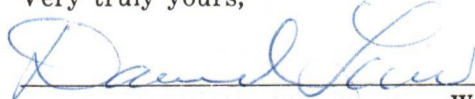

Well Operator

No objections have been filed by the coal owner or coal operator, or any available adjacent lease or property owners or interposed by the Department of Mines to the manner herein described for the plugging and filling of the well above mentioned. Therefore, the same is hereby approved this

4TH day of February, 1975.

DEPARTMENT OF MINES  
Oil and Gas Division

05/10/2024

By:

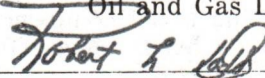

Approved by Harry Stevens

NOTE: This "work order" shall be filed in triplicate, one copy for the files of the Department of Mines; one to be approved or corrected and returned to the well operator as his authority for plugging said well; and one for the well inspector.

RECEIVED

FORM OG-8

STATE OF WEST VIRGINIA  
DEPARTMENT OF MINES

JUN 5 1980

OIL AND GAS WELLS DIVISION

AFFIDAVIT OF PLUGGING AND FILLING WELLS  
OIL & GAS DIVISION  
DEPT. OF MINES

AFFIDAVIT SHOULD BE MADE IN TRIPLICATE, ONE COPY MAILED TO THE DEPARTMENT, ONE COPY TO BE RETAINED BY THE WELL OPERATOR AND THE THIRD COPY (AND EXTRA COPIES IF REQUIRED) SHOULD BE MAILED TO EACH COAL OPERATOR AT THEIR RESPECTIVE ADDRESSES.

COAL OPERATOR OR OWNER \_\_\_\_\_ Big "D" Industrial Equipment, Inc.  
NAME OF WELL OPERATOR

ADDRESS \_\_\_\_\_ 419 Union Trust Building, Parkersburg, WV  
COMPLETE ADDRESS

COAL OPERATOR OR OWNER \_\_\_\_\_ May 9, 1980 19 \_\_\_\_\_  
WELL AND LOCATION

ADDRESS \_\_\_\_\_ Murphy District \_\_\_\_\_

LEASE OR PROPERTY OWNER \_\_\_\_\_ Ritchie County \_\_\_\_\_

ADDRESS \_\_\_\_\_ Well No. # one

\_\_\_\_\_ I.N. Elliot Farm \_\_\_\_\_

STATE INSPECTOR SUPERVISING PLUGGING \_\_\_\_\_ Paul Goodnight \_\_\_\_\_

AFFIDAVIT

STATE OF WEST VIRGINIA, }  
County of \_\_\_\_\_ } SS:

Ed Clark and \_\_\_\_\_  
being first duly sworn according to law depose and say that they are experienced in the work of plugging and filling oil and gas wells and were employed by Big "D" Industrial Equipment, Inc., well operator, and participated in the work of plugging and filling the above well, that said work was commenced on the 14 day of February, 19 75, and that the well was plugged and filled in the following manner:

SAND OR ZONE RECORD	FILLING MATERIAL	PLUGS USED	CASING	
			CSG PULLED	CSG LEFT IN
FORMATION		SIZE & KIND		
2130-2000	Clay		1290	790 5 1/2"
2000-1950	Cement			
1950-450				
450-430	Cement			
430-300	Clay			
300-275	Cement			
275-12	Clay			
12-Surface	Cement			
COAL SEAMS				
(NAME)			DESCRIPTION OF MONUMENT	
(NAME)			As per Rule 2:14	
(NAME)				
(NAME)				

and that the work of plugging and filling said well was completed on the 11 day of March, 19 75.

And further deponents saith not.

Ed Clark 05/10/2024

Sworn to and subscribed before me this 2nd day of JUNE, 19 80.

Robert G. Daniel  
Notary Public.

My commission expires: 5-18-86

Permit No. RIT-1844 D-P  
085

DEPT. OF MINES  
ON & GAS DIVISION

REPARTMENT OF MINES  
ON & GAS DIVISION

Big "D" Industrial Equipment, Inc.  
419 Union Trust Building, Parkersburg, WV

May 9, 1980

Murphy

Ritchie

# one

I. N. Elliot

Paul Goodnight

Ed Clark

Big "D" Industrial Equipment, Inc.

February

24

1200 1200 1200

1200

Clay

1130-2000

Cement

2000-1850

Cement

1850-450

Clay

450-430

Cement

430-300

Clay

300-275

Cement

275-15

Clay

15-2000

As per Rule 2:14

11

75

05/10/2024



RECEIVED  
NOV 20 1985

State of West Virginia  
Department of Mines  
Oil and Gas Division  
Charleston 25305

DIVISION OF OIL & GAS  
DEPARTMENT OF ENERGY

FINAL INSPECTION REPORT  
INSPECTORS COMPLIANCE REPORT

Permit-1-03-58  
Deeper-6-17-63  
Plugging Permit-2-04-75

COMPANY Big "D" Industrial Equipment Inc. PERMIT NO 085-1844-D-P (1975)  
419 Union Trust Building FARM & WELL NO I.N. Elliot #1  
Parkersburg, WV. 26101 DIST. & COUNTY Murphy / Ritchie

RULE	DESCRIPTION	IN COMPLIANCE	
		Yes	No
23.06	Notification Prior to Starting Work	_____	_____
16.01	Required Permits at Wellsite	_____	_____
17.02	Method of Plugging	_____	_____
18.01	Materials used in Plugging	_____	_____
23.02	Maintained Access Roads	✓	_____
25.01	Necessary Equipment to Prevent Waste	_____	_____
23.04	Reclaimed Drilling Pits	✓	_____
23.05	No Surface or Underground Pollution	_____	_____
17.06	Statutory Affidavit	_____	_____
7.06	Parties Responsible	_____	_____
7.05	Identification Markings	✓	_____

I HAVE INSPECTED THE ABOVE CAPTIONED WELL AND RECOMMEND THAT IT BE RELEASED:

SIGNED Samuel M. Heroman  
DATE 11-8-85

Your Affidavit of Plugging was received and reclamation requirements approved.  
The well designated by the above permit number has been released under your bond.

T. L. ...  
Administrator-Oil & Gas Division

TMS/chm

November 20, 1985  
DATE

March 12, 1963  
"Centennial Year"

Mrs. Alice Vandergrift  
1113 Powers Run Road  
Pittsburgh 38, Pennsylvania

In Re: Permit RIT-1844-D  
I. N. Elliot Well  
No. 1, Murphy District,  
Ritchie County

Dear Madam:

Thank you for your note of March 11, 1963 in regard to the well location described above.

We have cancelled Deepening Permit RIT-1844-D, which can be renewed upon request, if you decide at a later date to drill.

Very truly yours,

Assistant Director  
OIL AND Gas DIVISION

MG/dd

cc: Mr. Harry Stevens, Inspector

05/10/2024

Marie E. Griffith:

Department of Mines

Dear Mrs. Griffith:

We abandoned plans to deepen the Mercury well on I.N. Elliot farm, Murphy District, Ritchie County, West Virginia, Permit No. RIT-1844.

Respectfully Yours,

*Alice M. Vandergrift*

Alice M. Vandergrift, Agent



05/10/2024

709



State of West Virginia  
Department of Mines  
Charleston 5

L. J. TIMMS  
DIRECTOR

ELMER C. WORKMAN  
DEPUTY DIRECTOR

March 8, 1963  
"Centennial Year"

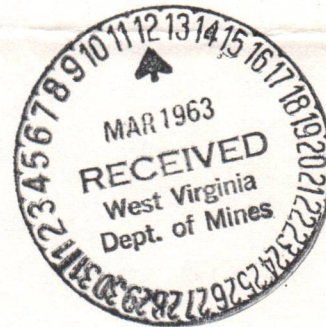

Mrs. Alice Vandergrift  
1113 Powers Run Road  
Pittsburgh 38, Pennsylvania

RE: PERMIT NO. RIT-1844-Drill Deeper  
WELL NO. 1  
FARM L. N. Elliot  
DISTRICT Murphy  
COUNTY Ritchie

Gentlemen:

Please send us two copies of the completion drilling record for the above described well. If drilling has not begun, please advise.

We will appreciate this information as soon as possible to be included in our 1962 Annual Report.

Very truly yours,

*Marie E. Griffith*  
Assistant Director  
OIL AND GAS DIVISION

MG/sm  
Enclosure--Forms OG-10

05/10/2024



May 1, 1964

Mrs. Marie E. Griffith  
State of West Virginia  
Department of Mines  
Oil and Gas Division  
Charleston, West Virginia

*File  
Rif 7844*  
Dear Marie:

I am enclosing two copies of the Deepening record of Mercury well, L.N. Elliott tract, Ritchie County, West Virginia. I am very sorry to be so late sending it in, but I guess you knew that Mr. Hardman passed away Oct. 21, 1963, several days after the well was completed. The log book was in his possession, and I was unable to get it from the executor, his son, and so had to get the information from the drillers when I was home in April. It was a dry hole through Berea formation, and we put it back to pumping in Injun sand, where we had small production.

In answer to your letter that came today regarding the two logs and permits: Permit RIT-2106 is for well # 2 on Earl Hardman or Gay Wilson et al, 59 $\frac{1}{2}$  acres, and both copies of logs you send pertain to the same well, Able Oil and Gas. The other Permit RIT-2774 for 120 acres W.A. Holt Hrs. lesse, issued July 8, 1963 has never been drilled. If I decide to drill in future, I can re-apply for this permit. I do hope this answers all your questions and that the two wells and permits are cleared.

I am trying to start a new business here in Florida that is quite interesting, but have spend since last December trying to get started. Plan to come home in May for my son's graduation from Penn State College, and hope to get to Charleston to see you. With kindest regards,

Sincerely Yours,

Alice M. Vandergrift  
1002 South Olive  
West Palm Beach, Florida

05/10/2024



State of West Virginia

Department of Mines

Oil and Gas Division

Charleston 25305

WALTER N. MILLER  
DIRECTOR

ROBERT L. DODD - P. E.  
DEPUTY DIRECTOR

TO: Gary Robinson  
FROM: THE OFFICE OF OIL AND GAS  
SUBJECT: COPIES OF WORK ORDERS AND INSPECTIONS  
DATE: MAY 8, 1980

Enclosed are copies of work orders and inspection reports for the following:

DODD-1623-P  
JAC-131-P  
LEW-504-P  
RIT-1844-DD-P ✓  
WOO-567-P

See the notation on DODD-1662-P.

/f  
cc: File

*OG-8 forms enclosed*

05/10/2024

39 09 30

Latitude 39° 10'

Longitude 81° 00'

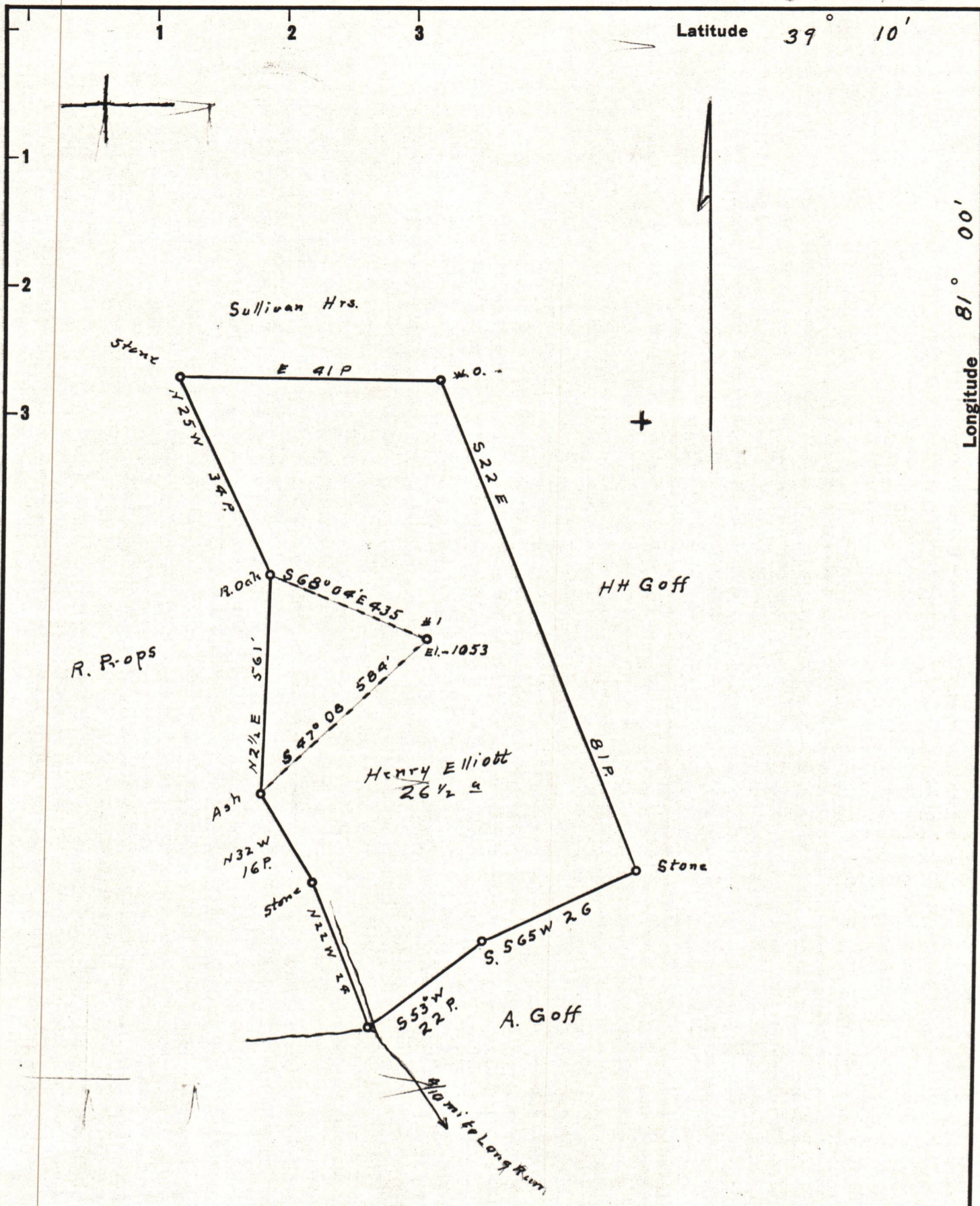

New Location   
 Drill Deeper   
 Abandonment  issued 2/4/75

BIG D INDUSTRIAL EQUIPMENT INC  
 Company Alice Vandergrift  
 414 UNION TRUST BLDG., PARKERSBURG W.V.  
 Address Smithville W.Va. (Earl Hardman agent)  
 Farm I.N. (Henry) Elliott  
 Tract \_\_\_\_\_ Acres 26 1/2 Lease No. \_\_\_\_\_  
 Well (Farm) No. 1 Serial No. \_\_\_\_\_  
 Elevation (Spirit Level) 1053  
 Quadrangle Harrisville 15 Smithville 7.5  
 County Ritchie District Murphy  
 Engineer Robert R. Anderson  
 by O. Meredith  
 Engineer's Registration No. 296  
 File No. \_\_\_\_\_ Drawing No. \_\_\_\_\_  
 Date Jan 28 Scale 20 Poles to 1 inch

STATE OF WEST VIRGINIA  
 DEPARTMENT OF MINES  
 OIL AND GAS DIVISION  
 CHARLESTON

WELL LOCATION MAP

FILE NO. Rit-18440-P  
OEG 05/16/2024  
 8-20-62

+ Denotes location of well on United States Topographic Maps, scale 1 to 62,500, latitude and longitude lines being represented by border lines as shown.

- Denotes one inch spaces on border line of original tracing.

47-085

RECEIVED

FEB 4 1975

OIL & GAS DIVISION  
DEPT. OF MINES

ASSIGNMENT

KNOW ALL MEN BY THESE PRESENTS: That the undersigned, being on of the owners of the hereinafter described leasehold estate and trustee for the below list of all other owners, for and in consideration of the sum of Ten Dollars (\$10.00); cash in hand paid, and other good and valuable considerations: the receipt of which is hereby acknowledged, do hereby assign, set over and convey unto Global Petroleum Investment, Inc. all of the right, title and interest in and to the following described lease and lease-hold estate thereby created, as well as the oil and gas well situate thereon, and all personal property thereunto appurtenant, situate in Ritchie County, West Virginia, and more particularly described as follows:

That certain lease for oil and gas purposed, containing Twenty Six and one quarter (26 1/4) acres, more or less, situate in Murphy District Ritchie County, West Virginia, and which was acquired by Earl Hardman from I.N. Elliott, et al and recorded in Deed Book No. 85 at page 38: of record in the County Court of Ritchie County, West Virginia, dated the 28th. day of August, 1956, and also being the same lease reassigned by Earl Hardman, by Agreement, dated January 30th. 1958, recorded in Lease Book No. 87, at page 196, of record in the County Court of Ritchie County, West Virginia, to Alice M. Vandergrift.

Witness the following signatures and seal on this the 23rd day of March, 1974

*Alice M. Vandergrift*

Alice M. Vandergrift, Attorney & Trustee

List of shareholders in Mercury Oil and Gas well #1.

- |                   |                               |
|-------------------|-------------------------------|
| E.S. Vaughan      | Phyllis Thomas                |
| B.A. Campbell     | Victor A. Smith               |
| John W. Straton   | Janes V. Stanley              |
| Harry F. Bell     | George, Therese & David Rauch |
| Mrs. J.W. Bailey  | Eva S &/or John B. Miller     |
| P.E. Hoskins      | Rupert S. Eaves               |
| J.N. Bailley      | R.F. Stevens                  |
| Julia L. Craddock | Ralph Mangum                  |
| Annette P. Smiley | M.D. Hanesy, Jr.              |
| Harold L. Born    | Walter W. Baker               |
| Eugene Thomas     | Charles E. Summers            |
| D.C. Vickery      | William A. Copenhaver         |
| Christie Hanesy   |                               |

Sworn to and subscribed before me this 23rd day of March, 1974.

STATE OF WEST VIRGINIA

COUNTY OF Putnam to wit:

I, Shirley G. Huff, a Notary Public, within and for said County and State, do hereby certify that Alice M. Vandergrift, who signed the writing above has this day and in my said County, before me, acknowledged the said writing to be her lawful signature.

Shirley G. Huff  
Notary Public

05/10/2024

My Commission expires on 23rd of May, 1977.

05/10/2024



DRILL DEEPER REQUEST

STATE OF WEST VIRGINIA  
DEPARTMENT OF MINES  
OIL AND GAS DIVISION

NOTICE OF PROPOSED LOCATION OF OIL AND GAS WELL

To THE DEPARTMENT OF MINES,  
Charleston, W. Va.

No Coal  
COAL OPERATOR OR COAL OWNER

Alice M. Vandergrift  
NAME OF WELL OPERATOR

ADDRESS

1113 Powers Run Road  
COMPLETE ADDRESS

COAL OPERATOR OR COAL OWNER

Pittsburgh 38, Pa. 6/17, 1963  
PROPOSED LOCATION (Drill deeper

ADDRESS

Murphy District

I.N. Elliott, his wife and  
B.F. Welch, his wife  
OWNER OF MINERAL RIGHTS

Ritchie County

Mahone, West Virginia  
Harrisville, West Va.  
ADDRESS

Well No. 1  
Henry Elliott  
I.N. Elliott Farm

GENTLEMEN:

The undersigned well operator is entitled to drill upon the above named farm or tract of land for oil and gas, having fee title thereto, (or as the case may be) under grant or lease dated August 28, 1958, made by B.F. Welch, his wife and I.N. Elliott, his wife, to Alice M. Vandergrift, and recorded on the \_\_\_\_\_ day of \_\_\_\_\_, in the office of the County Clerk for said County in Book 85, page 38.

The enclosed plat was prepared by a competent engineer and shows the proposed location of a well to be drilled for oil and gas by the undersigned well operator on the farm and in the Magisterial District and County above named, determined by survey and courses and distances from two permanent points, or land marks.

The undersigned well operator is informed and believes there are no coal operators operating beds of coal beneath said farm or tract of land on which said well is located, or within 500 feet of the boundaries of the same, who have mapped their workings and filed their maps as required by law, excepting the coal operators or coal owners (if any) above named as addressees.

The above named coal operators or coal owners (if any) are notified that any objections they may desire to make to such proposed location, or which they are required to make by Section 3 of said Code, if the drilling of a well at said proposed location will cause a dangerous condition in or about their respective coal mines, must be received by, or filed with the Department of Mines within ten\* days from the receipt of a copy of this notice and accompanying plat by said Department. Said coal operators are further notified that forms for use in making such objections will be furnished to them by the Department of Mines promptly on request and that all such objections must set forth as definitely as is reasonably possible the ground or grounds on which such objections are based and indicate the direction and distance the proposed location should be moved to overcome same.

(The next paragraph is to be completed only in Department's copy.)

Copies of this notice and the enclosed plat were mailed by registered mail, or delivered to the above named coal operators or coal owners at their above shown respective address \_\_\_\_\_ day \_\_\_\_\_ before, or on the same day with the mailing or delivery of this copy to the Department of Mines at Charleston, West Virginia.

Very truly yours,

Alice M. Vandergrift  
WELL OPERATOR

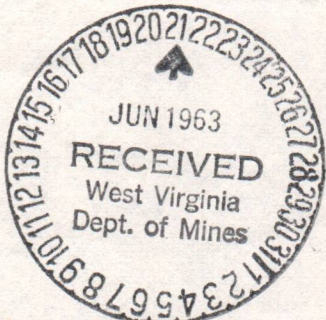

Address of Well Operator }

1113 Powers Run Road  
STREET

Pittsburgh 38, Pa.  
CITY OR TOWN

05/10/2024

STATE

\*Section 3 . . . . If no such objections be filed or be found by the department of mines, within said period of ten days from the receipt of said notice and plat by the department of mines, to said proposed location, the department shall forthwith issue to the well operator a drilling permit reciting the filing of such plat, that no objections have been made by the coal operators to the location, or found thereto by the department, and that the same is approved and the well operator authorized to proceed to drill at said location.



WILLIAMS DEEPER PROSPECT

STATE OF WEST VIRGINIA  
DEPARTMENT OF MINES  
OIL AND GAS DIVISION

NOTICE OF PROPOSED LOCATION OF OIL AND GAS WELL

To the Department of Mines  
Charleston, W. Va.

Alice M. Vandenberg

No. 6021

1113 Fowers Run Road

Pittsburgh 38, Pa. 8/17, 1933

Murphy

Ritchie

Well No. 1

Henry Elliott

K.M. Elliott

B.F. Welch, his wife and J.W. Elliott

and recorded on the

in the office of the County Clerk for said County in

Book 65 page 38

The enclosed plat was prepared by a competent engineer and shows the proposed location of a well to be drilled for oil and gas by the undersigned well operator on the farm and in the Marshall District and County above named, determined by survey and courses and distances from two permanent points on land marked.

The undersigned well operator is informed and believes there are no coal operators operating beds of coal beneath said farm or tract of land on which said well is located or within 500 feet of the boundary of the same who have mapped their workings and filed their maps as required by law, excepting the coal operators or coal owners (if any) above named as addressees.

The above named coal operators or coal owners (if any) are notified that any objections they may desire to make to such proposed location, or which they are reported to make by Section 3 of said Code, if the drilling of a well at said proposed location will cause a dangerous condition in or about their respective coal mines, must be received by or filed with the Department of Mines within ten days from the receipt of a copy of this notice and accompanying plat by said Department. Said coal operators are further notified that forms for use in making such objections will be furnished to them by the Department of Mines promptly on request and that all such objections must set forth as definitely as is reasonably possible the ground or grounds on which such objections are based and indicate the direction and distance the proposed location should be moved to overcome same.

(The next paragraph is to be completed only in Department's copy.)  
Copies of this notice and the enclosed plat were mailed by registered mail, or delivered to the above named coal operators or coal owners at their above shown respective addresses \_\_\_\_\_ day before \_\_\_\_\_ or on the same day with the mailing or delivery of this copy to the Department of Mines at Charleston, West Virginia.

Very truly yours,

Alice M. Vandenberg  
1113 Fowers Run Road  
Pittsburgh 38, Pa.  
CITY OR TOWN  
STATE

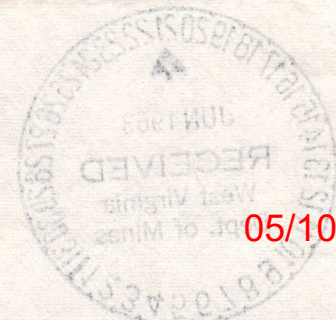

05/10/2024

Section 3. If no such objections be filed or be found by the department of mines within said period of ten days from the receipt of said notice and plat by the department of mines, to said proposed location, the department shall forthwith issue to the well operator a drilling permit, requiring the filing of such plat, that no objections have been made by the coal operators to the location, or found thereby by the department, and that the same is approved and the well operator authorized to proceed to drill at said location.

FILE - 1113 - FOWERS RUN ROAD