

MINIMUM ERROR OF CLOSURE 1/1000
 SOURCE OF ELEVATION junction of roads near location - Elev. 832

New Location
 Drill Deeper
 Abandonment
 I, THE UNDERSIGNED, HEREBY CERTIFY THAT THIS MAP IS CORRECT TO THE BEST OF MY KNOWLEDGE AND BELIEF AND SHOWS ALL THE INFORMATION REQUIRED BY PARAGRAPH 6 OF THE RULES AND REGULATIONS OF THE OIL AND GAS SECTION OF THE MINING LAWS OF WEST VIRGINIA.

Company Philip Lemon
 Address Cairo, W.Va
 Farm S. E. Ball
 Tract 1 Acres 105 Lease No. _____
 Well (Farm) No. 3 Serial No. _____
 Elevation (Spirit Level) 856
 Quadrangle Harrisville - NE
 County Ritchie District Grant
 Engineer Parker E. Peters
 Engineer's Registration No. 485
 File No. _____ Drawing No. _____
 Date Oct. 29, 1964 Scale 1" = 30 P.

STATE OF WEST VIRGINIA
 DEPARTMENT OF MINES
 OIL AND GAS DIVISION
 CHARLESTON

WELL LOCATION MAP
 FILE NO. RT-2969

+ Denotes location of well on United States Topographic Maps, scale 1 to 52,500, latitude and longitude lines being represented by border lines as shown.

- Denotes one inch spaces on border line of original tracing.

09/08/2023

SUBJECT WELL
S.E. Ball No.3
47-085-02969

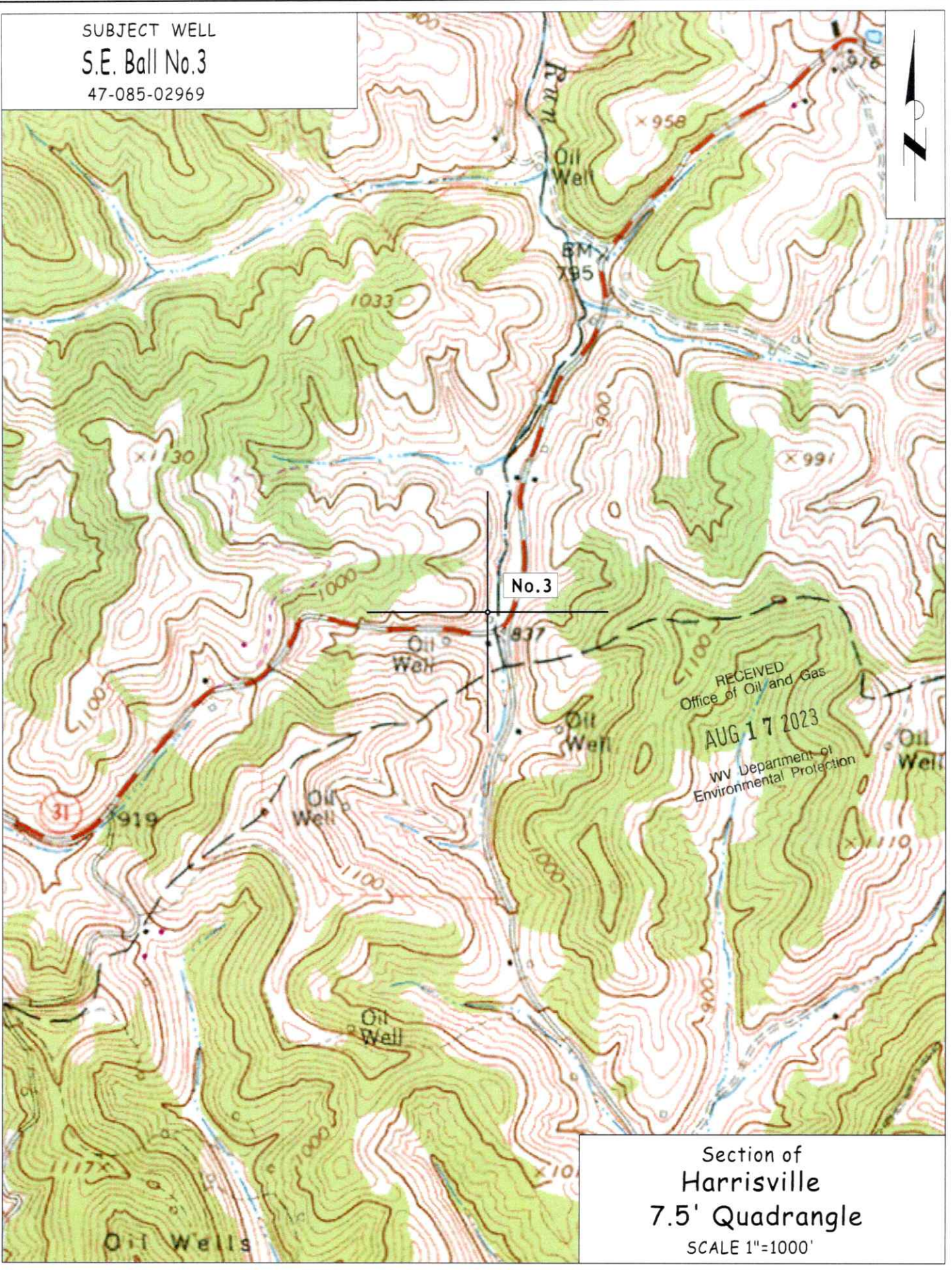

Section of
Harrisville
7.5' Quadrangle
SCALE 1"=1000'

09/08/2023