

LATITUDE 39° 02' 30"

LONGITUDE 81° 00' 18"

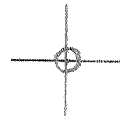

7'5 OGIS topo location

7.5' loc 1.835 15' loc _____
 0.60 W (calc.) _____

Company _____

Farm _____

Quad SMITHVILLE 7 1/2'

County RITCHIE

District MURPHY

WELL LOCATION MAP

File No. 085-3893

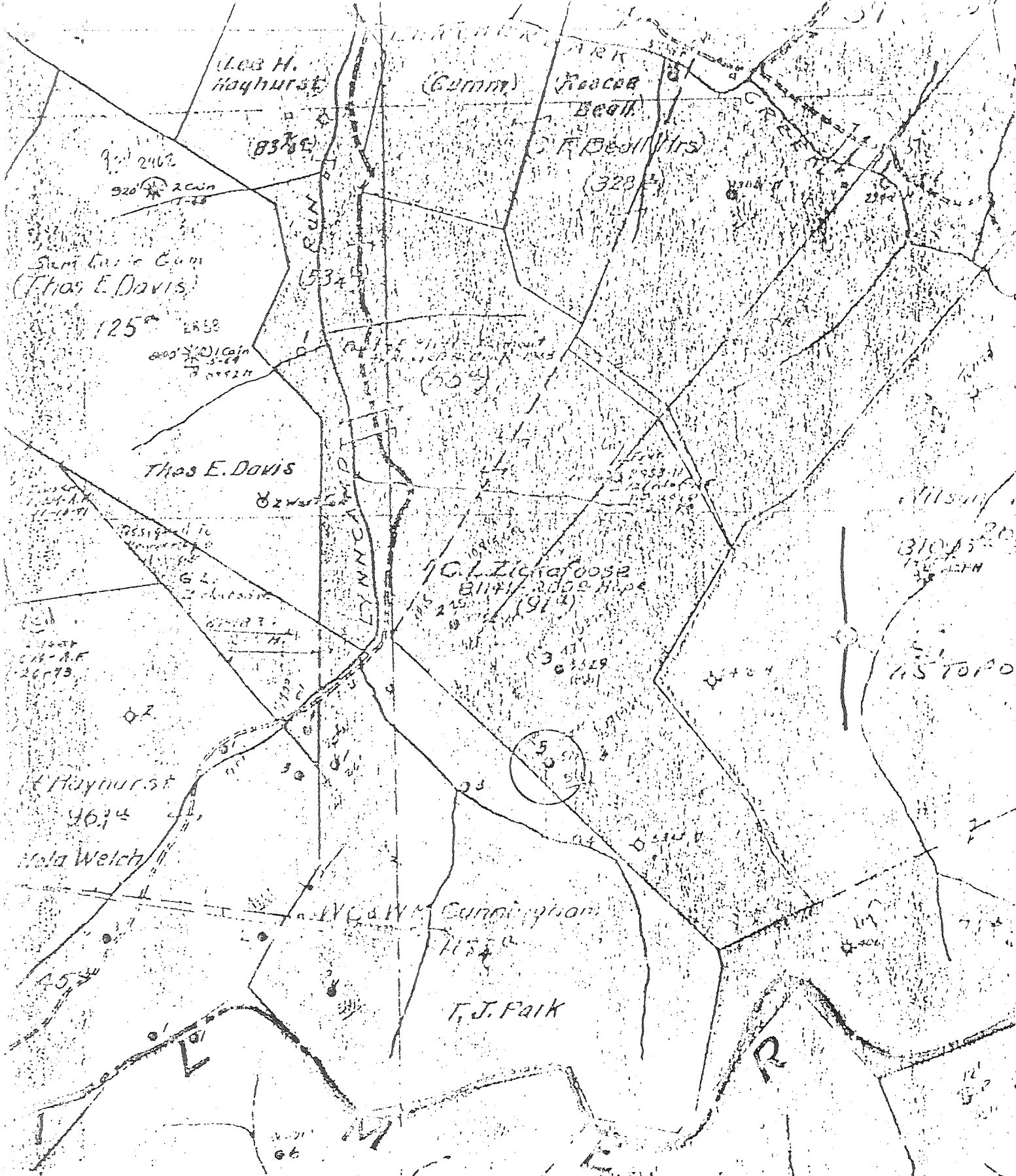

(+) DENOTES LOCATION OF WELL ON UNITED STATES TOPOGRAPHIC MAPS

FORM IV-B
(8-78)
24 S 29 W 23



STATE OF WEST VIRGINIA
DEPARTMENT OF MINES
OIL AND GAS DIVISION

DATE 1-2-1972
OPERATOR'S WELL NO. 47-085-3893
API WELL NO. _____
STATE COUNTY PERMIT

WELL TYPE: OIL GAS _____ LIQUID INJECTION _____ WASTE DISPOSAL _____
(IF "GAS", PRODUCTION _____ STORAGE _____ DEEP _____ SHALLOW _____)

LOCATION: ELEVATION _____ WATER SHED LYNN CAMP RUN, LEATHERPARK CK
DISTRICT MURPHY COUNTY RITCHIE
QUADRANGLE SMITHVILLE 7151

SURFACE OWNER _____ ACREAGE _____
OIL & GAS ROYALTY OWNER _____ LEASE NO. _____ LEASE ACREAGE _____

PROPOSED WORK: DRILL _____ CONVERT _____ DRILL DEEPER _____ REDRILL _____ FRACTURE OR STIMULATE _____ PLUS OFF OLD FORMATION _____ PERFORATE NEW FORMATION _____ OTHER PHYSICAL CHANGE IN WELL (SPECIFY) _____

PLUG AND ABANDON _____ CLEAN OUT AND REPLUS _____
TARGET FORMATION _____ ESTIMATED DEPTH _____

WELL OPERATOR Pennzoil Company DESIGNATED AGENT James A. Crews
ADDRESS P. O. Box 1588 ADDRESS P. O. Box 1588
Parkersburg, WV 26101 Parkersburg, WV 26101

