



West Virginia Department of Environmental Protection
Office of Oil and Gas

WELL LOCATION FORM: GPS

API: 47-085-04024 [†] WELL NO.: WV 655356 (Bird #1266)

FARM NAME: _____

RESPONSIBLE PARTY NAME: EQT Production Company

COUNTY: Ritchie DISTRICT: Union

QUADRANGLE: Burnt House 7.5'

SURFACE OWNER: F.P. Goff Estate et. al.

ROYALTY OWNER: Louie M. Conrad et. al.

UTM GPS NORTHING: 4,324,891

UTM GPS EASTING: 504,055 GPS ELEVATION: 246 m (807 ft)

The Responsible Party named above has chosen to submit GPS coordinates in lieu of preparing a new well location plat for a plugging permit or assigned API number on the above well. The Office of Oil and Gas will not accept GPS coordinates that do not meet the following requirements:

1. Datum: NAD 1983, Zone: 17 North, Coordinate Units: meters, Altitude height above mean sea level (MSL) – meters.
2. Accuracy to Datum – 3.05 meters
3. Data Collection Method:

Survey grade GPS _____: Post Processed Differential _____
Real-Time Differential _____

Mapping Grade GPS X: Post Processed Differential X
Real-Time Differential _____

4. **Letter size copy of the topography map showing the well location.**

I the undersigned, hereby certify this data is correct to the best of my knowledge and belief and shows all the information required by law and the regulations issued and prescribed by the Office of Oil and Gas.

Ben R. Saylor
Signature

P.S. 2092
Title

8-10-11
Date

RECEIVED
Office of Oil & Gas
AUG 23 2011
WV Department of
Environmental Protection

Topo Quad: Burnt House

Scale: 1" = 2000' 85-04024P

County: Ritchie

Date: July 19, 2011

District: Union

Project No: 68-38-00-08

47-085-04024 (WV 655356)

Topo

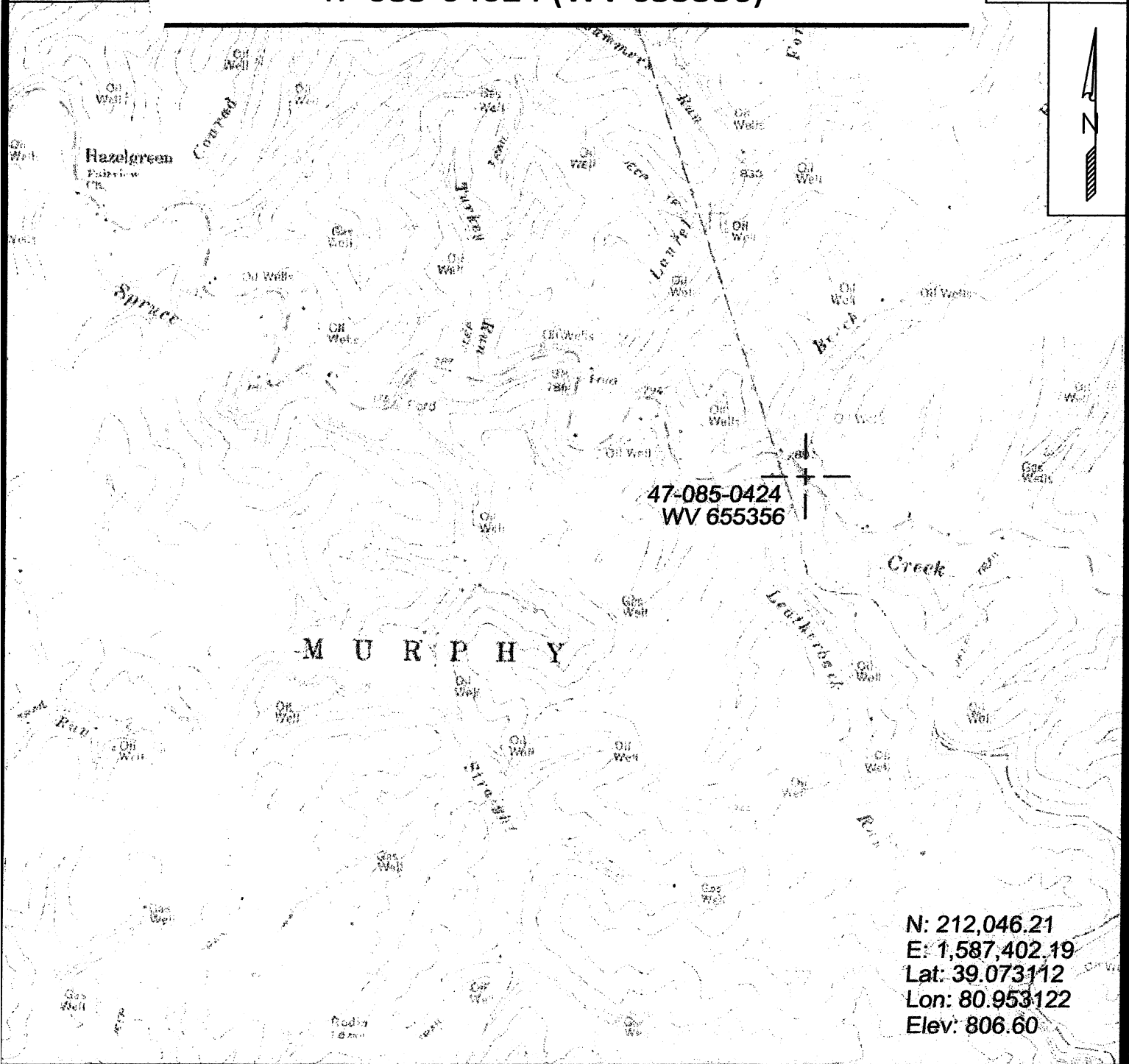

N: 212,046.21
 E: 1,587,402.19
 Lat: 39.073112
 Lon: 80.953122
 Elev: 806.60



SURVEYING AND MAPPING SERVICES PERFORMED BY:
ALLEGHENY SURVEYS, INC.

1-800-482-8606
 P.O. BOX 438
 BIRCH RIVER, WV 26610
 PH: (304) 649-8606
 FAX: (304) 649-8608

PREPARED FOR:

EQT Production Company

1710 Pennsylvania Ave.
 Charleston, WV 25302