

(Revised 3-81)

PROPOSED WORK ORDER

THIS IS AN ESTIMATE ONLY:
ACTUAL INFORMATION MUST BE SUBMITTED ON FORM IV-35 UPON COMPLETION

DRILLING CONTRACTOR (IF KNOWN) N/A

Address _____

GEOLOGICAL TARGET FORMATION Marcellus
Estimated depth of completed well 5000 feet. Rotary XX / Cable tools /
Approximate water strata depths: Fresh, 150 feet; salt, 1500 feet.
Approximate coal seam depths: none
Is coal being mined in this area: Yes / No XX /

CASING AND TUBING PROGRAM

CASING OR TUBING TYPE	SPECIFICATIONS					FOOTAGE INTERVALS		CEMENT FILL UP OR SACKS Cubic ft.	PACKERS
	Size	Grade	Weight per ft	New	Used	For Drilling	Left in Well		
Conductor	13 4/3			X		20'	to be pulled		Kinds
Fresh water	8 5/8			X		1100'	1100'	<i>78 surface</i>	Sizes
Coal									
Intermed.									
Production Tubing	4 1/2	K-55		X		T.D.	T.D.	500 sacks	Depths set
Liners		seamless						or as required	by rule 15.01
									Perforations:
									Top Bottom

NOTE: Regulation 7.02 of the Department of Mines provides that the original and four copies of Form IV-2 must be filed with the Department, accompanied by (i) a plat in the form prescribed by Regulation 11, (ii) a bond in one of the forms prescribed by Regulation 12, or in lieu thereof the other security allowed by Code §22-4-2, (iii) Form IV-9, "Reclamation Plan" applicable to the reclamation required by Code §22-4-12b and Regulation 23, (iv) unless previously paid on the same well, the fee required by Code §22-4-12a, and (v) if applicable, the consent required by Code §22-4-8a from the owner of any water well or dwelling within 200 feet of the proposed well.

A separate Form IV-2 shall not be required for fracturing or stimulating a well where fracturing or stimulating is to be part of the work for which a permit is sought and is noted as such on the Form IV-2 filed in connection therewith.

THIS PERMIT MUST BE POSTED AT THE WELL SITE

ALL PROVISIONS BEING IN ACCORDANCE WITH CHAPTER 22,

ARTICLE 4 OF THE W. VA. CODE, THE LOCATION IS HEREBY

APPROVED FOR Drilling. THIS PERMIT SHALL EXPIRE

IF OPERATIONS HAVE NOT COMMENCED BY 12-7-82.

BY Fred Budette

The following waiver must be completed by the coal operator and by any coal owner or coal lessee who has recorded a declaration under Code §22-4-20, if the permit is to be issued within fifteen (15) days of receipt thereof:

W A I V E R

The undersigned coal operator / owner / lessee / of the coal under this well location has examined this proposed well location. If a mine map exists which covers the area of the well location, the well location has been added to the mine map. The undersigned has no objection to the work proposed to be done at this location, **08/18/2023** the well operator has complied with all applicable requirements of the West Virginia Code and the governing regularions.

Date: , 19 .

By: _____

Its: _____

ATTACH OR PHOTOCOPY SECTION OF
INVOLVED TOPOGRAPHIC MAP.
QUADRANGLE Mac Farlan

LEGEND	
Well Site	
Access Road	



WELL SITE PLAN

Sketch to include well location, existing access road, roads to be constructed, wellsite, drilling pits and necessary structures numbered or lettered to correspond with the first part of this plan. Include all natural drainage.

LEGEND	
Property boundary	
Road	
Existing fence	
Planned fence	
Stream	
Open ditch	
Diversion	
Spring	
Wet spot	
Building	
Drain pipe	
Waterway	

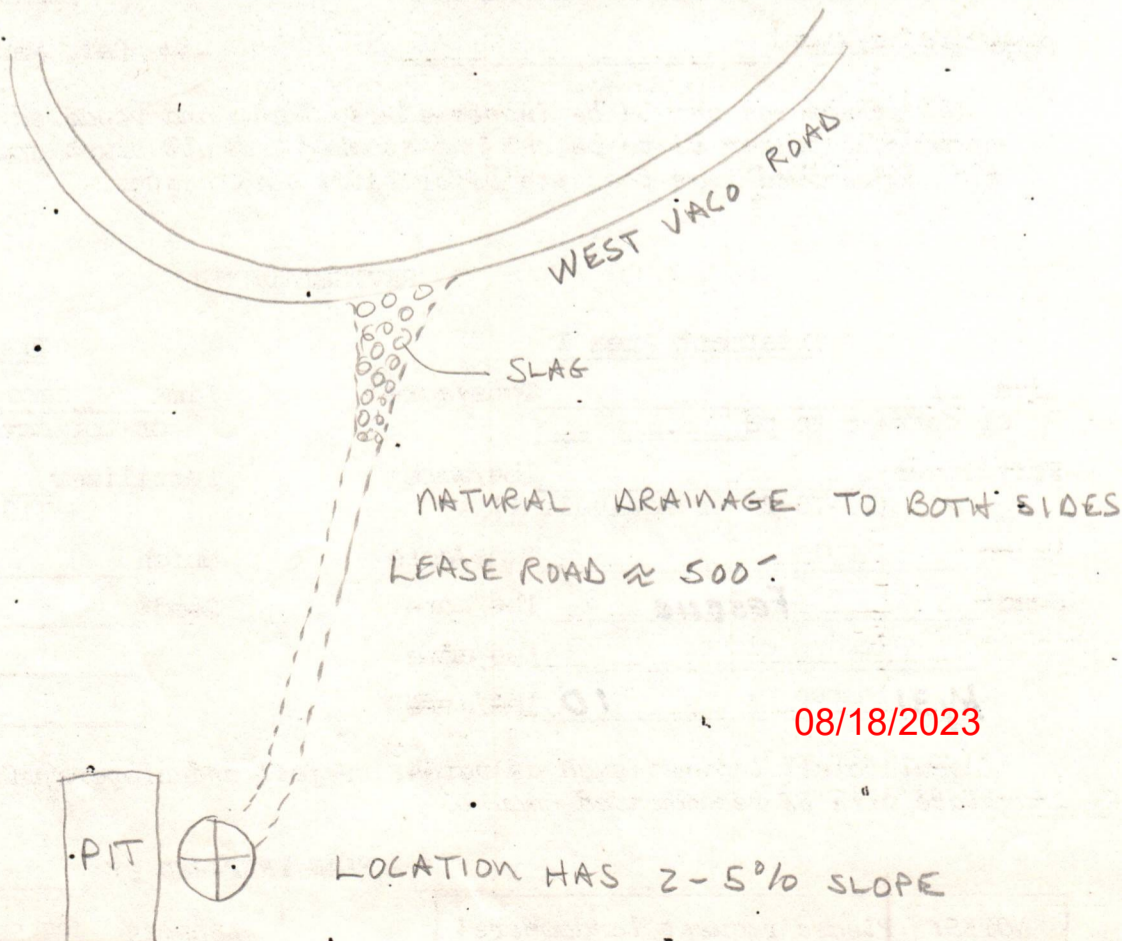



IV-9
(Rev 8-81)

DATE 3/25/82

WELL NO. D-8

State of West Virginia API NO. 47-085-5546

Department of Mines
Oil and Gas Division

CONSTRUCTION AND RECLAMATION PLAN

COMPANY NAME Energy Unlimited, Inc.
Address 427 Second St. Marietta, OH 45750
Telephone 614-373-7267

DESIGNATED AGENT Douglas M. Galloway
Address 427 Second St. Marietta, OH 45750
Telephone 614-373-7267

LANDOWNER Westvaco

SOIL CONS. DISTRICT Little Kanawha

Revegetation to be carried out by Unlimited Services, Inc. (Agent)

This plan has been reviewed by Little Kanawha SCD. All corrections and additions become a part of this plan: 3-27-82

(Date)
Jarrett Newton
(SCD Agent)

ACCESS ROAD

LOCATION

Structure see diagram (A)

Structure see diagram (1)

Spacing _____

Material _____

Page Ref. Manual _____

Page Ref. Manual _____

Structure _____ (B)

Structure _____ (2)

Spacing _____

Material _____

Page Ref. Manual _____

Page Ref. Manual _____

Structure _____ (C)

Structure _____ (3)

Spacing _____

Material _____

Page Ref. Manual _____

Page Ref. Manual _____

RECEIVED

APR 5 - 1982

OIL AND GAS DIVISION
WV DEPARTMENT OF MINES

All structures should be inspected regularly and repaired if necessary. All commercial timber is to be cut and stacked and all brush and small timber to be cut and removed from the site before dirt work begins.

REVEGETATION

Treatment Area I

Treatment Area II

Lime _____ Tons/acre
or correct to pH 6.5

Lime same as I Tons/acre
or correct to pH _____

Fertilizer 500 lbs/acre
(10-20-20 or equivalent)

Fertilizer _____ lbs/acre
(10-20-20 or equivalent)

Mulch (hay) 2 Tons/acre

Mulch _____ Tons/acre

Seed* ky 31 Fescue 30 lbs/acre

Seed* _____ lbs/acre

ladino clover 5 lbs/acre

_____ lbs/acre

Ky31 fescue 10 lbs/acre

_____ lbs/acre

08/18/2023

*Inoculate all legumes such as vetch, trefoil and clovers with the proper bacterium. Inoculate with 3X recommended amount.

PLAN PREPARED BY W. J. Slans

ADDRESS 427 Second St.

Marietta, OH 45750

PHONE NO. 614-373-7267

NOTES: Please request landowners' cooperation to protect new seedling for one growing season. Attach separate sheets as necessary for comments.

DETAILS OF PERFORATED INTERVALS, FRACTURING OR STIMULATING, PHYSICAL CHANGE, ETC.

Perforated with 16 - .39" holes from 3505'-3758'.

Fractured with 1000 gal. acid and 997MSCF of nitrogen.

WELL LOG

FORMATION	COLOR	HARD OR SOFT	TOP FEET	BOTTOM FEET	REMARKS
					Including indication of all fresh and salt water, coal, oil and gas
Soil		soft	0	6'	
Shale		soft	6'	35'	
Sand		hard	35'	85'	
Shale		soft	85'	125'	
Sand		hard	125'	160'	Freshwater
Sand & Shale		medium	160'	285'	
Siltstone		medium	285'	520'	
Sand		hard	520'	570'	
Shale		soft	570'	620'	
Sand		hard	620'	690'	
Shale & Siltstone		soft	690'	975'	
Sand		hard	975'	1010'	
Limestone		hard	1010'	1050'	
Shale & Sand		medium	1050'	1280'	
Sand		hard	1280'	1440'	
Siltstone		hard	1440'	1500'	
Shale		soft	1500'	1610'	
Sand		hard	1610'	1640'	
Shale		soft	1640'	1700'	
Maxton Sand		hard	1700'	1790'	Show of gas, saltwater
Big Lime		hard	1790'	1880'	
Big Injun Sand		hard	1880'	1960'	Little show of oil
Sandy Shale		soft	1960'	2330'	
Coffee Shale		soft	2330'	2340'	
Silty Shale		soft	2340'	2710'	
Fifth Sand		hard	2710'	2720'	
Shale			2720'	3500'	
Brown Shale			3500'	3880'	Show of gas and oil
Shale			3880'	T.D.	T.D. 4117'

(Attach separate sheets as necessary)

Energy Unlimited, Inc.

Well Operator

By: James J. Hanlon 08/18/2023
 Date: Jim Hanlon 11/2/82

Note: Regulation 2.02(i) provides as follows:
 "The term 'log' or 'well log' shall mean a systematic detailed geological record of all formations, including coal, encountered in the drilling of a well."

RECEIVED

NOV 2 2 1982

IV-35
(Rev 8-81)

OIL AND GAS DIVISION
WV DEPARTMENT OF MINES



State of West Virginia
Department of Mines
Oil and Gas Division

Date 10/13/82
Operator's
Well No. # D-8
Farm Goldin Heirs etal
API No. 47 - 085 - 5546

WELL OPERATOR'S REPORT
OF
DRILLING, FRACTURING AND/OR STIMULATING, OR PHYSICAL CHANGE

WELL TYPE: Oil x / Gas x / Liquid Injection / Waste Disposal /
(If "Gas," Production / Underground Storage / Deep / Shallow /)

LOCATION: Elevation: 915' Watershed South Fork Hughs River
District: Murphy County Ritchie Quadrangle MacFarlan

COMPANY Energy Unlimited, Inc.
ADDRESS 427 Second Street Marietta, Oh
DESIGNATED AGENT Dave Clovis 45750
ADDRESS Union Trust Bldg. Parkersburg, WV 26101
SURFACE OWNER Westvaco
ADDRESS 1900 Blizzare Dr. Parkersburg, WV 26101
MINERAL RIGHTS OWNER M. Goldin Heirs etal
ADDRESS N/A
OIL AND GAS INSPECTOR FOR THIS WORK Sam
Hersman ADDRESS Box 66 Smithville, WV
PERMIT ISSUED 4/5/82 26178
DRILLING COMMENCED 10/1/82
DRILLING COMPLETED 10/6/82
IF APPLICABLE: PLUGGING OF DRY HOLE ON
CONTINUOUS PROGRESSION FROM DRILLING OR
REWORKING. VERBAL PERMISSION OBTAINED
ON

Casing & Tubing	Used in Drilling	Left in Well	Cement fill up Cu. ft.
Size 20-16 Cond.			
13-10"			
9 5/8			
8 5/8	1140'	1140'	to surface
7			
5 1/2			
4 1/2	4090'	4090'	445 sks.
3			
2			
Liners used			

GEOLOGICAL TARGET FORMATION Devonian Brown Shale Depth 3500' feet
Depth of completed well 4117' feet Rotary X / Cable Tools
Water strata depth: Fresh 125' feet; Salt 1750' feet
Coal seam depths: None Reported Is coal being mined in the area? No

OPEN FLOW DATA

Producing formation Devonian Brown Shale Pay zone depth 3500-3760' feet
Gas: Initial open flow 90 Mcf/d Oil: Initial open flow - Bbl/d
Final open flow 75 Mcf/d Final open flow - Bbl/d
Time of open flow between initial and final tests 8 hours
Static rock pressure 520 psig (surface measurement) after 24 hours shut in
(If applicable due to multiple completion--)
Second producing formation Pay zone depth feet
Gas: Initial open flow Mcf/d Oil: Initial open flow Bbl/d
Final open flow Mcf/d Oil: Final open flow Bbl/d
Time of open flow between initial and final tests hours
Static rock pressure psig (surface measurement) after hours shut in

08/18/2023

(Continue on reverse side)

RIT - 5546

STATE OF WEST VIRGINIA
DEPARTMENT OF MINES
OIL AND GAS WELLS DIVISION

INSPECTOR'S WELL REPORT

Permit No. 85-5546

Oil or Gas Well _____
(KIND)

Company Energy Unlimited
 Address _____
 Farm Westvaco
 Well No. D-8
 District Murphy County Ritchie
 Drilling commenced 10-1-82
 Drilling completed _____ Total depth _____
 Date shot _____ Depth of shot _____
 Initial open flow _____ /10ths Water in _____ Inch
 Open flow after tubing _____ /10ths Merc. in _____ Inch
 Volume _____ Cu. Ft.
 Rock pressure _____ lbs. _____ hrs.
 Oil _____ bbls., 1st 24 hrs.
 Fresh water _____ feet _____ feet
 Salt water _____ feet _____ feet

CASING AND TUBING	USED IN DRILLING	LEFT IN WELL	PACKERS
Size			Kind of Packer
16			
13			
10			
8 1/4			
6 5/8			Depth set
5 3/16			
3			Perf. top
2			Perf. bottom
Liners Used			Perf. top
			Perf. bottom

RECEIVED

OCT 8 1982

OIL AND GAS DIVISION
WV DEPARTMENT OF MINES

CASING CEMENTED _____ SIZE _____ No. FT. _____ Date _____
 NAME OF SERVICE COMPANY _____
 COAL WAS ENCOUNTERED AT _____ FEET _____ INCHES
 _____ FEET _____ INCHES _____ FEET _____ INCHES
 _____ FEET _____ INCHES _____ FEET _____ INCHES

Drillers' Names Danny Cvey / Dale Bundy / Ronald Berg
Warren Drilling Rig # 2 toal Pusher
 Remarks: Randy Warren

9-3-82 Ran 1140' foot of 8 5/8 casing
Dowall-pumped 285 sacks
Basket set at 500'

10-4-82
DATE

Samuel T. Keraman 08/18/2023
DISTRICT WELL INSPECTOR

STATE OF WEST VIRGINIA
DEPARTMENT OF MINES
OIL AND GAS WELLS DIVISION

RECEIVED
JUN 6 - 1984

OIL & GAS DIVISION

INSPECTOR'S WELL REPORT DEPT. OF MINES

Permit No. 85-5546

Oil or Gas Well _____
(KIND)

Company <u>Energy Unlimited</u>	CASING AND TUBING	USED IN DRILLING	LEFT IN WELL	PACKERS
Address _____	Size			
Farm <u>Westwood</u>	16			Kind of Packer _____
Well No. <u>D-8</u>	13			
District <u>Murphy</u> County <u>Ritchie</u>	10			Size of _____
Drilling commenced _____	8 1/4			
Drilling completed _____ Total depth _____	6 5/8			Depth set _____
Date shot _____ Depth of shot _____	5 3/16			
Initial open flow _____ /10ths Water in _____ Inch	3			Perf. top _____
Open flow after tubing _____ /10ths Merc. in _____ Inch	2			Perf. bottom _____
Volume _____ Cu. Ft.	Liners Used			Perf. top _____
Rock pressure _____ lbs. _____ hrs.				Perf. bottom _____
Oil _____ bbls., 1st 24 hrs.	CASING CEMENTED _____ SIZE _____ No. FT. _____ Date _____			
Fresh water _____ feet _____ feet	NAME OF SERVICE COMPANY _____			
Salt water _____ feet _____ feet	COAL WAS ENCOUNTERED AT _____ FEET _____ INCHES			
	_____ FEET _____ INCHES _____ FEET _____ INCHES			
	_____ FEET _____ INCHES _____ FEET _____ INCHES			

Drillers' Names _____

Remarks: Visit location site with loyer operator to discuss disposal of pit and clean up of location to abate violation

5-31-84
DATE

Samuel N. H.
08/18/2023
DISTRICT WELL INSPECTOR



RECEIVED
OCT 10 1984

OIL & GAS DIVISION
DEPT. OF MINES

State of West Virginia
Department of Mines
Oil and Gas Division
Charleston 25305

FINAL INSPECTION REPORT
INSPECTORS COMPLIANCE REPORT

COMPANY ENERGY UNLIMITED INC
427 SECOND ST.
MARIETTA OHIO 45758

PERMIT NO 47-085-5546
FARM & WELL NO GOLDIN HEIRS D-8
DIST. & COUNTY MURPHY - RITCHIE

RULE	DESCRIPTION	IN COMPLIANCE	
		YES	NO
23.06	Notification Prior to Starting Work	_____	_____
25.04	Prepared before Drilling to Prevent Waste	_____	_____
25.03	High-Pressure Drilling	_____	_____
16.01	Required Permits at Wellsite	✓	_____
15.03	Adequate Fresh Water Casing	✓	_____
15.02	Adequate Coal Casing	_____	_____
15.01	Adequate Production Casing	_____	_____
15.04	Adequate Cement Strenght	_____	_____
15.05	Cement Type	_____	_____
23.02	Maintained Access Roads	✓	_____
25.01	Necessary Equipment to Prevent Waste	✓	_____
23.04	Reclaimed Drilling Pits	✓	_____
23.05	No Surface or Underground Pollution	✓	_____
23.07	Requirements for Production & Gathering Pipelines	✓	_____
16.01	Well Records on Site	✓	_____
16.02	Well Records Filed	✓	_____
7.05	Identification Markings	✓	_____

I HAVE INSPECTED THE ABOVE CAPTIONED WELL AND RECOMMEND THAT IT BE RELEASED:

SIGNED Samuel N. Hersman
DATE 10-2-84

Your well record was received and reclamation requirements approved. In accordance with Chapter 22, Article 4, Section 2, the above well will remain under bond coverage for the life of the well.

T. L. ...
Administrator-Oil & Gas Division

January 2, 1985
DATE

08/18/2023

RECEIVED
JUN 12 1984

OIL & GAS DIVISION
DEPT. OF MINES

Date June 8, 19 84

Operator's Well No. D-8

API Well No. 47 - 85 - 5546
State County Permit

STATE OF WEST VIRGINIA
DEPARTMENT OF MINES, OIL AND GAS DIVISION

NOTICE OF ABATEMENT

WELL TYPE: Oil / Gas / Liquid Injection _____ / Waste Disposal _____ /
Underground
If "Gas" - Production / Storage _____ / Deep _____ / Shallow

LOCATION: Elevation: 915 Watershed: South Fork Hughes River

District: Murphy County: Ritchie Quadrangle: Macfarlan

WELL OPERATOR Energy Unlimited DESIGNATED AGENT Dave Davis

Address 437 Second St
Marietta Ohio 45750

Address Union Trust Building
Parkersburg W. 26101

Notice is hereby given that the undersigned authorized oil and gas inspector made a special inspection of the above named well on June 8, 19 84.

Upon the expiration of a period of time originally fixed for abatement.

____ Upon the order of the Deputy Director for Oil and Gas at the request of the well operator.

____ Upon the request of the Deputy Director for Oil and Gas.

The violation of Code 22-4-12B, heretofore found to exist on May 9, 19 84,

by Form IV-27, "Notice of Violation" /, Form IV-28, "Imminent Danger Order" _____ / of that date has been totally abated. If the abated violation was found by an Imminent Danger Order requiring operations to cease, such requirement is hereby rescinded, and the well operator is hereby notified that he may resume operations.

COMMENTS: (USE REVERSE SIDE OF THIS NOTICE IF NECESSARY)

A copy of this NOTICE has been posted at the well site and sent by certified or registered mail to the indicated well operator or his designated agent.

08/18/2023

Samuel N. Heroman
Oil and Gas Inspector

Address P.O. Box 66

Smithville WV 26178

Telephone 477-3597

IV-27
11/23/81

RECEIVED
MAY 11 1984



OIL & GAS DIVISION
DEPT. OF MINES
STATE OF WEST VIRGINIA
DEPARTMENT OF MINES

Date: 5-9-84
Well No: D-8
API NO: 47-85-5546
State County Permit

Oil and Gas Division NOTICE OF VIOLATION

WELL TYPE: Oil / Gas Liquid Injection / Waste Disposal /
Of "Gas" - Production / Storage / Deep / Shallow /
LOCATION: Elevation: 915 Watershed: South Fork Hughes River
District: Murphy County: Ritchie Quadrangle: Macfarlan
WELL OPERATOR Energy Unlimited Inc. DESIGNATED AGENT Dave Clovis
Address 427 Second St. Address Union Trust Bldg.
Marietta Ohio 45750 Parkersburg, WV 26101

The above well is being posted this 9 day of May, 1984, for a violation of Code 22-4-12^B and/or Regulation _____, set forth in detail as follows:

(USE REVERSE SIDE OF THIS NOTICE IF NECESSARY)

22-4-12B states that within six months after the completion of drilling process reclamation work shall be completed.

Operator has not filled pits, graded, seeded or completed this location

22-4-1K No API # at well site or head

A copy of this notice has been posted at the well site and sent by certified or registered mail to the indicated well operator or his designated agent.

You are hereby granted until May 15, 1984, to abate this violation.

Failure to abate the violation may result in action by the Department under Code 22-4-17 or Code 22-4-18.

Samuel M. Hersman
Oil and Gas Inspector

Address P.O. Box 66
Smithville WV 26178

Telephone: 477-3587 08/18/2023

RECEIVED
MAY 22 1984

Date: May 17, 1984
Operator's Well Number D-8
API Well No. 47 - 085 - 5546
State County Permit

OIL & GAS DIVISION
DEPT. OF MINES
STATE OF WEST VIRGINIA
DEPARTMENT OF MINES, OFFICE OF OIL AND GAS
ORDER FOR FAILURE TO ABATE VIOLATION

WELL TYPE: Oil / Gas / Liquid Injection _____ / Waste Disposal _____ /
If "Gas" - Production _____ / Underground Storage _____ / Deep _____ / Shallow /
LOCATION: Elevation: 915 Watershed: South Fork Hughes River
District: Murphy County: Ritchie Quadrangle Macfarlan
WELL OPERATOR: Energy Unlimited Inc.
Address: 4299 Second St. Marietta Ohio 45758
DESIGNATED AGENT: Dave Clovis
Address: Union Trust Bldg. Parkersburg WV 26101

Notice is hereby given that the undersigned authorized oil and gas inspector has made a special inspection of the above-named well on May 17, 1984.

- Upon the expiration of a period of time originally fixes for abatement.
- Upon the order of the Administrator for the Office of Oil and Gas at the request of the well operator.
- Upon the request of the Administrator for the Office of Oil and Gas.

The violation of Code 22-4-12B, heretofore found to exist on May 9, 1984 by Form IV-27, "Notice of Violation" /, Form IV-28, "Imminent Danger Order" _____ / of that date has not been totally abated and it has been determined that no further extension of time should be permitted for the following reasons:

(USE REVERSE SIDE OF THIS ORDER IF NECESSARY)

No attempt made to abate Violation

Therefore, in accordance with the provisions of Code 22-4-1g, the well operator is hereby ORDERED:

- To continue cessation of operations until the imminent danger is fully abated.
- To cease further operations until the violation has been fully abated.

In accordance with Code 22-4-1h, a well operator or complaining coal operator, owner, or lessee may apply for review of this Order within 15 days of the date of this Order.

Samuel N. Hersman
Oil and Gas Inspector

PURCHASER: _____
Address _____

Address: P.O. Box 66
Smithville WV 26178
Telephone: 477-3597

(Copies of this ORDER have been posted at the well site and sent by certified or registered mail to the indicated well operator or his designated agent.)

08/18/2023

RECEIVED
MAY 2 1984
DEPT. OF MINES
OFFICE OF GAS DIVISION

Date: May 17 1984
 Operator's No. 0-8
 Well No. 082-3344
 State County Permit

STATE OF WEST VIRGINIA
 DEPARTMENT OF MINES, OFFICE OF OIL AND GAS
 ORDER FOR FAILURE TO ABATE VIOLATION

Well No. 082-3344
 Location W. 1/4 Sec. 17, T. 33 N., R. 10 E., 19th Dist., Boone Co., W. Va.
 Well Operator Boone County Industrial Co.
 Address Boone County Industrial Co., P.O. Box 1000, Boone, W. Va. 26001
 Designated Agent Boone County Industrial Co.
 Address Boone County Industrial Co., P.O. Box 1000, Boone, W. Va. 26001

Noti ce is hereby given that the undersigned authorized oil and gas inspector has made a special inspection of the above named well on May 17 1984 and has observed a violation of the provisions of the West Virginia Code, Chapter 20, Article 1, Section 1, which reads: "The operator of a well shall not allow the well to operate in a manner which causes the well to produce gas in excess of the capacity of the wellhead equipment installed on the well."

Upon the request of the Administrator for the Office of Oil and Gas, the violator found to exist on May 17 1984 was ordered to abate the violation by May 17 1984. The violator has not been fully abated and it has been determined that no further extension of time should be permitted for the following reasons:

(USE REVERSE SIDE OF THIS ORDER IF NECESSARY)

No attempt made to abate violation

Therefore, in accordance with the provisions of Code 20-1-1, the well operator is hereby ordered to continue cessation of operations until the violation is fully abated. In case further operations with the violation has been fully abated, in accordance with Code 20-1-1, a well operator or completed coal operator, under no circumstances may be permitted to resume operations until the date of the order or later may apply for review of this order within 15 days of the date of the order.

Boone County Industrial Co.
 Oil and Gas Inspector
 Address: P.O. Box 1000, Boone, W. Va. 26001
 Telephone: 777-3977

(Copies of this order have been posted at the well site and sent by certified or registered mail to the indicated well operator or his designated agent.)

1112. 4/6/82

11,130' WEST

LATITUDE 39° 07' 30"

LONGITUDE 81° 10' 00"

6800' SOUTH

NORTH

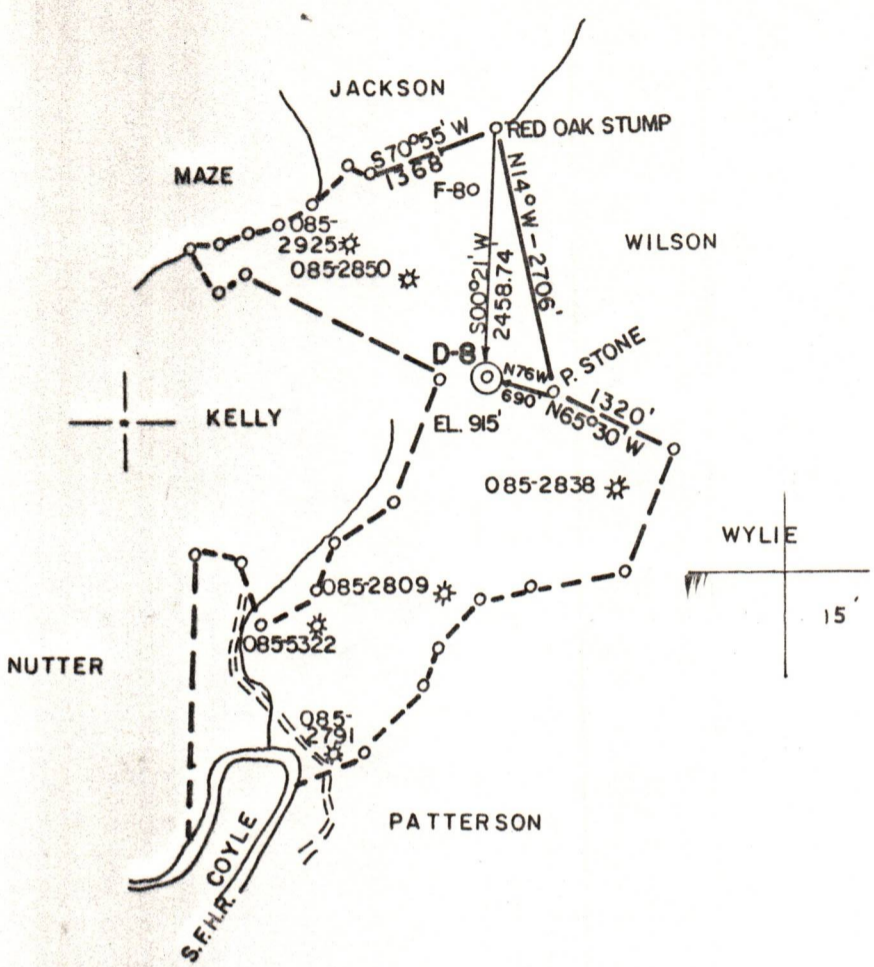

FILE NO. 82-82
 DRAWING NO. _____
 SCALE 1" = 2000'
 MINIMUM DEGREE OF ACCURACY 1/200'
 PROVEN SOURCE OF ELEVATION WELL #2850
(990.10')

I THE UNDERSIGNED, HEREBY CERTIFY THAT THIS PLAT IS CORRECT TO THE BEST OF MY KNOWLEDGE AND BELIEF AND SHOWS ALL THE INFORMATION REQUIRED BY LAW AND THE REGULATIONS ISSUED AND PRESCRIBED BY THE DEPARTMENT OF MINES.

(SIGNED) Chas Waterman
 R.P.E. 3788 L.L.S. _____

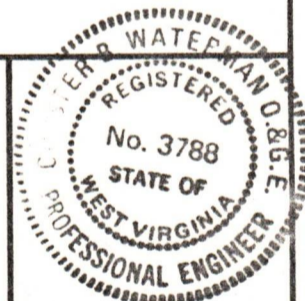

PLACE SEAL HERE

(+) DENOTES LOCATION OF WELL ON UNITED STATES TOPOGRAPHIC MAPS

FORM IV-6 (8-78)



DATE 3/15, 1982
 OPERATOR'S WELL NO. D-8
 API WELL NO. 47-085-5546
 STATE COUNTY PERMIT

STATE OF WEST VIRGINIA
 DEPARTMENT OF MINES
 OIL AND GAS DIVISION

WELL TYPE: OIL ___ GAS X LIQUID INJECTION ___ WASTE DISPOSAL ___
 (IF "GAS,") PRODUCTION X STORAGE ___ DEEP ___ SHALLOW ___
 LOCATION: ELEVATION 915 WATER SHED SOUTH FORK HUGHES RIVER
 DISTRICT MURPHY COUNTY RITCHIE
 QUADRANGLE MACFARLAN 7.5'
 SURFACE OWNER WESTVACO ACREAGE 372
 OIL & GAS ROYALTY OWNER M. GOLDEN HEIRS LEASE ACREAGE 372

08/18/2023

LEASE NO. _____

PROPOSED WORK: DRILL X CONVERT ___ DRILL DEEPER ___ REDRILL ___ FRACTURE OR STIMULATE ___ PLUG OFF OLD FORMATION ___ PERFORATE NEW FORMATION ___ OTHER PHYSICAL CHANGE IN WELL (SPECIFY) _____

PLUG AND ABANDON ___ CLEAN OUT AND REPLUG ___
 TARGET FORMATION MARCELLUS SHALE ESTIMATED DEPTH 5000'
 WELL OPERATOR ENERGY UNLIMITED DESIGNATED AGENT DAVID CLOVIS
 ADDRESS 427-2ND ST. MARIETTA, OH ADDRESS PARKERSBURG, WV