



Date: May 5, 19 82

Operator's Well No. Corbin #1

API Well No. 47 085 5611  
State County Permit

STATE OF WEST VIRGINIA  
DEPARTMENT OF MINES, OIL AND GAS DIVISION  
OIL AND GAS WELL PERMIT APPLICATION

WELL TYPE: Oil x / Gas x /  
(If "Gas", Production x / Underground storage \_\_\_\_\_ / Deep \_\_\_\_\_ / Shallow \_\_\_\_\_ /)

LOCATION: Elevation: 921' Watershed: WOLF Run  
District: Grant County: Ritchie Quadrangle: Scultz 7.5'

WELL OPERATOR RIMROCK PRODUCTION CORP. DESIGNATED AGENT ROBERT L. MURDOCK  
Address 4424-B EMERSON AVE. Address 4424-B EMERSON AVE.  
PARKERSBURG, W. VA. 26104 PARKERSBURG, W. VA. 26104

OIL & GAS ROYALTY OWNER M. Corbin, et al  
Address RT. 39 Box 196  
ST. MARY'S, W. VA  
Acreage 71 +/-

COAL OPERATOR none  
Address \_\_\_\_\_

SURFACE OWNER Martin Corbin  
Address SAME  
Acreage 71 +/-

COAL OWNER(S) WITH DECLARATION ON RECORD:  
Name none  
Address \_\_\_\_\_

FIELD SALE (IF MADE) TO:  
Address unknown

Name \_\_\_\_\_  
Address MAY - 7 1982

OIL & GAS INSPECTOR TO BE NOTIFIED  
Name William Blosser  
Address Rt. 4  
Fairmont, W. Va.  
363-9105

COAL LESSEE WITH DECLARATION ON RECORD:  
Name none  
Address \_\_\_\_\_

The undersigned well operator is entitled to operate for oil or gas purposes at the above location under a deed \_\_\_\_\_ / lease x other contract \_\_\_\_\_ / dated Dec. 1, 19 81, to the undersigned well operator from M. Corbin

(IF said deed, lease, or other contract has been recorded:)  
Recorded on \_\_\_\_\_, 19\_\_\_\_\_, in the office of the Clerk of the County Commission of \_\_\_\_\_ County, West Va., in Deed Book 171 at page 180. A permit is requested as follows:

PROPOSED WORK: Drill x / Drill deeper \_\_\_\_\_ / Redrill \_\_\_\_\_ / Fracture or stimulate \_\_\_\_\_ /  
Plug off old formation \_\_\_\_\_ / Perforate new formation \_\_\_\_\_ /  
Other physical change in well (specify) \_\_\_\_\_  
—planned as shown on the work order on the reverse side hereof.

The above named coal operator, coal owner(s), and coal lessee are hereby notified that any objection they wish to make or are required to make by Code §22-4-3 must be filed with the Department of Mines within fifteen (15) days after the receipt of this Application by the Department.

Copies of this Permit Application and the enclosed plat and reclamation plan have been mailed by registered mail or delivered by hand to the above named coal operator, coal owner(s), and coal lessee on or before the day of the mailing or delivery of this Permit Application to the Department of Mines at Charleston, West Virginia.

PLEASE SUBMIT COPIES OF ALL GEOPHYSICAL LOGS DIRECTLY TO:  
WEST VIRGINIA OIL AND GAS CONSERVATION COMMISSION  
1615 WASHINGTON STREET EAST CHARLESTON, WV 25311  
TELEPHONE: (304) 348-3092

04/19/2024  
RIMROCK PRODUCTION CORP.  
Well Operator  
By ROBERT L. MURDOCK  
Its PRESIDENT

BLANKET BOND

RECEIVED

OIL AND GAS DIVISION  
DEPARTMENT OF MINES

**PROPOSED WORK ORDER**

THIS IS AN ESTIMATE ONLY:  
ACTUAL INFORMATION MUST BE SUBMITTED ON FORM IV-35 UPON COMPLETION

DRILLING CONTRACTOR (IF KNOWN) UNKNOWN

Address \_\_\_\_\_

GEOLOGICAL TARGET FORMATION, ELK

Estimated depth of completed well, 5500' feet Rotary x / Cable tools \_\_\_\_\_ /

Approximate water strata depths: Fresh, 150' feet; salt, 0 feet.

Approximate coal seam depths: none Is coal being mined in the area? Yes \_\_\_\_\_ / No x /

**CASING AND TUBING PROGRAM**

CASING OR TUBING TYPE	SPECIFICATIONS					FOOTAGE INTERVALS		CEMENT FILL-UP OR SACKS (Cubic feet)	PACKERS
	Size	Grade	Weight per ft	New	Used	For drilling	Left in well		
Conductor	11-3/4	cw	45#	x		245'	245'	<del>40</del> <sup>CTS</sup> sx	Kinds
Fresh Water	8-5/8	erw	23#	x		1200'	1200'	<del>350</del> <sup>CTS</sup> sx	Baker
Coal									Sizes
Intermediate									
Production	4-1/2	erw	10.5#	x		0	5500'	350 sx	Depths set 4000'
Tubing	2-3/8	cw	4.7#	x		0	4000'	0	
Liners									Perforations: est. depth Top 3200' Bottom 5300'

NOTE: Regulation 7.02 of the Department of Mines provides that the original and four copies of Form IV-2 must be filed with the Department, accompanied by (i) a plat in the form prescribed by Regulation 11, (ii) a bond in one of the forms prescribed by Regulation 12, or in lieu thereof the other security allowed by Code § 22-4-2, (iii) Form IV-9, "Reclamation Plan", applicable to the reclamation required by Code § 22-4-12b and Regulation 23, (iv) unless previously paid on the same well, the fee required by Code § 22-4-12a, and (v) if applicable, the consent required by Code § 22-4-8a from the owner of any water well or dwelling within 200 feet of the proposed well.

A separate Form Iv-2 shall not be required for fracturing or stimulating a well where fracturing or stimulating is to be part of the work for which a permit is sought and is noted as such on the Form IV-2 filed in connection therewith.

**THIS PERMIT MUST BE POSTED AT THE WELL SITE**  
**ALL PROVISIONS BEING IN ACCORDANCE WITH CHAPTER 22,**  
**ARTICLE 4 OF THE W. VA. CODE, THE LOCATION IS HEREBY**  
 APPROVED FOR Drilling. **THIS PERMIT SHALL EXPIRE**  
**IF OPERATIONS HAVE NOT COMMENCED BY** 1-13-83.  
 BY [Signature]

The following waiver must be completed by the coal operator and by any coal owner or coal lessee who has recorded a declaration under Code 22-4-20, if the permit is to be issued within fifteen (15) days of receipt thereof.

**WAIVER**

The undersigned coal operator \_\_\_\_\_ / owner \_\_\_\_\_ / lessee \_\_\_\_\_ / of the coal under this well location has examined this proposed well location. If a mine map exists which covers the area of the well location, the well location has been added to the mine map. The undersigned has no objection to the work proposed to be done at this location, provided, the well operator has complied with all applicable requirements of the West Virginia Code and the governing regulations.

Date: \_\_\_\_\_, 19 \_\_\_\_\_

By \_\_\_\_\_  
Its \_\_\_\_\_

*file*

Department of Mines  
Oil and Gas Division

CONSTRUCTION AND RECLAMATION PLAN

COMPANY NAME RIMROCK PRODUCTION CORP. DESIGNATED AGENT ROBERT L. MURDOCK  
Address 4424A EMERSON AVE. PARKERSBURG W.V. 26101 Address 4424A EMERSON AVE. PARKERSBURG W.V.  
Telephone 304-428-1520 Telephone 304-428-1520  
LANDOWNER MARTIN CORBIN SOIL CONS. DISTRICT LITTLE KANAWHA  
Revegetation to be carried out by RIMROCK PRODUCTION CORP; (Agent)

This plan has been reviewed by Little Kanawha SCD. All corrections and additions become a part of this plan: 5-6-82 (Date)  
Jarrett Newton (SCD Agent)

ACCESS ROAD	LOCATION
Structure DRAINAGE DITCH Spacing Page Ref. Manual I:11	(A) Structure DIVERSION DITCH (1) Material EARTHEN Page Ref. Manual I:9
Structure DITCH RELIEF CROSS DRAIN Spacing 150' Page Ref. Manual I:4	(B) Structure SEDIMENT BARRIER (2) Material BRUSH OR LOGS Page Ref. Manual I:15
Structure CULVERT Spacing ONE 16" Page Ref. Manual I:7	(C) Structure Material MAY - 7 1982 Page Ref. Manual OIL AND GAS DIVISION DEPARTMENT OF MINES

RECEIVED

All structures should be inspected regularly and repaired if necessary. All commercial timber is to be cut and stacked and all brush and small timber to be cut and removed from the site before dirt work begins.

REVEGETATION

Treatment Area I & II	Treatment Area III
Lime _____ Tons/acre or correct to pH 6.5	Lime _____ Tons/acre or correct to pH _____
Fertilizer 600 lbs/acre (10-20-20 or equivalent)	Fertilizer _____ lbs/acre (10-20-20 or equivalent)
Mulch HAY 2 Tons/acre	Mulch _____ Tons/acre
Seed* KY-31 30 lbs/acre	Seed* _____ lbs/acre
CROWN VETCH 10 lbs/acre	_____ lbs/acre
_____ lbs/acre	_____ lbs/acre

\*Inoculate all legumes such as vetch, trefoil and clovers with the proper bacterium. Inoculate with 3X recommended amount.

04/19/2024

NOTES: Please request landowners' cooperation to protect new seedling for one growing season. Attach separate sheets as necessary for comments.

PLAN PREPARED BY SMITH LAND SURVEYING  
ADDRESS 111 SOUTH STREET  
GLENVILLE W.V. 26351  
PHONE NO. 304-462-5634

ATTACH OR PHOTOCOPY SECTION OF INVOLVED TOPOGRAPHIC MAP. QUADRANGLE SCHULTZ 7.5'

LEGEND











Well Site 

Access Road 

WELL SITE PLAN

Sketch to include well location, existing access road, roads to be constructed, wellsite, drilling pits and necessary structures numbered or lettered to correspond with the first part of this plan. Include all natural drainage.

LEGEND

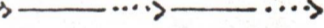
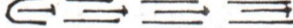
Property boundary 	Diversion 
Road 	Spring 
Existing fence 	Wet spot 
Planned fence 	Building 
Stream 	Drain pipe 
Open ditch 	Waterway 

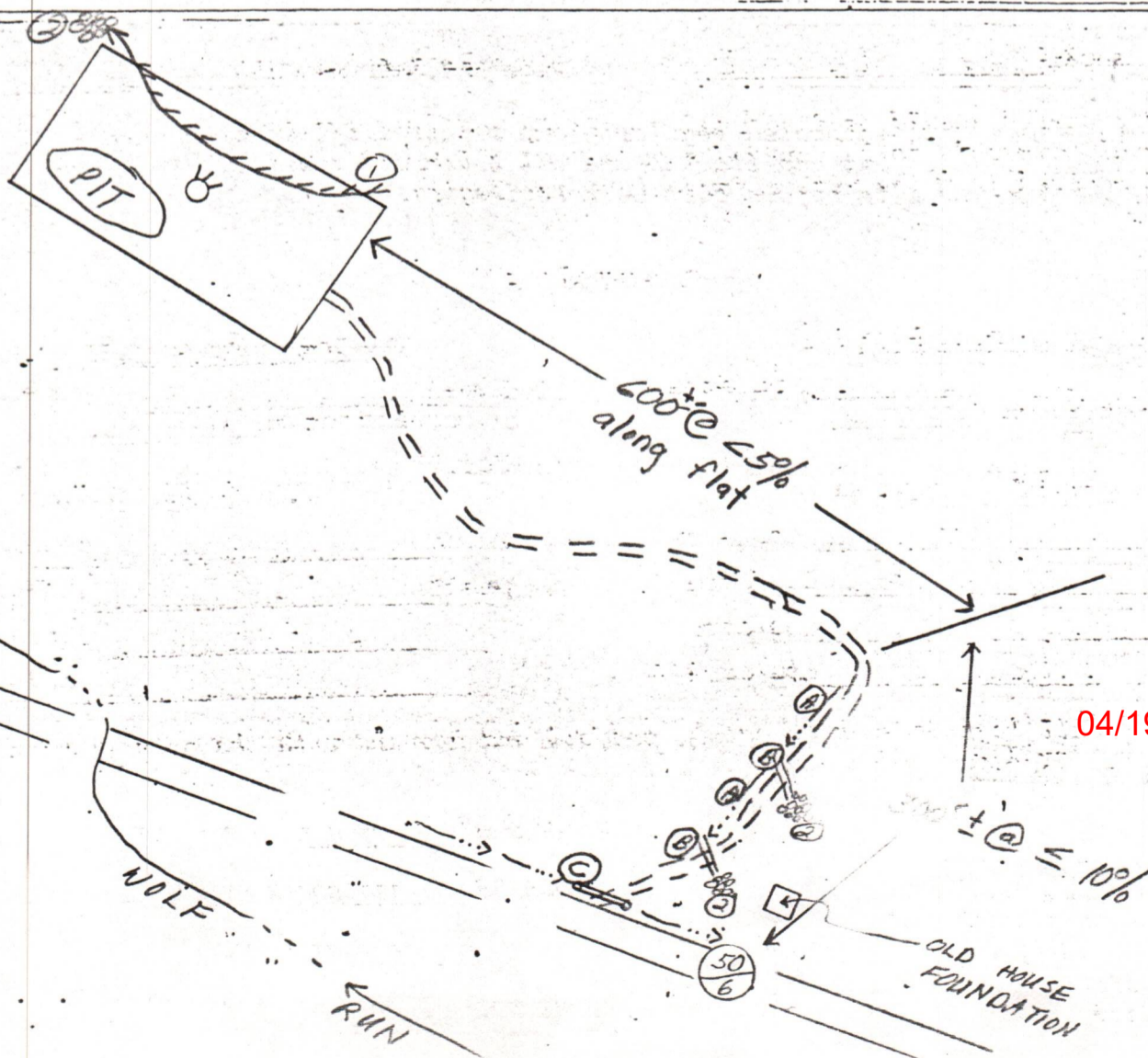



WDR #1

04/19/2024

PIKE (U.S. ALT. 50) 3.6 MI.  
ELLENBORO 5.6 MI.



DETAILS OF PERFORATED INTERVALS, FRACTURING OR STIMULATING, PHYSICAL CHANGE, ETC.

- Stage 1 - 4400' - 5490' - 43 holes - 975,000 SCF N<sub>2</sub>
- Stage 2 - 3550' - 4350' - 43 holes - 820,000 SCF N<sub>2</sub>
- Stage 3 - 2620' - 3490' - 46 holes - 897,000 SCF N<sub>2</sub>

WELL LOG

FORMATION	COLOR	HARD OR SOFT	TOP FEET	BOTTOM FEET	REMARKS
					Including indication of all fresh and salt water, coal, oil and gas
Sands & Shales			Surface	1500	
Sands & Shales			1500	1650	
Lime & Shales			1650	1792	
Big Injun Sand			1792	1800	
Sands, Silts, Shales			1800	2280	
Berea Sand			2280	2290	
Silt & Shale			2290	2550	
Gordon "Sand"			2550	2584	
Devonian Shale			2584	5548	

(Attach separate sheets as necessary)

RIMROCK PRODUCTION CORPORATION

Well Operator

04/19/2024

By: Alison Crane

*Alison Crane*

Date: May 24, 1982

Note: Regulation 2.02(i) provides as follows:  
"The term 'log' or 'well log' shall mean a systematic detailed geological record of all formations, including..."



RECEIVED

IV-35 (Rev 8-81)

JUL 26 1982

OIL AND GAS DIVISION WV DEPARTMENT OF MINES

State of West Virginia Department of Mines Oil and Gas Division

REVISED Date May 24, 1982 Operator's Well No. Martin Corbin #1 Farm Martin Corbin API No. 47 - 085 - 5611

WELL OPERATOR'S REPORT OF DRILLING, FRACTURING AND/OR STIMULATING, OR PHYSICAL CHANGE

WELL TYPE: Oil X/ Gas X/ Liquid Injection / Waste Disposal / (If "Gas," Production / Underground Storage / Deep / Shallow /)

LOCATION: Elevation: 921' Watershed Wolf Run District: Grant County Ritchie Quadrangle Schultz 7.5

COMPANY RIMROCK PRODUCTION CORPORATION

ADDRESS 4424 "B" Emerson Avenue, Parkersburg, WVA

DESIGNATED AGENT Robert L. Murdock

ADDRESS 4424 "B" Emerson, Parkersburg, WVA

SURFACE OWNER Martin Corbin

ADDRESS Box 221, Belmont, WVA 26134

MINERAL RIGHTS OWNER Martin Corbin

ADDRESS Box 221, Belmont, WVA 26134

OIL AND GAS INSPECTOR FOR THIS WORK

Deo Mace ADDRESS Sandridge, WVA

PERMIT ISSUED

DRILLING COMMENCED May 15, 1982

DRILLING COMPLETED May 21, 1982

IF APPLICABLE: PLUGGING OF DRY HOLE ON CONTINUOUS PROGRESSION FROM DRILLING OR REWORKING. VERBAL PERMISSION OBTAINED ON

Table with 4 columns: Casing & Tubing, Used in Drilling, Left in Well, Cement fill up Cu. ft. Rows include sizes 20-16, 13-10, 9 5/8, 8 5/8, 7, 5 1/2, 4 1/2, 3, 2 3/8 and Liners used.

GEOLOGICAL TARGET FORMATION Devonian Shale Depth 2620-5490 feet

Depth of completed well 5548 feet Rotary X / Cable Tools

Water strata depth: Fresh 300 feet; Salt feet

Coal seam depths: 0 Is coal being mined in the area? No

OPEN FLOW DATA

Producing formation Devonian Shale Pay zone depth 2620-5490 feet

Gas: Initial open flow 0 Mcf/d Oil: Initial open flow 0 Bbl/d

Final open flow 218 Mcf/d Final open flow 246 Bbl/d

Time of open flow between initial and final tests 8 hours

Static rock pressure 550 psig (surface measurement) after 8 hours shut in

(If applicable due to multiple completion--)

Second producing formation Pay zone depth feet

Gas: Initial open flow Mcf/d Oil: Initial open flow Bbl/d

Final open flow Mcf/d Oil: Final open flow Bbl/d

Time of open flow between initial and final tests hours

Static rock pressure psig (surface measurement) after hours shut in

04/19/2024

STATE OF WEST VIRGINIA  
 DEPARTMENT OF MINES  
 OIL AND GAS WELLS DIVISION

INSPECTOR'S WELL REPORT

Permit No. 85-9611

Oil or Gas Well \_\_\_\_\_  
 (KIND)

Company Pim Rock Prod.  
 Address \_\_\_\_\_  
 Farm Corbin  
 Well No 1  
 District Grant County Put  
 Drilling commenced \_\_\_\_\_  
 Drilling completed \_\_\_\_\_ Total depth \_\_\_\_\_  
 Date shot \_\_\_\_\_ Depth of shot \_\_\_\_\_  
 Initial open flow \_\_\_\_\_ /10ths Water in \_\_\_\_\_ Inch  
 Open flow after tubing \_\_\_\_\_ /10ths Merc. in \_\_\_\_\_ Inch  
 Volume \_\_\_\_\_ Cu. Ft.  
 Rock pressure \_\_\_\_\_ lbs. \_\_\_\_\_ hrs.  
 Oil \_\_\_\_\_ bbls., 1st 24 hrs.  
 Fresh water \_\_\_\_\_ feet \_\_\_\_\_ feet  
 Salt water \_\_\_\_\_ feet \_\_\_\_\_ feet

CASING AND TUBING	USED IN DRILLING	LEFT IN WELL	PACKERS
Size			
16			Kind of Packer _____
13			
10			Size of _____
8 1/4			
6 3/8			Depth set _____
5 3/16			
3			Perf. top _____
2			Perf. bottom _____
Liners Used			Perf. top _____
			Perf. bottom _____

CASING CEMENTED 5 1/8 SIZE 1049 No. FT. \_\_\_\_\_ Date 6-17-82

NAME OF SERVICE COMPANY Halibut HALIB.

COAL WAS ENCOUNTERED AT \_\_\_\_\_ FEET \_\_\_\_\_ INCHES  
 \_\_\_\_\_ FEET \_\_\_\_\_ INCHES \_\_\_\_\_ FEET \_\_\_\_\_ INCHES  
 \_\_\_\_\_ FEET \_\_\_\_\_ INCHES \_\_\_\_\_ FEET \_\_\_\_\_ INCHES

Drillers' Names S. W. JACK #13

Remarks: \_\_\_\_\_

5-18-82  
 DATE

D. S. Moore 04/19/2024  
 DISTRICT WELL INSPECTOR





STATE OF WEST VIRGINIA  
DEPARTMENT OF MINES  
OIL AND GAS WELLS DIVISION

RECEIVED

APR 25 1983

OIL & GAS DIVISION  
DEPT. OF MINES

INSPECTOR'S WELL REPORT

Permit No. 85-5611

Oil or Gas Well \_\_\_\_\_  
(KIND)

Company Rimrock Prod. Corp.  
 Address \_\_\_\_\_  
 Farm Martin Corbin  
 Well No. Martin Corbin #1  
 District Grant County Ritchie  
 Drilling commenced \_\_\_\_\_  
 Drilling completed \_\_\_\_\_ Total depth \_\_\_\_\_  
 Date shot \_\_\_\_\_ Depth of shot \_\_\_\_\_  
 Initial open flow \_\_\_\_\_ /10ths Water in \_\_\_\_\_ Inch  
 Open flow after tubing \_\_\_\_\_ /10ths Merc. in \_\_\_\_\_ Inch  
 Volume \_\_\_\_\_ Cu. Ft.  
 Rock pressure \_\_\_\_\_ lbs. \_\_\_\_\_ hrs.  
 Oil \_\_\_\_\_ bbls., 1st 24 hrs.  
 Fresh water \_\_\_\_\_ feet \_\_\_\_\_ feet  
 Salt water \_\_\_\_\_ feet \_\_\_\_\_ feet

CASING AND TUBING	USED IN DRILLING	LEFT IN WELL	PACKERS
Size			
16			Kind of Packer _____
13			
10			Size of _____
8 1/4			
6 5/8			Depth set _____
5 3/16			
3			Perf. top _____
2			Perf. bottom _____
Liners Used			Perf. top _____
			Perf. bottom _____

CASING CEMENTED \_\_\_\_\_ SIZE \_\_\_\_\_ No. FT. \_\_\_\_\_ Date \_\_\_\_\_  
 NAME OF SERVICE COMPANY \_\_\_\_\_  
 COAL WAS ENCOUNTERED AT \_\_\_\_\_ FEET \_\_\_\_\_ INCHES  
 \_\_\_\_\_ FEET \_\_\_\_\_ INCHES FEET \_\_\_\_\_ INCHES  
 \_\_\_\_\_ FEET \_\_\_\_\_ INCHES FEET \_\_\_\_\_ INCHES

Drillers' Names \_\_\_\_\_

Remarks: Final Inspection OK to Release

4-18-83  
DATE

Samuel N. Hersman  
DISTRICT WELL INSPECTOR

04/19/2024

Form 26  
2/16/82

STATE OF WEST VIRGINIA

DEPARTMENT OF MINES

04/19/2024

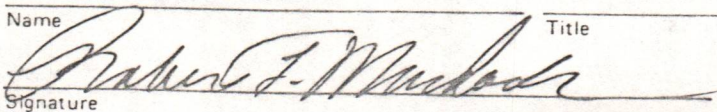
1.0 API well number: (If not available, leave blank. 14 digits.)	47 - 085 - 5611			
2.0 Type of determination being sought: (Use the codes found on the front of this form.)	107 Section of NGPA	High Cost Natural Gas Category Code		
3.0 Depth of the deepest completion location: (Only needed if sections 103 or 107 in 2.0 above.)	5548' feet			
4.0 Name, address and code number of applicant: (35 letters per line maximum. If code number not available, leave blank.)	Rimrock Production Corporation Name			_____ Seller Code
	4424 "B" Emerson Ave. Street			
	Parkersburg, City	WV State	26104 Zip Code	
5.0 Location of this well: [Complete (a) or (b).] (a) For onshore wells (35 letters maximum for field name.)	Glendale Field Field Name			
	Ritchie County	WV State		
(b) For OCS wells:	_____ Area Name	_____ Block Number		
	Date of Lease:           Mo. Day Yr.		_____ OCS Lease Number	
(c) Name and identification number of this well: (35 letters and digits maximum.)	Martin Corbin #1			
(d) If code 4 or 5 in 2.0 above, name of the reservoir: (35 letters maximum.)	_____			
6.0 (a) Name and code number of the purchaser: (35 letters and digits maximum. If code number not available, leave blank.)	Consolidated Gas Supply Name			_____ Buyer Code
	(b) Date of the contract:            Mo. Day Yr.			
(c) Estimated annual production:	78.48 MMcf.			
	(a) Base Price (\$/MMBTU)	(b) Tax	(c) All Other Prices [Indicate (+) or (-).]	(d) Total of (a), (b) and (c)
7.0 Contract price: (As of filing date. Complete to 3 decimal places.)	-----	-----	-----	-----
8.0 Maximum lawful rate: (As of filing date. Complete to 3 decimal places.)	-----	-----	-----	-----
9.0 Person responsible for this application:	Robert L. Murdock Name			
	President Title			
	 Signature			
	12-7-82 Date Application is Completed		(304) 428-1520 Phone Number	

Agency Use Only  
Date Received by Juris. Agency  
**JUN 14 1982**  
Date Received by FERC

04/19/2024

U.S. DEPARTMENT OF ENERGY  
Federal Energy Regulatory Commission  
Washington, D.C. 20426

**APPLICATION FOR DETERMINATION OF THE MAXIMUM LAWFUL  
PRICE UNDER THE NATURAL GAS POLICY ACT (NGPA)**  
(Sections 102, 103, 107 and 108)

**PLEASE READ BEFORE COMPLETING THIS FORM:**

General Instructions:

Complete this form if you are applying for price classification under sections 102, 103, 107 or 108 of the NGPA. A separate application is required for each well. If any reservoir qualifies for a category which differs from the category applicable to the producing well, separate applications must be made for the producing well and the reservoir. Complete each appropriate item on the reverse side of this page. The code numbers used in items 4.0 and 6.0 can be obtained from the Buyer/Seller Code Book. If there is more than one purchaser or contract, identify the additional information in the space below. Enter any additional remarks in the space below.

Submit the completed application to the appropriate Jurisdictional Agency as listed in title 18 of the CFR, part 270.103. If there are any questions, call (202) 275-4539.

Specific Instructions for Item 2.0, Type of Determination:

<u>Section of NGPA</u>	<u>Category Code</u>	<u>Description</u>
102	1	New OCS Lease
102	2	New onshore well (2.5 mile test)
102	3	New onshore well (1,000 feet deeper test)
102	4	New onshore reservoir
102	5	New reservoir on old OCS Lease
103	-	New onshore production well
107	-	High cost natural gas
108	-	Stripper well

Other Purchasers/Contracts:

<u>Contract Date</u> (Mo. Day Yr.)	<u>Purchaser</u>	<u>Buyer Code</u>
_____	Consolidated Gas Supply	_____
_____	445 W. Main Street	_____
_____	Clarksburg, WV 26302	_____

Remarks:

PARTICIPANTS:

DATE: DEC 3 1982

BUYER-SELLER CODE

WELL OPERATOR: Rimrock Production Corp.

FIRST PURCHASER: Columbia Gas Trans. Corp.

OTHER: Consolidated Gas Supply

004030

W. Va. Department of Mines, Oil & Gas Division  
 WELL DETERMINATION FILE NUMBER  
820614-107-085-5611  
 Use Above File Number on all Communications  
 Relating to Determination of this Well

**QUALIFIED**

CHECK EACH ITEM AS COMPLETE OR NOTE WHAT IS MISSING

ITEM NO.

1. FERC -121 1 Items not completed - Line No. All 7.0 + 8.0
2. IV-1 Agent ✓ Robert L. Murdock
3. IV-2 Well Permit \_\_\_\_\_
4. IV-6 Well Plat ✓
5. IV-35 Well Record ✓ Drilling ✓ Deepening -
6. IV-36 Gas-Oil Test: Gas Only - Was Oil Produced? - Ratio -
7. IV-39 Annual Production \_\_\_\_\_ years
8. IV-40 90 day Production \_\_\_\_\_ Days off line: -
9. IV-48 Application for certification. Complete? ✓
- 10-17. IV Form 51 - 52 - 53 - 54 - (55) - 56 - 57 - 58 Complete? ✓ Affidavit Signed ✓
- 18-28. Other: Survey \_\_\_\_\_ Logs \_\_\_\_\_ Geological Charts \_\_\_\_\_  
 Structure Map \_\_\_\_\_ 1: 4000 Map \_\_\_\_\_ Well Tabulations \_\_\_\_\_  
 Gas Analyses \_\_\_\_\_
- (1) Date commenced: 5-15-82 Date completed 5-21-82 Deepened -
- (5) Production Depth: 2620-5490
- (5) Production Formation: Devonia Shale
- (5) Final Open Flow: 218 MCF
- (5) After Frac. R. P. 550# 8hr.
- (6) Other Gas Test: \_\_\_\_\_
- (7) Avg. Daily Gas from Annual Production: \_\_\_\_\_
- (8) Avg. Daily Gas from 90-day ending w/1-120 days \_\_\_\_\_
- (8) Line Pressure: \_\_\_\_\_ PSIG from Daily Report: \_\_\_\_\_
- (5) Oil Production: \_\_\_\_\_ From Completion Report \_\_\_\_\_
- 10-17. Does lease inventory indicate enhanced recovery being done NO
- 10-17. Is affidavit signed? ✓ Notarized? ✓
- Does official well record with the Department confirm the submitted information 04/19/2024
- Additional information \_\_\_\_\_ Does computer program confirm? \_\_\_\_\_
- Was Determination Objected to \_\_\_\_\_ By Whom? \_\_\_\_\_

FORM 17-5540  
(12-78)

DEPARTMENT OF MINES OIL AND GAS DIVISION

Operator's  
Well No. M. Corbin #1

API Well No.  
47 - 085 - 5611  
State County Permit

WELL CLASSIFICATION FORM  
HIGH COST GAS WELL - DEVONIAN SHALE  
NGPA Section 107

DESIGNATED AGENT Robert L. Murdock  
ADDRESS 4424 "B" Emerson Ave.  
Parkersburg, WV 26104  
LOCATION Elevation 921'  
Watershed Wolfe Run  
Dist. Grant County Ritchie Quad. Schultz 7.5'  
Gas Purchase  
Contract No. \_\_\_\_\_  
Meter Chart Code \_\_\_\_\_  
Date of Contract \_\_\_\_\_

WELL OPERATOR Rimrock Production Corp.  
ADDRESS 4424 "B" Emerson Ave.  
Parkersburg, WV 26104  
GAS PURCHASER Consolidated Gas Supply  
ADDRESS 445 W. Main Street  
Clarksburg, WV 26302

\* \* \* \* \*

Date surface drilling began: May 15, 1982

Indicate the bottom hole pressure of the well and explain how this was calculated.

AFFIDAVIT

I, Robert L. Murdock, having been first sworn according to law, state that I have calculated the percentage of footage of the producing interval which is not Devonian Shale as indicated by a Gamma Ray index of less than 0.7 if a Gamma Ray log described in subparagraph (3)(i) or (3)(ii)(A) has been filed, or as indicated by the report described in subparagraph (3)(ii)(B); I have demonstrated that the percentage of potentially disqualifying non-shale footage is equal to or less than five (5) percent of the gross Devonian age interval; and I have no knowledge of any information not described in the application which is inconsistent with a conclusion that the well qualifies as a high-cost natural gas well.

Robert L. Murdock

STATE OF WEST VIRGINIA

COUNTY OF Wood, TO-WIT:

I, Linda R. Hamilton, a Notary Public in and for the state and county aforesaid, do certify that Robert L. Murdock, whose name is signed to the writing above, bearing date the 8th. day of December 8, 19 82, has acknowledged the same before me, in my county aforesaid.

04/19/2024

Given under my hand and official seal this 8th. day of December, 19 82.  
My term of office expires on the 3<sup>rd</sup> day of October, 19 89.

(NOTARIAL SEAL)

Linda R. Hamilton  
Notary Public  
Commission Expires October 3, 1989

# CORBIN WELL NO. 1 REVISED

## 71 ACRES ± TOTAL

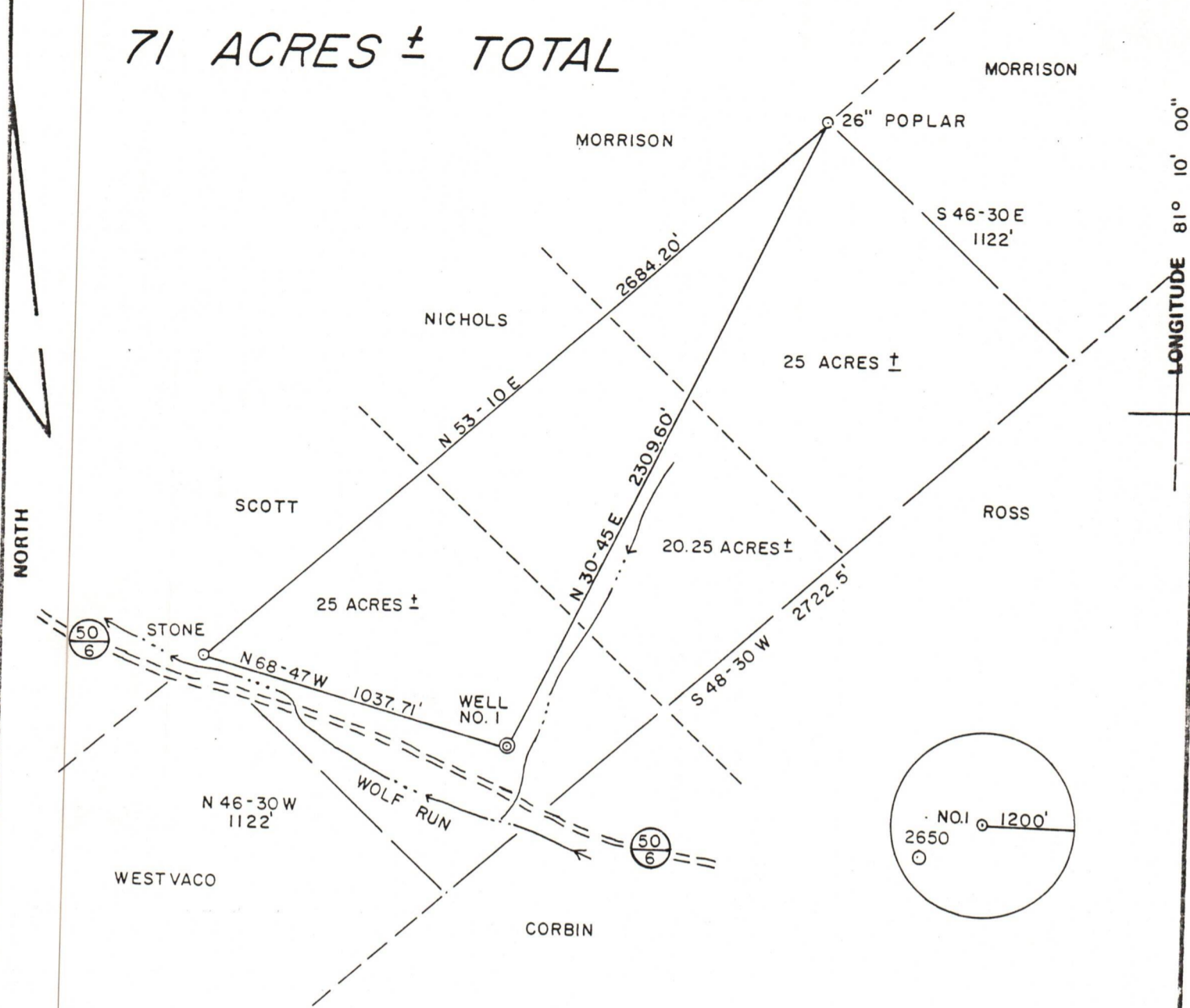

FILE NO. 7-25  
 DRAWING NO. \_\_\_\_\_  
 SCALE 1" = 500'  
 MINIMUM DEGREE OF ACCURACY 1/200  
 PROVEN SOURCE OF ELEVATION TOP OF KNOB  
 ELEV. 1046'

I THE UNDERSIGNED, HEREBY CERTIFY THAT THIS PLAT IS CORRECT TO THE BEST OF MY KNOWLEDGE AND BELIEF AND SHOWS ALL THE INFORMATION REQUIRED BY LAW AND THE REGULATIONS ISSUED AND PRESCRIBED BY THE DEPARTMENT OF MINES.  
 (SIGNED) Gregory A. Smith  
 R.P.E. \_\_\_\_\_ L.L.S. 677

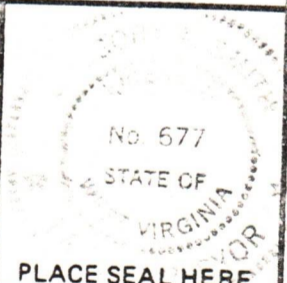

(+) DENOTES LOCATION OF WELL ON UNITED STATES TOPOGRAPHIC MAPS  
 FORM IV-6  
 (8-78)



DATE JULY 31, 19 82  
 OPERATOR'S WELL NO. 1  
 API WELL NO. \_\_\_\_\_  
47 095 - 5611 - Rev.  
 STATE COUNTY PERMIT

STATE OF WEST VIRGINIA  
 DEPARTMENT OF MINES  
 OIL AND GAS DIVISION

WELL TYPE: OIL \_\_\_ GAS X LIQUID INJECTION \_\_\_ WASTE DISPOSAL \_\_\_  
 (IF "GAS,") PRODUCTION X STORAGE \_\_\_ DEEP \_\_\_ SHALLOW X  
 LOCATION: ELEVATION 821' WATER SHED WOLF RUN  
 DISTRICT GRANT COUNTY RITCHIE  
 QUADRANGLE SCHULTZ 7.5'  
 SURFACE OWNER MARTIN CORBIN ACREAGE 70.25  
 OIL & GAS ROYALTY OWNER M. CORBIN, et. al. LEASE ACREAGE 70.25  
 LEASE NO. \_\_\_\_\_  
 PROPOSED WORK: DRILL X CONVERT \_\_\_ DRILL DEEPER \_\_\_ REDRILL \_\_\_ FRACTURE OR STIMULATE \_\_\_ PLUG OFF OLD FORMATION \_\_\_ PERFORATE NEW FORMATION \_\_\_ OTHER PHYSICAL CHANGE IN WELL (SPECIFY) \_\_\_\_\_  
 PLUG AND ABANDON \_\_\_ CLEAN OUT AND REPLUG \_\_\_  
 TARGET FORMATION ELK ESTIMATED DEPTH 5100'  
 WELL OPERATOR RIMROCK PRODUCTION CORP. DESIGNATED AGENT ROBERT L. MURDOCK  
 ADDRESS 4424 B EMERSON AVE. ADDRESS 4424 B EMERSON AVE.  
PARKERSBURG, W. V. 26101 PARKERSBURG, W. V. 26101

04/19/2024