



1) Date: March 11, 19 83
 2) Operator's Well No. Hoover #1
 3) API Well No. 47 State 085 County 6339 Permit

DRILLING CONTRACTOR:

STATE OF WEST VIRGINIA
DEPARTMENT OF MINES, OIL AND GAS DIVISION

Union Drilling, Inc.
P.O. Drawer 40
Buckhannon, WV 26201

OIL AND GAS WELL PERMIT APPLICATION

- 4) WELL TYPE: A Oil / Gas /
 B (If "Gas", Production / Underground storage / Deep / Shallow)
 5) LOCATION: Elevation: 895' Watershed: Tributary of Back Run
 District: Union County: Ritchie Quadrangle: Harrisville 7.5
 6) WELL OPERATOR Jenkins Energy Corp. 11) DESIGNATED AGENT Carlton Davis
 Address P.O. Box 980 Address P.O. Box 980
Bridgeport, WV 26330 Bridgeport, WV 26330
 7) OIL & GAS ROYALTY OWNER Prudence Wilson, et.al. 12) COAL OPERATOR None
 Address Harrisville, WV 26362 Address _____
 Acreage 125
 8) SURFACE OWNER Waneta Hoover 13) COAL OWNER(S) WITH DECLARATION ON RECORD: **RECEIVED**
 Address Harrisville, WV 26362 Name None
 Acreage 13.40 Address _____
 9) FIELD SALE (IF MADE) TO: Name _____
 Address _____
 10) OIL & GAS INSPECTOR TO BE NOTIFIED Name _____
 Name H. Paul Goodnight Address _____
 Address Smithville, WV 26178
 15) PROPOSED WORK: Drill / Drill deeper _____ / Redrill _____ / Fracture or stimulate _____
 Plug off old formation _____ / Perforate new formation _____
 Other physical change in well (specify) _____
 16) GEOLOGICAL TARGET FORMATION, Devonian Shale
 17) Estimated depth of completed well, 5875' feet
 18) Approximate water strata depths: Fresh, 300 feet; salt, no feet.
 19) Approximate coal seam depths: None Is coal being mined in the area? Yes _____ / No

20) CASING AND TUBING PROGRAM

| CASING OR TUBING TYPE | SPECIFICATIONS | | | | | FOOTAGE INTERVALS | | CEMENT FILL-UP OR SACKS (Cubic feet) | PACKERS |
|-----------------------|----------------|-------|----------------|-----|------|-------------------|--------------|--------------------------------------|---------------|
| | Size | Grade | Weight per ft. | New | Used | For drilling | Left in well | | |
| Conductor | 11 3/4 | | | | X | 75 | All | | Kinds |
| Fresh water | | | | | | | | | |
| Coal | | | | | | | | | Sizes |
| Intermediate | 8 5/8 | J-55 | | X | | 1,000 | To Surface | <u>Neat</u> | |
| Production | 4 1/2 | J-55 | | X | | 5875' | | 500 | Depths set |
| Tubing | | | | | | | | | |
| Liners | | | | | | | | | Perforations: |
| | | | | | | | | | Top Bottom |

- 21) EXTRACTION RIGHTS
 Check and provide one of the following:
 Included is the lease or leases or other continuing contract or contracts by which I hold the right to extract oil or gas.
 The requirement of Code 22-4-1-(c) (1) through (4). (See reverse side for specifics.)
 22) ROYALTY PROVISIONS
 Is the right to extract, produce or market the oil or gas based upon a lease or other continuing contract or contracts providing for flat well royalty or any similar provision for compensation to the owner of the oil or gas in place which is not inherently related to the volume of oil or gas so extracted, produced or marketed? Yes No
 If the answer above is No, nothing additional is needed. If the answer is Yes, you may use Affidavit Form IV-60.
 23) Required Copies (See reverse side.)
 24) Copies of this Permit Application and the enclosed plat and reclamation plan have been mailed by registered mail or delivered by hand to the above named coal operator, coal owner(s), and coal lessee on or before the day of the mailing or delivery of this Permit Application to the Department of Mines at Charleston, West Virginia.

Notary: Patricia L. Moore Signed: Carlton Davis
 My Commission Expires January 13, 1993 Its: Designated Agent

OFFICE USE ONLY
DRILLING PERMIT

Permit number 47-085-6339 Date March 18 1983
08/18/2023

This permit covering the well operator and well location shown below is evidence of permission granted to drill in accordance with the pertinent legal requirements subject to the conditions contained herein and on the reverse hereof. **Notification must be given to the District Oil and Gas Inspector. (Refer to No. 10) Prior to the construction of roads, locations and pits for any permitted work.** In addition, the well operator or his contractor shall notify the proper district oil and gas inspector 24 hours before actual permitted work has commenced.)

Permit expires November 18, 1983 unless drilling is commenced prior to that date and prosecuted with due diligence.
 Bond: BB Agent: lo Plat: [Signature] Casing: [Signature] Fee: 156
[Signature]
 Administrator, Office of Oil and Gas

Line Item Explanation

- 1) Date of Application
- 2) Your well name and number
- 3) To be filled out by office of oil & gas
- 4A) "Oil" means natural crude oil or petroleum and other hydrocarbons, regardless of gravity, which are produced at the well in liquid form by ordinary production methods and which are not the result of condensation of gas after it leaves underground reservoirs: "Gas" means all natural gas and all other fluid hydrocarbons not defined as oil.
- 4B) "Shallow well" means any well drilled and completed in a formation above the top of the uppermost member of the "Onondaga Group" or a depth less than six thousand feet, whichever is shallower.
"Deep well" means any well drilled and completed in a formation at or below the top of the uppermost member of the "Onondaga Group" or at a depth less than six thousand feet, whatever is shallower.
- 5) Where well is located
- 6) Before a permit can be issued in a corporation, company partnership, or fictitious name, the name must be registered with the Secretary of State Office
- 7) Use separate sheet if necessary
- 8) Present surface owner at time application is filed.
- 9) Optional
- 11) See Reg. 7.01 relating to code §22-4-1k
- 12) "Coal Operator" means any persons, firm, partnership, partnership association or corporation that proposes to or does operate a coal mine. See Note 24
- 13 & 14) As per §22-4-20; See Note 24
- 15) Work that will be attempted—A separate Form IV-2 shall not be required for fracturing or stimulating a well where fracturing or stimulating is to be part of the work for which a permit is sought and is noted as such on the Form IV-2 filed in connection therewith.
- 16) Anticipated formation for which well will be completed
- 17) Self explanatory
- 18) Depth to deepest freshwater, and shallowest salt water, taken from nearby wells corrected for differences in elevation
- 19) All coal seam depths
- 20) Proposed casing program and cementing refer to Code 22-4-5, 22-4-6, 22-4-7, 22-4-8, 22-4-8a Reg 9.01, 15.01, 15.02, 15.03, 15.04, 25.01, 25.02, 25.03, 25.04
- 21) Code 22-4-11(c) - In lieu of filing the lease or leases or other continuing contract or contracts, the applicant for a permit described herein may file the following:
 - (1) A brief description of the tract of land including the district and county wherein the tract is located;
 - (2) The identification of all parties to all leases or other continuing contractual agreements by which the right to extract, produce or market the oil or gas is claimed;
 - (3) The book and page number wherein each such lease or contract by which the right to extract, produce or market the oil or gas is recorded;
 - (4) A brief description of the royalty provisions of each such lease or contract.
- 22) Code 22-4-11(d) and 22-4-11(e).
- 23) Regulation 7.02 of the Department of Mines provides that the original and four copies of Form IV-2 must be filed with the Department, accompanied by (i) a plat in the form prescribed by Regulation 11, (ii) a bond in one of the forms prescribed by Regulation 12, or in lieu thereof the other security allowed by Code §22-4-2, (iii) Form IV-9, "Reclamation Plan", applicable to the reclamation required by Code §22-4-12b and Regulation 23, (iv) unless previously paid on the same well, the fee required by Code §22-4-12a, and (v) if applicable, the consent required by Code §22-4-8a from the owner of any water well or dwelling within 200 feet of the proposed well.
- 24) **The above named coal operator, coal owner(s), and coal lessee are hereby notified that any objection they wish to make or are required to make by Code §22-4-3 must be filed with the Department of Mines within fifteen (15) days after the receipt of this Application by the Department.**

The following waiver must be completed by the coal operator and by any coal owner or coal lessee who has recorded a declaration under Code 22-4-20, if the permit is to be issued within fifteen (15) days of receipt thereof.

WAIVER

The undersigned coal operator _____/ owner _____/ lessee _____/ of the coal under this well location has examined this proposed well location. If a mine map exists which covers the area of the well location, the well location has been added to the mine map. The undersigned has no objection to the work proposed to be done at this location, provided, the well operator has complied with all applicable requirements of the West Virginia Code and the governing regulations.

08/18/2023

Date: _____, 19_____

By _____

Its _____

ATTACH OR PHOTOCOPY SECTION OF INVOLVED TOPOGRAPHIC MAP. QUADRANGLE _____

LEGEND





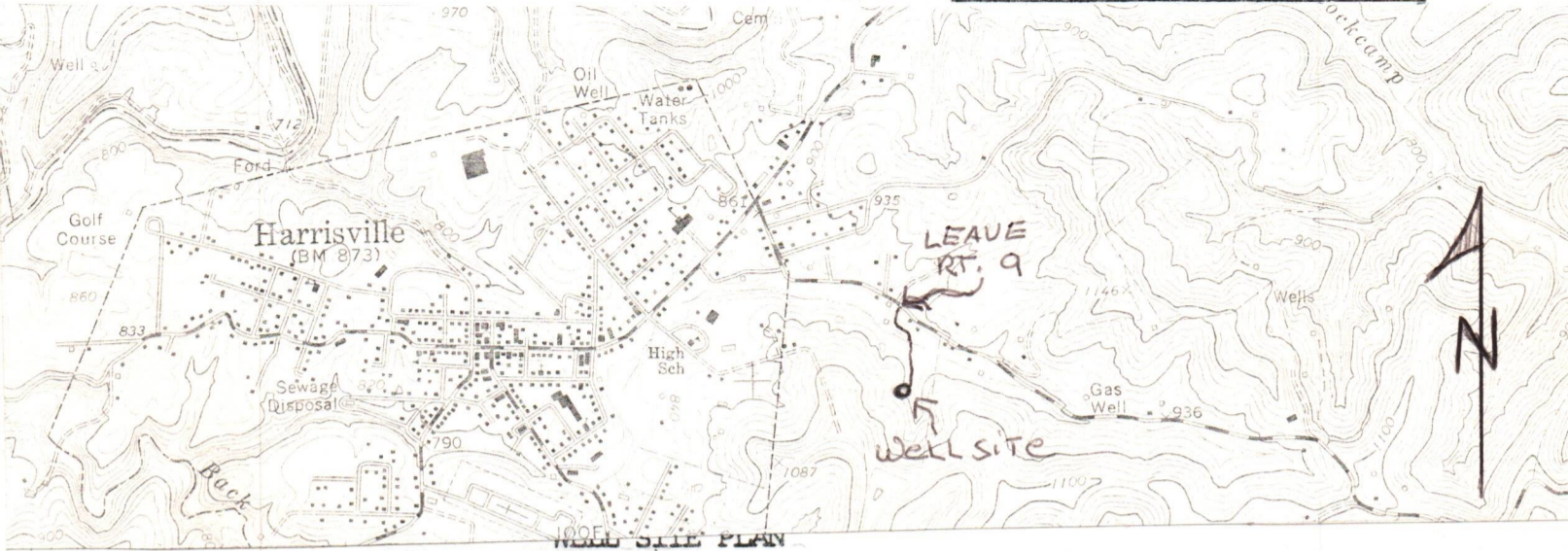



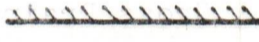

Well Site 

Access Road 

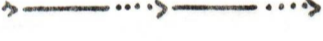

Sketch to include well location, existing access road, roads to be constructed, wellsite, drilling pits and necessary structures numbered or lettered to correspond with the first part of this plan. Include all natural drainage.

LEGEND

| | |
|---|--|
| Property boundary  | Diversion  |
| Road  | Spring  |
| Existing fence  | Wet spot  |
| Planned fence  | Building  |
| Stream  | Drain pipe  |
| Open ditch  | Waterway  |

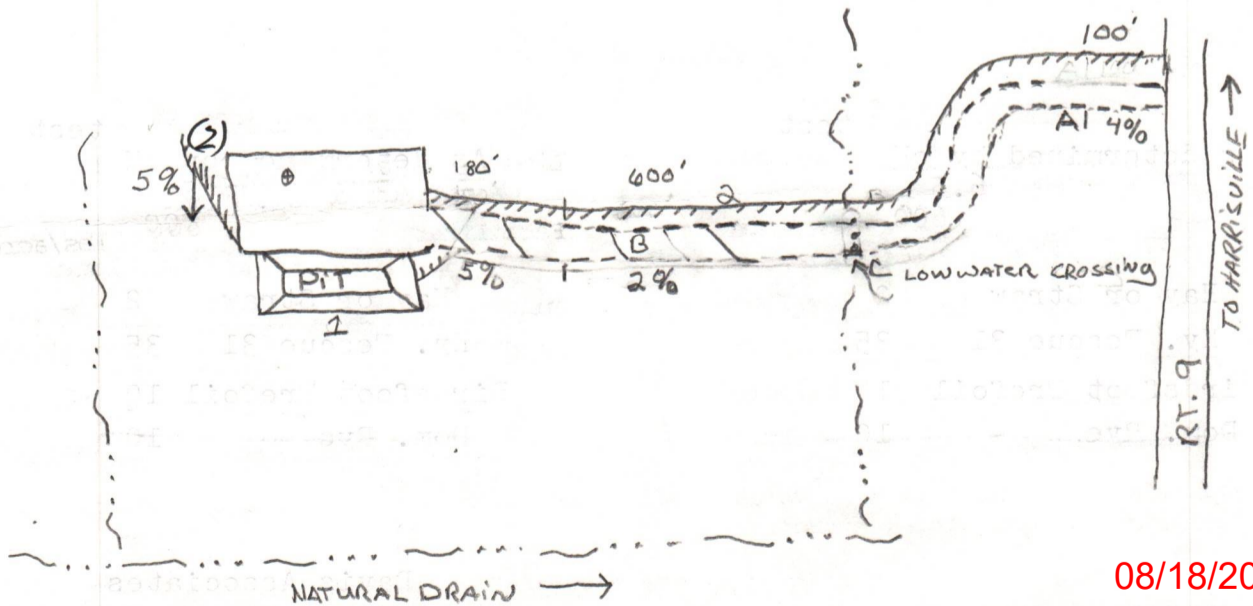

08/18/2023



IV-9
(Rev 8-81)

DATE March 11, 1983
WELL NO. Hoover #1
API NO. 047 - 085 - 6339

State of West Virginia
Department of Mines
Oil and Gas Division

CONSTRUCTION AND RECLAMATION PLAN

COMPANY NAME Jenkins Energy Cor. DESIGNATED AGENT Carlton Davis
Address P.O. Box 980, Bridgeport, WV Address P.O. Box 980, Bridgeport, WV
Telephone 304-622-3837 Telephone 304-622-3837 26330
LANDOWNER Waneta Hoover SOIL CONS. DISTRICT Little Kanawha
Revegetation to be carried out by Jenkins Energy Corp.-Carlton Davis (Agent)

This plan has been reviewed by Little Kanawha SCD. All corrections and additions become a part of this plan: 3-15-83

(Date)
Jarrett Newton
(SCD Agent)

| ACCESS ROAD | LOCATION |
|--|--|
| Structure <u>Rip-Rap</u> Spacing _____ Page Ref. Manual <u>2-14</u> | (A) Structure <u>Temporary Sed. Basin</u> (1) Material <u>Earthen</u> Page Ref. Manual <u>2-22</u> |
| Structure <u>Cross Drains</u> Spacing <u>2%-250', 5%-135', 4%-150'</u> Page Ref. Manual <u>2-4</u> | (B) Structure <u>Diversion Drainage Ditch</u> (2) Material <u>Earthen</u> Page Ref. Manual <u>2-12</u> |
| Structure <u>Low Water Crossing</u> Spacing _____ Page Ref. Manual <u>2-20</u> | (C) Structure _____ (3) Material _____ Page Ref. Manual _____ |

All structures should be inspected regularly and repaired if necessary. All commercial timber is to be cut and stacked and all brush and small timber to be cut and removed from the site before dirt work begins.

REVEGETATION

Treatment Area I test
 Lime As determined by pH 6.5 Tons/acre
 or correct to pH 6.5
 Fertilizer 600 lbs/acre
 (10-20-20 or equivalent)
 Mulch Hay or Straw 2 Tons/acre
 Seed* Ky. Fescue 31 35 lbs/acre
Birdsfoot Trefoil 10 lbs/acre
Dom. Rye 10 lbs/acre

Treatment Area II test
 Lime As determined by pH 6.5 Tons/acre
 or correct to pH 6.5
 Fertilizer 600 lbs/acre
 (10-20-20 or equivalent)
 Mulch Hay or Straw 2 Tons/acre
 Seed* Ky. Fescue 31 35 lbs/acre
Birdsfoot Trefoil 10 lbs/acre
Dom. Rye 10 lbs/acre

*Inoculate all legumes such as vetch, trefoil and clovers with the proper bacterium. Inoculate with 3X recommended amount.

PLAN PREPARED BY Davis Associates 08/18/2023
ADDRESS P.O. Box 841
Bridgeport, WV 26330
PHONE NO. 304-623-5371

NOTES: Please request landowner's cooperation to protect new seedling for one growing season. Attach separate sheets as necessary for comments.

LB 154

83

THIS INSTRUMENT dated the 28th day of December, 1982, by and between H. DAVIS JENKINS, party of the first part, and JENKINS ENERGY CORPORATION, party of the second part.

WITNESSETH: That for and in consideration of the sum of One Dollar (\$1.00), cash in hand paid by the party of the second part unto the said party of the first part, the receipt of which is hereby acknowledged, the said party of the first part does hereby assign, transfer, and set over unto the said JENKINS ENERGY CORPORATION, party of the second part, that certain lease and leasehold estate originally said to contain 212 acres, and now embracing approximately 125 acres, more or less, situate on the Waters of Rock Camp in Union District, Ritchie County, West Virginia, heretofore assigned unto DAVID G. HANLON by instrument dated the 20th day of December, 1982, of record in the Office of the Clerk of the County Commission of Ritchie County, West Virginia, in Lease Book 152, at Page 57. There is excepted and reserved from this assignment for the benefit of DAVID G. HANLON, his heirs and assigns, a one-thirty-second (1/32) overriding royalty interest therein, free and clear of all costs of production - making this assignment of 84.375% net interest being assigned to the party of the second part. This assignment is made by the party of first part without any warrenty either express or implied.

WITNESS the following signature and seal as of the day and year first above written.

 (SEAL)
H. DAVIS JENKINS

State of West Virginia,
County of Ritchie, to wit;

I, Garold W. Morris, II a statewide notary public do hereby certify that H. Dais Jenkins, whose name is signed to the writing above, bearing date the 28th of December, 1982, has this day acknowledged the same before me in this said County and State. Given under my hand this 25th day of January, 1983. My commission expires August 13, 1990.

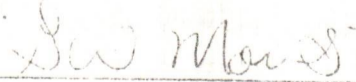
 08/18/2023
Statewide Notary Public

Prepared By: Jenkins Energy Corp.

Very Light Copy

LB 154

83

THIS INSTRUMENT dated the 28th day of December, 1982, by and between H. DAVIS JENKINS, party of the first part, and JENKINS ENERGY CORPORATION, party of the second part.

WITNESSETH: That for and in consideration of the sum of One Dollar (\$1.00), cash in hand paid by the party of the second part unto the said party of the first part, the receipt of which is hereby acknowledged, the said party of the first part does hereby assign, transfer, and set over unto the said JENKINS ENERGY CORPORATION, party of the second part, that certain lease and leasenold estate originally said to contain 212 acres, and now embracing approximately 125 acres, more or less, situate on the Waters of Rock Camp in Union District, Ritchie County, West Virginia, heretofore assigned unto DAVID G. HANLON by instrument dated the 20th day of December, 1982, of record in the Office of the Clerk of the County Commission of Ritchie County, West Virginia, in Lease book 152, at Page 57. There is excepted and reserved from this assignment for the benefit of DAVID G. HANLON, his heirs and assigns, a one-thirty-second (1/32) overriding royalty interest therein, free and clear of all costs of production - making this assignment of 84.375% net interest being assigned to the party of the second part. This assignment is made by the party of first part without any warrenty either express or implied.

WITNESS the following signature and seal as of the day and year first above written.

 (SEAL)
H. DAVIS JENKINS

State of West Virginia,
County of Ritchie, to wit;

I, Garold W. Morris, II a statewide notary public do hereby certify that H. Davis Jenkins, whose name is signed to the writing above, bearing date the 28th of December, 1982, has this day acknowledged the same before me in this said County and State. Given under my hand this 25th day of January, 1983. My commission expires August 13, 1990.

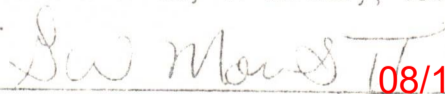
Statewide Notary Public

08/18/2023

Prepared By: Jenkins Energy Corp.

LB 154
83

THIS INSTRUMENT dated the 28th day of December, 1982, by and between H. DAVIS JENKINS, party of the first part, and JENKINS ENERGY CORPORATION, party of the second part.

WITNESSETH: That for and in consideration of the sum of One Dollar (\$1.00); cash in hand paid by the party of the second part unto the said party of the first part, the receipt of which is hereby acknowledged, the said party of the first part does hereby assign, transfer, and set over unto the said JENKINS ENERGY CORPORATION, party of the second part, that certain lease and leasenold estate originally said to contain 212 acres, and now embracing approximately 125 acres, more or less, situate on the Waters of Rock Camp in Union District, Ritchie County, West Virginia, heretofore assigned unto DAVID G. HANLON by instrument dated the 20th day of December, 1982, of record in the Office of the Clerk of the County Commission of Ritchie County, West Virginia, in Lease book 152, at Page 57. There is excepted and reserved from this assignment for the benefit of DAVID G. HANLON, his heirs and assigns, a one-thirty-second (1/32) overriding royalty interest therein, free and clear of all costs of production - making this assignment of 84.375% net interest being assigned to the party of the second part. This assignment is made by the party of first part without any warrenty either express or implied.

WITNESS the following signature and seal as of the day and year first above written.



H. DAVIS JENKINS (SEAL)

State of West Virginia,
County of Ritchie, to wit;

I, Garold W. Morris, II a statewide notary public do hereby certify that H. Davis Jenkins, whose name is signed to the writing above, bearing date the 28th of December, 1982, has this day acknowledged the same before me in this said County and State. Given under my hand this 25th day of January, 1983. My commission expires August 13, 1990.

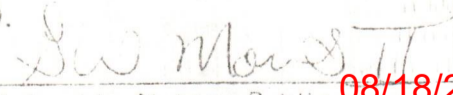

Statewide Notary Public 08/18/2023

Prepared By: Jenkins Energy Corp.

RECEIVED

DETAILS OF PERFORATED INTERVALS, FRACTURING OR STIMULATING, PHYSICAL CHANGE, ETC.

3 stages with total Nitrogen 2.8m mscf. Forty holes per stage.

- Perf 40 Holes 5457-5673 - Stimulate with 800,000 standard cubic feet of Nitrogen
- Perf 40 Holes 4007-4690 - Stimulate with 1,000,000 standard cubic feet of Nitrogen
- Perf 40 Holes 3543-53 - Stimulate with 1,000,000 standard cubic feet of Nitrogen

WELL LOG

| FORMATION | COLOR | HARD OR SOFT | TOP FEET | BOTTOM FEET | REMARKS Including indication of all fresh and salt water, coal, oil and gas |
|--|-------|--------------|------------|----------------|--|
| Top Soil, Surface Clay, Sand Shale and Lime Streaks Big Lime | | | 0 1,718 | 1,718 1,850 | |
| Big Injun | | | 1,850 | 1,952 | oil & gas |
| Weir Sandy Shale | | | 2,220 | 2,320 | oil & gas |
| Gantz | | | 2,440 | 2,470 | |
| Gordon | | | 2,610 | 2,665 | gas |
| Fifth Sand | | | 2,820 | 2,830 | gas |
| Brallier Shale | | | 2,970 | 3,323 | gas |
| Warren Shale | | | 3,323 | 3,390 | gas & oil |
| Brallier Shale | | | 3,390 | 4,010 | oil & gas |
| Harrell Shale | | | 4,010 | 4,688 | gas |
| Benson Sand | | | 4,688 | 4,708 | gas |
| Alexander Sand | | | 4,800 | 4,910 | gas |
| Hamilton | | | 5,068 | 5,778 | gas |

(Attach separate sheets as necessary)

Jenkins Energy Corp.
Well Operator
By: John Mitchell 08/18/2023
Date: 11-10-83

Note: Regulation 2.02(i) provides as follows:
"The term 'log' or 'well log' shall mean a systematic detailed geological record of all formations, including coal, encountered in the drilling of a well."

RECEIVED

DEC 1 2 1983



IV-35 (Rev 8-81)

OIL & GAS DIVISION DEPT. OF MINES State of West Virginia

Department of Mines Oil and Gas Division

Date June 1, 1983 Operator's Well No. One (1) Farm Hoover API No. 47 - 085 - 6339

WELL OPERATOR'S REPORT OF

DRILLING, FRACTURING AND/OR STIMULATING, OR PHYSICAL CHANGE

RECEIVED JAN 30 1984

OIL & GAS DIVISION

DEPT. OF MINES

WELL TYPE: Oil X / Gas X / Liquid Injection / Waste Disposal (If "Gas," Production X / Underground Storage / Deep / Shallow /)

LOCATION: Elevation: 895 G.L. Watershed Back Run District: Union County Ritchie Quadrangle Harrisville, 7.5

COMPANY Jenkins Energy Corp. ADDRESS P.O. Box 980, Bridgeport, W.Va. 26330 DESIGNATED AGENT Carlton Davis ADDRESS P.O. Box 980, Bridgeport, W.Va. 26330 SURFACE OWNER W. Hoover ADDRESS Harrisville, W.Va. MINERAL RIGHTS OWNER W. Hoover ADDRESS Harrisville, W.Va. OIL AND GAS INSPECTOR FOR THIS WORK Samuel Hersman ADDRESS Smithville, W.Va. PERMIT ISSUED February, 1983 DRILLING COMMENCED March 21, 1983 DRILLING COMPLETED March 29, 1983

Table with 4 columns: Casing & Tubing, Used in Drilling, Left in Well, Cement fill up Cu. ft. Rows include sizes 20-16, 13-10, 9 5/8, 8 5/8, 7, 5 1/2, 4 1/2, 3, 2, and Liners used.

IF APPLICABLE: PLUGGING OF DRY HOLE ON CONTINUOUS PROGRESSION FROM DRILLING OR REWORKING. VERBAL PERMISSION OBTAINED ON

GEOLOGICAL TARGET FORMATION Hamilton Shale Depth 5,990 feet Depth of completed well 5,775 feet Rotary / Cable Tools Water strata depth: Fresh 80 feet; Salt 850 feet Coal seam depths: -- Is coal being mined in the area? --

OPEN FLOW DATA

Producing formation Hamilton Shale Pay zone depth 5,670 feet Gas: Initial open flow show Mcf/d Oil: Initial open flow -0- Bbl/d Final open flow 475 Mcf/d Oil: Final open flow -0- Bbl/d Time of open flow between initial and final tests 4 hours Static rock pressure 925 psig (surface measurement) after 72 hours shut in (If applicable due to multiple completions) 08/18/2023 Second producing formation Harrell-Benson Pay zone depth 4,955 feet Gas: Initial open flow show Mcf/d Oil: Initial open flow show Bbl/d Final open flow 300 Mcf/d Oil: Final open flow show Bbl/d Time of open flow between initial and final tests -- hours Static rock pressure -- psig (surface measurement) after -- hours shut in

(Continue on reverse side)

RT 6339

STATE OF WEST VIRGINIA
DEPARTMENT OF MINES
OIL AND GAS WELLS DIVISION

RECEIVED

APR 5 - 1983

OIL AND GAS DIVISION
WV DEPARTMENT OF MINES

INSPECTOR'S WELL REPORT

Permit No. 85-6339

Oil or Gas Well _____
(KIND)

| | | | | |
|---|---|------------------|--------------|----------------------|
| Company <u>Jenkins Energy Corp.</u> | CASING AND TUBING | USED IN DRILLING | LEFT IN WELL | PACKERS |
| Address _____ | Size | | | |
| Farm <u>Waneta Hoover</u> | 16 | | | Kind of Packer _____ |
| Well No. <u>Hoover #1</u> | 13 | | | |
| District <u>Union</u> County <u>Ritchie</u> | 10 | | | Size of _____ |
| Drilling commenced <u>3-22-83</u> | 8 1/4 | | | |
| Drilling completed <u>3-30-83</u> Total depth <u>5775</u> | 6 5/8 | | | Depth set _____ |
| Date shot _____ Depth of shot _____ | 5 3/16 | | | |
| Initial open flow _____ /10ths Water in _____ Inch | 3 | | | Perf. top _____ |
| Open flow after tubing _____ /10ths Merc. in _____ Inch | 2 | | | Perf. bottom _____ |
| Volume _____ Cu. Ft. | Liners Used | | | Perf. top _____ |
| Rock pressure _____ lbs. _____ hrs. | | | | Perf. bottom _____ |
| Oil _____ bbls., 1st 24 hrs. | CASING CEMENTED _____ SIZE _____ No. FT. _____ Date _____ | | | |
| Fresh water _____ feet _____ feet | NAME OF SERVICE COMPANY _____ | | | |
| Salt water _____ feet _____ feet | COAL WAS ENCOUNTERED AT _____ FEET _____ INCHES | | | |
| | _____ FEET _____ INCHES _____ FEET _____ INCHES | | | |
| | _____ FEET _____ INCHES _____ FEET _____ INCHES | | | |

Drillers' Names _____

Remarks: Ran 5726' foot of 4 1/2" casing - Halliburton ran 675 sacks cement mix

3-30-82
DATE

Samuel N. H. 08/18/2023
DISTRICT WELL INSPECTOR

STATE OF WEST VIRGINIA
DEPARTMENT OF MINES
OIL AND GAS WELLS DIVISION

RECEIVED

INSPECTOR'S WELL REPORT

MAR 29 1983

Permit No. 85-6339

OIL AND GAS WELLS DIVISION
DEPARTMENT OF MINES

| | | | | |
|---|---|------------------|--------------|----------------------|
| Company <u>Jenkins Energy Corp.</u> | CASING AND TUBING | USED IN DRILLING | LEFT IN WELL | PACKERS |
| Address _____ | Size | | | |
| Farm <u>Wanita Hoover</u> | 16 | | | Kind of Packer _____ |
| Well No. <u>Hoover # 1</u> | 13 | | | |
| District <u>Union</u> County <u>Ritchie</u> | 10 | | | Size of _____ |
| Drilling commenced _____ | 8 1/4 | | | |
| Drilling completed _____ Total depth _____ | 6 5/8 | | | Depth set _____ |
| Date shot _____ Depth of shot _____ | 5 3/16 | | | |
| Initial open flow _____ /10ths Water in _____ Inch | 3 | | | Perf. top _____ |
| Open flow after tubing _____ /10ths Merc. in _____ Inch | 2 | | | Perf. bottom _____ |
| Volume _____ Cu. Ft. | Liners Used _____ | | | Perf. top _____ |
| Rock pressure _____ lbs. _____ hrs. | | | | Perf. bottom _____ |
| Oil _____ bbls., 1st 24 hrs. | CASING CEMENTED _____ SIZE _____ No. FT. _____ Date _____ | | | |
| Fresh water _____ feet _____ feet | NAME OF SERVICE COMPANY _____ | | | |
| Salt water _____ feet _____ feet | COAL WAS ENCOUNTERED AT _____ FEET _____ INCHES | | | |
| | _____ FEET _____ INCHES _____ FEET _____ INCHES | | | |
| | _____ FEET _____ INCHES _____ FEET _____ INCHES | | | |

Drillers' Names _____

Remarks: Visit location site = Road graveled to edge of location
Location made - Preparing to make pit

3-21-83
DATE

Samuel N. Hoover 08/18/2023
DISTRICT WELL INSPECTOR

STATE OF WEST VIRGINIA
DEPARTMENT OF MINES
OIL AND GAS WELLS DIVISION

RECEIVED

MAR 29 1983

OIL AND GAS DIVISION
WV DEPARTMENT OF MINES

INSPECTOR'S WELL REPORT

Permit No. 85-6339

Oil or Gas Well _____
(KIND)

| | | | | |
|---|---|------------------|--------------|----------------------|
| Company <u>Jenkins Energy Corp.</u> | CASING AND TUBING | USED IN DRILLING | LEFT IN WELL | PACKERS |
| Address _____ | Size | | | |
| Farm <u>Waneta Hoover</u> | 16 | | | Kind of Packer _____ |
| Well No. <u>Hoover #1</u> | 13 | | | |
| District <u>Union</u> County <u>Ritchie</u> | 10 | | | Size of _____ |
| Drilling commenced <u>2-22-83</u> | 8 1/4 | | | |
| Drilling completed _____ Total depth _____ | 6 5/8 | | | Depth set _____ |
| Date shot _____ Depth of shot _____ | 5 3/16 | | | |
| Initial open flow _____ /10ths Water in _____ Inch | 3 | | | Perf. top _____ |
| Open flow after tubing _____ /10ths Merc. in _____ Inch | 2 | | | Perf. bottom _____ |
| Volume _____ Cu. Ft. | Liners Used | | | Perf. top _____ |
| Rock pressure _____ lbs. _____ hrs. | | | | Perf. bottom _____ |
| Oil _____ bbls., 1st 24 hrs. | CASING CEMENTED _____ SIZE _____ No. FT. _____ Date _____ | | | |
| Fresh water _____ feet _____ feet | NAME OF SERVICE COMPANY _____ | | | |
| Salt water _____ feet _____ feet | COAL WAS ENCOUNTERED AT _____ FEET _____ INCHES | | | |
| | _____ FEET _____ INCHES _____ FEET _____ INCHES | | | |
| | _____ FEET _____ INCHES _____ FEET _____ INCHES | | | |

Drillers' Names _____

Remarks: Visit - 246 foot deep. - set 1 joint of 11 3/4" casing 39 foot long for conductor

3-23-83
DATE

Samuel N. [Signature]
08/18/2023
DISTRICT WELL INSPECTOR

STATE OF WEST VIRGINIA
DEPARTMENT OF MINES
OIL AND GAS WELLS DIVISION

RECEIVED

MAR 29 1983

OIL AND GAS DIVISION
WV DEPARTMENT OF MINES

INSPECTOR'S WELL REPORT

Permit No. 85-6339

Oil or Gas Well _____
(KIND)

Company Jenkins Energy Corp.
 Address _____
 Farm Waneta Hoover
 Well No. Hoover #1
 District Union County Ritchie
 Drilling commenced 3-22-83
 Drilling completed _____ Total depth _____
 Date shot _____ Depth of shot _____
 Initial open flow _____ /10ths Water in _____ Inch
 Open flow after tubing _____ /10ths Merc. in _____ Inch
 Volume _____ Cu. Ft.
 Rock pressure _____ lbs. _____ hrs.
 Oil _____ bbls., 1st 24 hrs.
 Fresh water _____ feet _____ feet
 Salt water _____ feet _____ feet

| CASING AND TUBING | USED IN DRILLING | LEFT IN WELL | PACKERS |
|-------------------|------------------|--------------|----------------------|
| Size | | | |
| 16 | | | Kind of Packer _____ |
| 13 | | | |
| 10 | | | Size of _____ |
| 8 1/4 | | | |
| 6 5/8 | | | Depth set _____ |
| 5 3/16 | | | |
| 3 | | | Perf. top _____ |
| 2 | | | Perf. bottom _____ |
| Liners Used | | | Perf. top _____ |
| | | | Perf. bottom _____ |

CASING CEMENTED _____ SIZE _____ No. FT. _____ Date _____
 NAME OF SERVICE COMPANY _____
 COAL WAS ENCOUNTERED AT _____ FEET _____ INCHES
 _____ FEET _____ INCHES FEET _____ INCHES
 _____ FEET _____ INCHES FEET _____ INCHES

Drillers' Names Richard Moore / Floyd J. Anderson / Carl D. Johnston
Union Drilling Rig # 6 Tool Pusher Chuck Casto
 Remarks: Visit 385 foot deep at time of visit - Pit OK.

3-24-83
DATE

Samuel N. [Signature] 08/18/2023
DISTRICT WELL INSPECTOR

STATE OF WEST VIRGINIA
DEPARTMENT OF MINES
OIL AND GAS WELLS DIVISION

RECEIVED

MAR 29 1983

OIL AND GAS DIVISION
WV DEPARTMENT OF MINES

INSPECTOR'S WELL REPORT

Permit No. 85-6339

Oil or Gas Well _____
(KIND)

Company Jenkins Energy Corp.
 Address _____
 Farm Waneta Hoover
 Well No. Hoover #1
 District Union County Pitchie
 Drilling commenced 3-22-83
 Drilling completed _____ Total depth _____
 Date shot _____ Depth of shot _____
 Initial open flow _____ /10ths Water in _____ Inch
 Open flow after tubing _____ /10ths Merc. in _____ Inch
 Volume _____ Cu. Ft.
 Rock pressure _____ lbs. _____ hrs.
 Oil _____ bbls., 1st 24 hrs.
 Fresh water _____ feet _____ feet
 Salt water _____ feet _____ feet

| CASING AND TUBING | USED IN DRILLING | LEFT IN WELL | PACKERS |
|-------------------|------------------|--------------|----------------------|
| Size | | | |
| 16 | | | Kind of Packer _____ |
| 13 | | | |
| 10 | | | Size of _____ |
| 8 1/4 | | | |
| 6 5/8 | | | Depth set _____ |
| 5 3/16 | | | |
| 3 | | | Perf. top _____ |
| 2 | | | Perf. bottom _____ |
| Liners Used | | | Perf. top _____ |
| | | | Perf. bottom _____ |

CASING CEMENTED _____ SIZE _____ No. FT. _____ Date _____
 NAME OF SERVICE COMPANY _____
 COAL WAS ENCOUNTERED AT _____ FEET _____ INCHES
 _____ FEET _____ INCHES FEET _____ INCHES
 _____ FEET _____ INCHES FEET _____ INCHES

Drillers' Names _____

Remarks: Run 1028' foot of 8 5/8 casing - 23 joints new
Halliburton ran 250 sacks total = 150 of 50-50 POS mix - 100 common
Plug down at 9:45 AM

3-25-83
DATE

Samuel N. [Signature] 08/18/2023
DISTRICT WELL INSPECTOR

STATE OF WEST VIRGINIA
DEPARTMENT OF MINES
OIL AND GAS WELLS DIVISION

RECEIVED

MAR 31 1983

OIL AND GAS DIVISION
WV DEPARTMENT OF MINES

INSPECTOR'S WELL REPORT

Permit No. 85-6339

Oil or Gas Well _____
(KIND)

| | | | | |
|---|---|------------------|--------------|----------------------|
| Company <u>Jenkins Energy Corp.</u> | CASING AND TUBING | USED IN DRILLING | LEFT IN WELL | PACKERS |
| Address _____ | Size | | | Kind of Packer _____ |
| Farm <u>Waneta Hoover</u> | 16 | | | |
| Well No. <u>Hoover #1</u> | 13 | | | Size of _____ |
| District <u>Union</u> County <u>Ritchie</u> | 10 | | | |
| Drilling commenced <u>3-22-83</u> | 8 3/4 | | | Depth set _____ |
| Drilling completed _____ Total depth _____ | 6 5/8 | | | |
| Date shot _____ Depth of shot _____ | 5 3/16 | | | Perf. top _____ |
| Initial open flow _____ /10ths Water in _____ Inch | 3 | | | Perf. bottom _____ |
| Open flow after tubing _____ /10ths Merc. in _____ Inch | 2 | | | Perf. top _____ |
| Volume _____ Cu. Ft. | Liners Used _____ | | | Perf. bottom _____ |
| Rock pressure _____ lbs. _____ hrs. | CASING CEMENTED _____ SIZE _____ No. FT. _____ Date _____ | | | |
| Oil _____ bbls., 1st 24 hrs. | NAME OF SERVICE COMPANY _____ | | | |
| Fresh water _____ feet _____ feet | COAL WAS ENCOUNTERED AT _____ FEET _____ INCHES | | | |
| Salt water _____ feet _____ feet | _____ FEET _____ INCHES _____ FEET _____ INCHES | | | |

Drillers' Names _____

Remarks: Visit, 4205' foot deep at time of visit

1460 --- gas show
1870-1940 --- Enjun level
-1940 --- oil trace
-2500 --- oil trace
3240 --- oil trace
3760 --- oil trace
4080 --- oil trace

3-28-83
DATE

Samuel P. Hoover
08/18/2023
DISTRICT WELL INSPECTOR



State of West Virginia
Department of Mines
Oil and Gas Division
Charleston 25305

RECEIVED
JUL 23 1985
OIL & GAS DIVISION
DEPT. OF MINES

FINAL INSPECTION REPORT
INSPECTORS COMPLIANCE REPORT
February 6, 1984

COMPANY Jenkins Energy Corporation
P. O. Box 980
Bridgeport, West Virginia 26330

PERMIT NO 085-6339(3-18-83)
FARM & WELL NO Waneta Hoover #1
DIST. & COUNTY Union/Ritchie

| RULE | DESCRIPTION | IN COMPLIANCE | |
|-------|---|---------------|-------|
| | | YES | NO |
| 23.06 | Notification Prior to Starting Work | _____ | _____ |
| 25.04 | Prepared before Drilling to Prevent Waste | _____ | _____ |
| 25.03 | High-Pressure Drilling | _____ | _____ |
| 16.01 | Required Permits at Wellsite | _____ | _____ |
| 15.03 | Adequate Fresh Water Casing | _____ | _____ |
| 15.02 | Adequate Coal Casing | _____ | _____ |
| 15.01 | Adequate Production Casing | _____ | _____ |
| 15.04 | Adequate Cement Strenght | _____ | _____ |
| 15.05 | Cement Type | _____ | _____ |
| 23.02 | Maintained Access Roads | _____ | _____ |
| 25.01 | Necessary Equipment to Prevent Waste | _____ | _____ |
| 23.04 | Reclaimed Drilling Pits | _____ | _____ |
| 23.05 | No Surface or Underground Pollution | _____ | _____ |
| 23.07 | Requirements for Production & Gathering Pipelines | _____ | _____ |
| 16.01 | Well Records on Site | _____ | _____ |
| 16.02 | Well Records Filed | _____ | _____ |
| 7.05 | Identification Markings | _____ | _____ |

I HAVE INSPECTED THE ABOVE CAPTIONED WELL AND RECOMMEND THAT IT BE RELEASED:

SIGNED Samuel M. Heroman
DATE 7-19-85

Your well record was received and reclamation requirements approved. In accordance with Chapter 22, Article 4, Section 2, the above well will remain under bond coverage for the life of the well.

T. H. v. B.
Administrator-Oil & Gas Division

August 6, 1985
08/18/2023
DATE

3-18-23

10,180'

LATITUDE 39°12'30"

LONGITUDE 81°00'00"

NORTH

HAUGH

WANETA HOOVER
13.4 AC.

NO. 1

N 11°31' W
797.93'

STK

N 72°00' W
429.00'

MOATS

S 80°40' E
247.80'

STK

S 09°30' W
746.58'

S 09°30' W
1518'

LAMP

RT. 9

TO HARRISVILLE

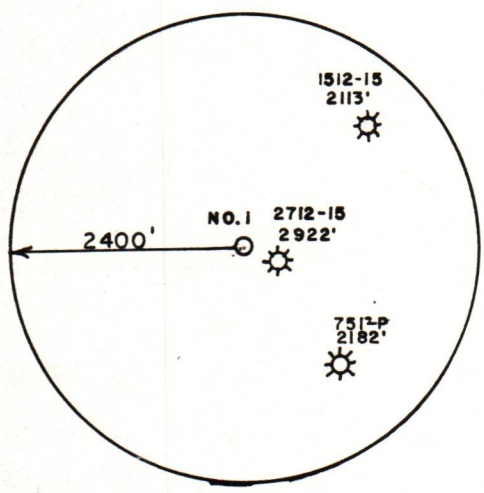

PREPARED BY DAVIS & ASSOCIATES BRIDGEPORT WV

FILE NO. _____
 DRAWING NO. _____
 SCALE 1" = 400'
 MINIMUM DEGREE OF ACCURACY 1 in 200
 PROVEN SOURCE OF ELEVATION U.S.G.S. ELEV. IN ROAD 936'

I THE UNDERSIGNED, HEREBY CERTIFY THAT THIS PLAT IS CORRECT TO THE BEST OF MY KNOWLEDGE AND BELIEF AND SHOWS ALL THE INFORMATION REQUIRED BY LAW AND THE REGULATIONS ISSUED AND PRESCRIBED BY THE DEPARTMENT OF MINES.

(SIGNED) A. M. Shaffer
 R.P.E. 2970 L.L.S. _____

PLACE SEAL HERE

STATE OF WEST VIRGINIA
 DEPARTMENT OF MINES
 OIL AND GAS DIVISION



DATE MARCH 3, 19 83
 OPERATOR'S WELL NO. HOOVER NO. 1
 API WELL NO. 47-085-6339
 STATE COUNTY PERMIT

(+) DENOTES LOCATION OF WELL ON UNITED STATES TOPOGRAPHIC MAPS
 WELL TYPE: OIL ___ GAS X LIQUID INJECTION ___ WASTE DISPOSAL ___
 (IF "GAS,") PRODUCTION X STORAGE ___ DEEP ___ SHALLOW X
 LOCATION: ELEVATION 895' WATER SHED TRIBUTARY OF BACK RUN
 DISTRICT UNION COUNTY RITCHIE
 QUADRANGLE HARRISVILLE

08/18/2023

SURFACE OWNER WANETA HOOVER ACREAGE 13.4 AC.
 OIL & GAS ROYALTY OWNER PRUDENCE WILSON ESTATE LEASE ACREAGE 125 AC.
 LEASE NO. _____

PROPOSED WORK: DRILL X CONVERT ___ DRILL DEEPER ___ REDRILL ___ FRACTURE OR STIMULATE ___ PLUG OFF OLD FORMATION ___ PERFORATE NEW FORMATION ___ OTHER PHYSICAL CHANGE IN WELL (SPECIFY) _____

PLUG AND ABANDON ___ CLEAN OUT AND REPLUG ___
 TARGET FORMATION DEVONIAN SHALE ESTIMATED DEPTH 5875'
 WELL OPERATOR JENKINS ENERGY CORP. DESIGNATED AGENT CARLTON DAVIS
 ADDRESS P.O. BOX 980 ADDRESS P.O. BOX 980

FORM IV-6 (8-78)

HALL