

85 06596P

WW-7
8-30-06



West Virginia Department of Environmental Protection
Office of Oil and Gas
WELL LOCATION FORM: GPS

API: 47-085-06596 WELL NO.: Brooks # 3

FARM NAME: Douglas Bowie

RESPONSIBLE PARTY NAME: Clarence W Mutschelknaus

COUNTY: Ritchie DISTRICT: Clay

QUADRANGLE: Ellenboro

SURFACE OWNER: Douglas Bowie

ROYALTY OWNER: _____

UTM GPS NORTHING: 4,351,060

UTM GPS EASTING: 492,255 GPS ELEVATION: 301m (987')

The Responsible Party named above has chosen to submit GPS coordinates in lieu of preparing a new well location plat for a plugging permit or assigned API number on the above well. The Office of Oil and Gas will not accept GPS coordinates that do not meet the following requirements:

1. Datum: NAD 1983, Zone: 17 North, Coordinate Units: meters, Altitude: height above mean sea level (MSL) – meters.
2. Accuracy to Datum – 3.05 meters
3. Data Collection Method:

Survey grade GPS _____: Post Processed Differential _____
Real-Time Differential _____

Mapping Grade GPS X: Post Processed Differential _____
Real-Time Differential _____

4. Letter size copy of the topography map showing the well location.

I the undersigned, hereby certify this data is correct to the best of my knowledge and belief and shows all the information required by law and the regulations issued and prescribed by the Office of Oil and Gas.

Clarence W Mutschelknaus Owner
Signature Title

6-1-15
Date

RECEIVED
Office of Oil and Gas

JUN 04 2015

WV Department of
Environmental Protection

07/24/2015

SUBJECT WELL
Brooks No.3
47-085-6596

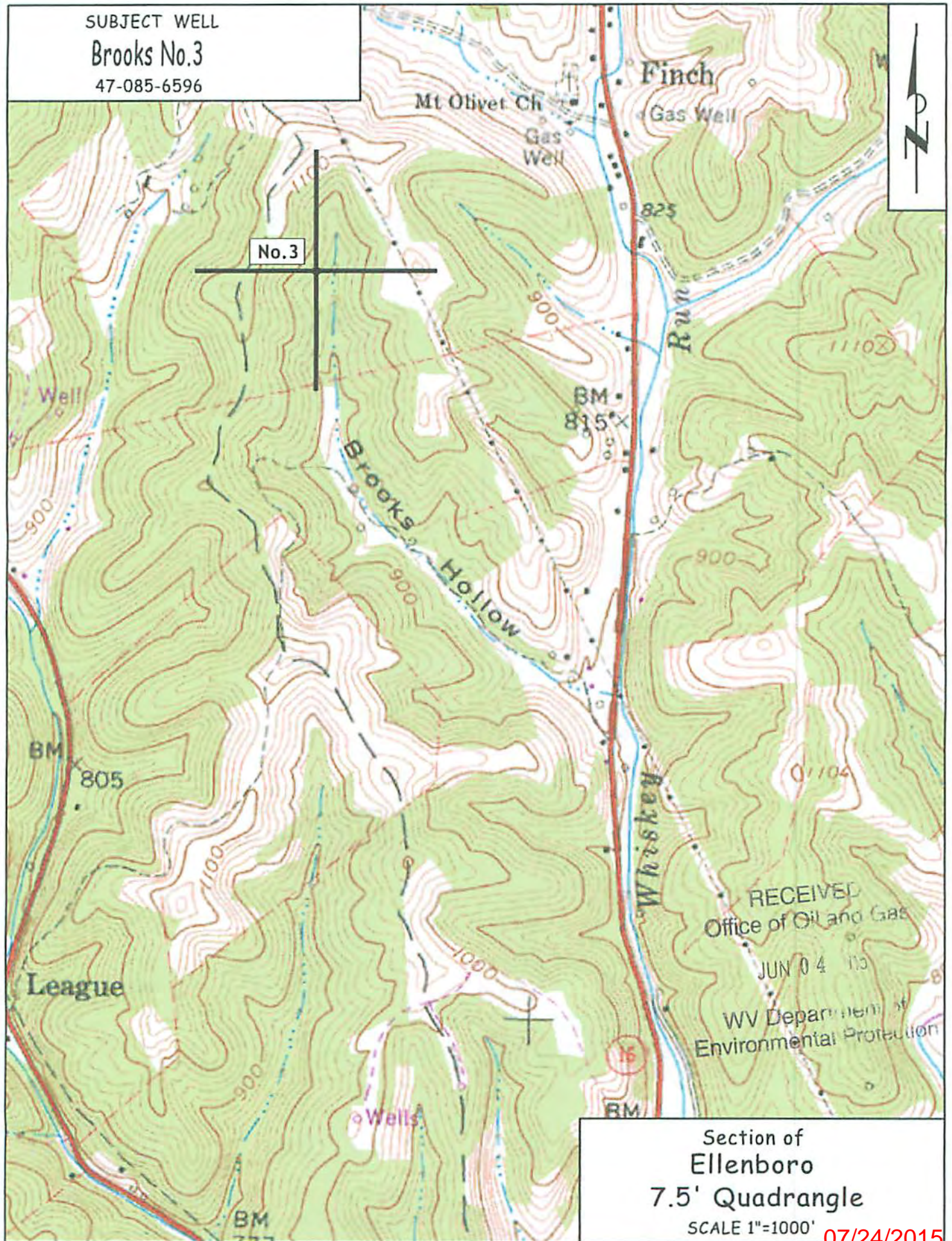

RECEIVED
Office of Oil and Gas
JUN 04 113
WV Department of
Environmental Protection

Section of
Ellenboro
7.5' Quadrangle

SCALE 1"=1000'

07/24/2015