



1) Date: JULY 18, 19 84  
 2) Operator's Well No. FOSTER # 2  
 3) API Well No. 47 085 - 7070  
 State County Permit

STATE OF WEST VIRGINIA  
 DEPARTMENT OF MINES, OIL AND GAS DIVISION  
 APPLICATION FOR A WELL WORK PERMIT

- 4) WELL TYPE: A Oil X / Gas X /  
 B (If "Gas", Production X / Underground storage \_\_\_\_\_ / Deep \_\_\_\_\_ / Shallow X)  
 5) LOCATION: Elevation: 985 Watershed: BEAR RUN of Bonds Creek (LKH 10 R,  
 District: GRANT 2 County: RITCHIE Quadrangle: HARRISVILLE 393  
 6) WELL OPERATOR WESTERN RESERVE OIL & GAS 7) DESIGNATED AGENT D. E. SPENCER  
 Address COMPANY, LTD. 53025 Address 7845 EMERSON AVE.  
7845 EMERSON AVE, PARKERSBURG, WV PARKERSBURG, WV 26101  
 8) OIL & GAS INSPECTOR TO BE NOTIFIED 9) DRILLING CONTRACTOR:  
 Name JAM HERSMAN Name UNKNOWN GENE STALNAKER  
 Address P.O. BOX 66 Address \_\_\_\_\_  
SMITHVILLE, WV 26178  
 10) PROPOSED WELL WORK: Drill X / Drill deeper \_\_\_\_\_ / Redrill \_\_\_\_\_ / Stimulate X /  
 Plug off old formation \_\_\_\_\_ / Perforate new formation \_\_\_\_\_ /  
 Other physical change in well (specify) \_\_\_\_\_  
 11) GEOLOGICAL TARGET FORMATION, DEVONIAN SHALE  
 12) Estimated depth of completed well, 5999 feet  
 13) Approximate strata depths: Fresh, 245', 235' feet; salt, \_\_\_\_\_ feet.  
 14) Approximate coal seam depths: \_\_\_\_\_ Is coal being mined in the area? Yes \_\_\_\_\_ No X

RECEIVED  
 JUL 19 1984

OIL & GAS DIVISION  
 DEPT. OF MINES

15) CASING AND TUBING PROGRAM

CASING OR TUBING TYPE	SPECIFICATIONS					FOOTAGE INTERVALS		CEMENT FILL-UP OR SACKS (Cubic feet)	PACKERS
	Size	Grade	Weight per ft.	New	Used	For drilling	Left in well		
Conductor	<u>11 3/4</u>		<u>42</u>	<u>X</u>		<u>1000'</u>	<u>30'</u>	<u>225'</u>	<u>to be pulled</u>
Fresh water									<u>225' 15.05</u>
Coal									<u>for through</u>
Intermediate	<u>8 5/8</u>		<u>23</u>	<u>X</u>		<u>1080'</u>	<u>1085'</u>	<u>980'</u>	<u>1085'</u>
Production	<u>4 1/2</u>		<u>10.5</u>	<u>X</u>		<u>5900'</u>	<u>5900'</u>	<u>350</u>	<u>BY TULE 15.01</u>
Tubing								<u>or as req.</u>	
Liners									
<u>Nowaco Slurry bit to be run on surface casing</u> <u>See conditioning on reverse side.</u>									Kinds _____ Sizes _____ Depths set _____ Perforations: _____ Top _____ Bottom _____

OFFICE USE ONLY  
 DRILLING PERMIT

Permit number 47-085-7070 Date July 19, 19 84

This permit covering the well operator and well location shown below is evidence of permission granted to drill in accordance with the pertinent legal requirements subject to the conditions contained herein and on the reverse hereof. **Notification must be given to the District Oil and Gas Inspector, (Refer to No. 8) Prior to the construction of roads, locations and pits for any permitted work.** In addition, the well operator or his contractor shall notify the proper district oil and gas inspector 24 hours before actual permitted work has commenced.)

The permitted work is as described in the Notice and Application, plat, and reclamation plan, subject to any modifications and conditions specified on the reverse hereof.

Permit expires July 19, 1986 unless well work is commenced prior to that date and prosecuted with due diligence.

Bond: <u>170</u>	Agent: <u>LMH</u>	Plat: <u>MH</u>	Casing: <u>MH</u>	Fee: <u>340</u>
------------------	-------------------	-----------------	-------------------	-----------------

Margaret J. Hasse  
 Administrator, Office of Oil and Gas

NOTE: Keep one copy of this permit posted at the drilling location.



OFFICE USE ONLY

PERMIT MODIFICATIONS AND CONDITIONS (IF ANY) TO THE PROPOSED WELL WORK

Westerly Reserve may be used on the surface string of this Foster #2 well.

The waiting time will be 8 hours.

A weight measurement will be made on site to assure that the cement slurry meets the ~~minimum~~ minimum weight spec. of 15.3 lb/gal.

A sample will be collected and if after 8 hours the cement is not set up, additional time will be required.

A copy of the cement ticket will be left with the state or a gas inspector, or available at the rig.

OFFICE USE ONLY

This part of Form IV-2(b) is to record the dates of certain occurrences and any follow-up inspections.

	Date	Date(s)
Application received		
Well work started		
Completion of the drilling process		
Well Record received		
Reclamation completed		

OTHER INSPECTIONS

Reason: \_\_\_\_\_  
Reason: \_\_\_\_\_

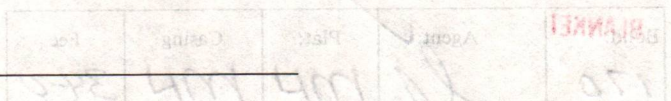



IV-9  
(Rev 8-81)

DATE 7/11/84

WELL NO. 2

State of West Virginia API NO. 47 - 085 - 7070

Department of Mines  
Oil and Gas Division Telephone 348-2057

CONSTRUCTION AND RECLAMATION PLAN

COMPANY NAME Western Reserve O & G DESIGNATED AGENT D.E. Spencer

Address 7845 Emerson Ave., Parkersburg Address Same

Telephone 464-4353 Telephone 464-4353

LANDOWNER E.D. Salmons SOIL CONS. DISTRICT Little Kanawha

Revegetation to be carried out by E.D. Spencer (Agent)

This plan has been reviewed by Little Kanawha SCD. All corrections and additions become a part of this plan: 7-18-84 (Date)

Garrett Newton  
(SCD Agent)

RECEIVED

JUL 19 1984

ACCESS ROAD GRADE 5% (500')

LOCATION OIL & GAS DIVISION

Structure Cross Drains (3) (A)

Spacing 135' Apart

Page Ref. Manual 2-4

Structure Culvert (B)

Spacing 0-5% grade 250' max  
6-10% grade 150' max

Page Ref. Manual 2-7

Structure Open Ditch (C)

Spacing Along side of access road

Page Ref. Manual 2-12

Structure Temporary Diversion Ditch

Material Soil

Page Ref. Manual 2-12

Structure Rip Rap (2)

Material Rock

Page Ref. Manual N/A

Structure \_\_\_\_\_ (3)

Material \_\_\_\_\_

Page Ref. Manual \_\_\_\_\_

DEPT. OF MINES

All structures should be inspected regularly and repaired if necessary. All commercial timber is to be cut and stacked and all brush and small timber to be cut and removed from the site before dirt work begins.

REVEGETATION

Treatment Area I

Lime 3 Tons/acre  
or correct to pH 6.5

Fertilizer 500 lbs/acre  
(10-20-20 or equivalent)

Mulch Hay 2 Tons/acre

Seed\* K-31 Fescue 35 lbs/acre

Redtop 10 lbs/acre

Ladino Clover 5 lbs/acre

Treatment Area II

Lime 3 Tons/acre  
or correct to pH 6.5

Fertilizer 500 lbs/acre  
(10-20-20 or equivalent)

Mulch Hay 2 Tons/acre

Seed\* K-31 Fescue 35 lbs/acre

Redtop 10 lbs/acre

Ladino Clover 5 lbs/acre

\*Inoculate all legumes such as vetch, trefoil and clovers with the proper bacteria. Inoculate with 3X recommended amount.

12/29/2023

PLAN PREPARED BY Robert Davis



ADDRESS Rt. 2 Box. 23

Camden W.V. 26338

PHONE NO. 269-3497

NOTES: Please request landowners' cooperation to protect new seedling for one growing season. Attach separate sheets as necessary for comments.









ATTACH OR PHOTOCOPY SECTION OF INVOLVED TOPOGRAPHIC MAP. QUADRANGLE Harrisville 7.5

LEGEND	
Well Site	
Access Road	

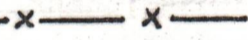
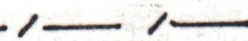
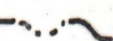
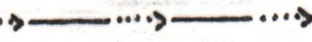
SEE ATTACHED SHEET !!

WELL SITE PLAN

Sketch to include well location, existing access road, roads to be constructed, wellsite, drilling pits and necessary structures numbered or lettered to correspond with the first part of this plan. Include all natural drainage.

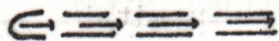
LEGEND	
Property boundary	
Road	
Existing fence	
Planned fence	
Stream	
Open ditch	
Diversion	
Spring	
Wet spot	
Building	
Drain pipe	
Waterway	

ROAD BANKS 2:1 SLOPE  
LOCATION GRADE = 1% INTO DIVERSION DITCH

"PITS WILL BE PLACED OUT OF FILL AREA"

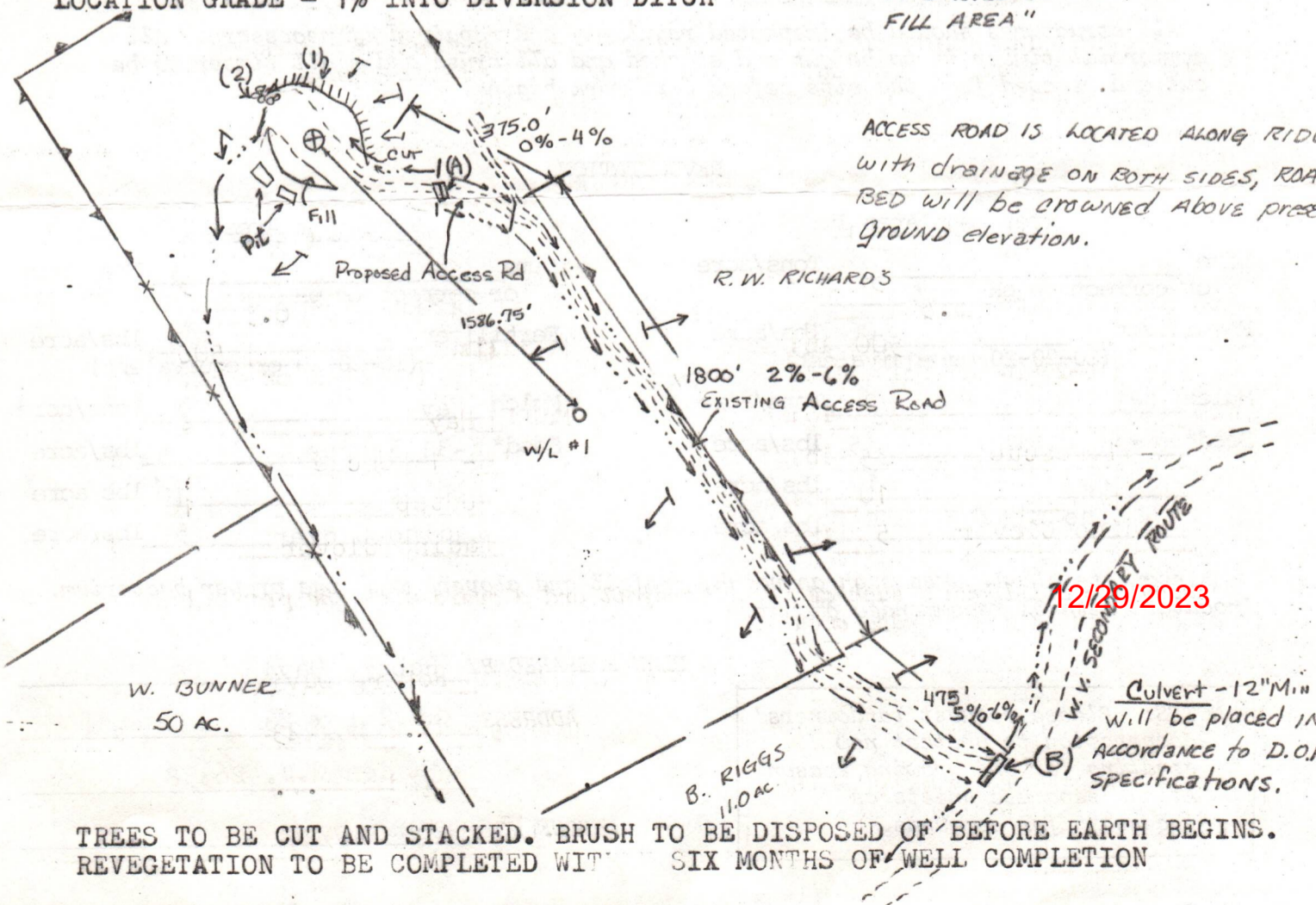

12/29/2023

TREES TO BE CUT AND STACKED. BRUSH TO BE DISPOSED OF BEFORE EARTH BEGINS. REVEGETATION TO BE COMPLETED WITH SIX MONTHS OF WELL COMPLETION

UNITED STATES  
DEPARTMENT OF THE INTERIOR  
GEOLOGICAL SURVEY

621 SW  
CULTZ

1492  
4775

81°07'30"  
39°15'

490000m E.

491

492

5'

493



1) Date: July 17 1984  
2) Operator's Well No. Foster #2  
3) API Well No. 47 085-7070  
State County Permit

STATE OF WEST VIRGINIA  
DEPARTMENT OF MINES, OFFICE OF OIL & GAS

NOTICE OF APPLICATION FOR A WELL WORK PERMIT

4) SURFACE OWNER(S) OF RECORD TO BE SERVED

(i) Name E.D. Salmons  
Address Rt. 1  
Hamden, Ohio 45634

(ii) Name \_\_\_\_\_  
Address \_\_\_\_\_

(iii) Name \_\_\_\_\_  
Address \_\_\_\_\_

5(i) COAL OPERATOR  
Address \_\_\_\_\_

5(ii) COAL OWNER(S) WITH DECLARATION ON RECORD  
Name Same as oil + Gas  
Address \_\_\_\_\_

Name \_\_\_\_\_  
Address \_\_\_\_\_

5(iii) COAL LESSEE WITH DECLARATION ON RECORD:  
Name \_\_\_\_\_  
Address \_\_\_\_\_

TO THE PERSON(S) NAMED ABOVE: You should have received this Form and the following documents:

- (1) The Application for a Well Work Permit on Form IV-2(B) (or Form IV-4 if the well is to be plugged, which sets out the parties involved in the drilling or other work, and describes the well and its location and, if applicable, the proposed casing and cementing program;
- (2) The plat (surveyor's map) showing the well location on Form IV-6; and
- (3) The Construction and Reclamation Plan on Form IV-9 (unless the well work is only to plug a well), which sets out the plan for erosion and sediment control and for reclamation for the site and access road.

THE REASON YOU RECEIVED THESE DOCUMENTS IS THAT YOU HAVE RIGHTS REGARDING THE APPLICATION WHICH ARE SUMMARIZED IN THE "INSTRUCTIONS" ON THE REVERSE SIDE OF THE COPY OF THE APPLICATION (FORM IV-2(B) OR FORM 4, DESIGNATED FOR YOU. HOWEVER, YOU ARE NOT REQUIRED TO TAKE ANY ACTION AT ALL.

Take notice that under Chapter 22 of the West Virginia Code, the undersigned well operator proposes to file or has filed this Notice and Application and accompanying documents for a Well Work Permit with the Administrator of the Office of Oil and Gas, West Virginia Department of Mines, with respect to a well at the location described on attached Application and depicted on attached Form IV-6. Copies of this Notice, the Application, the plat, and the Construction and Reclamation Plan have been mailed by registered or certified mail or delivered by hand to the person(s) named above (or by publication in certain circumstances) on or before the day of mailing or delivery to the Administrator.

RECEIVED  
JUL 19 1984  
OIL & GAS DIVISION  
DEPT. OF MINES

6) EXTRACTION RIGHTS

Check and provide one of the following:

- Included is the lease or leases or other continuing contract or contracts by which I hold the right to extract oil or gas.
- The requirement of Code 22-4-1-(c) (1) through (4). (See reverse side for specifics.)

7) ROYALTY PROVISIONS

Is the right to extract, produce or market the oil or gas based upon a lease or leases or other contract or contracts providing for flat well royalty or any similar provision for compensation to the owner of the oil or gas in place which is not inherently related to the volume of oil or gas so extracted, produced or marketed? Yes No

If the answer above is No, nothing additional is needed. If the answer is Yes, you may use Affidavit Form IV-60.

See the reverse side for line item instructions, and for instructions concerning the required copies of the Notice and Application, plat, and Construction and Reclamation Plan.

The truth of the information on the Notice and Application is verified and sworn to and the Notice is signed on behalf of the Well Operator in my County and State by

Sharon L. Fischer  
this 17 day of July, 1984.  
My commission expires 1-12, 1994.

WELL OPERATOR Western Reserve Oil + Gas Co., Ltd  
By Donna E. Spencer  
Its Designated Agent  
Address 1745 Emerald  
Parkersburg, W. VA 26101  
Telephone 304-464-5353

INSTRUCTIONS TO APPLICANT

CONCERNING THE LINE ITEMS:

- 1) Date of Notice.
- 2) Your well name and number.
- 3) To be filled out by the Office of Oil & Gas.
- 4) & 5) Use separate sheet if necessary.
- 4) Surface owner(s) of record to be served with Notice and Application. However, see also Code § 22-4-1b(b) if "more than three tenants in common or other co-owners of interest described in subsection (a) of this section hold interests in such lands".
- 5(i) "Coal Operator" means any person, firm, partnership, partnership association or corporation that proposes to or does operate a coal mine.
- 5(ii, iii) See Code § 22-4-20.
- 6) See Code § 22-4-11(c). However, in lieu of filing the lease(s) or other continuing contract(s), the Applicant may fill out the information in the space provided below.
- 7) See Code §§ 22-4-11(d, e).

CONCERNING THE REQUIRED COPIES FOR FILING AND SERVICE:

Filing. Code § 22-4-1k and Regulation 7.02 provide that the original and required copies of the Notice and Application must be filed with the Administrator, accompanied by (i) a plat in the form prescribed by Regulation 11, (ii) a bond in one of the forms prescribed by Regulation 12, or in lieu thereof the other security allowed by Code § 22-4-1k(d) and the reclamation required by Code § 22-4-12b and Regulation 23, (iv) unless previously paid on the same well, the fees required by Code § 22-4-1a(c) and 22-3-12a, and (v) if applicable, the consent required by Code § 22-4-8a from the owner of any water well on dwelling within 200 feet of the proposed well.

Service. In addition, service must be made on the surface owner(s) and the person(s) with an interest in the coal. See Code §§ 22-4-1m, 22-4-2, 22-4-2a, and 22-4-2b.

INFORMATION SUPPLIED UNDER CODE § 22-4-11(d)

IN LIEU OF FILING LEASE(S) AND OTHER CONTINUING CONTRACT(S)

Under the oath required to make the verification on the obverse side of this Notice, I depose and say that I am the person who signed the Notice for the Applicant, and that--

- (1) the tract of land is the same tract described in the Application to which this Notice applies, partly or wholly depicted in the accompanying plat, and described in the Construction and Reclamation Plan;
- (2) the parties and recordation data (if recorded) for lease(s) or other continuing contract(s) by which the Applicant claims the right to extract, produce or market the oil or gas are as follows:

<u>Grantor, lessor, etc.</u>	<u>Grantee, lessee, etc.</u>	<u>Royalty</u>	<u>Book Page</u>
John E + Edna C. Foster	A.M. Pipeline Trust	12.5	165/406
A.M. Pipeline Trust	1983 Western Employee's Trust		173/84
1983 Western Employee's Trust	Magna Energy Corporation		173/82
Magna Energy Corporation	1983 Western Reserve Oil & Gas Co., Ltd.		



1) Date: JULY 12, 1984  
 2) Operator's Well No. FASTER #2  
 3) API Well No. 47 State 025 County PERMIT

**STATE OF WEST VIRGINIA  
 DEPARTMENT OF MINES, OIL AND GAS DIVISION  
 APPLICATION FOR A WELL WORK PERMIT**

- 4) WELL TYPE: A Oil  / Gas   
 B (If "Gas", Production  / Underground storage  / Deep  / Shallow )
- 5) LOCATION: Elevation: 785 Watershed: BEAR RIVER  
 District: GRAFT County: RITCHIE Quadrangle: HARRISVILLE
- 6) WELL OPERATOR WESTERN RESEARCH GAS 7) DESIGNATED AGENT DR. SPENCER  
 Address COMPANY LTD Address 7245 EMERSON AVE  
2295 EMERSON AVE PARKERSBURG, WV PARKERSBURG, WV 26101
- 8) OIL & GAS INSPECTOR TO BE NOTIFIED 9) DRILLING CONTRACTOR:  
 Name EAM HERSMAN Name HASKINIAN  
 Address P.O. BOX 66 Address 3000  
SMITHVILLE, WV 26178
- 10) PROPOSED WELL WORK: Drill  / Drill deeper  / Redrill  / Stimulate   
 Plug off old formation  / Perforate new formation   
 Other physical change in well (specify) \_\_\_\_\_
- 11) GEOLOGICAL TARGET FORMATION, DELVONIAN SHALE  
 12) Estimated depth of completed well, 5999 feet  
 13) Approximate strata depths: Fresh, 5225 feet; salt, \_\_\_\_\_ feet.  
 14) Approximate coal seam depths: \_\_\_\_\_ Is coal being mined in the area? Yes \_\_\_\_\_

**RECEIVED**  
 JUL 19 1984

OIL & GAS DIVISION  
 DEPT. OF MINES

**15) CASING AND TUBING PROGRAM**

CASING OR TUBING TYPE	SPECIFICATIONS					FOOTAGE INTERVALS		CEMENT FILL-UP OR SACKS (Cubic feet)	PACKERS	
	Size	Grade	Weight per ft.	New	Used	For drilling	Left in well		Kinds	Sizes
Conductor										
Fresh water	<u>1 1/4</u>		<u>42</u>	<input checked="" type="checkbox"/>		<u>175'</u>	<u>175'</u>	<u>0.95</u>		
Coal										
Intermediate	<u>2 3/8</u>		<u>23</u>	<input checked="" type="checkbox"/>		<u>1820'</u>	<u>1820'</u>	<u>0.95</u>		
Production	<u>1 1/2</u>		<u>10.5</u>	<input checked="" type="checkbox"/>		<u>5900'</u>	<u>5900'</u>	<u>350</u>		
Tubing										
Liners										

The law requires a comment period for surface owners. However, the permit can be issued in less than 15 days from the filing of the Application if the surface owner(s) of record sign(s) the following "Voluntary Statement of No Objection" on a facsimile of this surface owner's copy of the Application.

**VOLUNTARY STATEMENT OF NO OBJECTION**

I hereby state that I have read the instructions to surface owners on the reverse side of this Application for a Well Work Permit, and that I have received copies of (1) a Notice of Application for a Well Work Permit on Form IV-2(A), (2) an Application for a Well Work Permit on Form IV-2(B), (3) a survey plat on Form IV-6, and (4) a Construction and Reclamation Plan on Form IV-9, all for proposed well work on my surface land as described therein.

I further state that I have no objection to the planned work described in these materials, and I have no objection to a permit being issued based on those materials.

(For execution by corporation, partnership, etc.)

(For execution by natural persons)

NAME: \_\_\_\_\_

E. D. Salmon  
 (Signature)

Date: \_\_\_\_\_

By \_\_\_\_\_

A. R. ...  
 (Signature)

Date: \_\_\_\_\_

Its \_\_\_\_\_ Date \_\_\_\_\_

**12/29/2023**  
 Surface Owner



**INSTRUCTIONS TO SURFACE OWNERS  
AND  
EXPLANATION OF METHODS AND TIME LIMITS TO COMMENT  
ON OIL AND GAS WELL WORK PERMIT**

The well operator named in the Notice and this Application and the attached materials is applying for a permit from the State to do oil or gas well drilling or other well work. You are being served with these materials because surface owners have the right to file comments before the permit is issued. (**NOTE:** If the surface tract is owned by more than three persons, in multiple heirship for example, then these materials were served on you because your name appeared on the Sheriff's tax ticket on the land or because you actually occupy the surface tract. In either case, you may be the only owner who will actually receive these materials.) See Chapter 22, Article 4 of the W. Va. Code. Permits are valid for 24 months.

If you do not own any interest in the surface tract, please forward these materials to the true owner immediately if you know who it is. Also, please notify the well operator named in the materials and the Administrator of the Office of Oil and Gas in the West Virginia Department of Mines immediately.

**NOTE: You are not required to file any comment at all.**

**Where to file comments and obtain additional information:**

Administrator of the Office of Oil and Gas  
West Virginia Department of Mines  
1615 Washington Street East  
Charleston, West Virginia 25311  
(304) 348-2057

**Who may file comments?** If you wish to file comments, you must be an owner of record of (1) an interest in the surface tract on which the well already is or is about to be located, or (2) an interest in any other surface tract under the same oil or gas lease which will be utilized for roads or other land disturbances.

**Time limits for comments.** The law requires these materials to be delivered on or before the date the operator files his Application. You have **FIFTEEN (15) DAYS** after the filing date to file your comments as provided in **Methods for Filing Comments** below. You may call the Administrator's office at the above telephone number to be sure of the date. However, if you have been contacted by the well operator, and if you have signed a "voluntary statement of no objection" to any of the planned work described in these materials, then the permit may be issued at any time.

**Comments must be in writing.** Your comments must include your name, address and telephone number, the well operator's name and well number, and the approximate location of the proposed well site including district and county from the application. You may add other documents, such as sketches, maps or photographs to support your comments.

**Methods for filing comments.** Comments must be filed in person or received in the mail at the Administrator's office by the time stated above. Check with your postmaster to ensure adequate delivery time or to arrange special expedited handling.

The Administrator for Oil and Gas has the power to deny or condition a well work permit based on your comments on the following grounds:

- “(1) The proposed well work will constitute a hazard to the safety of persons; or
- “(2) The plan for soil erosion and sediment control is not adequate or effective; or
- “(3) Damage would occur to publicly owned lands or resources; or
- “(4) The proposed well work fails to protect fresh water sources or supplies.”

**If you want a copy of the permit** as it is finally issued, or a copy of the order denying the permit, you should request a copy from the Administrator.

**List of Water Testing Laboratories.** The Administrator maintains a list of water testing laboratories which you can hire to test your water to establish water quality prior to and after drilling. Contact the Administrator's office or an Oil and Gas Inspector to obtain a copy of the list.

15/406

# OIL AND GAS LEASE

THIS AGREEMENT, made this 23rd day of November, 19 83,  
by and between: JOHN E. FOSTER AND EDNA C. FOSTER, husband and wife  
1525 17th Street  
Parkersburg, WV 26101

hereinafter known as the "LESSOR", whether one or more,  
and A.M. Pipeline Trust of West Virginia hereinafter known as the "LESSEE", whether one or more,  
7845 Emerson Avenue, Parkersburg, WV 26101

### WITNESSETH:

1. That the LESSOR, in consideration of the sum of One Dollar (\$1.00), and other good and valuable consideration, the receipt of which is hereby acknowledged, and of the covenants and agreements hereinafter contained, does hereby ~~grant~~ **LEASE** unto the LESSEE all of the oil and gas and all of the constituents of either, in and under the following described land, together with the exclusive right to operate, drill for, produce, and market oil and gas and their constituents, and also the right to enter thereon for the purpose of drilling and operating for oil and gas, laying pipelines, erecting tanks and machinery, and the right to do all other things necessary and proper for the drilling, production, and marketing of oil and gas and their constituents from the property which is more particularly described below:

Situated in ~~Section~~ Grant ~~Township~~ District, County of Ritchie, State of W. Va.,  
and more particularly described at Volume \_\_\_\_\_, Page \_\_\_\_\_, of the Deed Records of \_\_\_\_\_ County,  
\_\_\_\_\_ which description is hereby referred to and incorporated herein by reference; which property is bounded substantially as follows:

NORTH by lands of C. Richards (Being the same 42 acre, 11.2 and 2 acre  
EAST by lands of C. Richards tracts of land designated as Parcels 26,  
SOUTH by lands of C. Richards 26.1 and 29 on Sheet 18 on the Grant District,  
WEST by lands of W. Bunner Ritchie County Assessor's Map.)

Containing 55.25 acres, more or less.

2. It is agreed that this lease shall remain in force for a primary term of Nine (9) Months from this date and as long thereafter as operations for oil or gas, or either of them, are being conducted on the premises, or oil or gas, or either of them, is being produced in paying quantities. It is expressly agreed that if LESSEE shall commence drilling operations at any time while this lease is in force, it shall remain in force and its terms continue so long as such operations are prosecuted, and if production results therefrom as long as production continues in paying quantities.

If, after expiration of the term of this lease, production from the leased premises in paying quantities shall cease from any cause, this lease shall not terminate provided LESSEE resumes operations for the production of oil or gas within sixty (60) days from such cessation, and this lease shall remain in force during the prosecution of such operations, and, if production results therefrom, as long thereafter as oil or gas or either of them is produced in paying quantities.

3. LESSEE shall commence operations for a well on the leased premises or on acreage pooled therewith as provided herein, on or before August 23, 1984 or this lease shall expire as to both parties hereto, unless LESSEE pays or tenders the sum of \$ paid in for each full months that operations are delayed. Such payment shall be a rental for the privilege of deferring commencement of drilling operations for the above period of time. In like manner, and upon like payments or tenders, the commencement of drilling operations shall be further deferred for successive periods during the primary term of this lease.

4. If a well capable of producing oil or gas or the constituents of either in paying quantities located on the leased premises ~~to produce or to be~~ is at any time shut in, suspended or otherwise not produced by the LESSEE due to lack of a market, and no oil or gas or their constituents is sold or utilized off the premises, nevertheless such shut in well shall be deemed to be a well on the leased premises producing in paying quantities and this lease shall remain in force during all of the time while such well is so shut in, whether before or after the expiration of the primary term. LESSEE shall use reasonable diligence to market any production from such well or wells but shall be under no obligation to market such products under terms, conditions or circumstances which in LESSEE's good faith judgment are unsatisfactory.

LESSEE shall be obligated to pay or tender to LESSOR within sixty (60) days after any such well is shut in and each anniversary thereafter, as royalty, an amount equal to \$ 5.00 per acre per year it being the intention of the parties that this lease shall remain in full force and effect for sixty (60) days after shutting in any well without payment.

5. LESSEE agrees to pay to the credit of the LESSOR one-eighth (1/8) of all the oil produced and saved from the leased premises, delivered free of cost to the purchasing agency, and one-eighth (1/8) of the proceeds of all the gas marketed and sold from said premises, payable monthly, free of any cost.  
6. LESSOR reserves to himself, free of cost, 200,000 cubic feet of gas per annum for domestic use in one single family dwelling located on this property. Such free gas shall be taken through LESSOR's own appliances and LESSOR shall be responsible for using economical appliances. LESSOR further covenants and agrees that his taking and use of such gas shall be wholly at his own risk and LESSOR agrees to indemnify and hold harmless LESSEE for any accident or damage caused thereby to either the parties to this agreement or any third party, and LESSEE shall not be liable for any shortage or failure in the supply of gas for said domestic use.

7. All payments made to LESSOR under the terms of this lease shall be made to the LESSOR, or any one of them, in cash or check in person or by United States mail to the address set forth herein or to the credit of LESSOR, or any one of them, in Parkersburg National

Bank at Parkersburg, West Virginia, which bank and its successors are hereby designated as LESSOR's agent for the purpose of receiving said payment. If said bank should fail, liquidate or be succeeded by another bank, or for any reason fail or refuse to accept payments on behalf of LESSOR, LESSEE shall not be held in default for failure to make said payment so long as LESSEE has made a bona fide attempt to make said payment and in no event shall any default be declared against LESSEE until thirty (30) days after LESSEE receives written notice of said default during which time LESSEE shall have the right to make the payment then in default and thereby cure said default.

8. Any notice or demand required by this agreement shall be made to the LESSOR and LESSEE at the address set forth in the instrument of conveyance as recorded in the County Recorder's Office by United States mail, postage prepaid, or in person.

9. LESSEE is authorized to pool or combine the land covered by this lease, or any portion thereof, or formation thereunder, as to oil and/or gas, with any other land, lease or leases when in LESSEE's judgment it is advisable to do so in order to properly develop or operate said premises. Such pooling shall be into a well unit or units not exceeding approximately forty (40) acres for oil and not exceeding approximately six hundred forty (640) acres for gas. LESSEE shall execute and record an instrument or instruments identifying and describing the pooled acreage. Production, drilling or reworking operations anywhere on the unit which includes all or a part of this lease shall be treated as if it were production, drilling or reworking operations under this lease. In lieu of the royalties elsewhere herein specified, LESSOR shall receive from a unit so formed only such portion of the royalties stipulated herein as the amount of his acreage placed in the unit or his royalty therein bears to the total acreage so pooled in the particular unit involved. **This paragraph does not apply to formations above 6000', only to those below 6000'.**

10. The rights of either party hereunder may be assigned in whole or in part, and the provisions hereof shall extend to, and be binding on, their heirs, successors, and assigns; but no change or division in ownership of the land, rentals or royalties, however accomplished, shall operate to enlarge the obligations or diminish the rights of LESSEE; and no change or division in such ownership shall be binding on LESSEE until thirty (30) days after LESSEE shall have been furnished by certified mail at LESSEE's principal place of business with originals or certified copies of recorded documents of title transferring title from LESSOR. In the event of assignment hereof, in whole or in part, liability for breach of any obligation hereunder shall rest exclusively upon the owners of this lease or portion thereof who commits such breach.

11. LESSEE shall have and enjoy all rights and privileges necessary and convenient for the proper use and development of this lease, and shall have the right to use, free of cost, gas, oil and water produced on said land for its operations thereon, except water from wells of LESSOR. LESSEE shall also have the right at any time to remove all or any part of the machinery, fixtures or structures placed on said premises including the right to draw and remove casing.

12. LESSEE hereby agrees to restore the surface of the land covered by this lease to as near as practical its original condition after each drilling operation and further agrees to pay LESSOR for all damages to growing crops, improvements and livestock caused by or arising out of its operations thereon. When required by LESSOR, LESSEE will bury all pipelines below ordinary plow depth. No well shall be drilled within two hundred (200) feet of any residence or barn now on said land without LESSOR's consent.

13. LESSOR hereby warrants and agrees to title to this property including the oil and gas and other minerals which are the subject of this lease and LESSEE agrees that LESSEE, at its option, may pay, discharge or convey any taxes, mortgages, or other liens existing on or assessed against said property, either in whole or in part, and in the event LESSEE does so, it shall be subrogated to the rights of such lien holder with the right to reimburse itself by applying any royalty toward satisfying the same.

12/29/2023

**RECEIVED**

JUL 19 1984

OIL & GAS DIVISION  
DEPT. OF MINES

12/29/2023

14. Should LESSEE be prevented from complying with any express or implied covenant of this lease, from conducting operations thereon or from producing oil or gas therefrom by operation of force majeure, any Federal or State law, or any order, rule, or regulation of any governmental authority, then while so prevented, LESSEE's obligation to comply with such covenant shall be suspended, and LESSEE shall not be liable in damages for failure to comply therewith; and this lease shall be extended while and so long as LESSEE is prevented by any such cause from conducting drilling or reworking operations on or from producing oil or gas from the leased premises, anything in the lease to the contrary notwithstanding.

15. If LESSOR owns a less interest in the above-described land than the entire and undivided fee simple estate therein, then the royalties and rentals herein provided shall be paid to the LESSOR only in the proportion which its interest bears to the whole undivided fee. Should any person, firm, or corporation having an interest in the above-described land not lease to LESSEE, or should any one or more of the parties named above as LESSOR not execute this lease, it shall nevertheless be binding upon the party or parties executing the same.

16. At any time LESSEE shall have the right to surrender this lease or any part thereof for cancellation, after which all payments and liabilities hereunder shall cease and determine as to the part or parts so surrendered, and if the whole is surrendered, then this lease shall become absolutely null and void. This surrender may be made to the LESSOR, or if more than one LESSOR, then to any one of them, or to any heir or assign of any one of them, by delivery of a duly executed surrender thereof in person or by mail addressed to the address of such person as set forth herein, or by recording a duly executed surrender thereof in the Recorder's Office of the County in which the land is located.

17. In consideration of the granting of this lease and its terms and covenants, LESSOR does hereby grant, sell, assign, transfer and set over unto the LESSEE, its heirs, successors, representatives and assigns, a right-of-way to lay, maintain, operate, inspect, replace, change the size of, relocate and remove pipe lines for the transportation of oil or gas and other products with drips, valves, measuring and regulating equipment and other necessary appurtenances thereto on, over and through the land of the LESSOR together with the right of ingress and egress to and from said pipe line measuring and regulating equipment and other necessary appurtenances at all times as may be necessary or convenient for the full and complete use by the LESSEE of this right-of-way.

The LESSOR shall use and enjoy the said lands subject to the conditions and provisions of this right-of-way grant expressed and implied and provided always that such use and enjoyment shall not interfere with or be inconsistent in any way with the rights, privileges and uses herein granted to the LESSEE.

18. This lease embodies the entire contract and agreement between LESSOR and LESSEE, and no warranties, representations, promises, or inducements not herein expressed have been made or relied upon by either party.

IN WITNESS WHEREOF, the parties hereto, intending to be legally bound, have executed this instrument as of the day and year first above-written.

WITNESSES

Social Security # 169-07-3547  
Social Security # 233-68-8101

x John E. Foster (SEAL)  
(John E. Foster) (SEAL)  
x Edna C. Foster (SEAL)  
(Edna C. Foster) (SEAL)

WEST VIRGINIA ACKNOWLEDGEMENT

STATE OF WEST VIRGINIA }  
COUNTY OF WOOD }

To-wit:

I, R. Bruce White, a Notary Public of said County, do hereby certify that JOHN E. FOSTER AND EDNA C. FOSTER, husband and wife

whose names are signed to the within writing bearing date the 23rd day of November, 19 83 have this day acknowledged the same before me in my said County.

Given under my hand this 23rd day of Nov., 19 83

[Signature]  
Notary Public

My Commission expires 8-9-91

OHIO ACKNOWLEDGEMENT

STATE OF WEST VIRGINIA,

Ritchie County Commission Clerk's Office, November 28th, 19 83 at 3:45 o'clock P. M. (Form CC No. 1)

The foregoing writing, with the certificate of acknowledgment thereto, was this day admitted to record in said office.

Teste: Linda B. May Clerk

Oil and Gas Lease

JOHN E. FOSTER AND EDNA C. FOSTER, HUSBAND AND WIFE

A.M. PIPELINE Trust  
OF W. VA.  
Date November 23, 1983

Acres 55.25

Location Buck Run

Grant District

County Ritchie State WV

Term Nine (9) Months

RECORDING DATA:

Filed and admitted to record in the office of the Clerk of the County Commission of Ritchie County, W. Va. NOV 28 1983  
at 3:45 o'clock P. M.  
Recorded in lease  
Book No. 165 Page 406  
Teste: Linda B. May Clerk



IV-35  
(Rev 8-81)

Date September 13, 1984  
Operator's  
Well No. 2  
Farm Foster  
API No. 47 - 085 - 7070

State of West Virginia  
Department of Mines  
Oil and Gas Division

WELL OPERATOR'S REPORT  
OF  
DRILLING, FRACTURING AND/OR STIMULATING, OR PHYSICAL CHANGE

RECEIVED  
SEP 17 1984

OIL & GAS DIVISION

DEPT. OF MINES

WELL TYPE: Oil \_\_\_ / Gas x / Liquid Injection \_\_\_ / Waste Disposal \_\_\_  
(If "Gas," Production \_\_\_ / Underground Storage \_\_\_ / Deep \_\_\_ / Shallow x /)

LOCATION: Elevation: 985 Watershed North Fork Hughes River  
District: Grant County Ritchie Quadrangle Harrisville 7.5

COMPANY Western Reserve Oil & Gas  
ADDRESS 7845 Emerson Ave., Parkersburg, WV  
DESIGNATED AGENT D. E. Spencer  
ADDRESS 7845 Emerson Ave., Parkersburg, WV  
SURFACE OWNER E. D. Salmono  
ADDRESS Rt. 1, Hamden, OH  
MINERAL RIGHTS OWNER John Foster etal  
ADDRESS 1525 17th Street, Parkersburg, WV  
OIL AND GAS INSPECTOR FOR THIS WORK Sam Hersman  
ADDRESS Box 66 Smithville, WV  
PERMIT ISSUED July 19, 1984  
DRILLING COMMENCED July 21, 1984  
DRILLING COMPLETED July 25, 1984

Casing & Tubing	Used in Drilling	Left in Well	Cement fill up Cu. ft.
Size 20-16 Cond.			
<u>11 3/4 13-10"</u>	<u>40'</u>	<u>0</u>	<u>NONE</u>
<u>9 5/8</u>			
<u>8 5/8</u>	<u>1263'</u>	<u>1180'</u>	<u>310 sks.</u>
<u>7</u>			
<u>5 1/2</u>			
<u>4 1/2</u>	<u>4535'</u>	<u>4484</u>	<u>460 sks.</u>
<u>3</u>			
<u>2</u>			
Liners used			

IF APPLICABLE: PLUGGING OF DRY HOLE ON CONTINUOUS PROGRESSION FROM DRILLING OR REWORKING. VERBAL PERMISSION OBTAINED ON \_\_\_\_\_

GEOLOGICAL TARGET FORMATION Devonian Shale Depth 2473-4535 feet  
Depth of completed well 4535 feet Rotary x / Cable Tools \_\_\_\_\_  
Water strata depth: Fresh 80 feet; Salt --- feet  
Coal seam depths: n/a Is coal being mined in the area? No

OPEN FLOW DATA

Producing formation Devonian Shale Pay zone depth 3192-4460 feet  
Gas: Initial open flow \_\_\_\_\_ Mcf/d Oil: Initial open flow \_\_\_\_\_ Bbl/d  
Final open flow 120 Mcf/d Final open flow \_\_\_\_\_ Bbl/d  
Time of open flow between initial and final tests 6 hours  
Static rock pressure 450 psig (surface measurement) after 24 hours shut in  
(If applicable due to multiple completion--)  
Second producing formation \_\_\_\_\_ Pay zone depth \_\_\_\_\_ feet  
Gas: Initial open flow \_\_\_\_\_ Mcf/d Oil: Initial open flow \_\_\_\_\_ Bbl/d  
Final open flow \_\_\_\_\_ Mcf/d Oil: Final open flow \_\_\_\_\_ Bbl/d  
Time of open flow between initial and final tests \_\_\_\_\_ hours  
Static rock pressure \_\_\_\_\_ psig (surface measurement) after \_\_\_\_\_ hours shut in

12/29/2023

(Continue on reverse side)

DETAILS OF PERFORATED INTERVALS, FRACTURING OR STIMULATING, PHYSICAL CHANGE, ETC.

Stage 1  
3932-4460  
1,500,000 Cubic Feet N2  
500 Gal. 15% HCl

Stage 2  
3192-3889  
1,500,000 Cubic Feet N2  
500 Gal. 15% HCl

WELL LOG

FORMATION	COLOR	HARD OR SOFT	TOP FEET	BOTTOM FEET	REMARKS
					Including indication of all fresh and salt water, coal, oil and gas
Red Rock			0	10	
Sand & Shale			10	40	
Red Rock			40	42	
Shale			42	55	
Red Rock			55	68	
Sand & Shale			68	80	
Sand			80	103	
Sand & Shale			103	110	
Red Rock			110	130	
Sand			130	153	
Red Rock			153	166	
Sand & Shale			166	186	
Red Rock			186	190	
Shale			190	200	
Red Rock			200	225	
Sand & Shale			225	245	
Sand			245	265	
Shale			265	278	
Sand			278	309	
Sand & Shale			309	325	
Red Rock			325	337	
Shale			337	368	
Red Rock			368	385	
Shale			385	408	
Red Rock			408	430	
Sand & Shale			430	435	
Sand			435	460	
Shale			460	489	
Sand			489	550	
Shale			550	560	
Sand			560	575	
Red Rock			575	580	
Sand			580	584	
Shale			584	590	
Sand			590	648	
Sand & Shale			648	710	
Sand			710	746	

(Attach separate sheets as necessary)

Western Reserve Oil & Gas Co., Ltd.  
Well Operator

By: Donna E. Spencer 12/29/2023

Date: 9/13/84

RIT. 7070

Note: Regulation 2.02(i) provides as follows:  
"The term 'log' or 'well log' shall mean a systematic detailed geological record of all formations, including coal, encountered in the drilling of a well."

085-7070

FOSTER # 2

WELL LOG CON'T

<u>FORMATION</u>	<u>TOP FEET</u>	<u>BOTTOM FEET</u>
Red Rock	746	810
Sand & Shale	810	815
Sand	815	851
Sand & Shale	851	996
Red Rock	996	1007
Sand & Shale	1007	1040
Shale	1040	1278
Sand & Shale	1278	1581
Sand	1581	1630
Shale	1630	1646
Sand	1646	1760
Sand & Shale	1760	1890
Lime	1890	1951
Keener	1951	2044
Big Injun	2044	2071
Squaw	2071	2094
Shale	2094	2210
Wier	2210	2280
Shale	2280	2453
Berea	2453	2473
Siltstone	2473	2665
Gordon	2665	2733
Siltstone	2733	2859
Fifth Sand	2859	2873
Shale	2873	3610
Warren	3610	3660
Shale	3660	3885
Speechly	3885	3940
Shale	3940	4046
Balltown	4046	4145
Shale	4145	4320
Riley	4320	4385
Shale	4385	4535 TD

RIT. 7070

12/29/2023

STATE OF WEST VIRGINIA  
DEPARTMENT OF MINES  
OIL AND GAS WELLS DIVISION

RECEIVED

JUL 30 1984

OIL & GAS DIVISION  
DEPT. OF MINES  
INSPECTOR'S WELL REPORT

Permit No. 85-7070

Oil or Gas Well \_\_\_\_\_  
(KIND)

Company <u>Western Reserve O. &amp; G. Ltd.</u>	CASING AND TUBING	USED IN DRILLING	LEFT IN WELL	PACKERS
	Address _____	Size		
Farm <u>Salmons</u>	16			
Well No. <u>Foster # 2</u>	13			Size of _____
District <u>Grant</u> County <u>Ritchie</u>	10			
Drilling commenced <u>7-21-84</u>	8 1/4			Depth set _____
Drilling completed _____ Total depth _____	6 5/8			
Date shot _____ Depth of shot _____	5 3/16			Perf. top _____
Initial open flow _____ /10ths Water in _____ Inch	3			Perf. bottom _____
Open flow after tubing _____ /10ths Merc. in _____ Inch	2			Perf. top _____
Volume _____ Cu. Ft.	Liners Used _____			Perf. bottom _____
Rock pressure _____ lbs. _____ hrs.	CASING CEMENTED _____ SIZE _____ No. FT. _____ Date _____			
Oil _____ bbls., 1st 24 hrs.	NAME OF SERVICE COMPANY _____			
Fresh water <u>80'</u> feet _____ feet	COAL WAS ENCOUNTERED AT _____ FEET _____ INCHES			
Salt water _____ feet _____ feet	_____ FEET _____ INCHES FEET _____ INCHES			
	_____ FEET _____ INCHES FEET _____ INCHES			

Drillers' Names D. Tothman / William Todd / Glen Stump

Gene Stalmaker Rig # 5 Tool Pusher Frank Amos

Remarks: on 7-22-84 ran 1180 foot of 8 5/8" casing  
Houseco ran 310 sacks slurry 61 with 3% cc and flocc  
1311' foot deep. - rig down at visit - metal lost in hole

7-23-84  
DATE

Samuel M. H. 12/29/2023  
DISTRICT WELL INSPECTOR



Form 26  
2/16/82

RECEIVED  
OIL & GAS DIVISION  
DEPT. OF MINES

STATE OF WEST VIRGINIA  
DEPARTMENT OF MINES  
OIL AND GAS WELLS DIVISION

INSPECTOR'S PLUGGING REPORT

Permit No. \_\_\_\_\_

Well No. \_\_\_\_\_

COMPANY \_\_\_\_\_ ADDRESS \_\_\_\_\_

FARM \_\_\_\_\_ DISTRICT \_\_\_\_\_ COUNTY \_\_\_\_\_

Filling Material Used \_\_\_\_\_

Liner		Location		Amount	Packer	Location	
PLUGS USED AND DEPTH PLACED			BRIDGES		CASING AND TUBING		
CEMENT-THICKNESS	WOOD-SIZE	LEAD	CONSTRUCTION-LOCATION		RECOVERED	SIZE	LOST

Drillers' Names \_\_\_\_\_

Remarks: \_\_\_\_\_  
\_\_\_\_\_

\_\_\_\_\_ I hereby certify I visited the above well on this date.  
DATE

DISTRICT WELL INSPECTOR  
12/29/2023

STATE OF WEST VIRGINIA  
DEPARTMENT OF MINES  
OIL AND GAS WELLS DIVISION

RECEIVED  
JUL 31 1984

INSPECTOR'S WELL REPORT

Permit No. 85-7070

OIL & GAS DIVISION  
DEPT. OF MINES  
Oil & Gas Well (KING)

Company Western Reserve O. & G. Ltd  
 Address \_\_\_\_\_  
 Farm E. D. Salmons  
 Well No. Foster # 2  
 District Grant County Ritchie  
 Drilling commenced 7-21-84  
 Drilling completed 7-26-84 Total depth 4535'  
 Date shot \_\_\_\_\_ Depth of shot \_\_\_\_\_  
 Initial open flow \_\_\_\_\_ /10ths Water in \_\_\_\_\_ Inch  
 Open flow after tubing \_\_\_\_\_ /10ths Merc. in \_\_\_\_\_ Inch  
 Volume \_\_\_\_\_ Cu. Ft.  
 Rock pressure \_\_\_\_\_ lbs. \_\_\_\_\_ hrs.  
 Oil \_\_\_\_\_ bbls., 1st 24 hrs.  
 Fresh water 80'' feet \_\_\_\_\_ feet  
 Salt water \_\_\_\_\_ feet \_\_\_\_\_ feet

CASING AND TUBING	USED IN DRILLING	LEFT IN WELL	PACKERS
Size			
16			Kind of Packer _____
13			
10			Size of _____
<u>8 1/4 8 5/8"</u>	<u>1180'</u>	<u>1180'</u>	
<u>6 5/8"</u>			Depth set _____
<u>5 3/16 4 1/2"</u>	<u>4484'</u>	<u>4484'</u>	
3			Perf. top _____
2			Perf. bottom _____
Liners Used			Perf. top _____
			Perf. bottom _____

CASING CEMENTED \_\_\_\_\_ SIZE \_\_\_\_\_ No. FT. \_\_\_\_\_ Date \_\_\_\_\_  
 NAME OF SERVICE COMPANY \_\_\_\_\_  
 COAL WAS ENCOUNTERED AT \_\_\_\_\_ FEET \_\_\_\_\_ INCHES  
 \_\_\_\_\_ FEET \_\_\_\_\_ INCHES FEET \_\_\_\_\_ INCHES  
 \_\_\_\_\_ FEET \_\_\_\_\_ INCHES FEET \_\_\_\_\_ INCHES

Drillers' Names \_\_\_\_\_

Remarks: on 7-26-84 Complete hole at depth of 4535' foot ran 4484 foot of 4 1/2" casing - ran cement for a 3000' foot fillup - Back to app. 1535' Rig shut down and ready to move at time of visit

7-27-84  
DATE

Samuel N. H. [Signature]  
DISTRICT WELL INSPECTOR

**STATE OF WEST VIRGINIA  
DEPARTMENT OF MINES  
OIL AND GAS WELLS DIVISION  
INSPECTOR'S PLUGGING REPORT**

Permit No. \_\_\_\_\_ Well No. \_\_\_\_\_

COMPANY \_\_\_\_\_ ADDRESS \_\_\_\_\_

FARM \_\_\_\_\_ DISTRICT \_\_\_\_\_ COUNTY \_\_\_\_\_

Filling Material Used \_\_\_\_\_

Liner	Location		Amount	Packer	Location		
	PLUGS USED AND DEPTH PLACED				BRIDGES	CASING AND TUBING	
	CEMENT-THICKNESS	WOOD-SIZE	LEAD	CONSTRUCTION-LOCATION	RECOVERED	SIZE	LOST

Drillers' Names \_\_\_\_\_

Remarks: \_\_\_\_\_

I hereby certify I visited the above well on this date.

DATE

DISTRICT WELL INSPECTOR

12/29/2023

STATE OF WEST VIRGINIA  
DEPARTMENT OF MINES  
OIL AND GAS WELLS DIVISION

RECEIVED

SEP 4 - 1984

OIL & GAS DIVISION

DEPT. OF MINES

085-7070

INSPECTOR'S WELL REPORT

Permit No. 085-

Oil or Gas Well \_\_\_\_\_  
(KIND)

Company <u>WESTERN RESERVE</u>	CASING AND TUBING	USED IN DRILLING	LEFT IN WELL	PACKERS
Address _____	Size			
Farm <u>ED. SALMON'S</u>	16			Kind of Packer _____
Well No. <u>FOSTER 2#</u>	13			
District <u>Grant</u> County <u>Ritchie</u>	10			Size of _____
Drilling commenced _____	8 1/4			
Drilling completed _____ Total depth _____	6 5/8			Depth set _____
Date shot _____ Depth of shot _____	5 3/16			
Initial open flow _____ /10ths Water in _____ Inch	3			Perf. top _____
Open flow after tubing _____ /10ths Merc. in _____ Inch	2			Perf. bottom _____
Volume _____ Cu. Ft.	Liners Used			Perf. top _____
Rock pressure _____ lbs. _____ hrs.				Perf. bottom _____
Oil _____ bbls., 1st 24 hrs.	CASING CEMENTED _____ SIZE _____ No. FT. _____ Date _____			
Fresh water _____ feet _____ feet	NAME OF SERVICE COMPANY _____			
Salt water _____ feet _____ feet	COAL WAS ENCOUNTERED AT _____ FEET _____ INCHES			
	_____ FEET _____ INCHES _____ FEET _____ INCHES			
	_____ FEET _____ INCHES _____ FEET _____ INCHES			

Drillers' Names \_\_\_\_\_

Status Report

Remarks: Visit site, to look at Reclamation, on REQUEST of contractor to release location, because there in there logging trimbler out and they TEAR it all up. No location will not pass, pit empty over run into woods needs CLEANED up.

8-29-84  
DATE

Mike Underwood 12/29/2023  
DISTRICT WELL INSPECTOR

Form 26  
2/16/82

STATE OF WEST VIRGINIA  
DEPARTMENT OF MINES  
OIL AND GAS WELLS DIVISION

INSPECTOR'S PLUGGING REPORT

Permit No. \_\_\_\_\_

Well No. \_\_\_\_\_

COMPANY \_\_\_\_\_ ADDRESS \_\_\_\_\_

FARM \_\_\_\_\_ DISTRICT \_\_\_\_\_ COUNTY \_\_\_\_\_

Filling Material Used \_\_\_\_\_

Liner	Location		Amount	Packer	Location		
CEMENT-THICKNESS	PLUGS USED AND DEPTH PLACED		LEAD	CONSTRUCTION-LOCATION	CASING AND TUBING		
	WOOD-SIZE	WOOD-SIZE			RECOVERED	SIZE	LOST

Drillers' Names \_\_\_\_\_

Remarks: \_\_\_\_\_

\_\_\_\_\_ I hereby certify I visited the above well on this date.

DATE

DISTRICT WELL INSPECTOR  
12/29/2023



**RECEIVED**

DEC 4 - 1984

OIL & GAS DIVISION  
**DEPT. OF MINES**

**State of West Virginia**

**Department of Mines  
Oil and Gas Division  
Charleston 25305**

**FINAL INSPECTION REPORT  
INSPECTORS COMPLIANCE REPORT  
October 17, 1984**

COMPANY Western Reserve Oil & Gas, LTD

PERMIT NO 085-7070

7845 Emerson Avenue

FARM & WELL NO E. D. Salmono  
Foster #2

Parkersburg, West Virginia 26101

DIST. & COUNTY Grant/Ritchie

RULE	DESCRIPTION	IN COMPLIANCE	
		YES	NO
23.06	Notification Prior to Starting Work	<input checked="" type="checkbox"/>	<input type="checkbox"/>
25.04	Prepared before Drilling to Prevent Waste	<input checked="" type="checkbox"/>	<input type="checkbox"/>
25.03	High-Pressure Drilling	<input checked="" type="checkbox"/>	<input type="checkbox"/>
16.01	Required Permits at Wellsite	<input checked="" type="checkbox"/>	<input type="checkbox"/>
15.03	Adequate Fresh Water Casing	<input checked="" type="checkbox"/>	<input type="checkbox"/>
15.02	Adequate Coal Casing	<input type="checkbox"/>	<input type="checkbox"/>
15.01	Adequate Production Casing	<input checked="" type="checkbox"/>	<input type="checkbox"/>
15.04	Adequate Cement Strenght	<input type="checkbox"/>	<input type="checkbox"/>
15.05	Cement Type	<input type="checkbox"/>	<input type="checkbox"/>
23.02	Maintained Access Roads	<input checked="" type="checkbox"/>	<input type="checkbox"/>
25.01	Necessary Equipment to Prevent Waste	<input checked="" type="checkbox"/>	<input type="checkbox"/>
23.04	Reclaimed Drilling Pits	<input checked="" type="checkbox"/>	<input type="checkbox"/>
23.05	No Surface or Underground Pollution	<input checked="" type="checkbox"/>	<input type="checkbox"/>
23.07	Requirements for Production & Gathering Pipelines	<input type="checkbox"/>	<input type="checkbox"/>
16.01	Well Records on Site	<input checked="" type="checkbox"/>	<input type="checkbox"/>
16.02	Well Records Filed	<input checked="" type="checkbox"/>	<input type="checkbox"/>
7.05	Identification Markings	<input checked="" type="checkbox"/>	<input type="checkbox"/>

I HAVE INSPECTED THE ABOVE CAPTIONED WELL AND RECOMMEND THAT IT BE RELEASED:

SIGNED Samuel N. Keroman

DATE 11-28-84

Your well record was received and reclamation requirements approved. In accordance with Chapter 22, Article 4, Section 2, the above well will remain under bond coverage for the life of the well.

T. L. ...  
Administrator-Oil & Gas Division

January 4, 1985

DATE

12/29/2023

MD 7/19/84

11,700'

LATITUDE 39° - 15' - 00"

850

LONGITUDE 81° - 50' - 00"

REFERENCES

- A N 48-06-40 E 158.34'
- B N 74-46-00 E 158.32'

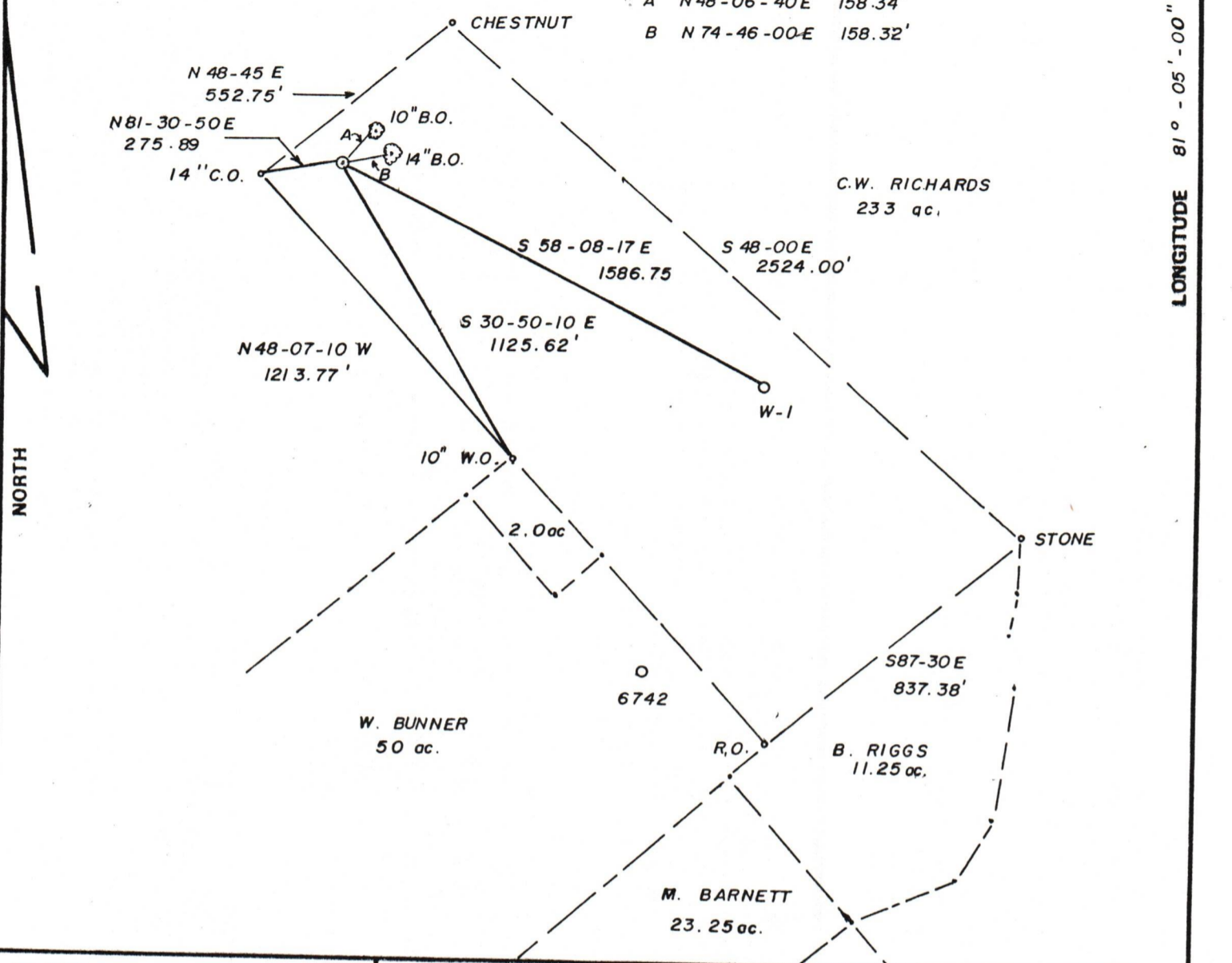

FILE NO. \_\_\_\_\_  
 DRAWING NO. \_\_\_\_\_  
 SCALE 1" = 500'  
 MINIMUM DEGREE OF ACCURACY 1 in 200  
 PROVEN SOURCE OF ELEVATION PROVEN ELEV = 1114 TOP OF POINT

I THE UNDERSIGNED, HEREBY CERTIFY THAT THIS PLAT IS CORRECT TO THE BEST OF MY KNOWLEDGE AND BELIEF AND SHOWS ALL THE INFORMATION REQUIRED BY LAW AND THE REGULATIONS ISSUED AND PRESCRIBED BY THE DEPARTMENT OF MINES.  
 (SIGNED) William G. Giberson  
 R.P.E. 5112 L.L.S. \_\_\_\_\_

PLACE SEAL HERE

(+) DENOTES LOCATION OF WELL ON UNITED STATES TOPOGRAPHIC MAPS  
 FORM IV-6 (8-78)



STATE OF WEST VIRGINIA  
 DEPARTMENT OF MINES  
 OIL AND GAS DIVISION

DATE JUNE 14, 19 84  
 OPERATOR'S WELL NO. 2  
 API WELL NO. 47-085-7070  
 STATE COUNTY PERMIT

WELL TYPE: OIL  GAS  LIQUID INJECTION \_\_\_\_\_ WASTE DISPOSAL \_\_\_\_\_  
 (IF "GAS,") PRODUCTION  STORAGE \_\_\_\_\_ DEEP \_\_\_\_\_ SHALLOW   
 LOCATION: ELEVATION 985 WATER SHED NORTH FORK HUGHES RIVER  
 DISTRICT GRANT COUNTY RITCHIE  
 QUADRANGLE HARRISVILLE 7.5'  
 SURFACE OWNER SALMONS ACREAGE 42.0  
 OIL & GAS ROYALTY OWNER JOHN FOSTER et. al. LEASE ACREAGE 65.25  
 LEASE NO. \_\_\_\_\_  
 PROPOSED WORK: DRILL  CONVERT \_\_\_\_\_ DRILL DEEPER \_\_\_\_\_ REDRILL \_\_\_\_\_ FRACTURE OR STIMULATE \_\_\_\_\_ PLUG OFF OLD FORMATION \_\_\_\_\_ PERFORATE NEW FORMATION \_\_\_\_\_ OTHER PHYSICAL CHANGE IN WELL (SPECIFY) \_\_\_\_\_  
 PLUG AND ABANDON \_\_\_\_\_ CLEAN OUT AND REPLUG \_\_\_\_\_  
 TARGET FORMATION DEVONIAN SHALE ESTIMATED DEPTH 5900'  
 WELL OPERATOR WESTERN RESERVE OBG CO. DESIGNATED AGENT D.E. SPENCER  
 ADDRESS 7845 EMERSON AVENUE ADDRESS SAME  
PARKERSBURG, W. Va

12/29/2023

RIT. 7070