

**BETHEL MILLER
103.67 ACRE LEASE**

UTM NAD 83
N: 4334122
E: 466055

FILE NO. _____
DRAWING NO. _____
SCALE 1" = 500'
MINIMUM DEGREE OF ACCURACY 1:200
PROVEN SOURCE OF ELEVATION GPS
OBSERVATION

I, THE UNDERSIGNED, HEREBY CERTIFY THAT THIS PLAT IS CORRECT TO THE BEST OF MY KNOWLEDGE AND BELIEF AND SHOWS ALL THE INFORMATION REQUIRED BY LAW AND THE REGULATIONS ISSUED AND PRESCRIBED BY THE DEPARTMENT OF ENERGY.

[Signature]
PROFESSIONAL SURVEYOR: 551



**STATE OF WEST VIRGINIA
DEPARTMENT OF ENERGY
DIVISION OF OIL AND GAS**

DATE APRIL 18TH 2013
OPERATORS WELL NO. BETHEL MILLER # 2

API 47 - 085 - 7605 W RE-Well
STATE COUNTY PERMIT

WELL TYPE: OIL GAS LIQUID INJECTION _____ WASTE DISPOSAL _____
(IF GAS) PRODUCTION STORAGE _____ DEEP _____ SHALLOW

LOCATION: ELEVATION 958' WATER SHED ROCKY FORK OF DEVILHOLE CREEK
DISTRICT GRANT COUNTY MITCHELL QUADRANGLE CAIRO

SURFACE OWNER THOMAS & MARIJANE YOST ACREAGE 4.000
OIL & GAS ROYALTY BETHEL MILLER HEIRS LEASE AC. 103.67

PROPOSED WORK: DRILL _____ CONVERT _____ DRILL DEEPER _____ REDRILL _____
FRACTURE OR STIMULATE _____ PLUG OFF OLD FORMATION _____
PERFORATE NEW FORMATION _____
OTHER PHYSICAL CHANGE IN WELL _____ NITROGEN SOLVENT CLEANOUT _____
PLUG AND ABANDON _____ CLEAN OUT AND REPLUG _____

TARGET FORMATION MISSISSIPPIAN SHALE ESTIMATED DEPTH 2048'

WELL OPERATOR VIRCO, INC. DESIGNATED AGENT KIMBERLY ARNOLD
ADDRESS 125 PUTNAM STREET ADDRESS P. O. BOX 154
MARIETTA, OH 45750 WAVERLY, WV 26184

FORM WV-5

COUNTY NAME

PERMIT

05/24/2013

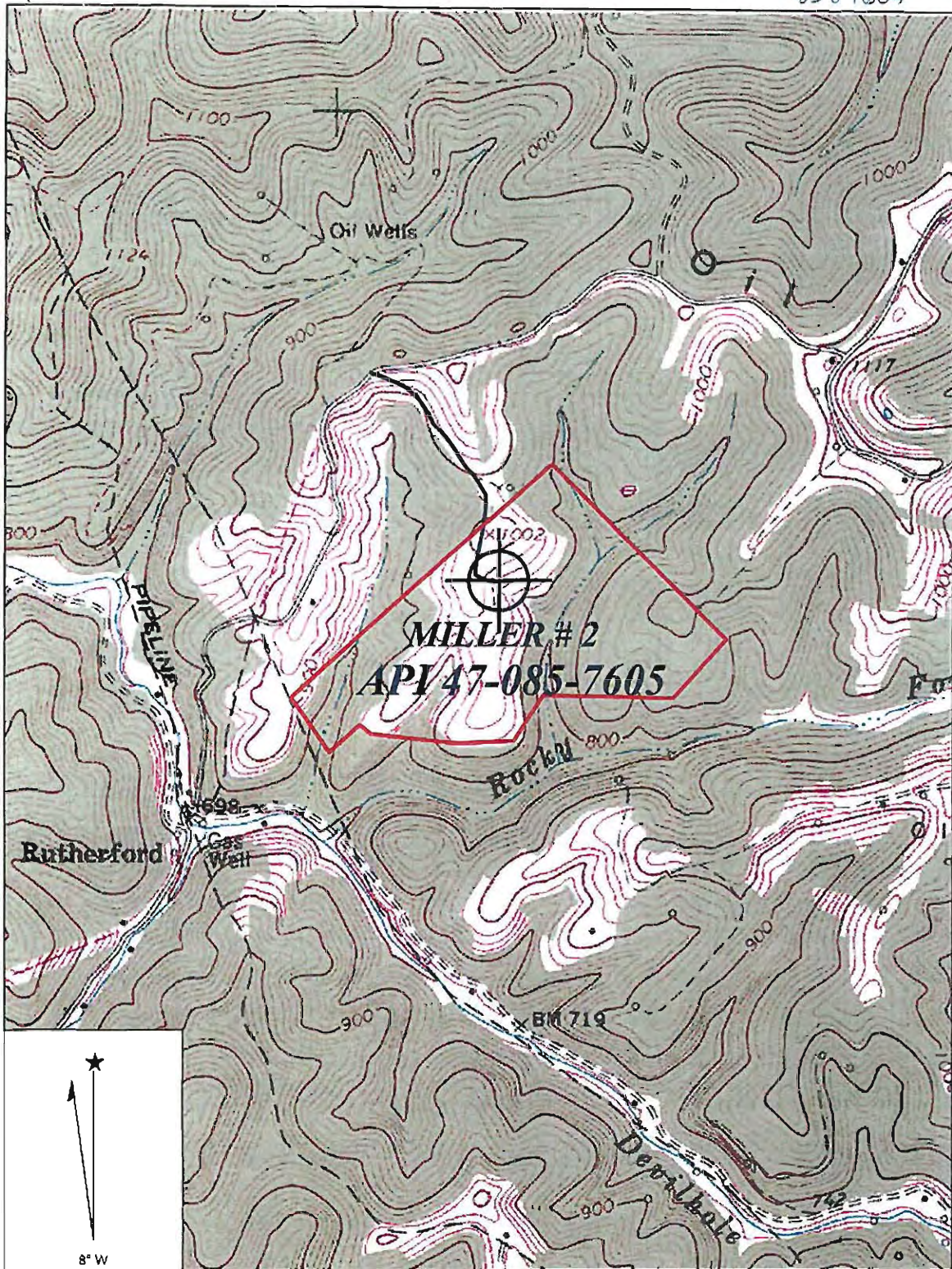

CAIRO QUADRANGLE

SCALE 1" = 1000'

VIRCO, INC.

WELL: MILLER # 2 API 47-085-7605
BETHEL MILLER HEIRS 103.67 ACRE LEASE

GRANT DISTRICT RITCHIE COUNTY WEST VIRGINIA

Dull

RECEIVED
U.S. DEPT. OF THE INTERIOR
BUREAU OF LAND MANAGEMENT

MAY 1 2013

Environmental

05/24/2013