

Jamie 4/12/90

HAYMOND LEASE

33 ACRES ±

WELL NO. C1

*0.345
0.65W*

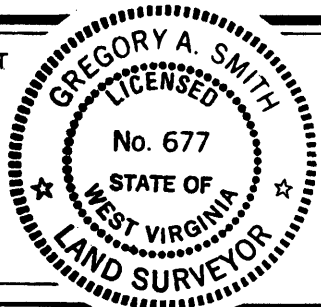
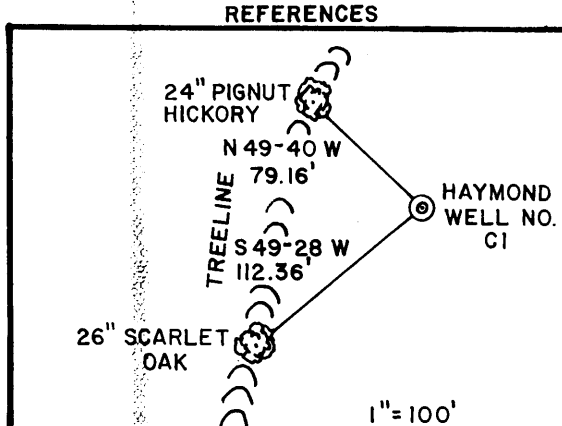

(+) DENOTES LOCATION OF WELL ON UNITED STATES TOPOGRAPHIC MAPS.
 DATE JANUARY 8, 19 90
 OPERATORS: WELL NO. HAYMOND WELL NO. C1
 API WELL NO. 47-085-7932
 STATE COUNTY PERMIT

I THE UNDERSIGNED, HEREBY CERTIFY THAT THIS PLAT IS CORRECT TO THE BEST OF MY KNOWLEDGE AND BELIEF AND SHOWS ALL THE INFORMATION REQUIRED BY LAW AND THE REGULATIONS ISSUED AND PRESCRIBED BY THE DEPARTMENT OF ENERGY.

L.L.S. Gregory A. Smith
677

MINIMUM DEGREE OF ACCURACY 1 / 200 FILE NO. 2218 (30-54)
 PROVEN SOURCE OF ELEVATION JUNCTION OF ROADS ELEV. 825' SCALE 1"=400'

STATE OF WEST VIRGINIA
 DEPARTMENT OF ENERGY
 OIL AND GAS DIVISION

WELL TYPE: OIL GAS LIQUID INJECTION WASTE DISPOSAL IF "GAS" PRODUCTION STORAGE DEEP SHALLOW
 LOCATION: ELEVATION 1019' WATERSHED NORTH FORK HUGHES RIVER West Union SW
 DISTRICT CLAY 1 COUNTY RITCHIE QUADRANGLE PENNSBORO 7.5'
 SURFACE OWNER HARVEY K., JR. & ANNIE B. HAYMOND ACREAGE 33
 ROYALTY OWNER HARVEY K., JR. & ANNIE B. HAYMOND et. al. LEASE ACREAGE 33
 PROPOSED WORK: LEASE NO. _____
 DRILL CONVERT DRILL DEEPER REDRILL FRACTURE OR STIMULATE PLUG OFF OLD FORMATION PERFORATE NEW FORMATION PLUG AND ABANDON CLEAN OUT AND REPLUG OTHER _____
 PHYSICAL CHANGE IN WELL (SPECIFY) _____ TARGET FORMATION ALEXANDER
 ESTIMATED DEPTH 5,800

WELL OPERATOR PARDKE GAS CO. DESIGNATED AGENT WILLIAM CARPENTER
 ADDRESS P.O. BOX 4119 ADDRESS P.O. BOX 4119
PARKERSBURG, WV. 26101 4568 PARKERSBURG, WV. 26101

LONGITUDE 80-55-08 EQUINOCT

COUNTY NAME PERMIT

RECEIVED

Division of Energy

JUL 30 90

Permitting
Oil and Gas Section

State of West Virginia
DEPARTMENT OF ENERGY
Division of Oil and Gas

11-Apr-90
API # 47- 85-07932

Well Operator's Report of Well Work

Farm name: HAYMOND, HARVEY & ANNIE Operator Well No.: HAYMOND C-1

LOCATION: Elevation: 1019.00 Quadrangle: PENNSBORO

District: CLAY County: RITCHIE
Latitude: 1900 Feet South of 39 Deg. 20Min. 0 Sec.
Longitude 3500 Feet West of 80 Deg. 55 Min. 0 Sec.

Company: PARDEE GAS COMPANY

4001 COLLEGE PKY. P.O. BX 4119 | Casing | Used in | Left | Cement

PARKERSBURG, WV 26104-4119

Agent:

Inspector: SAMUEL HERSMAN

Permit Issued: 04/11/90

Well work Commenced: 6/21/90

Well work Completed: 6/26/90

Verbal Plugging

Permission granted on:

Rotary Cable _____ Rig

Total Depth (feet) 5562

Fresh water depths (ft) 101

Salt water depths (ft) 871

Is coal being mined in area (Y/N)? N

Coal Depths (ft): N/A

& Tubing Size	Drilling	in Well	Fill Up Cu. Ft.
11 3/4	126	126	118 cuft
8 5/8	1854	1854	611 cuft
4 1/2	5261	5261	568 cuft

OPEN FLOW DATA

Producing formation Alexander/Benson Pay zone depth (ft) 5181-5190
 Gas: Initial open flow 950 MCF/d Oil: Initial open flow 4893-4899 Bbl/d
 Final open flow 640 MCF/d Final open flow _____ Bbl/d
 Time of open flow between initial and final tests 24 Hours
 Static rock Pressure 1680 psig (surface pressure) after 24 Hours

Second producing formation Pay zone depth (ft) _____
 Gas: Initial open flow _____ MCF/d Oil: Initial open flow _____ Bbl/d
 Final open flow _____ MCF/d Final open flow _____ Bbl/d
 Time of open flow between initial and final tests _____ Hours
 Static rock Pressure _____ psig (surface pressure) after _____ Hours

NOTE: ON BACK OF THIS FORM PUT THE FOLLOWING: 1). DETAILS OF PERFORATED INTERVALS, FRACTURING OR STIMULATING, PHYSICAL CHANGE, ETC. 2). THE WELL LOG WHICH IS A SYSTEMATIC DETAILED GEOLOGICAL RECORD OF ALL FORMATIONS, INCLUDING COAL ENCOUNTERED BY THE WELLBORE.

For: PARDEE GAS COMPANY

By: Linda C. Caputo AUG 6 1990
Date: 7/25/90

Haymond C-1

1st Stage - Alexander - Water/Sand Frac

Shot 16, .39 holes from 5181 feet to 5190 feet and broke down with 500 gals of 15% Fe Acid at a pressure of 1765 lbs. Ran 50 sacks of 80/100 mesh sand and 300 sacks of 20/40 mesh sand at an average rate of 27.4 BPM. For a total volumn of 487 bbls. Average treating pressure was 2503 lbs. with an ISIP of 1357 lbs. A total of 71,000 SCF of Nitrogen was used for assist.

2nd Stage - Benson - Water/Sand Frac

Shot 14, .39 holes from 4893 feet to 4896 feet and broke down with 500 gals of 15% Fe Acid at a pressure of 3480 lbs. Ran 50 sacks of 80/100 mesh sand and 300 sacks of 20/40 mesh sand at an average rate of 27.5 BPM. For a total volumn of 487 bbls. Average treating pressure was 2374 lbs. with and ISIP of 1433 lbs. A total of 75,000 SCF of Nitrogen was used for assist.

Formation	Color	Hard/Soft	Top	Bottom	
RR		soft	0	30	
Sand	Gray	hard	30	65	
Sandy shale	Gray	hard	65	134	hole wet 101
Sand	Gray	hard	134	165	
Sand	white	hard	165	205	
Sand/shale	red/gray	med	205	265	
Sand	white	hard	265	290	
Shale/sand	gray	med	290	350	
Sand	gray	med	350	500	
RR		soft	500	550	
Sand	gray	med	550	700	
Sand/shale	gray	med	700	850	
Sand	gray	med	850	875	hole wet 871
Sandy shale	gray	med	875	1190	
Sand	white	hard	1190	1330	
Sandy shale	gray	med	1330	1390	
Sandy	white	hard	1390	1415	
Sandy shale	gray	med	1415	1702	
Sand	white	hard	1702	1770	
Sandy shale	gray	med	1770	1790	
Lime		med	1790	1980	
Lime	gray	med	1980	1990	gas
Sand/shale	gray	med	1990	2540	
Shale	gray		2540	2860	
Shale	gray	med	2860	3560	
Shale	gray/brown	med	3560	4360	
Shale	gray	soft	4360	4980	
Shale	green	soft	4980	5560	

3/1/01

Issued 4/11/90
 Expires 4/11/92 Page ___ of ___

STATE OF WEST VIRGINIA
DEPARTMENT OF ENERGY, DIVISION OF OIL AND GAS
WELL WORK PERMIT APPLICATION

- 1) Well Operator: PARDEE GAS COMPANY 36880 (1) 538
- 2) Operator's Well Number: HAYMOND C-1 3) Elevation: 1019
- 4) Well type: (a) Oil ___ / or Gas X /
 (b) If Gas: Production ___ / Underground Storage ___ /
 Deep ___ / Shallow X /
- 5) Proposed Target Formation(s): 439 Benson, Alexander
- 6) Proposed Total Depth: 5500 feet
- 7) Approximate fresh water strata depths: 202' @ 370'
- 8) Approximate salt water depths: 1490'
- 9) Approximate coal seam depths: Possible Blosson @ 673'
- 10) Does land contain coal seams tributary to active mine? Yes ___ / No X /
- 11) Proposed Well Work: Drill & Stimulate New Well
- 12)

CASING AND TUBING PROGRAM

TYPE	SPECIFICATIONS			FOOTAGE INTERVALS		CEMENT
	Size	Grade	Weight per ft.	For drilling	Left in well	
Conductor	11 3/4			120	120	CTS
Fresh Water						
Coal						30CSR16 11.3
Intermediate	8 5/8	ERW	23 lbs.	1835'	1835'	by rule 38 CSR 18-11.2.2
Production	4 1/2	ERW	10.5 lbs.	5500'	5500'	by rule 38 CSR 18-11.1
Tubing						
Liners						

PACKERS : Kind _____
 Sizes _____
 Depths set _____

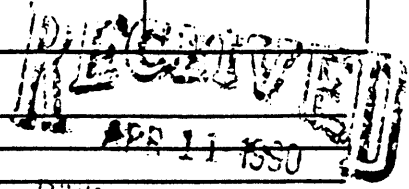

For Division of Oil and Gas Use Only

Fee(s) paid: Well Work Permit Reclamation Fund WPCP
 Plat WW-9 WW-2B Bond L.C. Agent
 (Type)

RECEIVED
APR 11 1990

DIVISION OF OIL & GAS
DEPARTMENT OF ENERGY

- 1) Date: 3/6/90
- 2) Operator's well number
Haymond #C1
- 3) API Well No: 47 - 085 - 7932
State - County - Permit

STATE OF WEST VIRGINIA
DEPARTMENT OF ENERGY, DIVISION OF OIL AND GAS

NOTICE AND APPLICATION FOR A WELL WORK PERMIT

- 4) Surface Owner(s) to be served:
 - (a) Name Harvey K. & Annie B. Haymond
 - Address Pennsboro, WV
 - (b) Name _____
 - Address _____
 - (c) Name _____
 - Address _____
- 5) (a) Coal Operator:
 - Name _____
 - Address N/A
 - (b) Coal Owner(s) with Declaration
 - Name _____
 - Address _____
 - Name N/A
 - Address _____
 - (c) Coal Lessee with Declaration
 - Name _____
 - Address _____
- 6) Inspector Samuel Hersman
- Address Rt. 1 Box 240
- Harrisville, WV 26362
- Telephone (304) - 628-3185

TO THE PERSON(S) NAMED ABOVE TAKE NOTICE THAT:

_____ Included is the lease or leases or other continuing contract or contracts by which I hold the right to extract oil and gas OR
X Included is the information required by Chapter 22B, Article 1, Section 8(d) of the Code of West Virginia (see page 2)

I certify that as required under Chapter 22B of the West Virginia Code I have served copies of this notice and application, a location plat, and accompanying documents pages 1 through _____ on the above named parties, by:

- _____ Personal Service (Affidavit attached)
- _____ Certified Mail (Postmarked postal receipt attached)
- _____ Publication (Notice of Publication attached)

I have read and understand Chapter 22B and 38 CSR 11-18, and I agree to the terms and conditions of any permit issued under this application.

I certify under penalty of law that I have personally examined and am familiar with the information submitted on this application form and all attachments, and that based on my inquiry of those individuals immediately responsible for obtaining the information, I believe that the information is true, accurate, and complete.

I am aware that there are significant penalties for submitting false information, including the possibility of fine and imprisonment.

Well Operator The Coastal Corporation
 By: Charles M. Davis Jr
 Its: Field Supervisor
 Address P. O. Box 4119
Parkersburg, WV 26104
 Telephone 304-428-3471

Subscribed and sworn before me this 6th day of March, 19 90

Debra Ann M... Notary Public
 My commission expires May 24, 1999