

85 09173 P

WW-7  
8-30-06



West Virginia Department of Environmental Protection  
Office of Oil and Gas  
**WELL LOCATION FORM: GPS**

API: 47-085-09173 WELL NO.: 4

FARM NAME: Mary Shanley

RESPONSIBLE PARTY NAME: Hall Drilling, LLC

COUNTY: Ritchie DISTRICT: Clay

QUADRANGLE: Ellenboro 7.5'

SURFACE OWNER: Tech Service Center

ROYALTY OWNER: Tech Service Center

UTM GPS NORTHING: 4,348,625

UTM GPS EASTING: 498,555 GPS ELEVATION: 310 m. <sup>(1017')</sup>

The Responsible Party named above has chosen to submit GPS coordinates in lieu of preparing a new well location plat for a plugging permit or assigned API number on the above well. The Office of Oil and Gas will not accept GPS coordinates that do not meet the following requirements:

- Datum: NAD 1983, Zone: 17 North, Coordinate Units: meters, Altitude: height above mean sea level (MSL) – meters.
- Accuracy to Datum – 3.05 meters
- Data Collection Method:

Survey grade GPS  : Post Processed Differential

Real-Time Differential

Mapping Grade GPS  : Post Processed Differential

Real-Time Differential

- Letter size copy of the topography map showing the well location.**

I the undersigned, hereby certify this data is correct to the best of my knowledge and belief and shows all the information required by law and the regulations issued and prescribed by the Office of Oil and Gas.

*CMT Hall*  
Signature

Designated Agt.  
Title

9-6-17  
Date

RECEIVED  
Office of Oil and Gas

SEP 20 2017

WV Department of  
Environmental Protection

10/20/2017



SUBJECT WELL  
Mary Shanley No.4  
47-085-09173

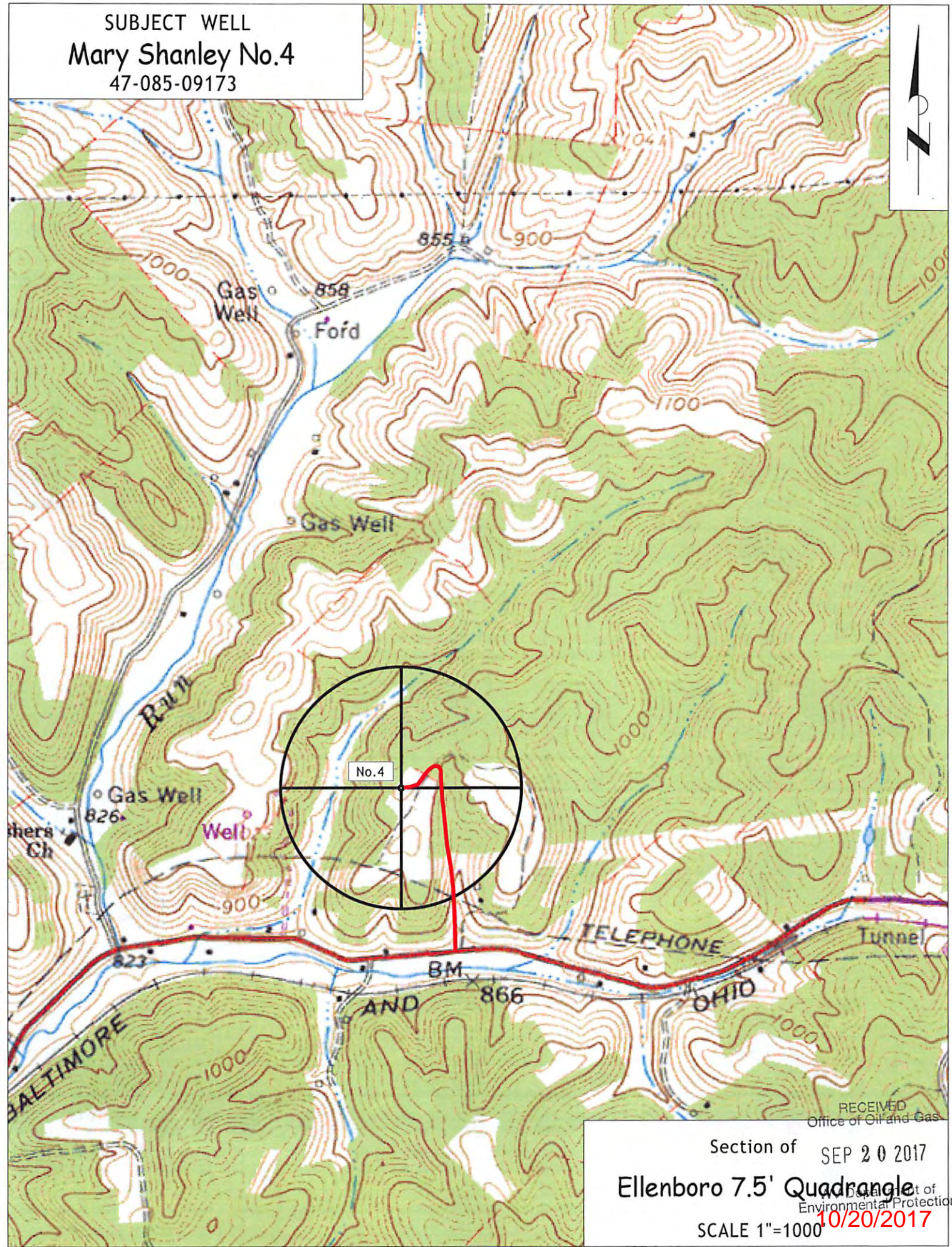

RECEIVED  
Office of Oil and Gas

Section of SEP 20 2017  
Ellenboro 7.5' Quadrangle  
SCALE 1"=1000  
10/20/2017  
U.S. Department of Environmental Protection