

FILE NO. _____
 DRAWING NO. 06-125-4
 SCALE 1" = 1000'
 MINIMUM DEGREE OF ACCURACY 1 IN 200
 PROVEN SOURCE OF ELEVATION G.P.S.

I THE UNDERSIGNED, HEREBY CERTIFY THAT THIS PLAT IS CORRECT TO THE BEST OF MY KNOWLEDGE AND BELIEF AND SHOWS ALL THE INFORMATION REQUIRED BY LAW AND THE REGULATIONS ISSUED AND PRESCRIBED BY THE DEPARTMENT OF ENERGY.

(SIGNED) _____

R.P.E. _____ L.L.S. 851

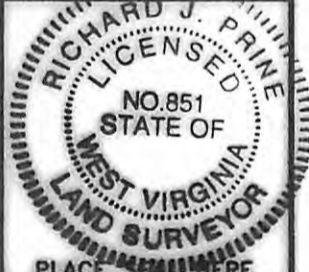

STATE OF WEST VIRGINIA
 Division of Environmental Protection
 OFFICE OF OIL AND GAS

DATE 04-06, 2006

OPERATOR'S WELL NO. #P4

API WELL NO. 47-085-09339

STATE WV COUNTY CLAY PERMIT RITCHIE

WELL TYPE: OIL GAS LIQUID INJECTION _____ WASTE DISPOSAL _____
 (IF "GAS") PRODUCTION STORAGE _____ DEEP _____ SHALLOW

LOCATION: ELEVATION 1083 WATER SHED NORTH FORK HUGHES RIVER
 DISTRICT CLAY COUNTY RITCHIE
 QUADRANGLE PENNSBORO

SURFACE OWNER TERESA CINQMARS ACREAGE 64.7
 OIL & GAS ROYALTY OWNER HAUGHT FAMILY TRUST LEASE ACREAGE 322 AC. 33 pl
 LEASE NO. _____

PROPOSED WORK: DRILL CONVERT _____ DRILL DEEPER _____ REDRILL _____ FRACTURE OR STIMULATE PLUG OFF OLD FORMATION _____ PERFORATE NEW FORMATION _____ OTHER PHYSICAL CHANGE IN WELL (SPECIFY): _____

PLUG AND ABANDON _____ CLEAN OUT AND REPLUG _____

TARGET FORMATION RHINESTREET ESTIMATED DEPTH 5,900'
 WELL OPERATOR PETROEDGE RESOURCES (WV), LLC. DESIGNATED AGENT WARREN HAUGHT
 ADDRESS 10375 RICHMOND AVE. SUITE 850 ADDRESS HC 68 BOX 14
HOUSTON TX, 77042 SMITHVILLE, WV 26178

08/09/2013