

(+) DENOTES LOCATION OF WELL ON UNITED STATES TOPOGRAPHIC MAPS

FILE NO. _____
DRAWING NO. 08-38
SCALE 1"=2000'
MINIMUM DEGREE OF ACCURACY 1 IN 200
PROVEN SOURCE OF ELEVATION GPS

I THE UNDERSIGNED, HEREBY CERTIFY THAT THIS PLAT IS CORRECT TO THE BEST OF MY KNOWLEDGE AND BELIEF AND SHOWS ALL THE INFORMATION REQUIRED BY LAW AND THE REGULATIONS ISSUED AND PRESCRIBED BY THE DEPARTMENT OF ENERGY.
(SIGNED) _____
R.P.E. _____ I.L.S. 851

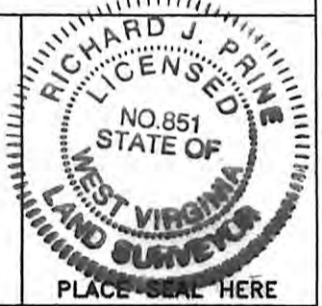

STATE OF WEST VIRGINIA
Division of Environmental Protection
OFFICE OF OIL AND GAS

DATE 5/8, 20 08
OPERATOR'S WELL NO. MCQUAIN #8
API WELL NO. 47-085-09745
STATE WV COUNTY MCQUAIN PERMIT 09745

WELL TYPE: OIL GAS LIQUID INJECTION WASTE DISPOSAL
(IF "GAS") PRODUCTION STORAGE DEEP SHALLOW

LOCATION: ELEVATION 1265 WATER SHED LYNNCAMP RUN OF LEATHERBARK CREEK
DISTRICT MURPHY COUNTY RITCHIE
QUADRANGLE SMITHVILLE

SURFACE OWNER COASTAL LUMBER CO. ACREAGE 523
OIL & GAS ROYALTY OWNER RUSSELL MCQUAIN & OTHERS LEASE ACREAGE 523
LEASE NO. _____

PROPOSED WORK: DRILL CONVERT DRILL DEEPER REDRILL FRACTURE OR STIMULATE PLUG OFF OLD FORMATION PERFORATE NEW FORMATION OTHER PHSYICAL CHANGE IN WELL (SPECIFY): _____

PLUG AND ABANDON CLEAN OUT AND REPLUG

TARGET FORMATION GORDON ESTIMATED DEPTH 3200
WELL OPERATOR MEGAN OIL & GAS INC. DESIGNATED AGENT ROY G. HILDRETH JR.
ADDRESS PO. BOX 1007 ADDRESS PO. BOX 1007
SPENCER, WV 25276 SPENCER, WV 25276

CANCELLED