

Well is located on topo map 13,960' feet south of Latitude: 39° 22' 30"

SURFACE HOLE LOCATION (SHL)
UTM 17-NAD83
N:4354136.49
E:498916.89
 NAD27, WV NORTH
 N:308299.73
 E:1572143.52
 LAT/LON DATUM-NAD83
 LAT:39.336653
 LON:-81.012568

APPROX. LANDING POINT
UTM 17-NAD83
N:4354163.24
E:498671.23
 NAD27, WV NORTH
 N:308401.00
 E:1571338.84
 LAT/LON DATUM-NAD83
 LAT:39.336894
 LON:-81.015419

BOTTOM HOLE LOCATION (BHL)
UTM 17-NAD83
N:4356335.92
E:496786.86
 NAD27, WV NORTH
 N:315634.07
 E:1565274.24
 LAT/LON DATUM-NAD83
 LAT:39.356466
 LON:-81.037295

LEGEND

- ⊕ - TOPO MAP POINT
- ☼ - WELL
- - ALL ARE POINTS UNLESS OTHERWISE NOTED.
- ⊙ - WATER SOURCE
- ⓪ - LEASE NUMBER BASED ON ATTACHED WW-6A1
- - - - - MINERAL TRACT BOUNDARY
- - - - - PARCEL LINES
- - - - - WELL REFERENCE
- - - - - PROPOSED HORIZONTAL WELL
- - - - - ROAD
- - - - - STREAM CENTER LINE
- WELLS WITHIN 3000'**
- - EXISTING WELLS
- ⦿ - PLUGGED WELLS

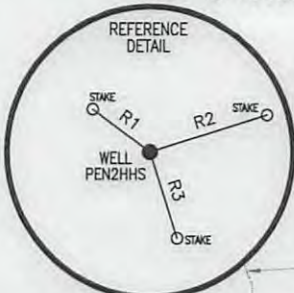

LINE	BEARING	DISTANCE
R1	N 53°50'38" W	149.56'
R2	N 72°28'22" E	257.11'
R3	S 17°37'04" E	187.65'
R4	N 58°44'52" W	1806.16'
R5	N 19°32'56" W	1811.34'
R6	N 16°05'47" E	1637.50'

- NOTES:
1. There are no water wells or developed springs within 250' of proposed well.
 2. There are no existing buildings within 625' of proposed well.
 3. Proposed well is greater than 100' from perennial stream, wetland, pond, reservoir or lake.
 4. There are no native trout streams within 300' of proposed well.
 5. Proposed well is greater than 1000' from surface/groundwater intake or public water supply.
 6. It is not the purpose or intention of this plat to represent surveyed locations of the surface or mineral parcels depicted hereon. The location of the boundary lines, as shown, are based on record deed descriptions, field evidence found and/or tax map position, unless otherwise noted.



Blue Mountain Inc.
 11023 MASON DIXON HIGHWAY
 BURTON, WV 26562
 PHONE: (304) 662-6486

Well is located on topo map 3,551' feet west of Longitude: 81° 00' 00"

FILE #: PEN2HHS
 DRAWING #: PEN2HHS
 SCALE: 1" = 2000'
 MINIMUM DEGREE OF ACCURACY: 1/2500
 PROVEN SOURCE OF ELEVATION: U.S.G.S. MONUMENT THOMAS 1498.81'

I, THE UNDERSIGNED, HEREBY CERTIFY THAT THIS PLAT IS CORRECT TO THE BEST OF MY KNOWLEDGE AND BELIEF AND SHOWS ALL THE INFORMATION REQUIRED BY LAW AND THE REGULATIONS ISSUED AND PRESCRIBED BY THE DEPARTMENT OF ENVIRONMENTAL PROTECTION.

Signed: *[Signature]*
 R.P.E.: _____ L.L.S.: P.S. No. 2000

GEORGE D. SIX
LICENSED
No. 2000
STATE OF WEST VIRGINIA
PROFESSIONAL SURVEYOR

PLACE SEAL HERE

(+) DENOTES LOCATION OF WELL ON UNITED STATES TOPOGRAPHIC MAPS WVDEP
 OFFICE OF OIL & GAS
 601 57TH STREET
 CHARLESTON, WV 25304



DATE: OCTOBER 15, 2013
 OPERATOR'S WELL #: PEN2HHS
 API WELL #: 47 85 10073
 STATE COUNTY PERMIT

Well Type: Oil Waste Disposal Production Deep
 Gas Liquid Injection Storage Shallow

WATERSHED: NORTH FORK HUGHES RIVER ELEVATION: 1084'±
 COUNTY/DISTRICT: RITCHIE / CLAY QUADRANGLE: ELLENBORO, WV 7.5'
 SURFACE OWNER: TERRY & HELEN KIESSLING ACREAGE: 79.242±
 OIL & GAS ROYALTY OWNER: SEE ATTACHED WW-6A1 ACREAGE: 514.618±

DRILL CONVERT DRILL DEEPER REDRILL FRACTURE OR STIMULATE
 PLUG OFF OLD FORMATION PERFORATE NEW FORMATION PLUG & ABANDON
 CLEAN OUT & REPLUG OTHER CHANGE (SPECIFY): _____

TARGET FORMATION: MARCELLUS ESTIMATED DEPTH: TVD: 6,314'± TMD: 16,331'±
 WELL OPERATOR NOBLE ENERGY, INC. DESIGNATED AGENT STEVEN M. GREEN
 Address 333 TECHNOLOGY DRIVE, SUITE 116 Address 500 VIRGINIA STREET EAST, UNITED CENTER SUITE 590
 City CANONSBURG State PA Zip Code 15317 City CHARLESTON State WV Zip Code 25301

plat spotted
C/AV

85 10073

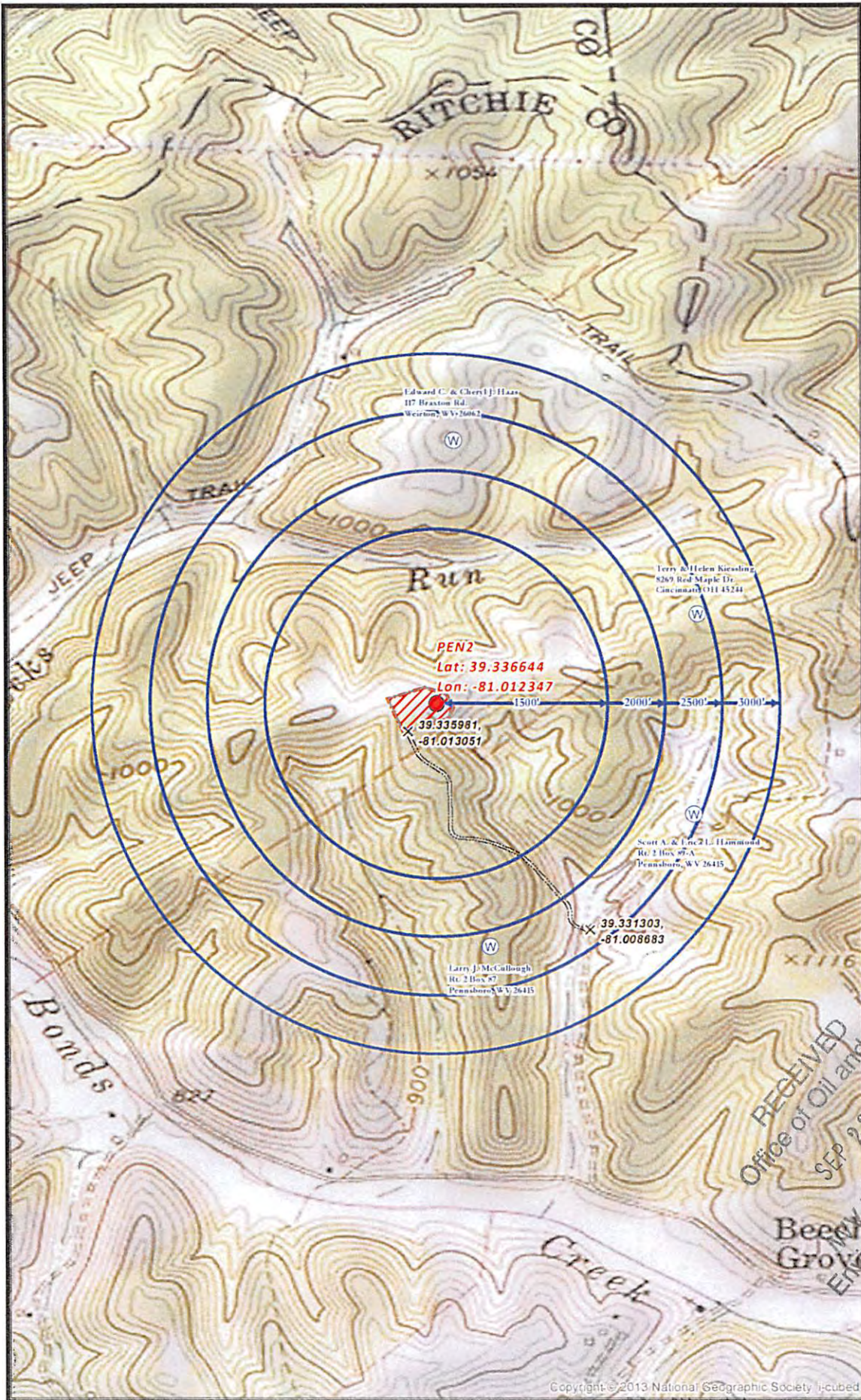

RECEIVED
Office of Oil and Gas
SEP 28 2013
U.S. Department of
Environmental Protection

PENS2 SITE SAFETY PLAN
- WATER WELLS PROXIMITY -

Water Well Buffer
 Proposed Road
 Road Intersection
 Well Pad Boundary

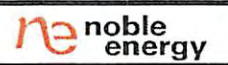
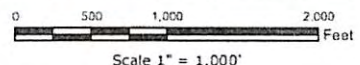

Disclaimer: All data is licensed for use by Noble Energy Inc. use only.

Date: 7/31/2013
Author: Christopher Glover

6/6