

NOTES:
WELL 1H TOP HOLE INFORMATION:
 N: 294,396ft E: 1,581,674ft
 LAT: 39°17'55.83" LON: 80°58'41.66"
BOTTOM HOLE INFORMATION:
 N: 301,538ft E: 1,580,023ft
 LAT: 39°19'06.15" LON: 80°59'04.15"
 WEST VIRGINIA COORDINATE SYSTEM OF 1927 NORTH ZONE. ZONE WAS DERIVED FROM MEASUREMENTS TAKEN WITH TRIMBLE GEOXT SUBMETER MAPPING GRADE GPS UNIT. PLAT ORIENTATION, CORNER, AND WELL REFERENCE TIE LINES ARE BASED ON GRID NORTH.

(NAD) 83 (UTM) ZONE 17 COORDS:
WELL 1H TOP HOLE INFORMATION:
 N: 4,349,949m E: 501,891m
BOTTOM HOLE INFORMATION:
 N: 4,352,117m E: 501,352m

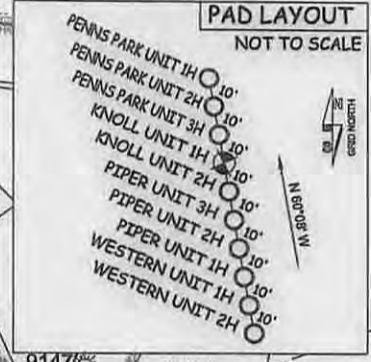

NOTE:
 NO OCCUPIED DWELLINGS OR BUILDINGS TWO THOUSAND FEET (610) SQUARE FEET OR LARGER USED TO HOUSE OR SHELTER DAIRY CATTLE OR POULTRY HUSBANDRY ARE LOCATED WITHIN SIX HUNDRED TWENTY-FIVE (625) FEET OF THE CENTER OF THE WELL PAD.

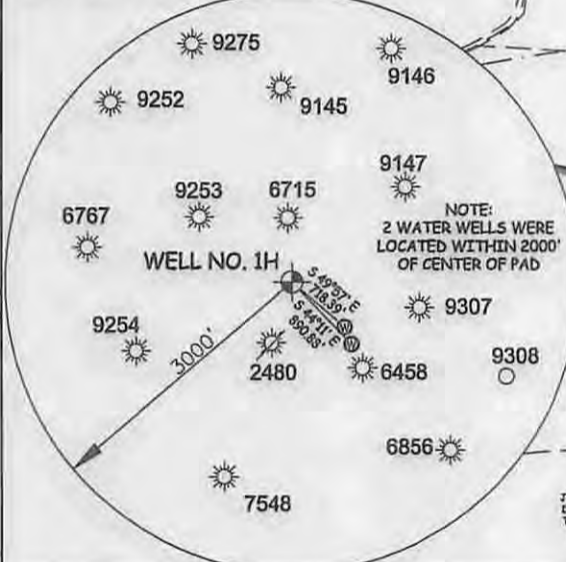

JOB # 14-003WA
 DRAWING # KNOLL1HR
 SCALE 1" = 1000'
 MINIMUM DEGREE OF ACCURACY SUBMETER
 PROVEN SOURCE OF ELEV. SUBMETER MAPPING GRADE GPS

I THE UNDERSIGNED, HEREBY CERTIFY THAT THIS PLAT IS CORRECT TO THE BEST OF MY KNOWLEDGE AND BELIEF AND SHOWS ALL THE INFORMATION REQUIRED BY LAW AND THE RULES ISSUED AND PERSCRIBED BY THE DEPARTMENT OF ENVIRONMENTAL PROTECTION.



STATE OF WEST VIRGINIA, DIVISION OF ENVIRONMENTAL PROTECTION, OFFICE OF OIL AND GAS
 WILLOW LAND SURVEYING PLLC
 266 HUSHERS RUN RD PENNSBORO WEST VIRGINIA 26415

LEGEND
 --- Surface Owner Boundary Lines +/-
 - - - Interior Surface Tracts +/-
 X Existing Fence
 ⊕ Rebar, Found

THOMAS SUMMERS P.S. 2109
 DATE 05/18/15
 OPERATOR'S WELL# KNOLL UNIT 1H

STATE OF WEST VIRGINIA DEPARTMENT OF ENERGY DIVISION OF OIL AND GAS
 WELL TYPE: OIL GAS X LIQUID INJECTION WASTE DISPOSAL
 (IF "GAS") PRODUCTION X STORAGE DEEP SHALLOW X
 LOCATION: ELEVATION 1,159' ORIGINAL - 1,143' PROPOSED WATERSHED NORTH FORK HUGHES RIVER
 QUADRANGLE PENNSBORO 7.5' DISTRICT CLAY COUNTY RITCHIE
 SURFACE OWNER DARRELL A. NOLAND ET AL ACREAGE 32.5 ACRES +/-
 OIL & GAS ROYALTY OWNER MARY V. WEDEKAMM; C.E. GIEBELL; DAVID L. MAPLE; APPALACHIAN ROYALTIES, INC. LEASE ACREAGE 32.5 ACRES +/-; 44 ACRES +/-; 54.25 ACRES +/-; 372.5 ACRES +/-
 PROPOSED WORK: DRILL X CONVERT DRILL DEEPER REDRILL FRACTURE OR STIMULATE X
 PLUG OFF OLD FORMATION PERFORATE NEW FORMATION X OTHER PHYSICAL CHANGE IN WELL (SPECIFY) MOD-BHL PLUG & ABANDON CLEAN OUT & REPLUG
 TARGET FORMATION MARCELLUS ESTIMATED DEPTH 6,500' TVD 14,500 MD
 WELL OPERATOR ANTERO RESOURCES CORP. DESIGNATED AGENT DIANNA STAMPER
 ADDRESS 1615 WYNKOOP STREET ADDRESS 5400 D BIG TYLER ROAD
DENVER, CO 80202 CHARLESTON, WV 25313

06/05/2015

COUNTY NAME PERMIT