

**EQT PRODUCTION COMPANY  
W.M. ADAMS LEASE  
402 ACRES±  
WELL NO. WV 512428**

(S.P.C. NORTH ZONE) (UTM(M) ZONE 17 NORTH)

NAD'27 S.P.C.(FT) N. 233,074.50 E. 1,622,411.30  
 NAD'27 GEO. LAT-(N) 39.132246 LONG-(W) 80.831096  
 NAD'83 UTM (M) N. 4,331,475.36 E. 514,613.39

**LANDING POINT**

NAD'27 S.P.C.(FT) N. 234,226.89 E. 1,624,300.97  
 NAD'27 GEO. LAT-(N) 39.135486 LONG-(W) 80.824495  
 NAD'83 UTM (M) N. 4,331,836.04 E. 515,183.21

**BOTTOM HOLE**

NAD'27 S.P.C.(FT) N. 226,689.78 E. 1,626,878.96  
 NAD'27 GEO. LAT-(N) 39.114898 LONG-(W) 80.815019  
 NAD'83 UTM (M) N. 4,329,553.04 E. 516,006.89

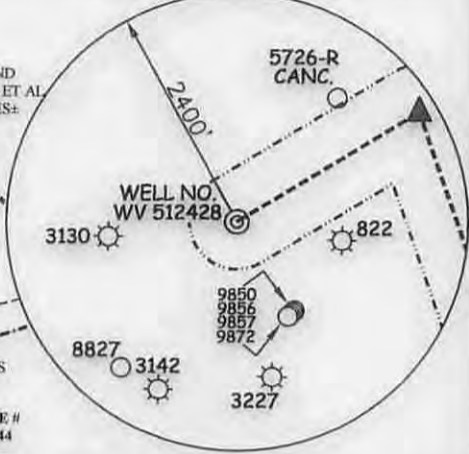

A	MALAKI SPENCER	7.204 ACRES±
B	ZAVADA & SUNRAK SPENCER	7.202 ACRES±
C	MELVIN & MARY BRITTON	7.226 ACRES±
D	CAZJUN SPENCER	2.278 ACRES±
E	CHIARA RUMMEL	7.204 ACRES±
F	CEMETERY	0.467 ACRES±
G	MELVIN BRITTON	3.57 ACRES±
H	RANDALL & DEBBY FARLEY	42.92 ACRES±
I	COASTAL FOREST RESOURCES COMPANY d/b/a COASTAL TIMBERLANDS COMPANY	145.192 ACRES±
J	JEFFREY A. SPERRY	72.86 ACRES±
K	COASTAL FOREST RESOURCES COMPANY d/b/a COASTAL TIMBERLANDS COMPANY	416.61 ACRES±
L	EQUITRANS INC	0.632 ACRES±
M	COASTAL FOREST RESOURCES COMPANY d/b/a COASTAL TIMBERLANDS COMPANY	3.51 ACRES±
N	JIMMIE & EILEEN BURKE	9.68 ACRES±
O	MARVIN EDWARDS JR	1 ACRE±

**LEGEND**

LEASE LINE	---
SURFACE LINE	---
WELL LATERAL	---
OFFSET LINE	---
TIE LINE	---
CREEK	---
ROAD	---
FENCE LINE	---
COUNTY ROUTE	---
PROPOSED WELL	⊙
EXISTING WELL	⊙
PERMITTED WELL	⊙
RITCHIE COUNTY UNION DISTRICT TAX MAP-PARCEL	TM U-00-00
DODDRIDGE COUNTY SOUTHWEST DISTRICT TAX MAP-PARCEL	TM SW-00-00

**ROYALTY OWNERS**

ADELE McDOUGAL ET AL	2000 AC±	LEASE NO. 109481
MICHAEL M. MCKENZIE ET AL	57 AC±	LEASE NO. 987352
MICHAEL M. MCKENZIE ET AL	199.75 AC±	LEASE NO. 987351

**NOTES ON SURVEY**

- NO WATER WELLS WERE FOUND WITHIN 250' OF PROPOSED GAS WELL. NO AGRICULTURAL BUILDINGS ≥ 2500 SQ. FT. OR DWELLINGS WERE FOUND WITHIN 625' OF THE CENTER OF PROPOSED WELL PAD.



**REFERENCES**

(+) DENOTES LOCATION OF WELL ON UNITED STATES TOPOGRAPHIC MAPS.

DATE JANUARY 13, 20 14

REVISED JULY 10 15

OPERATORS WELL NO. WV 512428

API WELL NO. 47-085-1023646A

STATE WEST VIRGINIA COUNTY TRUY PERMIT 1023646A



I THE UNDERSIGNED, HEREBY CERTIFY THAT THIS PLAT IS CORRECT TO THE BEST OF MY KNOWLEDGE AND BELIEF AND SHOWS ALL THE INFORMATION REQUIRED BY LAW AND THE REGULATIONS ISSUED AND PRESCRIBED BY THE DIVISION OF ENVIRONMENTAL PROTECTION.

P.S. C. Victor Moyers

MINIMUM DEGREE OF ACCURACY 1/2500 FILE NO. 6811P512428R3

HORIZONTAL & VERTICAL CONTROL DETERMINED BY DGPS (SURVEY GRADE TIE TO CORS NETWORK) SCALE 1" = 2000'

STATE OF WEST VIRGINIA  
DIVISION OF ENVIRONMENTAL PROTECTION  
OFFICE OF OIL AND GAS

WELL TYPE: OIL  GAS  LIQUID INJECTION  WASTE DISPOSAL  IF "GAS" PRODUCTION  STORAGE  DEEP  SHALLOW

LOCATION: ELEVATION 1,111'(PAD ELEVATION) WATERSHED STRAIGHT FORK

DISTRICT UNION COUNTY RITCHIE QUADRANGLE OXFORD 7.5'

SURFACE OWNER RICHARD L. & SHERYL A. RAY ACREAGE 255.50±

ROYALTY OWNER HAUGHT FAMILY TRUST ET AL ACREAGE 402±

PROPOSED WORK: DRILL  CONVERT  DRILL DEEPER  REDRILL  FRACTURE OR STIMULATE  PLUG OFF OLD FORMATION  PERFORATE NEW FORMATION  PLUG AND ABANDON  CLEAN OUT AND REPLUG  OTHER

PHYSICAL CHANGE IN WELL (SPECIFY) \_\_\_\_\_ TARGET FORMATION MARCELLUS

ESTIMATED DEPTH TVD 6,461'

WELL OPERATOR EQT PRODUCTION COMPANY DESIGNATED AGENT REX C. RAY

ADDRESS 115 PROFESSIONAL PLACE P.O. BOX 280 BRIDGEPORT, WV 26330 ADDRESS 115 PROFESSIONAL PLACE P.O. BOX 280 BRIDGEPORT, WV 26330



NOTE: SEE SITE PLAN  
OXF122 FOR COMPLETE  
CONSTRUCTION &  
EROSION & SEDIMENT  
CONTROL DETAILS.

MATCH LINE

SHEET 2 OF 2  
SCALE: 1"=500'

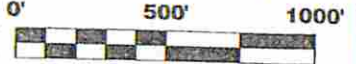

Detail Sketch for Proposed OXF122 Well No.s WV 512426, WV 512427, WV 512428, WV 512500, WV 512501, WV 513762, WV 514081 & WV 514082

Not To Scale

NOTE: SEE SITE PLAN  
OXF122 FOR COMPLETE  
CONSTRUCTION &  
EROSION & SEDIMENT  
CONTROL DETAILS.

Received  
Office of Oil & Gas

JUL 30 2015



SURVEYORS  
ENGINEERS  
ENVIRONMENTAL  
PROJECT MGMT.

DRAWN BY: K.D.W. FILE NO.: 6811 DATE: 07-02-15 CADD FILE: 6811RECPLAN.dwg

TOPO SECTIONS OF OXFORD 7.5'  
TOPO QUADRANGLE

09/04/2015