

EQT PRODUCTION COMPANY
WELL NO. 516215 - Ashley E. Ness, Jr. et al
PAGE 2 OF 2

LATITUDE 39°32'30" TH 5245'
LATITUDE 39°32'30" BH 105'

- NOTES
1. THERE ARE NO WATER WELLS OR DEVELOPED SPRINGS WITHIN 250' OF THE PROPOSED WELL.
 2. PERENNIAL STREAM, WETLAND, POND, RESERVOIR OR LAKE - THERE ARE WETLANDS LOCATED WITHIN 100 FEET OF THE PROPOSED PAD, LOD, OR E&S CONTROL. REFER TO WETLAND WAIVER REQUEST ASSOCIATED WITH THIS PERMIT APPLICATION FOR MORE DETAIL.
 3. THERE ARE NO NATIVE TROUT STREAMS WITHIN 300' OF PROPOSED PAD, LOD, OR E&S CONTROL FEATURE.
 4. PROPOSED PAD, LOD, OR E&S CONTROL FEATURE IS GREATER THAN 1000' FROM SURFACE OR GROUND-WATER INTAKE OF PUBLIC WATER SUPPLY.
 5. CENTER OF PAD IS 625 FEET FROM OCCUPIED DWELLING STRUCTURE AND AGRICULTURAL BUILDINGS LARGER THAN 2500 SQUARE FEET.
 6. IT IS NOT THE INTENTION OF THIS PLAT TO REPRESENT A COMPLETE BOUNDARY SURVEY OF THE PARCELS SHOWN HEREON. BOUNDARIES AS SHOWN TAKEN FROM RECORD DEED DESCRIPTIONS, TAX MAPS, AND SUPPLEMENTAL FIELD SURVEY.
 7. OWNERSHIP DATA GATHERED FROM COUNTY PUBLIC TAX AND DEED RECORDS.
 8. LATERAL GEOMETRY BASED ON WEST VIRGINIA SPC NORTH, NAD 27 DATUM

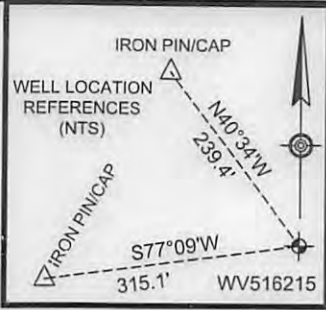

LEGEND

- OUTER LEASE BOUNDARY
- LEASE BOUNDARY
- SURFACE TRACT LINES
- WELL REFERENCE LINES
- ⊙ - COUNTY ROADS
- ⊙ - PUBLIC ROADS
- BLUE-LINE STREAMS
- ⊙ - PROPOSED WELL
- ⊙ - EXISTING WELL
- ▲ - LANDING POINT
- ⊗ - BOTTOM HOLE
- 1 - PROPERTY CROSSED BY BORE
- A - ADJOINER PROPERTY TAB



FILE NO. 7936-002
 DRAWN BY DMS
 SCALE 1 INCH = 2000 FEET
 MIN DEGREE OF ACCURACY 1 IN 2500
 PROVEN SOURCE OF ELEVATION SURVEY GRADE GPS

I, THE UNDERSIGNED, HEREBY CERTIFY THAT THIS PLAT IS CORRECT TO THE BEST OF MY KNOWLEDGE AND BELIEF AND SHOWS ALL THE INFORMATION REQUIRED BY LAW AND THE REGULATIONS ISSUED AND PRESCRIBED BY THE DIVISION OF ENVIRONMENTAL PROTECTION

David M. Shannon
 P.S. #2034

DAVID M. SHANNON
 LICENSED
 No. 2034
 STATE OF
 WEST VIRGINIA
 PROFESSIONAL SURVEYOR

(+) DENOTES LOCATION OF WELL ON UNITED STATES TOPOGRAPHIC MAPS

LDG

W.V.D.E.P. OFFICE OF OIL AND GAS
 601 57TH STREET
 CHARLESTON, WV 25304

DATE 1-5-2017
 OPERATORS WELL NO. WV516215
 API WELL NO. 47 085 1026146A
 STATE COUNTY PERMIT

WELL TYPE: OIL GAS LIQUID INJECTION WASTE DISPOSAL
 IF "GAS", PRODUCTION STORAGE DEEP SHALLOW
 LOCATION: WATERSHED BUZZARD RUN - NORTH FORK HUGHES RIVER ELEVATION (EXIST) 945.0 (PROP) 938.8
 COUNTY/DISTRICT RITCHIE COUNTY - CLAY DISTRICT QUADRANGLE PULLMAN - SEC. 2
 SURFACE OWNER CHRISTA J. SMITH ACREAGE 69.88 AC (DEED) 03/03/2017
 OIL & GAS ROYALTY OWNER ASHLEY E. NESS JR., ET AL ACREAGE 150 AC LEASE# 105410

PROPOSED WORK: DRILL CONVERT DRILL DEEPER REDRILL FRACTURE OR STIMULATE
 PLUG OFF OLD FORMATION PERFORATE NEW FORMATION PLUG & ABANDON
 CLEAN OUT & REPLUG OTHER CHANGE (SPECIFY) _____

TARGET FORMATION: MARCELLUS ESTIMATED DEPTH 6183

WELL OPERATOR: EQT PRODUCTION COMPANY DESIGNATED AGENT REX C. RAY
 ADDRESS 115 PROFESSIONAL PLACE, PO BOX 280 BRIDGEPORT, WV 26330

EQT PRODUCTION COMPANY
WELL NO. 516215 - Ashley E. Ness, Jr. et al
PAGE 1 OF 2

Table with 4 columns: UTM Zone, Point Type, Northing, Easting. Rows include TOPHOLE, LANDING PT, BOT HOLE for NAD83, NAD27 SPC FEET NORTH ZONE, and NAD27 GEO LAT(N) LONG(W).

MINERAL OWNERS table with columns: Name, AREA (Ac±), LEASE #. Owners include David A. Dorward, Orma M. Johnson, and Richard Barnard.

PROPERTY TIES table with columns: ID, Description, Length. Includes S33°46'W 1533.1' and N69°24'E 1137.5'.

HORIZONTAL BORE GEOMETRY table with columns: Type, Azimuth, Length. Includes TH-LP, LP-BH with azimuths and lengths.

TOTAL HORIZONTAL LENGTH - 9,918'

PROPERTIES CROSSED BY BORE table with columns: TAB, OWNER, DISTRICT, TAX MAP #, PARCEL #, ACREAGE. Lists 12 properties from Christa J. Smith to Peggy Wince.

* - DENOTES SUBSURFACE EASEMENT ACQUIRED

PROPERTIES ADJOINING THOSE CROSSED BY BORE (ABOVE) table with columns: TAB, OWNER, DISTRICT, TAX MAP #, PARCEL #, ACREAGE. Lists 20 adjacent properties from Elf, LLC to Heartwood Forestland Fund IV.

* - DENOTES SUBSURFACE EASEMENT ACQUIRED

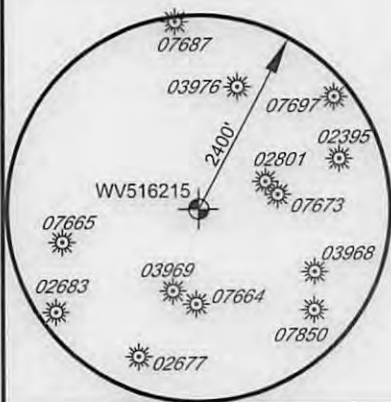

FILE NO. 7936-002
DRAWN BY DMS
SCALE 1 INCH = 2000 FEET
MIN DEGREE OF ACCURACY 1 IN 2500
PROVEN SOURCE OF ELEVATION SURVEY GRADE GPS

I, THE UNDERSIGNED, HEREBY CERTIFY THAT THIS PLAT IS CORRECT TO THE BEST OF MY KNOWLEDGE AND BELIEF AND SHOWS ALL THE INFORMATION REQUIRED BY LAW AND THE REGULATIONS ISSUED AND PRESCRIBED BY THE DIVISION OF ENVIRONMENTAL PROTECTION

David M. Shannon
P.S. #2034

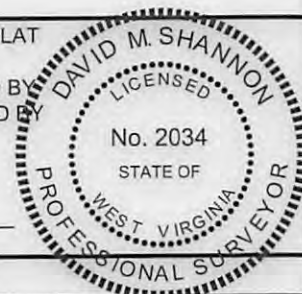

(+) DENOTES LOCATION OF WELL ON UNITED STATES TOPOGRAPHIC MAPS



OFFICE OF OIL AND GAS
601 57TH STREET
CHARLESTON, WV 25304

DATE 1-5-2017

OPERATORS WELL NO. WV516215
API WELL NO.

47 STATE 085 COUNTY

1026146A PERMIT

WELL TYPE: OIL [] GAS [x] LIQUID INJECTION [] WASTE DISPOSAL []
IF "GAS", PRODUCTION [x] STORAGE [] DEEP [] SHALLOW [x]
LOCATION: WATERSHED BUZZARD RUN - NORTH FORK HUGHES RIVER ELEVATION (EXIST) 945.0 (PROP) 938.8
COUNTY/DISTRICT RITCHIE COUNTY - CLAY DISTRICT QUADRANGLE PULLMAN - SEC. 2
SURFACE OWNER CHRISTA J. SMITH ACREAGE 69.88 AC (DEED) LEASE# 105410
OIL & GAS ROYALTY OWNER ASHLEY E. NESS JR., ET AL ACREAGE 150 AC
PROPOSED WORK: DRILL [x] CONVERT [] DRILL DEEPER [] REDRILL [] FRACTURE OR STIMULATE [x]
PLUG OFF OLD FORMATION [] PERFORATE NEW FORMATION [] PLUG & ABANDON []
CLEAN OUT & REPLUG [] OTHER CHANGE [] (SPECIFY) _____
TARGET FORMATION: MARCELLUS ESTIMATED DEPTH 6183
WELL OPERATOR: EQT PRODUCTION COMPANY DESIGNATED AGENT REX C. RAY
ADDRESS 115 PROFESSIONAL PLACE, PO BOX 280 BRIDGEPORT, WV 26330

COUNTY NAME PERMIT