

OXF122
WV 514083
EQT PRODUCTION COMPANY

LATITUDE 39°10'00"

LONGITUDE 80°47'30"

(S.P.C. NORTH ZONE) (UTM(M) ZONE 17 NORTH)

NAD'27 S.P.C.(FT) N. 233,051.21 E. 1,622,340.01
 NAD'27 GEO. LAT-(N) 39.132179 LONG-(W) 80.815346
 NAD'83 UTM (M) N. 4,331,467.90 E. 514,591.79

LANDING POINT

NAD'27 S.P.C.(FT) N. 231,728.34 E. 1,626,846.57
 NAD'27 GEO. LAT-(N) 39.128730 LONG-(W) 80.815393
 NAD'83 UTM (M) N. 4,331,087.83 E. 515,971.41

BOTTOM HOLE

NAD'27 S.P.C.(FT) N. 226,355.43 E. 1,628,684.40
 NAD'27 GEO. LAT-(N) 39.114053 LONG-(W) 80.808640
 NAD'83 UTM (M) N. 4,329,460.37 E. 516,558.61

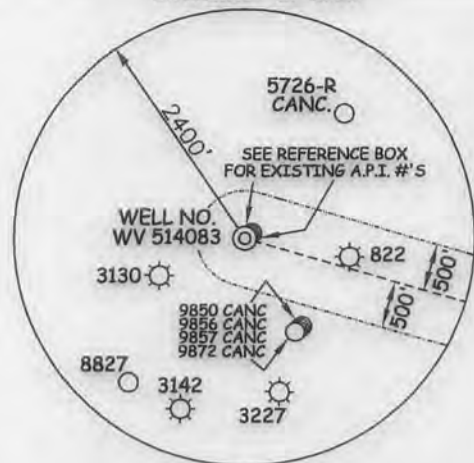

ROYALTY OWNERS			
ADELE McDOUGAL ET AL	2000 AC±	LEASE NO. 109481	
MICHAEL M. MCKENZIE ET AL	189.75 AC±	LEASE NO. 987351	
JAMES L. REED ET AL	40 AC±	LEASE NO. 986844	
JAMES L. REED ET AL	40 AC±	LEASE NO. 986845	

A	RICHARD L. & SHERYL A. RAY	255.5 ACRES±	R-U-TM-32-07
B	KENNETH P. ADAMS	47.15 ACRES±	R-U-TM-32-04
C	COASTAL FOREST RESOURCES CO. d/b/a COASTAL TIMBERLANDS CO.	145.192 ACRES±	D-SW-TM-16-04
D	JEFFREY SPERRY	72.86 ACRES±	D-SW-TM-16-4.1
E	RANDALL SR. & DEBBY FARLEY	42.92 ACRES±	D-SW-TM-16-8.6
F	COASTAL FOREST RESOURCES CO. d/b/a COASTAL TIMBERLANDS CO.	416.61 ACRES±	D-SW-TM-16-8.2
G	MARVIN EDWARDS JR.	94.5 ACRES±	D-SW-TM-18-02
H	MARVIN EDWARDS JR.	1 ACRE±	D-SW-TM-18-04
I	PAUL (LIFE) & JAMES MCKENZIE	228.75 ACRES±	D-SW-TM-18-05
J	RAYMOND A. TREWHELLA	35.5 ACRES±	D-SW-TM-18-12
K	JAMES MCKENZIE	57 ACRES±	R-U-TM-33-03
L	RANDALL SHORT	184.66 ACRES±	R-U-TM-32-15
M	SANDRA ADAMS	100 ACRES±	D-SW-TM-18-11
N	CHARLES & JUDITH WRIGHT	25 ACRES±	D-SW-TM-18-10
O	CHARLES & JUDITH WRIGHT	30.25 ACRES±	D-SW-TM-18-09
P	JEFFERY & JULIA SPERRY	53.44 ACRES±	D-SW-TM-18-14
Q	RUSSELL & CAROL WICK	30.05 ACRES±	R-U-TM-38-01
R	JAMES MCKENZIE	46.7 ACRES±	R-U-TM-33-01
S	BOBBY RIDDLE ET AL	188.88 ACRES±	R-U-TM-32-14
T	EQT PRODUCTION COMPANY	78.3 ACRES±	R-U-TM-32-06
U	JIMMIE JR. & SANDRA TRENT	76 ACRES±	R-U-TM-32-05
V	STEVEN P. ADAMS	7.3 ACRES±	D-SW-TM-18-03
W	MANSFIELD LEESON	189 ACRES±	D-SW-TM-16-09
X	CHARLES ADAMS	109.5 ACRES±	D-SW-TM-18-06
Y	JAMES MCKENZIE	3.43 ACRES±	R-U-TM-33-02

NOTES ON SURVEY

- NO WATER WELLS WERE FOUND WITHIN 250' OF PROPOSED GAS WELL. NO AGRICULTURAL BUILDINGS ≥ 2500 SQ. FT. OR DWELLINGS WERE FOUND WITHIN 625' OF THE CENTER OF PROPOSED WELL PAD.
- WELL SPOT CIRCLE & TOPO MARK SCALE IS 1"=2000'.

REFERENCES

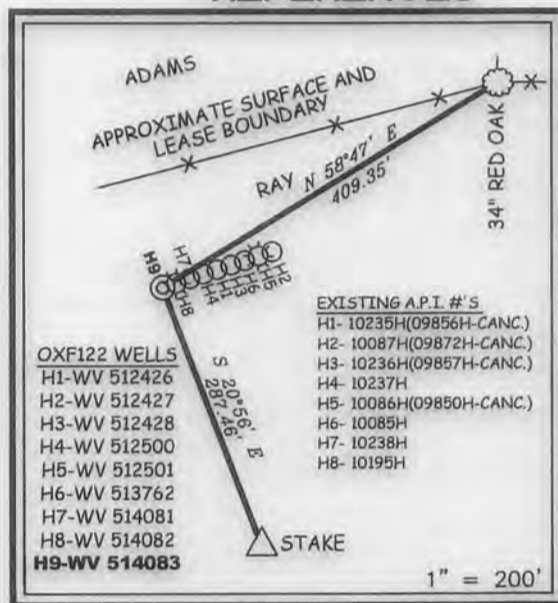

SLS
 Land & Energy Development
 Solutions from the ground up.
 P.O. Box 150 • 12 Vanhorn Drive • Glenville, WV 26351 • (304) 462-5634
 www.slsurveyors.com

I THE UNDERSIGNED, HEREBY CERTIFY THAT THIS PLAT IS CORRECT TO THE BEST OF MY KNOWLEDGE AND BELIEF AND SHOWS ALL THE INFORMATION REQUIRED BY LAW AND THE REGULATIONS ISSUED AND PRESCRIBED BY THE DIVISION OF ENVIRONMENTAL PROTECTION.

P.S. 849 *C. Victor Moyers*



(+) DENOTES LOCATION OF WELL ON UNITED STATES TOPOGRAPHIC MAPS.
 DATE APRIL 05, 20 16
 REVISED APRIL 11, 20 16
 OPERATORS WELL NO. WV 514083
 API WELL NO. 47 - 085 - 10285 HGA
 STATE COUNTY PERMIT

MINIMUM DEGREE OF ACCURACY 1 / 2500
 FILE NO. 6811P514083R
 HORIZONTAL & VERTICAL CONTROL DETERMINED BY DGPS (SURVEY GRADE TIE TO CORS NETWORK)
 SCALE SEE NOTE 2

STATE OF WEST VIRGINIA
 DIVISION OF ENVIRONMENTAL PROTECTION
 OFFICE OF OIL AND GAS

WELL TYPE: OIL GAS LIQUID INJECTION WASTE DISPOSAL IF "GAS" PRODUCTION STORAGE DEEP SHALLOW

LOCATION: PAD ELEVATION 1,111' WATERSHED STRAIGHT FORK DISTRICT UNION COUNTY RITCHIE QUADRANGLE OXFORD 7.5'

SURFACE OWNER RICHARD L. & SHERYL A. RAY ACREAGE 255.50±
 ROYALTY OWNER HAUGHT FAMILY TRUST ET AL ACREAGE 402±

PROPOSED WORK: DRILL CONVERT DRILL DEEPER REDRILL FRACTURE OR STIMULATE PLUG OFF OLD FORMATION PERFORATE NEW FORMATION PLUG AND ABANDON CLEAN OUT AND REPLUG OTHER

PHYSICAL CHANGE IN WELL (SPECIFY) TARGET FORMATION MARCELLUS ESTIMATED DEPTH 6,461'

WELL OPERATOR EQT PRODUCTION COMPANY DESIGNATED AGENT REX C. RAY
 ADDRESS 115 PROFESSIONAL PLACE P.O. BOX 280 BRIDGEPORT, WV 26330
 ADDRESS 115 PROFESSIONAL PLACE P.O. BOX 280 BRIDGEPORT, WV 26330

COUNTY NAME PERMIT

06/10/2016

