

LATITUDE 39°22'30" 2,686'

Antero Resources Corporation
Well No. Griff Unit 2H

NOTES:
WELL 2H TOP HOLE INFORMATION:
N: 308,392ft E: 1,608,422ft
LAT: 39°20'18.36" LON: 80°53'04.19"
BOTTOM HOLE INFORMATION:
N: 320,566ft E: 1,605,761ft
LAT: 39°22'18.27" LON: 80°53'40.46"
WEST VIRGINIA COORDINATE SYSTEM OF 1927 NORTH ZONE. ZONE WAS DERIVED FROM MEASUREMENTS TAKEN WITH TRIMBLE GEOXT SUBMETER MAPPING GRADE GPS UNIT. PLAT ORIENTATION, CORNER, AND WELL REFERENCE TIE LINES ARE BASED ON GRID NORTH.

(NAD) 83 (UTM) ZONE 17 COORDS:
WELL 2H TOP HOLE INFORMATION:
N: 4,354,349m E: 509,969m
BOTTOM HOLE INFORMATION:
N: 4,358,045m E: 509,096m

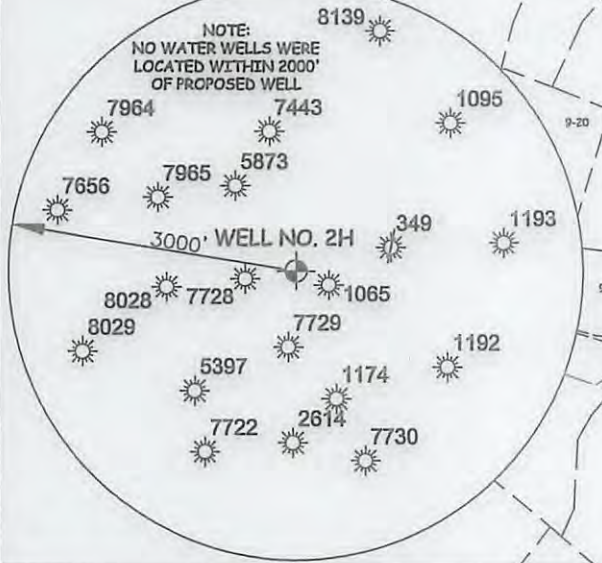

Clay District - Ritchie County	
4-11 Clifford Lockwood	297/285 68.583 AC
4-111 Henry Richards	297/285 1395 AC
4-113 Clarence Jones, Jr.	154/173 0.56 AC
4-115 Alfred Jones	267/415 5 AC
4-117 Clifford Lockard	306/402 1.24 AC
4-118 Henry Hilger	248/1049 8.776 AC
4-119 Thomas Smith	331/358 30.639 AC
4-12 Alfred Jones	300/480 48.57 AC
4-12.1 Arlon Jones	258/848 1 AC
4-17 Brian Jones	253/848 13 AC
4-28 Gary Lassiter	178/124 19.3 AC
4-29 James Lassiter	219/107 66.5 AC
4-20 Albert Ayers	260/620 4 AC
4-21 Mike Ross Inc.	313/1037 91 AC
4-30.1 James Lassiter	219/107 60 AC
4-37 Myron Perkins	338/484 27 AC
4-37.1 Myron Perkins	338/484 70 AC
4-48 John Koshlin	287/276 42.05 AC
4-49 Ricky Halton	323/295 23.35 AC
9-05 John Koshlin	287/276 29.19 AC
9-11 John Koshlin	287/276 33.12 AC
9-05 Richard Ridgeway	312/055 18 AC
9-07 John Koshlin	287/276 24 AC
9-08 Robert Rows	174/490 30.71 AC
9-8.1 Robert Rows	174/490 10.91 AC
9-8.2 Robert Rows	174/490 11.1 AC
9-8.3 Robert Rows	174/490 1.44 AC
9-09 Jeanette Bean	221/577 31.11 AC
9-21 Robert Rows	276/253 69 AC
9-10 Jeanette Bean	253/208 14.55 AC
9-11 Jeanette Bean	253/208 19 AC
9-12 Robert Rows	174/490 16.33 AC
9-12.1 Jeanette Bean	221/577 Lot
9-13 Robert Rows	280/791 0.786 AC
9-13.1 Robert Rows	276/250 2.04 AC
9-14 Robert Rows	174/490 76.55 AC
9-15 Robert Rows	174/490 69 AC
9-28 Robert Lassinger	312/911 129.32 AC
9-28.1 Robert Lassinger	312/911 27.52 AC
9-32 WVA Christian Youth Camp	178/198 87.75 AC
9-33 William Hart	313/273 98.79 AC

Casterville District - Tyler County	
14-08 Humby Land & Timber LLC	349/133 63 AC
14-08 Humby Land & Timber LLC	349/133 63 AC
15-24 Mike Ross Inc.	393/012 100.90 AC
17-01 Ben (Ray) Paul Ayers of Black Co.	437/216 44.82 AC
17-11 Ben (Ray) Paul Ayers of Black Co.	437/216 8 AC
17-12 Ben (Ray) Paul Ayers of Black Co.	437/216 22.5 AC
17-07 Roger Scott	65/223 20 AC
17-2 Roger Scott	207/043 30 AC
17-7.3 Roger Scott	211/621 30.88 AC
17-7.5 Randall Bond	326/16 32.16 AC
17-08 Eleanor Fowler	279/079 145 AC
17-25 Larry Hasler	309/363 180.895 AC
17-32 Man Kathy Smartycha	398/409 14.94 AC

I THE UNDERSIGNED, HEREBY CERTIFY THAT THIS PLAT IS CORRECT TO THE BEST OF MY KNOWLEDGE AND BELIEF AND SHOWS ALL THE INFORMATION REQUIRED BY LAW AND THE RULES ISSUED AND PERSCRIBED BY THE DEPARTMENT OF ENVIRONMENTAL PROTECTION.



STATE OF WEST VIRGINIA, DIVISION OF ENVIRONMENTAL PROTECTION, OFFICE OF OIL AND GAS

WILLOW LAND SURVEYING PLLC
220 MASONIC AVE. PENNSBORO WEST VIRGINIA 26415

(NAD) 27 (UTM) ZONE 17 COORDS:
WELL 2H TOP HOLE INFORMATION:
N: 14,285,180ft E: 1,673,075ft
POINT OF ENTRY INFORMATION:
N: 14,285,478ft E: 1,674,073ft
BOTTOM HOLE INFORMATION:
N: 14,297,304ft E: 1,670,212ft

NOTE
NO OCCUPIED DWELLINGS OR BUILDINGS TWO THOUSAND FIVE HUNDRED (2,500) SQUARE FEET OR LARGER USED TO HOUSE OR SHELTER DAIRY CATTLE OR POULTRY HUSBANDRY ARE LOCATED WITHIN SIX HUNDRED TWENTY-FIVE (625) FEET OF THE CENTER OF THE WELL PAD.

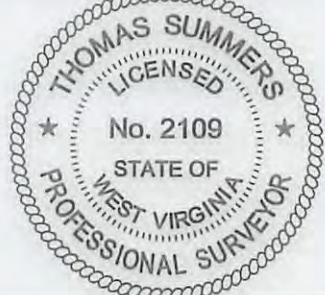

JOB # 17-007WA	LEGEND	REFERENCES
DRAWING # GRIFF2HR	--- Surface Owner Boundary Lines +/-	
SCALE 1" = 200'	- - - Interior Surface Tracts +/-	
MINIMUM DEGREE OF ACCURACY SUBMETER	- x - x - Existing Fence	
PROVEN SOURCE OF ELEV. SUBMETER MAPPING GRADE GPS	⊕ Found monument, as noted	
STATE OF WEST VIRGINIA DEPARTMENT OF ENERGY DIVISION OF OIL AND GAS	<i>Thomas Summers</i>	
	THOMAS SUMMERS P.S. 2109	
	DATE 07/05/18	
	OPERATOR'S WELL# GRIFF UNIT #2H	
WELL TYPE: OIL GAS X LIQUID INJECTION WASTE DISPOSAL		
(IF "GAS") PRODUCTION X STORAGE DEEP SHALLOW X		
LOCATION: ELEVATION 1,250' AS BUILT WATERSHED NORTH FORK HUGHES RIVER		
QUADRANGLE PENNSBORO 7.5 DISTRICT CLAY COUNTY RITCHIE		
SURFACE OWNER RADALL BOND ET AL ACREAGE 32.16 ACRES +/-		
OIL & GAS ROYALTY OWNER MARTHA J. DAVIS ET VIR; LELIA WASHBURN ET AL; BETTY M. TARULLI ET AL; LEASE ACREAGE 70 AC±; 150 AC±; 69 AC±; BETTY M. TARULLI ET AL; WACO OIL & GAS CO.; SHIRLEY BERYL BURCHARD ET VIR; EDITH A. GRIFFIN ET VIR; 76 AC±; 56 AC±; 60 AC±; 91 AC±; JAMES D. LASATER; LINDA D. BURG-JETT 66.5 AC±; 65 AC±		
PROPOSED WORK: DRILL CONVERT DRILL DEEPER X REDRILL FRACTURE OR STIMULATE X		
PLUG OFF OLD FORMATION PERFORATE NEW FORMATION X OTHER PHYSICAL CHANGE IN WELL PLUG & ABANDON CLEAN OUT & REPLUG		
(SPECIFY) MOD-BHL		
TARGET FORMATION MARCELLUS ESTIMATED DEPTH 7,000' TVD 19,900' MD		
WELL OPERATOR ANTERO RESOURCES CORP. DESIGNATED AGENT DIANNA STAMPER - CT CORPORATION SYSTEM		
ADDRESS 1615 WYNKOOP ST. ADDRESS 5400 D BIG TYLER ROAD		
FORM WW-6 DENVER, CO 80202 ADDRESS CHARLESTON, WV 25313		

1,188' TO BOTTOM HOLE LONGITUDE 80°52'30" 1,3,319' LONGITUDE 80°52'30"

07/13/2018