

11/16/2018

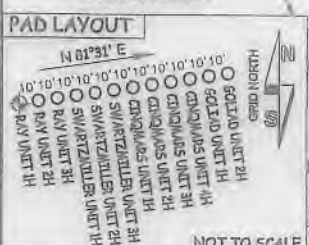

NOTES:
WELL 1H TOP HOLE INFORMATION:
N: 320,628ft E: 1,597,402ft
LAT: 39°22'17.59" LON: 80°55'26.89"
BOTTOM HOLE INFORMATION:
N: 327,133ft E: 1,592,934ft
LAT: 39°23'21.17" LON: 80°56'25.12"
WEST VIRGINIA COORDINATE SYSTEM OF 1927 NORTH ZONE. ZONE WAS DERIVED FROM MEASUREMENTS TAKEN WITH TRIMBLE GEOXT SUBMETER MAPPING GRADE GPS UNIT. PLAT ORIENTATION, CORNER, AND WELL REFERENCE TIE LINES ARE BASED ON GRID NORTH.

(NAD) 83 (UTM) ZONE 17 COORDS:
WELL 1H TOP HOLE INFORMATION:
N: 4,358,021m E: 506,549m
BOTTOM HOLE INFORMATION:
N: 4,359,980m E: 505,155m

(NAD) 27 (UTM) ZONE 17 COORDS:
WELL 1H TOP HOLE INFORMATION:
N: 14,297,227ft E: 1,661,856ft
POINT OF ENTRY INFORMATION:
N: 14,296,547ft E: 1,659,834ft
BOTTOM HOLE INFORMATION:
N: 14,303,654ft E: 1,657,281ft

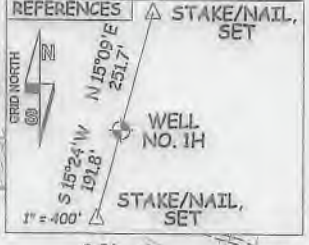

JOB # 17-043WA
DRAWING # RAY1HR1
SCALE 1" = 2000'
MINIMUM DEGREE OF ACCURACY SUBMETER
PROVEN SOURCE OF ELEV. SUBMETER MAPPING GRADE GPS
STATE OF WEST VIRGINIA DEPARTMENT OF ENERGY DIVISION OF OIL AND GAS

THE UNDERSIGNED, HEREBY CERTIFY THAT THIS PLAT IS CORRECT TO THE BEST OF MY KNOWLEDGE AND BELIEF AND SHOWS ALL THE INFORMATION REQUIRED BY LAW AND THE RULES ISSUED AND PERSCRIBED BY THE DEPARTMENT OF ENVIRONMENTAL PROTECTION.



STATE OF WEST VIRGINIA, DIVISION OF ENVIRONMENTAL PROTECTION, OFFICE OF OIL AND GAS
WILLOW LAND SURVEYING PLLC
220 MASONIC AVE. PENNSBORO WEST VIRGINIA 26415

LEGEND
----- Surface Owner Boundary Lines +/-
----- Interior Surface Tracts +/-
----- Existing Fence
----- Found monument, as noted

DOUGLAS R. ROWE P.S. 2202
DATE 07/30/18
OPERATOR'S WELL# RAY UNIT 1H

WELL TYPE: OIL GAS X LIQUID INJECTION WASTE DISPOSAL 47 - 085 - 10346
(IF "GAS") PRODUCTION X STORAGE DEEP SHALLOW X STATE COUNTY PERMIT
LOCATION: ELEVATION 1,235' AS BUILT WATERSHED NORTH FORK HUGHES RIVER
QUADRANGLE PENNSBORO 7.5' - TH MIDDLEBOURNE 7.5' - BH DISTRICT CLAY COUNTY RITCHIE
SURFACE OWNER DAVID L. WEEKLEY REVOCABLE TRUST ACREAGE 203.38 ACRES +/-
OIL & GAS ROYALTY OWNER DAVID L. WEEKLEY REVOCABLE TRUST; NORMAN FLEMING ET UX; LEASE ACREAGE 229 AC±; 126.5 AC±;
BRIAN KEITH JONES; BRIAN KEITH JONES; GARY MICHAEL DER ET UX; JOE-DOM INC.; 31 AC±; 14 AC±; 10 AC±; 380 AC±;
RAYMOND CECIL DARNELL; RICHARD HALL BARNARD 81.5 AC±; 148.252 AC±

PROPOSED WORK: DRILL CONVERT DRILL DEEPER X REDRILL FRACTURE OR STIMULATE X
PLUG OFF OLD FORMATION PERFORATE NEW FORMATION X OTHER PHYSICAL CHANGE IN WELL
(SPECIFY) MOD-BHL PLUG & ABANDON CLEAN OUT & REPLUG
TARGET FORMATION MARCELLUS ESTIMATED DEPTH 7,000' TVD 17,300' MD
WELL OPERATOR ANTERO RESOURCES CORP. DESIGNATED AGENT DIANNA STAMPER - CT CORPORATION SYSTEM
ADDRESS 1615 WYNKOOP ST. ADDRESS 5400 D BIG TYLER ROAD
DENVER, CO 80202 CHARLESTON, WV 25313