

NOTES:
 WELL 1H TOP HOLE INFORMATION:
 N: 320,632ft E: 1,597,432ft
 LAT: 39°22'17.63" LON: 80°55'26.52"
 BOTTOM HOLE INFORMATION:
 N: 327,714ft E: 1,595,349ft
 LAT: 39°23'27.29" LON: 80°55'54.48"
 WEST VIRGINIA COORDINATE SYSTEM OF 1927 NORTH ZONE. ZONE WAS DERIVED FROM MEASUREMENTS TAKEN WITH TRIMBLE 660XT SUBMETER MAPPING GRADE GPS UNIT. PLAT ORIENTATION, CORNER, AND WELL REFERENCE TIE LINES ARE BASED ON GRID NORTH.
 (NAD) 83 (UTM) ZONE 17 COORDS:
 WELL 1H TOP HOLE INFORMATION:
 N: 4,358,022m E: 506,558m
 BOTTOM HOLE INFORMATION:
 N: 4,360,169m E: 505,888m

Clay District - Ritchie County		
PAR.	SURFACE OWNER	OIL & GAS ROYALTY OWNER
1-08	CLIFF PERKINS ET AL	CLIFF WM. PERKINS ET UX
1-09	CLIFF PERKINS ET AL	CLIFF WM. PERKINS ET UX
1-11	CLIFF PERKINS ET AL	CLIFF WM. PERKINS ET UX
1-12	CLIFF PERKINS ET AL	LAURA ULAM
1-13	CLIFF PERKINS ET AL	CLIFF WM. PERKINS ET UX
1-14	CLIFF PERKINS ET AL	CLIFF WM. PERKINS ET UX
1-15	CLIFF PERKINS ET AL	CLIFF WM. PERKINS ET UX
1-16	CLIFF PERKINS ET AL	CLIFF WM. PERKINS ET UX
1-17	CLIFF PERKINS ET AL	CLIFF WM. PERKINS ET UX
1-18	CLIFF PERKINS ET AL	CLIFF WM. PERKINS ET UX
1-19	MICHAEL DER	GARY MICHAEL DER ET UX
1-20	TONY PERKINS ET AL	TONY ADRIAN PERKINS
3-03	BRIAN JONES	BRIAN KEITH JONES
3-04	BRIAN JONES	BRIAN KEITH JONES
3-05	DENNY COWGER	DENNY COWGER ET UX
3-06	CLIFF PERKINS ET AL	TONY ADRIAN PERKINS

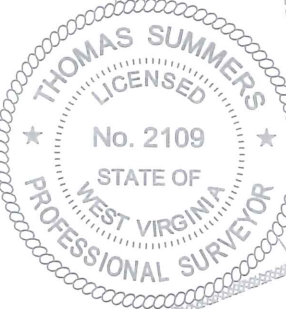
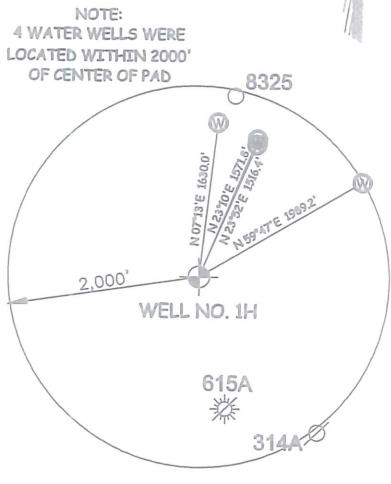

JOB # 17-044WA	THE UNDERSIGNED, HEREBY CERTIFY THAT THIS PLAT IS CORRECT TO THE BEST OF MY KNOWLEDGE AND BELIEF AND SHOWS ALL THE INFORMATION REQUIRED BY LAW AND THE RULES ISSUED AND PERSCRIBED BY THE DEPARTMENT OF ENVIRONMENTAL PROTECTION.	LEGEND - - - - - Surface Owner Boundary Lines +/- - - - - - Interior Surface Tracts +/- ○ - - - - - Proposed Well Path ⊗ - - - - - As Drilled Well Path
DRAWING # SWARTMILLER1HAD	STATE OF WEST VIRGINIA, DIVISION OF ENVIRONMENTAL PROTECTION, OFFICE OF OIL AND GAS	THOMAS SUMMERS P.S. 2109
SCALE 1" = 1000'		DATE 02/10/20
MINIMUM DEGREE OF ACCURACY SUBMETER	WILLOW LAND SURVEYING PLLC 220 MASONIC AVE. PENNSBORO WEST VIRGINIA 26415	OPERATOR'S WELL # SWARTZMILLER UNIT #1H
PROVEN SOURCE OF ELEV. SUBMETER MAPPING GRADE GPS	STATE OF WEST VIRGINIA DEPARTMENT OF ENERGY DIVISION OF OIL AND GAS	DATE 02/10/20
STATE OF WEST VIRGINIA DEPARTMENT OF ENERGY DIVISION OF OIL AND GAS		OPERATOR'S WELL # SWARTZMILLER UNIT #1H
WELL TYPE: OIL ___ GAS <u>X</u> LIQUID INJECTION ___ WASTE DISPOSAL ___ 47 - 085 - 10349		
(IF "GAS") PRODUCTION <u>X</u> STORAGE ___ DEEP ___ SHALLOW <u>X</u> STATE COUNTY PERMIT		
LOCATION: ELEVATION 1,235' AS BUILT WATERSHED NORTH FORK HUGHES RIVER		
QUADRANGLE PENNSBORO 7.5' - TH MIDDLEBOURNE 7.5' - BH DISTRICT CLAY COUNTY RITCHIE		
SURFACE OWNER DAVID L. WEEKLEY REVOCABLE TRUST ACREAGE 203.38 ACRES +/-		
OIL & GAS ROYALTY OWNER DAVID L. WEEKLEY REVOCABLE TRUST; CLIFF WM. PERKINS ET UX; LEASE ACREAGE 229 AC±; 16.35 AC±; CLIFF WM. PERKINS ET UX; CLIFF WM. PERKINS ET UX; LAURA ULAM; CLIFF WM. PERKINS ET UX; CLIFF WM. PERKINS ET UX; 17 AC±; 18.5 AC±; 16.5 AC±; 16 AC±; 75.08 AC±; JOE-DOM INC.; ROBERT A. DAVIS ET UX 380 AC±; 284.33 AC±		
PROPOSED WORK: DRILL ___ CONVERT ___ DRILL DEEPER ___ REDRILL ___ FRACTURE OR STIMULATE ___ PLUG OFF OLD FORMATION ___ PERFORATE NEW FORMATION ___ OTHER PHYSICAL CHANGE IN WELL (SPECIFY) <u>AS DRILLED</u> PLUG & ABANDON ___ CLEAN OUT & REPLUG ___		
TARGET FORMATION <u>MARCELLUS</u> ESTIMATED DEPTH 6,581' TVD 14,250' MD		
WELL OPERATOR <u>ANTERO RESOURCES CORP.</u> DESIGNATED AGENT <u>DIANNA STAMPER - CT CORPORATION SYSTEM</u>		
ADDRESS <u>1615 WYNKOOP ST. DENVER, CO 80202</u> ADDRESS <u>5400 D BIG TYLER ROAD CHARLESTON, WV 25313</u>		

COUNTY NAME
 PERMIT